

USER: Mch21 TWS: C8.2  
 DATE: Jun 21 2006 1:40pm  
 DRAWING: S:\J085\Jobs2005\05-340\LD5-340.dwg\PHASE IMPROVEMENT PLANS\PLAN\_C8.0 SANITARY PROFILES.dwg

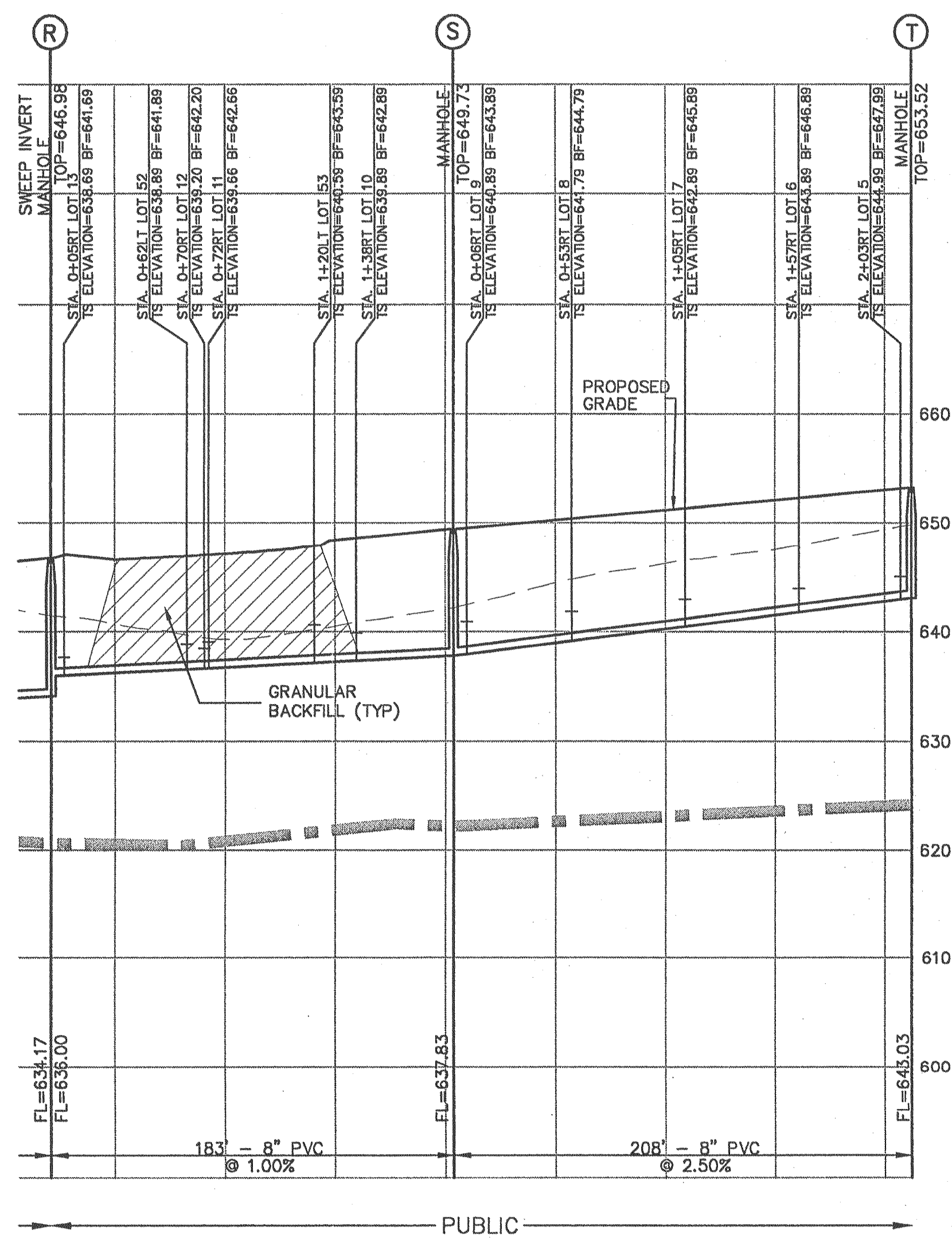
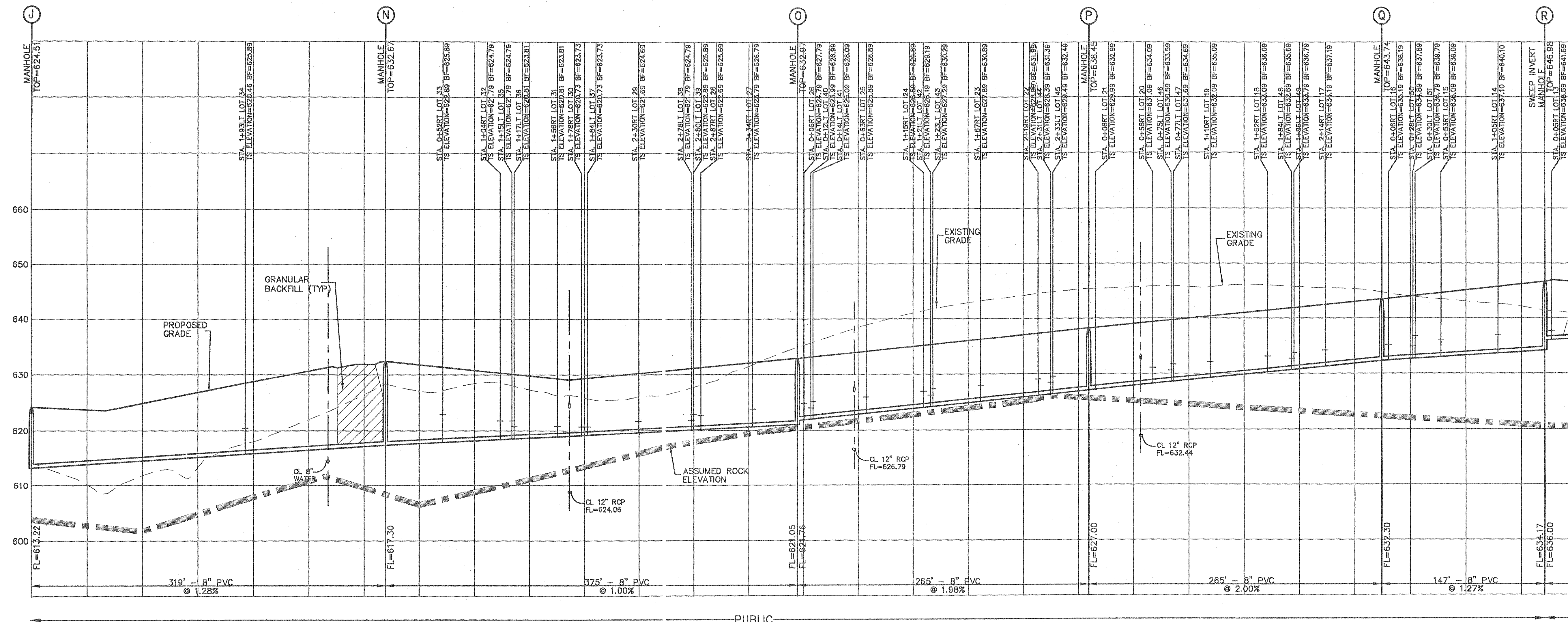

RECEIVED  
 JUN 22 2006  
 ST. CHARLES COUNTY  
 COMMUNITY DEVELOPMENT DEPT.  
 DEVELOPMENT REVIEW DIVISION

Handwritten note: Fl. of 2.5'

SCALE:  
 1" = 50' HORIZ.  
 1" = 10' VERT.

NOTE: STORM SEWER PIPES WHICH CROSS OVER EXISTING OR PROPOSED SANITARY SEWER TRENCHES SHALL BE CRADLED IN CONCRETE THROUGH THE FULL WIDTH OF THE SANITARY SEWER TRENCH. THE TRENCH SHALL BE BACKFILLED AND COMPACTED WITH GRANULAR FILL TO THE BOTTOM OF THE CONCRETE GRADE.  
 IF THE STORM AND SANITARY SEWERS ARE PARALLEL AND IN THE SAME TRENCH OR OVER-DIG, THE UPPER PIPE SHALL BE PLACED ON A SHELF AND THE LOWER PIPE SHALL BE BEDDED IN COMPACTED GRANULAR FILL TO THE FLOWLINE OF THE UPPER PIPE.  
 ALL SANITARY LATERAL STREET CROSSINGS, IF TRENCHED, SHALL BE BACKFILLED WITH GRANULAR MATERIAL (AGGREGATE).

<b>REVISIONS</b> DATE: 4/29/06 BY: JKW OWNER/COUNTY COMMENTS: ST. CHARLES CO. REVIEW COMMENTS DATE: 5/19/06 BY: JKW OWNER/COUNTY COMMENTS: PARCELS TO GREEK ROAD DIST. COMMENTS DATE: 6/2/06 BY: JKW OWNER/COUNTY COMMENTS: COUNTY COMMENTS DATE: 6/21/06 BY: JKW OWNER/COUNTY COMMENTS: COUNTY COMMENTS	
DEVELOPER/OWNER: <b>THE JONES COMPANY HOMES, L.L.C.</b> 16640 CHESTERFIELD GROVE, SUITE 160 CHESTERFIELD, MO 63005 PHONE: (636) 537-7192	
THE PROFESSIONAL WARE SIGNATURE AND PERSONAL SEAL APPEAR HEREON ASSUMES RESPONSIBILITY ONLY FOR WHAT APPEARS ON THIS PAGE, AND DOES NOT ASSUME RESPONSIBILITY FOR ANY OTHER INFORMATION, SPECIFICATIONS, NOTATIONS, OR OTHER DOCUMENTS OR INSTRUMENTS NOT PREPARED BY OR UNDER THE SUPERVISION OF THE PROFESSIONAL ENGINEER. THIS SEAL IS NOT VALID UNLESS IT IS PLACED ON THIS PAGE.	
SEAL: ST. CHARLES COUNTY PROFESSIONAL ENGINEER JOHN F. HARRIS No. 000000000 E-29716	
<b>PRESTON WOODS - PHASE I</b> IMPROVEMENT PLANS RHODES LANE ST. CHARLES, MO. 63366	
<b>SANITARY SEWER PROFILE</b>	
planning • engineering • surveying • landscape architecture <b>Cole and Associates</b> INCORPORATED 10777 sunset office dr. suite 10 saint louis, missouri p: 314 984 9887 f: 314 984 0587	
DESIGNED BY: JKW DRAWN BY: BJ CHECKED BY: JFH	
DATE: 2/2/06 Job Number: 05-340 Sheet Number: C8.2	