

USER: kwright TAB: C61
 DATE: Oct 23, 2007 12:11pm
 DRAWING: s:\085\085207\07-0041\07-0041.dwg IMPROVEMENT PLANS PHASE 2\0-PLAN_C6.0 STREET PROFILES.dwg

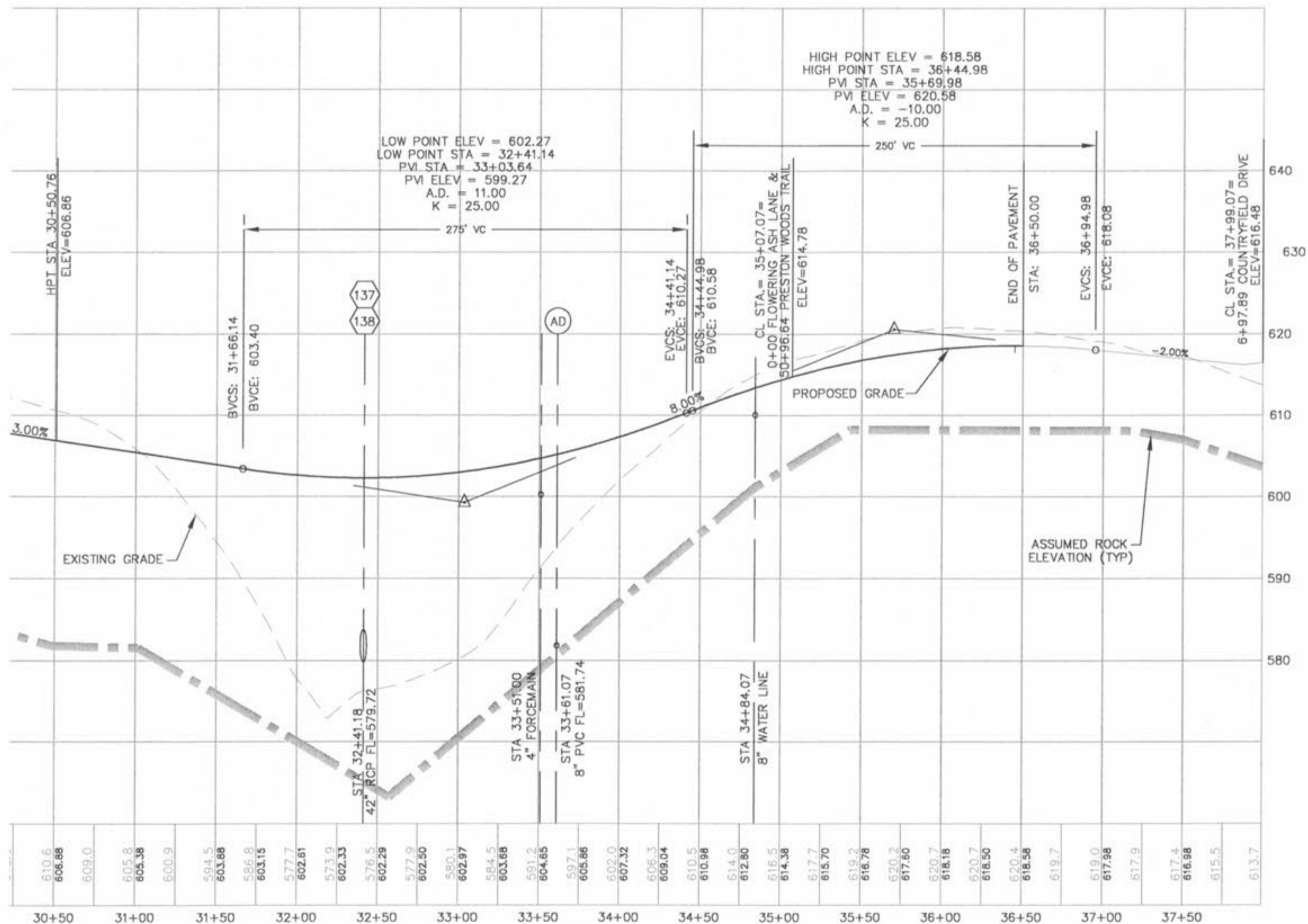

| | |
|-------|--------|
| 30+50 | 610.6 |
| 30+50 | 606.86 |
| 30+50 | 609.0 |
| 31+00 | 605.8 |
| 31+00 | 603.38 |
| 31+00 | 600.9 |
| 31+50 | 604.5 |
| 31+50 | 603.68 |
| 31+50 | 601.8 |
| 31+50 | 603.15 |
| 31+50 | 601.7 |
| 32+00 | 602.61 |
| 32+00 | 602.33 |
| 32+00 | 576.5 |
| 32+00 | 602.29 |
| 32+00 | 602.50 |
| 32+00 | 590.1 |
| 32+00 | 602.97 |
| 32+00 | 604.5 |
| 32+00 | 603.68 |
| 32+00 | 604.65 |
| 32+00 | 597.1 |
| 32+00 | 605.86 |
| 32+00 | 607.32 |
| 32+00 | 606.3 |
| 32+00 | 609.04 |
| 32+00 | 610.5 |
| 32+00 | 610.98 |
| 32+00 | 614.0 |
| 32+00 | 612.80 |
| 32+00 | 615.5 |
| 32+00 | 614.36 |
| 32+00 | 617.7 |
| 32+00 | 615.70 |
| 32+00 | 619.2 |
| 32+00 | 616.78 |
| 32+00 | 620.2 |
| 32+00 | 617.60 |
| 32+00 | 620.7 |
| 32+00 | 618.18 |
| 32+00 | 620.4 |
| 32+00 | 618.50 |
| 32+00 | 618.58 |
| 32+00 | 619.7 |
| 32+00 | 619.0 |
| 32+00 | 617.98 |
| 32+00 | 617.9 |
| 32+00 | 617.4 |
| 32+00 | 616.98 |
| 32+00 | 615.5 |
| 32+00 | 613.7 |

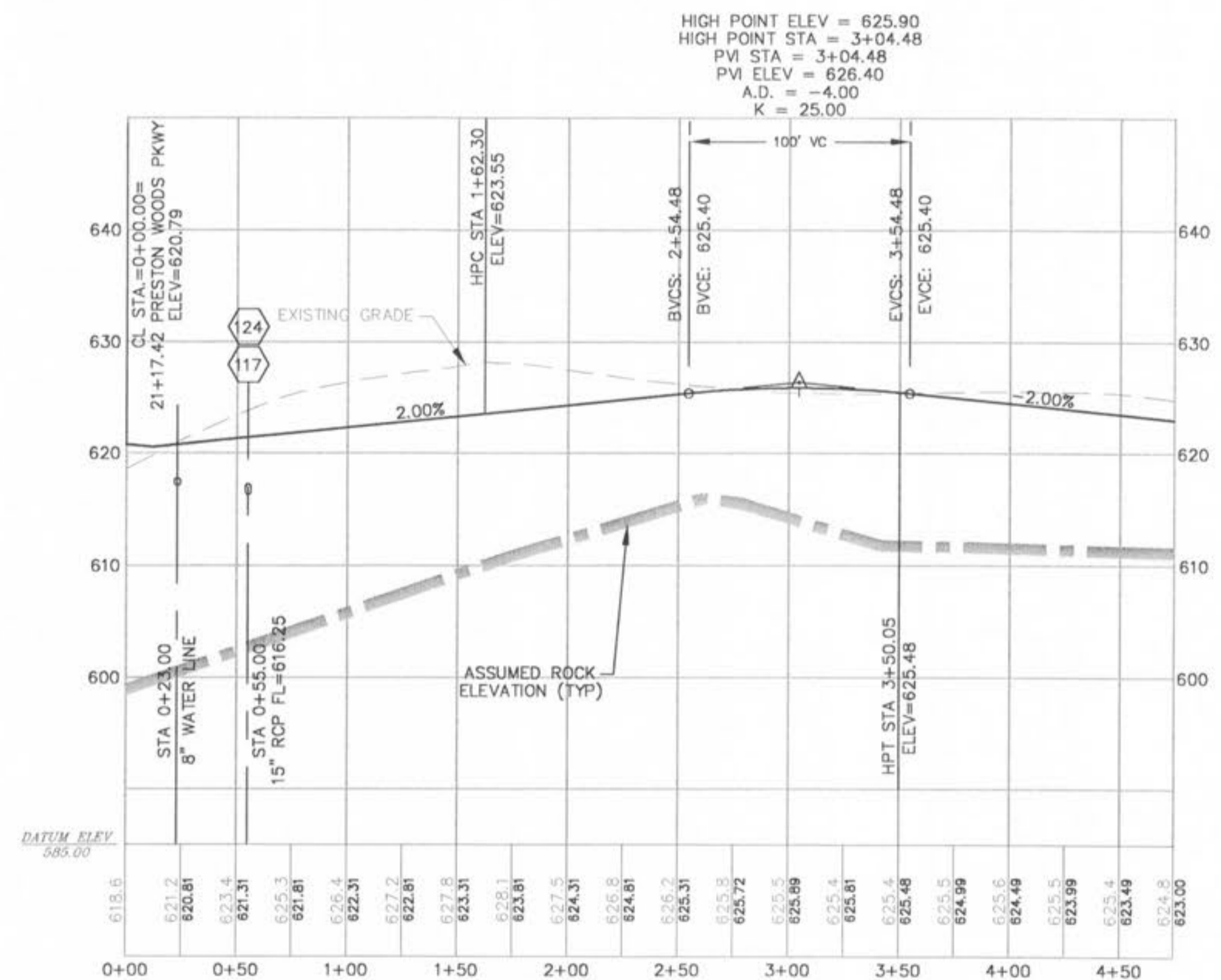

| | |
|------|--------|
| 0+00 | 618.6 |
| 0+00 | 621.2 |
| 0+00 | 620.61 |
| 0+00 | 623.4 |
| 0+00 | 621.31 |
| 0+00 | 625.3 |
| 0+00 | 622.81 |
| 0+00 | 622.31 |
| 0+00 | 627.2 |
| 0+00 | 622.81 |
| 0+00 | 623.51 |
| 0+00 | 628.1 |
| 0+00 | 627.5 |
| 0+00 | 624.31 |
| 0+00 | 626.8 |
| 0+00 | 624.81 |
| 0+00 | 626.2 |
| 0+00 | 625.31 |
| 0+00 | 625.72 |
| 0+00 | 625.5 |
| 0+00 | 625.89 |
| 0+00 | 625.4 |
| 0+00 | 625.81 |
| 0+00 | 625.48 |
| 0+00 | 625.5 |
| 0+00 | 624.99 |
| 0+00 | 625.6 |
| 0+00 | 624.49 |
| 0+00 | 625.5 |
| 0+00 | 623.99 |
| 0+00 | 625.4 |
| 0+00 | 623.49 |
| 0+00 | 623.00 |

STORM STRUCTURE TABLE

| STRUCTURE NUMBER | STREET NAME | STATION | OFFSET |
|------------------|----------------------|----------|---------|
| AI 122 | PRESTON WOODS PKWY. | 20+32.46 | 25.96 R |
| CI 118 | PRESTON WOODS PKWY. | 20+37.87 | 17.50 R |
| CI 119 | PRESTON WOODS PKWY. | 20+37.87 | 17.50 L |
| MH 90 | PRESTON WOODS PKWY. | 23+33.87 | 23.00 R |
| DCI 106 | PRESTON WOODS PKWY. | 25+66.14 | 17.50 L |
| DCI 105 | PRESTON WOODS PKWY. | 25+66.14 | 17.50 R |
| MH 89 | PRESTON WOODS PKWY. | 25+92.92 | 23.00 R |
| DCI 137 | PRESTON WOODS PKWY. | 32+41.14 | 17.50 R |
| DCI 138 | PRESTON WOODS PKWY. | 32+41.14 | 17.50 L |
| MH 139 | PRESTON WOODS PKWY. | 32+61.56 | 34.83 L |
| CI 117 | SILVER LINDEN CIRCLE | 0+55.00 | 17.50 R |
| CI 124 | SILVER LINDEN CIRCLE | 0+55.00 | 17.50 L |
| MH 116 | SILVER LINDEN CIRCLE | 1+31.61 | 17.98 R |
| CI 131 | SILVER LINDEN CIRCLE | 5+00.79 | 35.61 L |

SCALE: 1" = 50' HORIZ.
 1" = 10' VERT.

planning • engineering • surveying • landscape architecture

Gole and ASSOCIATES INCORPORATED

10777 sunset office dr.
 saint louis, missouri 63127
 p: 314 984 9887 f: 314 984 0567

DESIGNED BY: JKW
 DRAWN BY: KDK
 CHECKED BY: JFH
 DATE: 6/14/07
 Job Number: 07-0041
 Sheet Number: C6.1

DEVELOPER/OWNER:
 THE JONES COMPANY HOMES, L.L.C.
 16640 CHESTERFIELD GROVE, SUITE 200
 CHESTERFIELD, MO 63005
 PHONE: (636) 537-7192

REVISIONS

| NO. | DATE | DESCRIPTION |
|-----|---------|--------------------|
| 1 | 9/14/07 | ISSUED FOR PERMITS |
| 2 | 9/14/07 | ISSUED FOR PERMITS |
| 3 | 9/14/07 | ISSUED FOR PERMITS |
| 4 | 9/14/07 | ISSUED FOR PERMITS |
| 5 | 9/14/07 | ISSUED FOR PERMITS |
| 6 | 9/14/07 | ISSUED FOR PERMITS |
| 7 | 9/14/07 | ISSUED FOR PERMITS |
| 8 | 9/14/07 | ISSUED FOR PERMITS |
| 9 | 9/14/07 | ISSUED FOR PERMITS |
| 10 | 9/14/07 | ISSUED FOR PERMITS |
| 11 | 9/14/07 | ISSUED FOR PERMITS |
| 12 | 9/14/07 | ISSUED FOR PERMITS |
| 13 | 9/14/07 | ISSUED FOR PERMITS |
| 14 | 9/14/07 | ISSUED FOR PERMITS |
| 15 | 9/14/07 | ISSUED FOR PERMITS |
| 16 | 9/14/07 | ISSUED FOR PERMITS |
| 17 | 9/14/07 | ISSUED FOR PERMITS |
| 18 | 9/14/07 | ISSUED FOR PERMITS |
| 19 | 9/14/07 | ISSUED FOR PERMITS |
| 20 | 9/14/07 | ISSUED FOR PERMITS |
| 21 | 9/14/07 | ISSUED FOR PERMITS |
| 22 | 9/14/07 | ISSUED FOR PERMITS |
| 23 | 9/14/07 | ISSUED FOR PERMITS |
| 24 | 9/14/07 | ISSUED FOR PERMITS |
| 25 | 9/14/07 | ISSUED FOR PERMITS |
| 26 | 9/14/07 | ISSUED FOR PERMITS |
| 27 | 9/14/07 | ISSUED FOR PERMITS |
| 28 | 9/14/07 | ISSUED FOR PERMITS |
| 29 | 9/14/07 | ISSUED FOR PERMITS |
| 30 | 9/14/07 | ISSUED FOR PERMITS |
| 31 | 9/14/07 | ISSUED FOR PERMITS |
| 32 | 9/14/07 | ISSUED FOR PERMITS |
| 33 | 9/14/07 | ISSUED FOR PERMITS |
| 34 | 9/14/07 | ISSUED FOR PERMITS |
| 35 | 9/14/07 | ISSUED FOR PERMITS |
| 36 | 9/14/07 | ISSUED FOR PERMITS |
| 37 | 9/14/07 | ISSUED FOR PERMITS |
| 38 | 9/14/07 | ISSUED FOR PERMITS |
| 39 | 9/14/07 | ISSUED FOR PERMITS |
| 40 | 9/14/07 | ISSUED FOR PERMITS |
| 41 | 9/14/07 | ISSUED FOR PERMITS |
| 42 | 9/14/07 | ISSUED FOR PERMITS |
| 43 | 9/14/07 | ISSUED FOR PERMITS |
| 44 | 9/14/07 | ISSUED FOR PERMITS |
| 45 | 9/14/07 | ISSUED FOR PERMITS |
| 46 | 9/14/07 | ISSUED FOR PERMITS |
| 47 | 9/14/07 | ISSUED FOR PERMITS |
| 48 | 9/14/07 | ISSUED FOR PERMITS |
| 49 | 9/14/07 | ISSUED FOR PERMITS |
| 50 | 9/14/07 | ISSUED FOR PERMITS |
| 51 | 9/14/07 | ISSUED FOR PERMITS |
| 52 | 9/14/07 | ISSUED FOR PERMITS |
| 53 | 9/14/07 | ISSUED FOR PERMITS |
| 54 | 9/14/07 | ISSUED FOR PERMITS |
| 55 | 9/14/07 | ISSUED FOR PERMITS |
| 56 | 9/14/07 | ISSUED FOR PERMITS |
| 57 | 9/14/07 | ISSUED FOR PERMITS |
| 58 | 9/14/07 | ISSUED FOR PERMITS |
| 59 | 9/14/07 | ISSUED FOR PERMITS |
| 60 | 9/14/07 | ISSUED FOR PERMITS |
| 61 | 9/14/07 | ISSUED FOR PERMITS |
| 62 | 9/14/07 | ISSUED FOR PERMITS |
| 63 | 9/14/07 | ISSUED FOR PERMITS |
| 64 | 9/14/07 | ISSUED FOR PERMITS |
| 65 | 9/14/07 | ISSUED FOR PERMITS |
| 66 | 9/14/07 | ISSUED FOR PERMITS |
| 67 | 9/14/07 | ISSUED FOR PERMITS |
| 68 | 9/14/07 | ISSUED FOR PERMITS |
| 69 | 9/14/07 | ISSUED FOR PERMITS |
| 70 | 9/14/07 | ISSUED FOR PERMITS |
| 71 | 9/14/07 | ISSUED FOR PERMITS |
| 72 | 9/14/07 | ISSUED FOR PERMITS |
| 73 | 9/14/07 | ISSUED FOR PERMITS |
| 74 | 9/14/07 | ISSUED FOR PERMITS |
| 75 | 9/14/07 | ISSUED FOR PERMITS |
| 76 | 9/14/07 | ISSUED FOR PERMITS |
| 77 | 9/14/07 | ISSUED FOR PERMITS |
| 78 | 9/14/07 | ISSUED FOR PERMITS |
| 79 | 9/14/07 | ISSUED FOR PERMITS |
| 80 | 9/14/07 | ISSUED FOR PERMITS |
| 81 | 9/14/07 | ISSUED FOR PERMITS |
| 82 | 9/14/07 | ISSUED FOR PERMITS |
| 83 | 9/14/07 | ISSUED FOR PERMITS |
| 84 | 9/14/07 | ISSUED FOR PERMITS |
| 85 | 9/14/07 | ISSUED FOR PERMITS |
| 86 | 9/14/07 | ISSUED FOR PERMITS |
| 87 | 9/14/07 | ISSUED FOR PERMITS |
| 88 | 9/14/07 | ISSUED FOR PERMITS |
| 89 | 9/14/07 | ISSUED FOR PERMITS |
| 90 | 9/14/07 | ISSUED FOR PERMITS |
| 91 | 9/14/07 | ISSUED FOR PERMITS |
| 92 | 9/14/07 | ISSUED FOR PERMITS |
| 93 | 9/14/07 | ISSUED FOR PERMITS |
| 94 | 9/14/07 | ISSUED FOR PERMITS |
| 95 | 9/14/07 | ISSUED FOR PERMITS |
| 96 | 9/14/07 | ISSUED FOR PERMITS |
| 97 | 9/14/07 | ISSUED FOR PERMITS |
| 98 | 9/14/07 | ISSUED FOR PERMITS |
| 99 | 9/14/07 | ISSUED FOR PERMITS |
| 100 | 9/14/07 | ISSUED FOR PERMITS |