

USER: jkron, TAB: G3.0  
 DRAWING: S:\G35\2007\07-0041\07-0041\07-0041\MASS GRADING PLANS PHASE 2B\0\_G3.0 GRADING PLAN.dwg

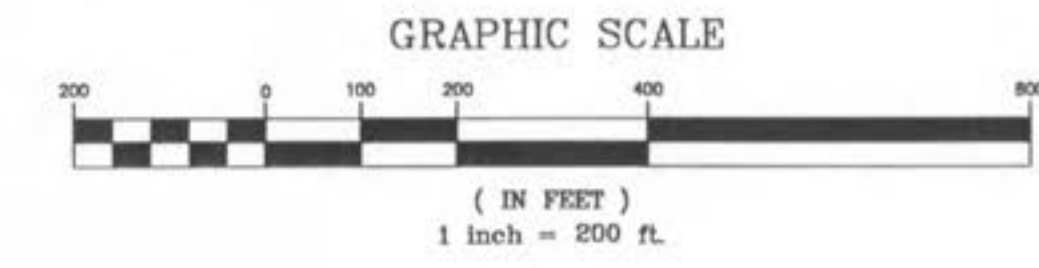
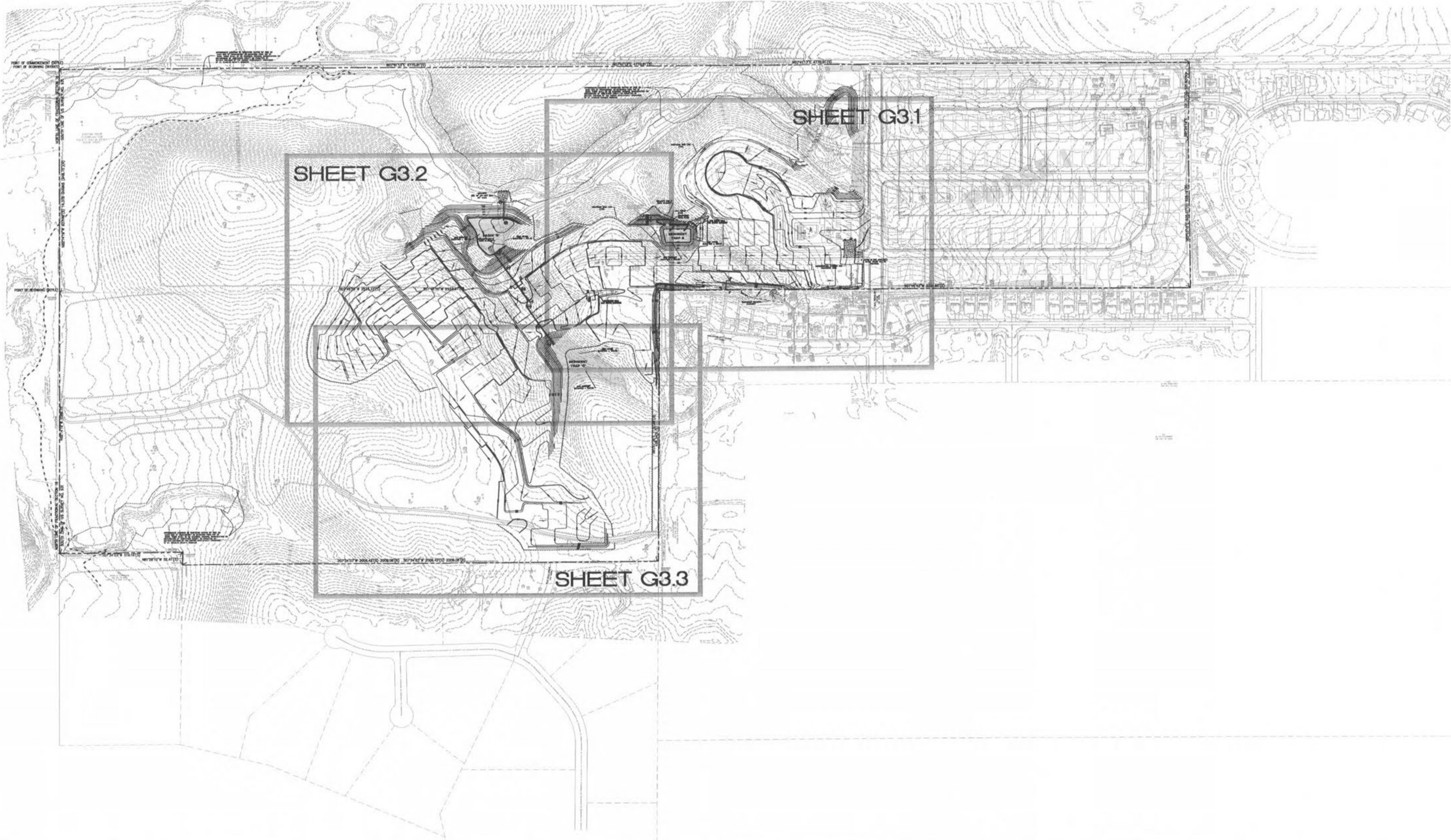

REVISIONS	
DATE	DESCRIPTION
8/13/07	ISSUE
8/13/07	CITY COMMENTS
8/13/07	CITY COMMENTS
8/13/07	CITY COMMENTS

DEVELOPER/OWNER:  
**THE JONES COMPANY HOMES, L.L.C.**  
 16640 CHESTERFIELD GROVE, SUITE 200  
 CHESTERFIELD, MO 63005  
 PHONE: (636) 337-7192

THE PROFESSIONAL, WRITTEN SIGNATURE AND PERSONAL SEAL APPEAR HEREON  
 INDICATE THAT THE DESIGNER HAS REVIEWED THE PLANS AND IS AWARE OF THE  
 ASSUMPTIONS AND LIMITATIONS OF THE DESIGN. THE DESIGNER HAS  
 SPECIFICALLY REVIEWED THE PLANS FOR CONFORMANCE WITH THE  
 SPECIFICATIONS, ESTIMATES, REPORTS, OR OTHER DOCUMENTS OF INSTRUMENTS NOT  
 SHOWN ON THESE PLANS. THE DESIGNER'S REVIEW IS LIMITED TO THE  
 PLANS AND DOES NOT CONSTITUTE A GUARANTEE OR WARRANTY OF ANY KIND.  
 FOR ANY PART OR PARTS OF THE PROJECT TO WHICH THIS SEAL APPLIES.



**PRESTON WOODS - PHASE II**  
 REVISED MASS GRADING PLANS  
 + PARTIAL STORM SEWER  
 ST. CHARLES, MO. 63366

planning • engineering • surveying • landscape architecture  
**Cole and ASSOCIATES**  
 INCORPORATED  
 10777 sunset office dr.  
 saint louis, missouri 63127  
 p. 314 984 9887 f. 314 984 0587

DESIGNED BY: JKW  
 DRAWN BY: JKW  
 CHECKED BY: JFH  
 DATE: 8/13/07  
 Job Number: 07-0041  
 Sheet Number: G3.0

GRADING PLAN INDEX