

USER: I:\proj\TAB\_G4.2\_3\_15.dwg  
DATE: 8/13/07 11:30 AM  
DRAWING: S:\025\025.dwg\PROJECTS\MASS GRADING PLANS PHASE 2B\025.dwg\EROSION CONTROL PLAN.dwg

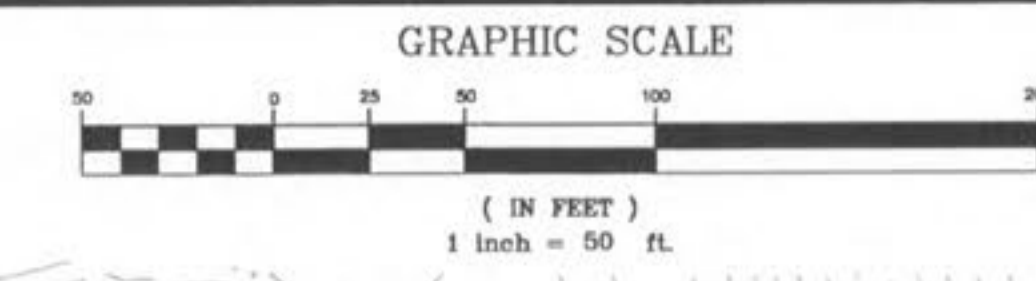
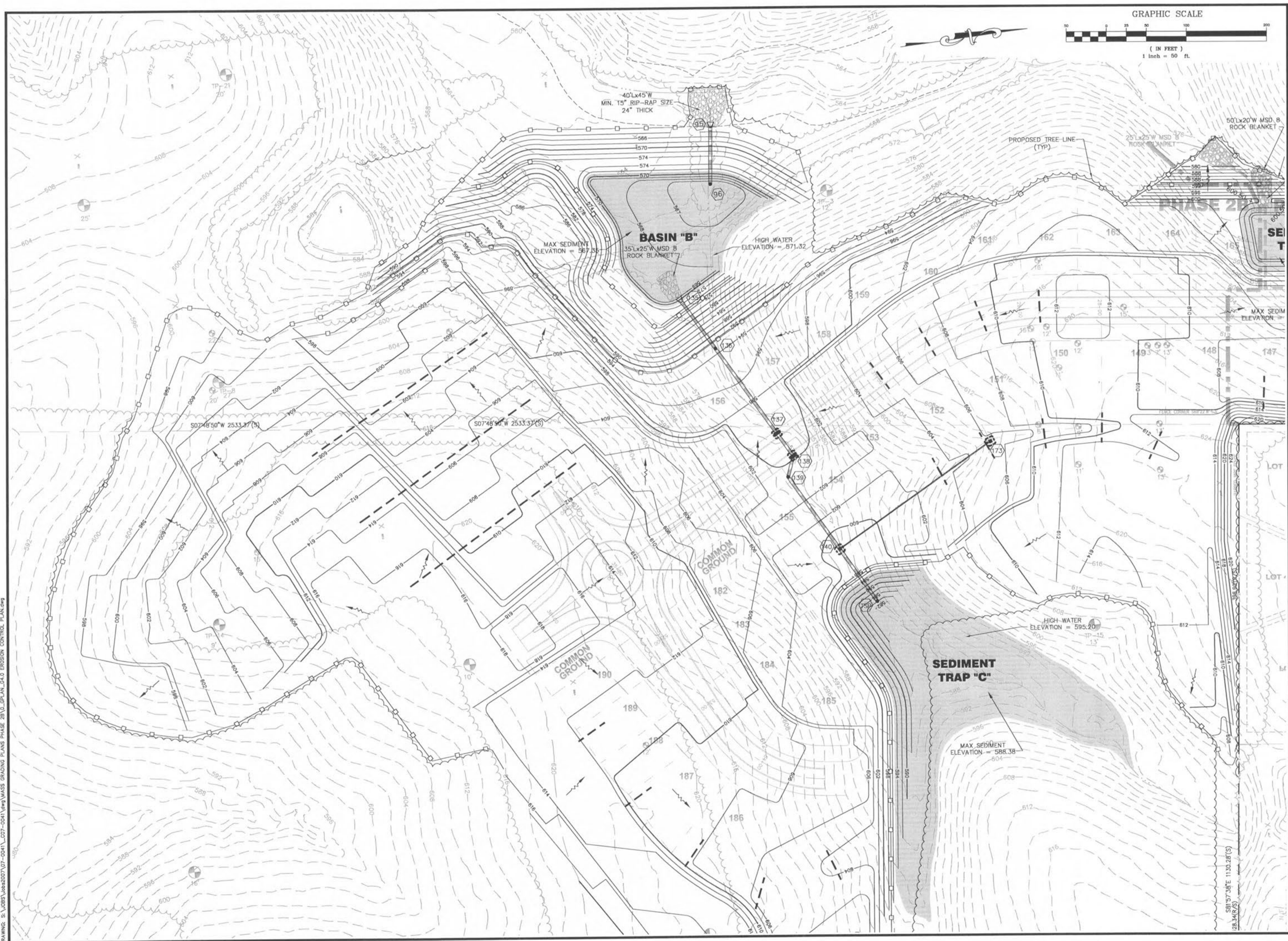

REVISIONS		
DATE	DESCRIPTION	BY
9/12/07	CITY COMMENTS	
9/12/07	CITY COMMENTS	
9/29/07	CITY COMMENTS	

DEVELOPER/OWNER:  
**THE JONES COMPANY HOMES, L.L.C.**  
16640 CHESTERFIELD GROVE, SUITE 200  
CHESTERFIELD, MO 63005  
PHONE: (636) 537-7192

THE PROFESSIONAL ENGINEER'S SIGNATURE AND PERSONAL SEAL APPEAR HEREON.  
ASSUMES RESPONSIBILITY FOR THE DATA SHOWN ON THIS PLAN AND FOR THE ACCURACY  
OF THE INFORMATION AND ESTIMATES THEREON. THE ENGINEER'S SIGNATURE AND SEAL  
IS REQUIRED BY THE BOARD OF REGISTRATION OF PROFESSIONAL ENGINEERS OF  
MISSOURI AND MUST BE PLACED ON THE FRONT OF THIS DRAWING AT THE TIME IT IS  
ISSUED FOR CONSTRUCTION.

**II PRESTON WOODS - PHASE II**  
REVISED MASS GRADING PLANS  
+ PARTIAL STORM SEWER  
ST. CHARLES, MO. 63366  
**EROSION CONTROL PLAN**

planning • engineering • surveying • landscape architecture  
**Cole and Associates Incorporated**  
10777 sunset office dr.  
saint louis, missouri 63127  
p: 314 984 9887 f: 314 984 0587

DESIGNED BY	JKW
DRAWN BY	JKW
CHECKED BY	JFH
DATE	8/13/07
Job Number	07-0041
Sheet Number	G4.2