

USER: jwilson TAB: G5.0
 DATE: Jan 11, 2008 - 7:49am
 DRAWING: S:\085\0852007\07-0178\CD-0178\img\MASS GRADING PLANS PHASE III\0_GPLAN_G5.0 PROFILES.dwg

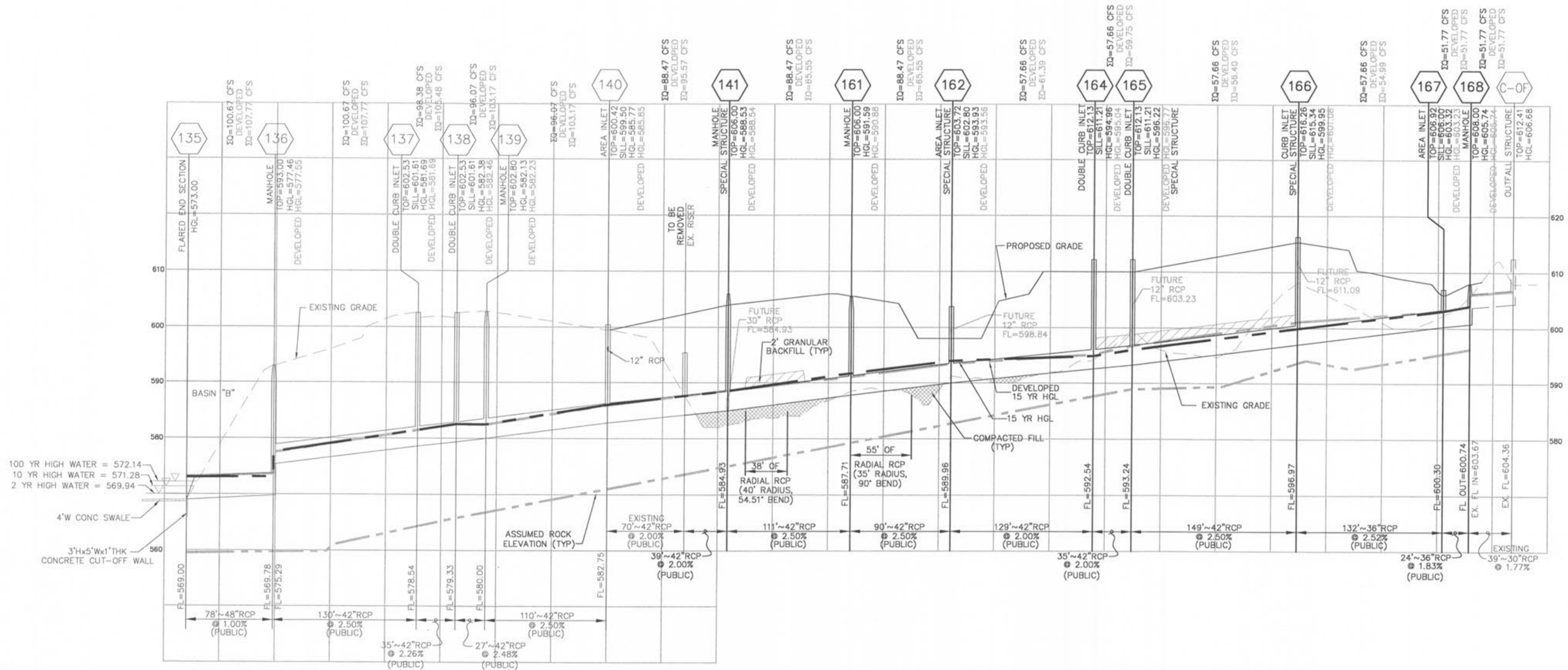

NOTE: CONCRETE PIPE JOINTS SHALL BE MSD TYPE "A" APPROVED COMPRESSION-TYPE JOINTS AND SHALL CONFORM TO THE REQUIREMENTS OF THE SPECIFICATIONS FOR JOINTS FOR CIRCULAR CONCRETE SEWER AND CULVERT PIPE, USING FLEXIBLE, WATERTIGHT, RUBBER-TYPE GASKETS ASTM C443. BAND-TYPE GASKETS DEPENDING ENTIRELY ON CEMENT FOR ADHESION AND RESISTANCE TO DISPLACEMENT DURING JOINTING SHALL NOT BE USED.

ALL STORM SEWER PIPES SHALL BE REINFORCED CONCRETE PIPE, CLASS II MINIMUM. ANY CONCRETE PIPE, CONDUIT, OR CULVERT BENEATH A STREET RIGHT-OF-WAY OR WITH REASONABLE PROBABILITY OF BEING SO LOCATED SHALL BE A MINIMUM OF CLASS III, BUT ALSO SHALL ACCOUNT FOR ALL VERTICAL LOADS. IN NO CASE SHALL THE DESIGN PROVIDE FOR LESS THAN HS-20 LOADING PER AASHTO. FOR OTHER LOCATIONS, THE MINIMUM DESIGN LIVE LOAD SHALL BE THE HS-10 LOADING.

STORM SEWER PIPES WHICH CROSS OVER EXISTING OR PROPOSED SANITARY SEWER TRENCHES SHALL BE CRADLED IN CONCRETE THROUGH THE FULL WIDTH OF THE SANITARY SEWER TRENCH. THE TRENCH SHALL BE BACKFILLED AND COMPACTED WITH GRANULAR FILL TO THE BOTTOM OF THE CONCRETE CRADLE.

IF THE STORM AND SANITARY SEWERS ARE PARALLEL AND IN THE SAME TRENCH OR OVER-DIG, THE UPPER PIPE SHALL BE PLACED ON A SHELF AND THE LOWER PIPE SHALL BE BEDDED IN COMPACTED GRANULAR FILL TO THE FLOWLINE OF THE UPPER PIPE.

BRICK SHALL NOT BE USED IN THE CONSTRUCTION OF STORM SEWER STRUCTURES

ALL CONCRETE PIPES WILL BE INSTALLED WITH O-RING RUBBER TYPE GASKETS

CONNECTIONS AT ALL STORM SEWER STRUCTURES TO BE MADE WITH A-LOK JOINT OR EQUAL.

SCALE: 1" = 50' HORIZ.
 1" = 10' VERT.

planning • engineering • surveying • landscape architecture
Cole and ASSOCIATES
 INCORPORATED
 10777 sunset office dr.
 saint louis, missouri 63127
 p. 314 984 9887 f. 314 984 0587

DESIGNED BY
 JKW
 DRAWN BY
 JKW
 CHECKED BY
 JFH
 DATE
 8/13/07

Job Number
 07-0178
 Sheet Number
 G5.0

PRESTON WOODS - PHASE III
 MASS GRADING PLANS
 + PARTIAL STORM SEWER
 ST. CHARLES, MO. 63366

STORM PROFILES

SEAL: MIKE E. WUNDERHEIDE
 REGISTERED PROFESSIONAL ENGINEER
 NUMBER E-23977
 1/23/08

DEVELOPER/OWNER:
 THE JONES COMPANY HOMES, L.L.C.
 16640 CHESTERFIELD GROVE, SUITE 200
 CHESTERFIELD, MO 63005
 PHONE: (636) 537-7192

DATE	REVISIONS
12/29/07	OWNER COMMENTS/CITY COMMENTS
1/17/08	CITY COMMENTS