

USER: Taylor, Stuart TAB: Preston WoodFinal  
 DATE: May 27, 2013 11:41 AM  
 DRAWING: C:\Users\stuart\Documents\2013\13-0109\CAD\DWG\C-04\VP-PHASE7A\_0\_P\_RPT\_STREET\_PROFILE.dwg

# PRESTON WOODS TRAIL

(PUBLIC 42' ROW, 26' PVMT)

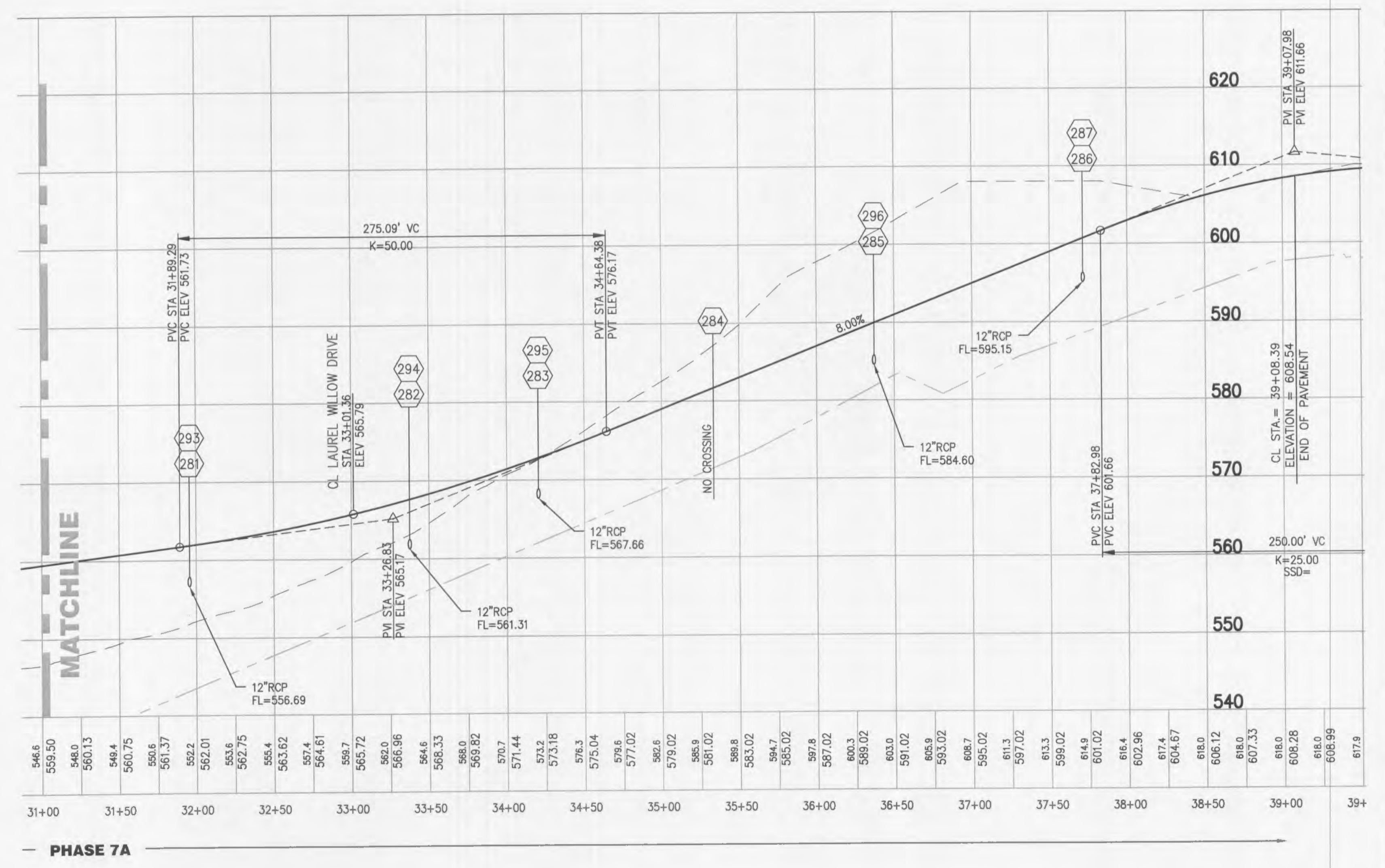
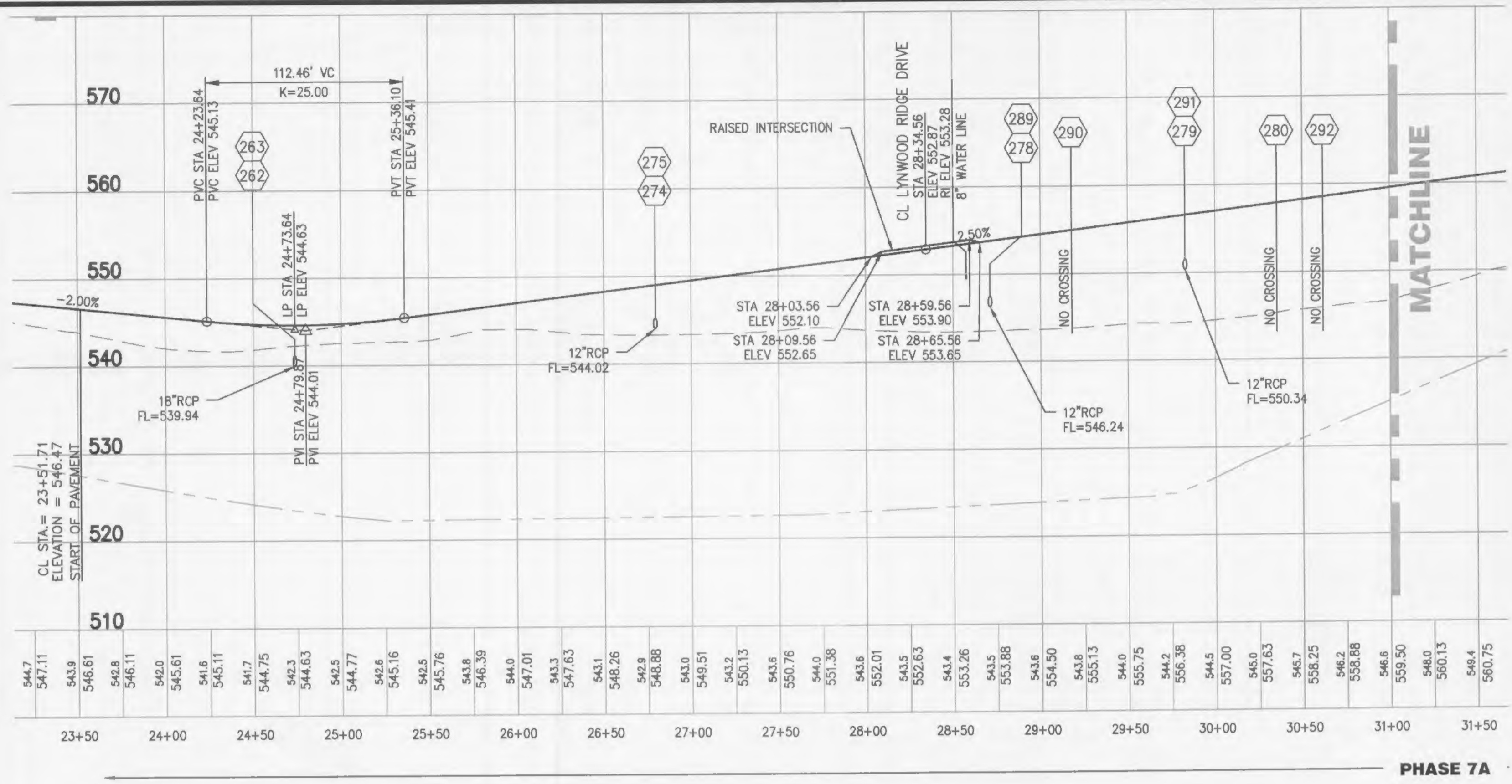

SCALE: 1" = 50' HORIZ.  
 1" = 10' VERT.

DEVELOPER/OWNER:  
**PULTE GROUP**  
 1707 CHESTERFIELD AIRPORT RD, STE 120  
 CHESTERFIELD, MO 63005  
 PHONE: (636) 537-7129

CIVIL ENGINEERS  
 CORPORATE  
 ENGINEERING  
 NUMBER  
 #001185

JOHN F. GYER  
 PE NO. E-29718

DATE: 5/27/13

NO. REVISION DESCRIPTION

1	NO. REVISION DESCRIPTION
2	CITY COMMENTS
3	CITY COMMENTS
4	CITY COMMENTS
5	CITY COMMENTS
6	CITY COMMENTS
7	CITY COMMENTS
8	CITY COMMENTS
9	CITY COMMENTS
10	CITY COMMENTS
11	CITY COMMENTS
12	CITY COMMENTS
13	CITY COMMENTS
14	CITY COMMENTS
15	CITY COMMENTS
16	CITY COMMENTS
17	CITY COMMENTS
18	CITY COMMENTS
19	CITY COMMENTS
20	CITY COMMENTS
21	CITY COMMENTS
22	CITY COMMENTS
23	CITY COMMENTS
24	CITY COMMENTS
25	CITY COMMENTS
26	CITY COMMENTS
27	CITY COMMENTS
28	CITY COMMENTS
29	CITY COMMENTS
30	CITY COMMENTS
31	CITY COMMENTS
32	CITY COMMENTS
33	CITY COMMENTS
34	CITY COMMENTS
35	CITY COMMENTS
36	CITY COMMENTS
37	CITY COMMENTS
38	CITY COMMENTS
39	CITY COMMENTS
40	CITY COMMENTS
41	CITY COMMENTS
42	CITY COMMENTS
43	CITY COMMENTS
44	CITY COMMENTS
45	CITY COMMENTS
46	CITY COMMENTS
47	CITY COMMENTS
48	CITY COMMENTS
49	CITY COMMENTS
50	CITY COMMENTS
51	CITY COMMENTS
52	CITY COMMENTS
53	CITY COMMENTS
54	CITY COMMENTS
55	CITY COMMENTS
56	CITY COMMENTS
57	CITY COMMENTS
58	CITY COMMENTS
59	CITY COMMENTS
60	CITY COMMENTS
61	CITY COMMENTS
62	CITY COMMENTS
63	CITY COMMENTS
64	CITY COMMENTS
65	CITY COMMENTS
66	CITY COMMENTS
67	CITY COMMENTS
68	CITY COMMENTS
69	CITY COMMENTS
70	CITY COMMENTS
71	CITY COMMENTS
72	CITY COMMENTS
73	CITY COMMENTS
74	CITY COMMENTS
75	CITY COMMENTS
76	CITY COMMENTS
77	CITY COMMENTS
78	CITY COMMENTS
79	CITY COMMENTS
80	CITY COMMENTS
81	CITY COMMENTS
82	CITY COMMENTS
83	CITY COMMENTS
84	CITY COMMENTS
85	CITY COMMENTS
86	CITY COMMENTS
87	CITY COMMENTS
88	CITY COMMENTS
89	CITY COMMENTS
90	CITY COMMENTS
91	CITY COMMENTS
92	CITY COMMENTS
93	CITY COMMENTS
94	CITY COMMENTS
95	CITY COMMENTS
96	CITY COMMENTS
97	CITY COMMENTS
98	CITY COMMENTS
99	CITY COMMENTS
100	CITY COMMENTS

PRESTON WOODS  
 PHASE 7  
 IMPROVEMENT PLANS  
 PRESTON WOODS LANE  
 O'FALLON, IL 63396

STREET PROFILES

+ ST. CHARLES  
 1270 S. Effin Street  
 Suite 307  
 St. Charles, MO 63033  
 636.978.7508 fax  
 636.978.7508 tel

**COLE**  
 CIVIL ENGINEERING / SURVEYING / PLANNING / LANDSCAPE ARCHITECTURE  
 Cole & Associates, Inc.

DESIGN/CALC BY: MTS  
 DRAWN BY: MTS  
 CHECKED BY: JFH  
 DRAWING SCALE: -  
 DATE: 01/07/2013  
 Job Number: 13-0109  
 Sheet Number: C6.1