

USER: Taylor, Stuart; TAB: Storm (4)
 DATE: May 22, 2014 - 2:22:08 PM
 DRAWING: S:\0085\Job2013\13-0109\CAD-DWG\C-DWG-PLAN-IMP-PROFILES.dwg

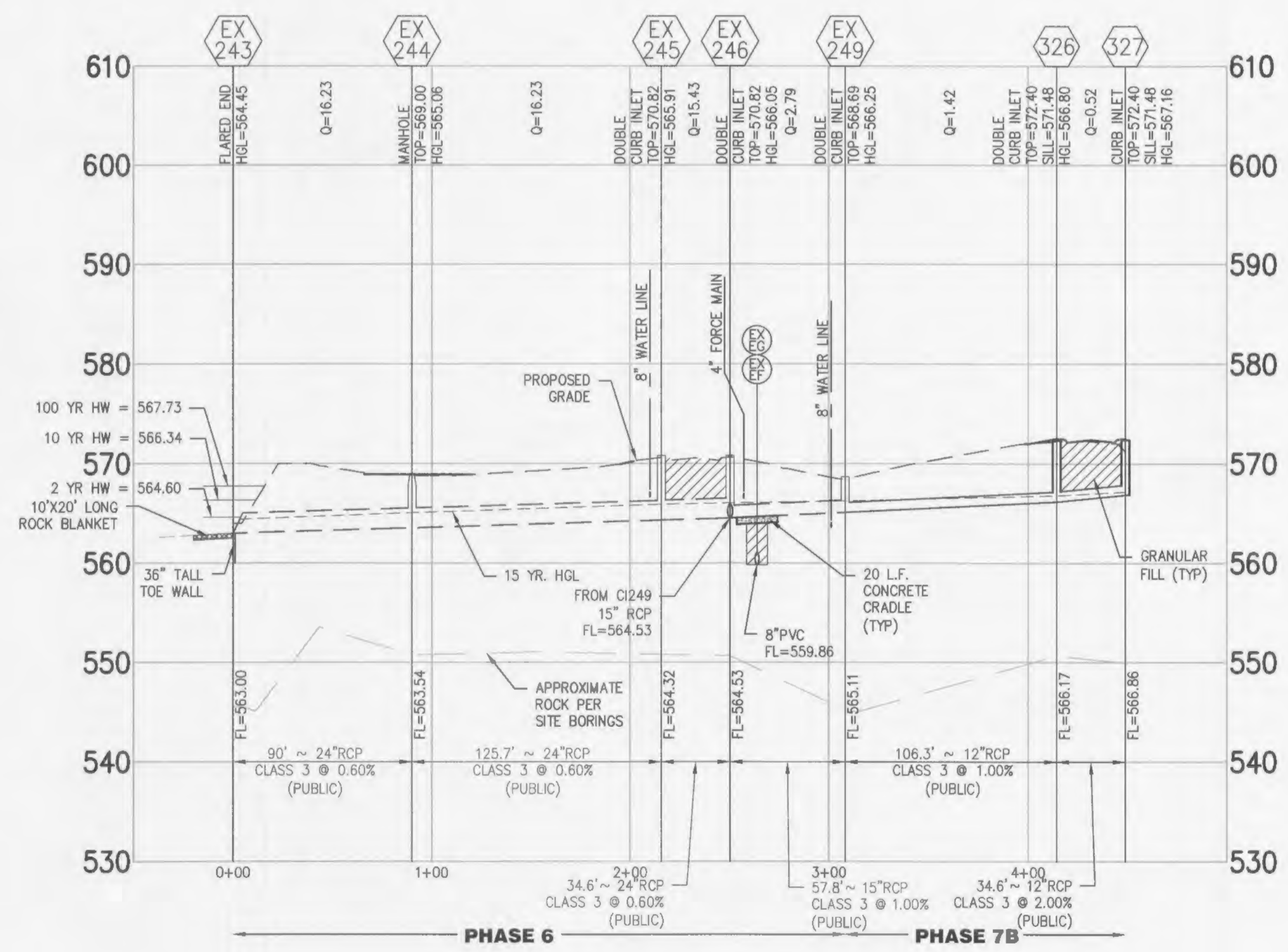
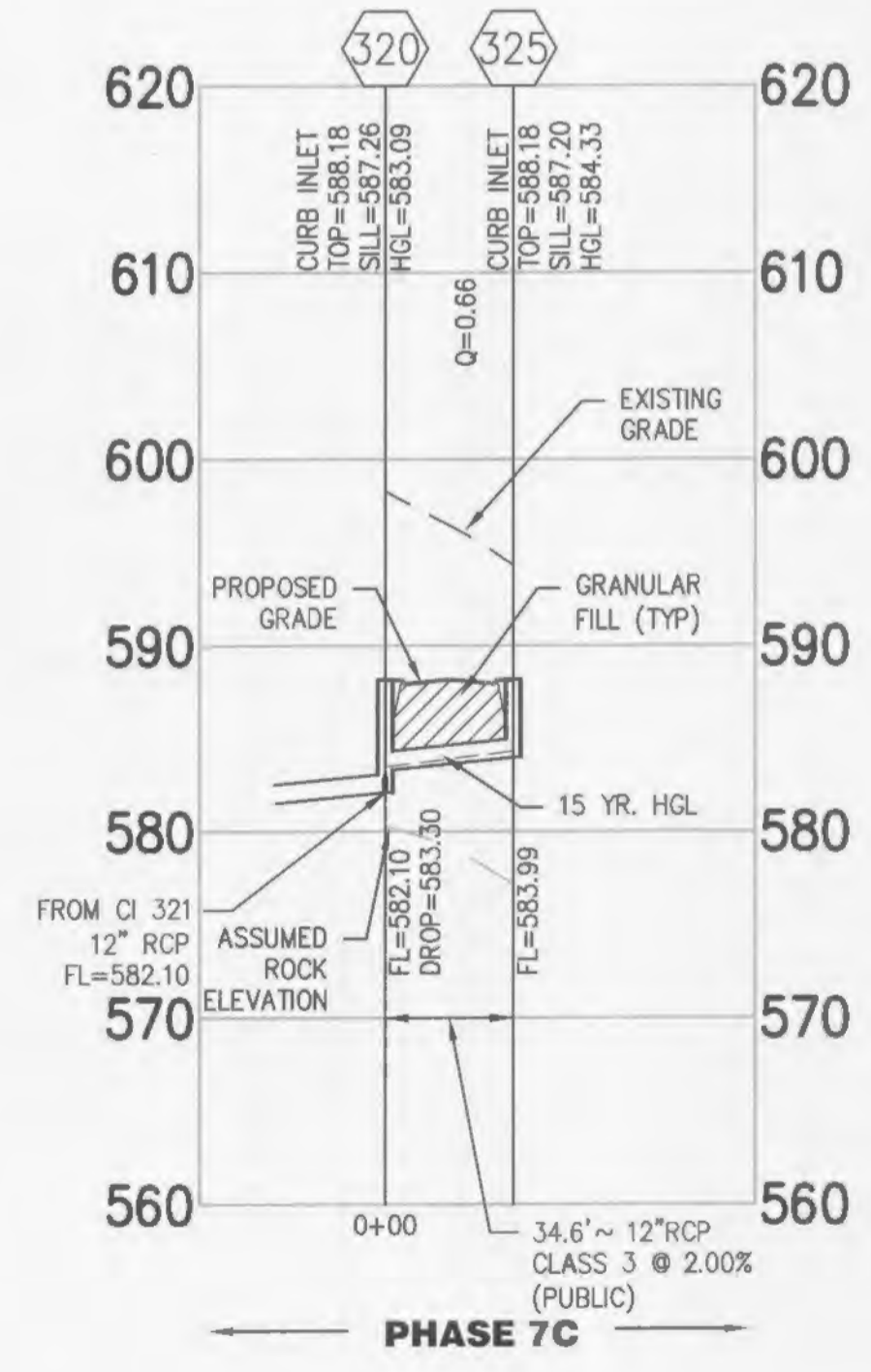
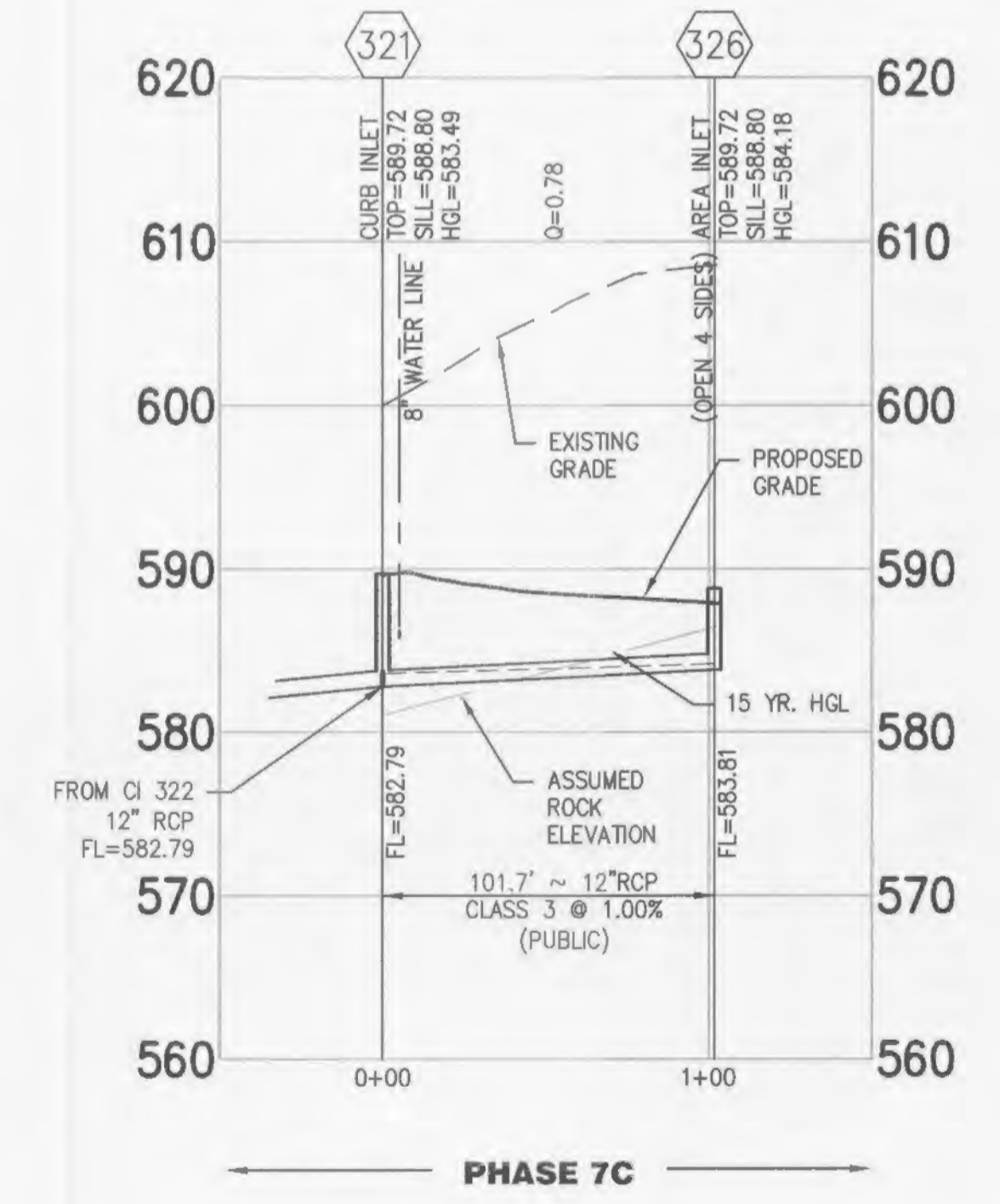
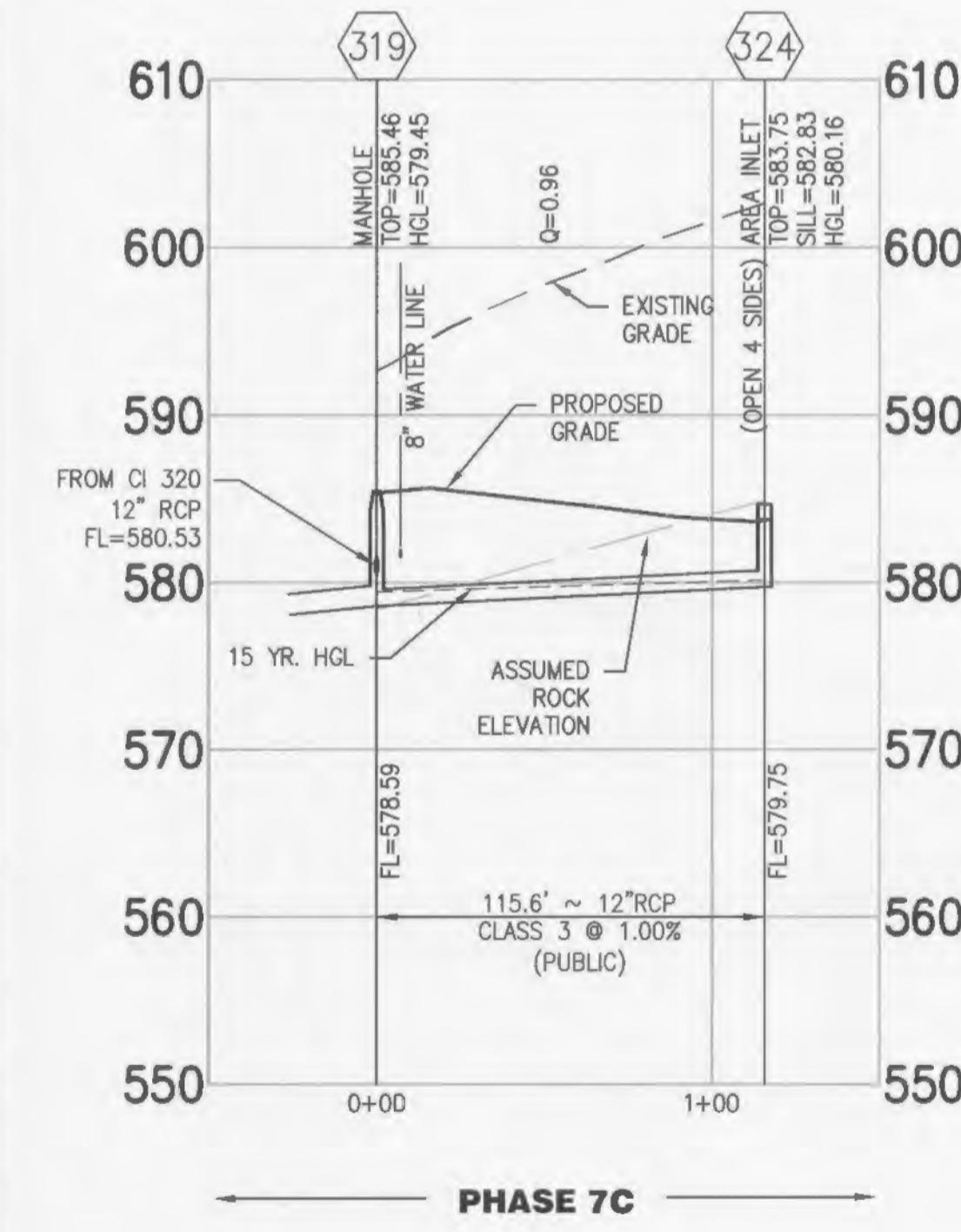
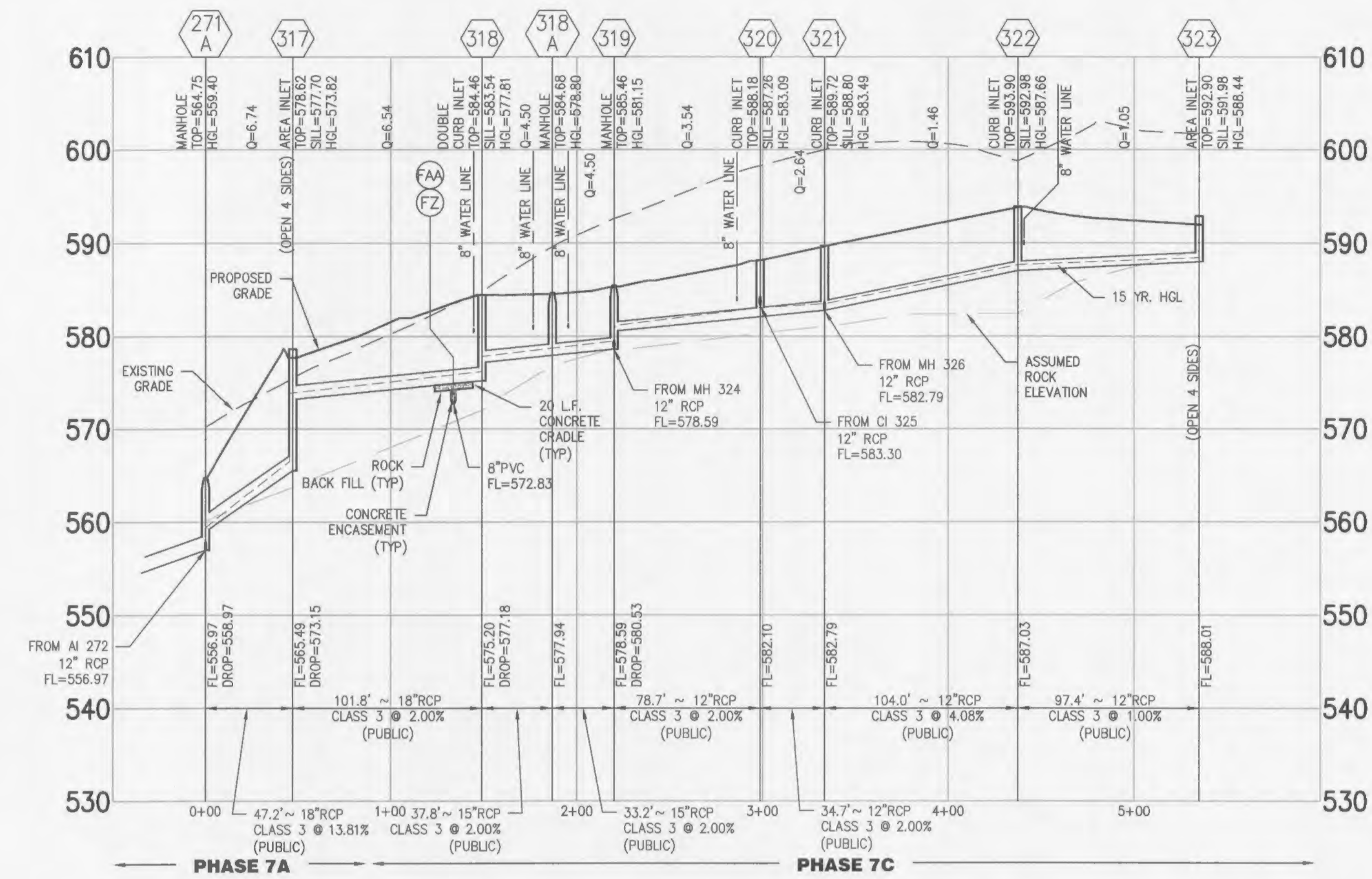
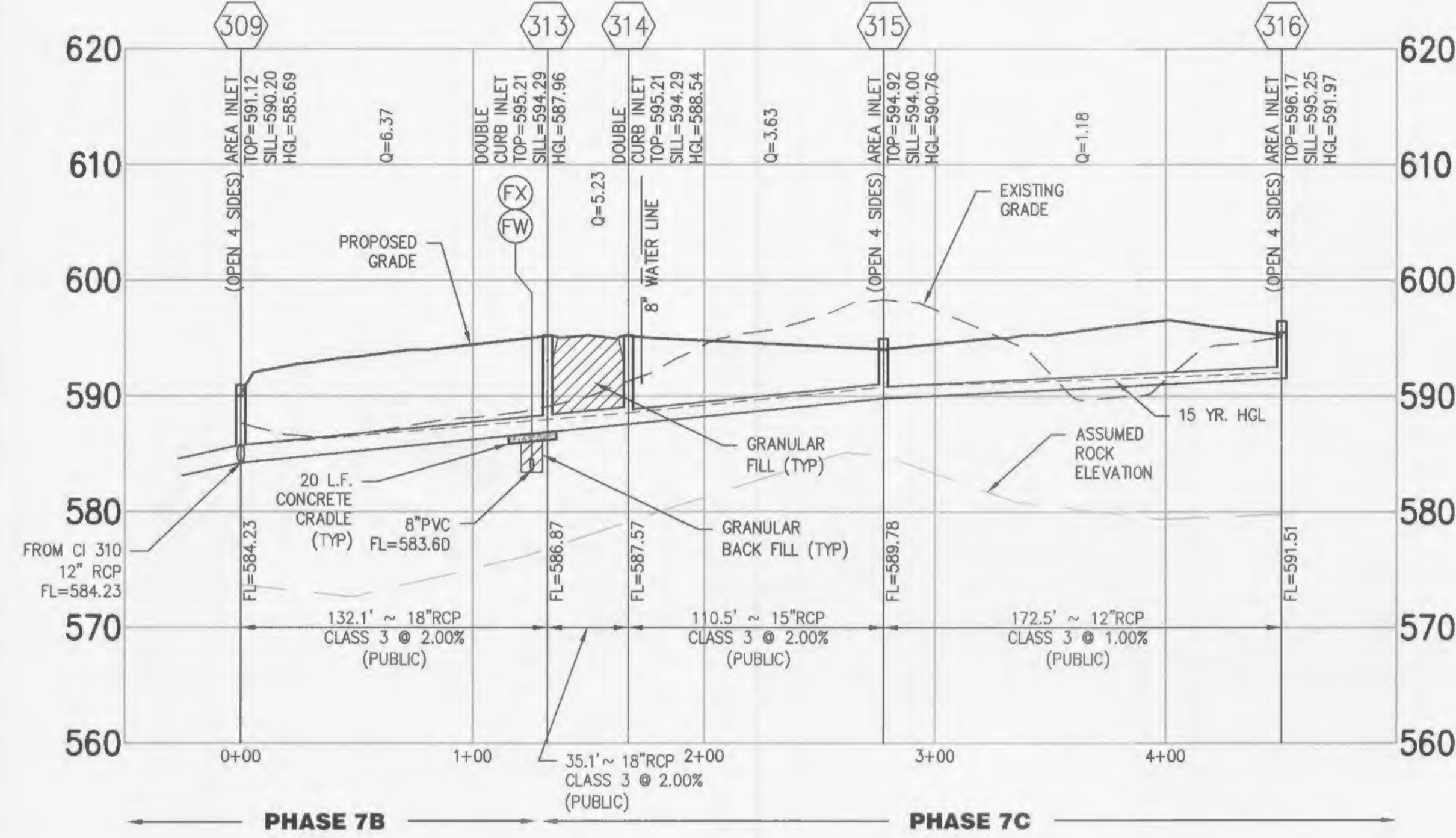

1 STORM SEWER PROFILES
 SCALE: 1"=50' HORIZ. 1"=10' VERT. REF. DWG.

NOTE: ALL STORM SEWER STRUCTURES SHALL HAVE POSITIVE FLOW THROUGH THE STRUCTURE.

SCALE: 1" = 50' HORIZ.
 1" = 10' VERT.

DEVELOPER/OWNER:
PULTE GROUP
 1707 CHESTERFIELD AIRPORT RD, STE 120
 CHESTERFIELD, MO 63005
 PHONE: (636) 537-7129

CIVIL ENGINEERS
 JOHN F. HARSCHBARGER
 NUMBER E-29716
 REGISTERED PROFESSIONAL ENGINEER
 STATE OF MISSOURI

DATE: 5/27/14

3 CITY COMMENTS
 2 CITY, DSDS & WATER COMMENTS
 1 CITY, DSDS, WATER & FIRE COMMENTS

NO REVISION DESCRIPTION

PRESTON WOODS
 PHASE 7
 IMPROVEMENT PLANS
 PRESTON WOODS, LAKE
 O'FALLON, MO 63366

STORM PROFILES

ST. CHARLES
 1520 S. Fifth Street
 Suite 307
 St. Charles, MO 63303
 636.978.7508 Tel
 636.978.7508 Fax

cole
 CIVIL ENGINEERING / SURVEYING / PLANNING / LANDSCAPE ARCHITECTURE
 Cole & Associates, Inc.

DESIGN/CALC BY: JFH
 DRAWN BY: MTS
 CHECKED BY: JFH
 DRAWING SCALE: -
 DATE: 01/07/2013

Job Number
13-0109

Sheet Number
C7.7