

TRAPEZOIDAL CHANNEL ANALYSIS
NORMAL DEPTH COMPUTATION

March 25, 2014

DESCRIPTION	PROGRAM INPUT DATA	VALUE
Flow Rate (cfs)		6.54
Channel Bottom Slope (ft/ft)		0.07
Manning's Roughness Coefficient (n-value)		0.027
Channel Left Side Slope (horizontal/vertical)		5.0
Channel Right Side Slope (horizontal/vertical)		5.0
Channel Bottom Width (ft)		3.0

DESCRIPTION	COMPUTATION RESULTS	VALUE
Normal Depth (ft)		0.28
Flow Velocity (fps)		5.19
Froude Number		1.972
Velocity Head (ft)		0.42
Energy Head (ft)		0.7
Cross-Sectional Area of Flow (sq ft)		1.26
Top Width of Flow (ft)		5.85

HYDROCALC Hydraulics for Windows, Version 1.2a Copyright (c) 1996
Dodson & Associates, Inc., 5629 FM 1960 West, Suite 314, Houston, TX 77069
Phone: (281) 440-3787, Fax: (281) 440-4742, Email: software@dodson-hydro.com
All Rights Reserved.

2 CHANNEL ANALYSIS LOTS 468-469
SCALE: N.T.S. REF. DWG.



2 EMERGENCY SPILLWAY DETAIL
SCALE: N.T.S. REF. DWG.

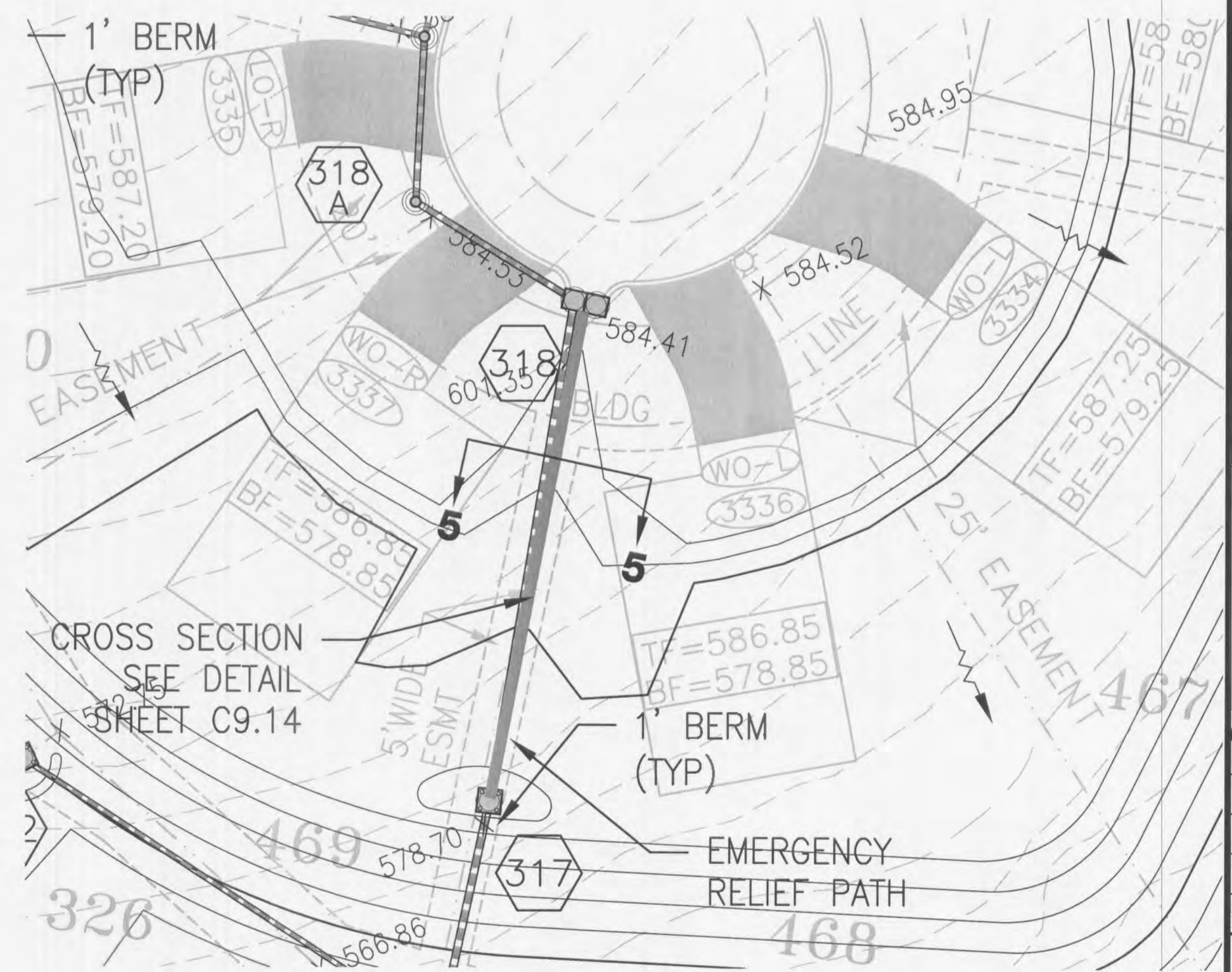

1 EMERGENCY SPILLWAY
SCALE: 1"=20' REF. DWG.

NO	DATE	REVISION DESCRIPTION
1	5/07/14	CITY COMMENTS
2	5/07/14	CITY, DSSA, WATER COMMENTS
1	3/26/14	CITY, DSSA, WATER & FIRE COMMENTS
NO		REVISION DESCRIPTION

DEVELOPER/OWNER:
PULTE GROUP
1707 CHESTERFIELD AIRPORT RD. SITE 120
CHESTERFIELD, MO 63005
PHONE: (636) 537-7129

THE PROFESSIONAL WHOSE SIGNATURE AND PERSONAL SEAL APPEAR HEREON
CERTIFIES THAT HE HAS PREPARED THIS PLAN AND DESIGN IN ACCORDANCE
WITH THE PROFESSIONAL ENGINEERING ACT AND THE RULES AND REGULATIONS
OF THE BOARD OF PROFESSIONAL ENGINEERS AND SURVEYORS OF THE STATE OF
MISSOURI. HE FURTHER CERTIFIES THAT HE IS NOT PROVIDING ANY SERVICES
OTHER THAN THOSE FOR WHICH HE IS LICENSED AND THAT HE IS NOT PROVIDING
ANY SERVICES FOR WHICH HE IS NOT LICENSED. THIS PLAN AND DESIGN IS NOT
TO BE USED FOR ANY OTHER PROJECT OR PART OF THE PROJECT TO WHICH THIS
PLAN AND DESIGN IS REFERRED TO BE USED.

CIVIL ENGINEERS
CORPORATE
ENGINEERING
CERTIFICATE
#00118

JOHN F. HARSHBARGER
E-29716

PROFESSIONAL ENGINEER
REGISTERED

DATE: 5/12/14

**PRESTON WOODS
PHASE 7
IMPROVEMENT PLANS**
PRESTON WOODS LANE
OF FALLON, MO 63386

EMERGENCY SPILLWAY

+ ST. CHARLES
12345 Fifth Street
St. Charles, MO 63303
636.978.7598 (or
636.978.7598 (or

COLE
CIVIL ENGINEERING / SURVEYING / PLANNING / LANDSCAPE ARCHITECTURE
Cole & Associates, Inc.

DESIGN/CALC BY: JFH
DRAWN BY: MTS
CHECKED BY: JFH
DRAWING SCALE: -
DATE: 01/07/2013
Job Number: 13-0109
Sheet Number

C9.14

USER: hofe Smart TAB - DETAILS 14
DRAWING: S:\GIS\Jobs\2013\13-0109\CSD-DWG1.C-04A (P-PHASE) D.P. PH7-DETAILS.dwg