

NOTE: THIS LOT DOES NOT HAVE AN EXISTING IRRIGATION SYSTEM.

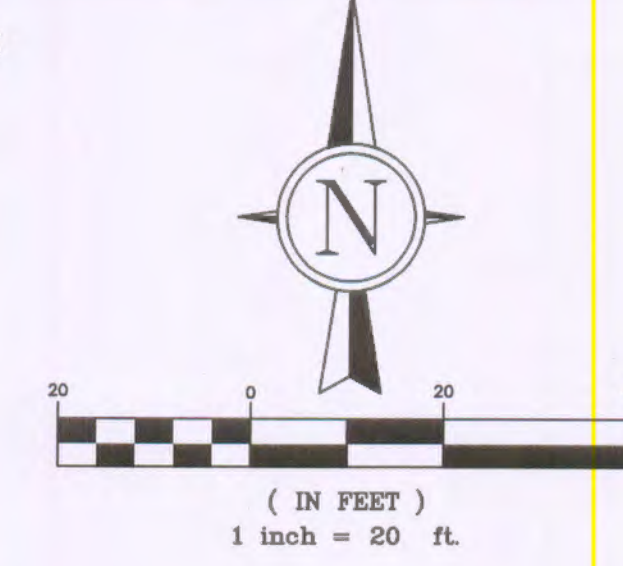

NOTE: CLEARING LIMITS SHALL BE VISIBLY MARKED IN THE FIELD PRIOR TO REMOVAL OF TREES.

**GENERAL DEMOLITION NOTES:**

1. THE UTILITIES SHOWN HEREIN WERE PLOTTED FROM AVAILABLE INFORMATION AND DO NOT NECESSARILY REFLECT THE ACTUAL EXISTENCE, NONEXISTENCE, SIZE, TYPE, OR LOCATION OF THESE OR OTHER UTILITIES. THE CONTRACTOR SHALL BE RESPONSIBLE FOR VERIFYING THE ACTUAL LOCATION OF ALL UTILITIES, SHOWN OR NOT SHOWN, AND SAID UTILITIES SHALL BE LOCATED IN THE FIELD PRIOR TO ANY CONSTRUCTION OF IMPROVEMENTS.  
CONTRACTOR MUST CONTACT TEXAS ONE-CALL (811) FOR UTILITY LOCATIONS BEFORE PERFORMING ANY EXCAVATION ON THE SITE.  
CONTRACTOR TO CONTACT ALL SEWER, GAS, TELEPHONE, WATERLINE AND ANY OTHER UTILITIES PRIOR TO CONSTRUCTION. ALL CONNECTIONS OR REPAIRS ARE TO BE MADE IN ACCORDANCE WITH LOCAL CODES AND/OR UTILITY COMPANIES REQUIREMENTS.
2. GENERAL CONTRACTOR RESPONSIBLE TO COORDINATE DEMOLITION, RELOCATING, DISCONNECTING, AND CAPPING OF ALL EXISTING UTILITIES PRIOR TO DEMOLITION WITH APPROPRIATE UTILITY COMPANY.
3. DUE CARE IS TO BE TAKEN TO AVOID UNDUE DAMAGE TO ADJACENT STRUCTURES/FINISHES AND SCHEDULED ITEMS TO REMAIN.
4. GENERAL CONTRACTOR TO REMOVE ALL DEBRIS, RUBBISH, AND OTHER MATERIAL RESULTING FROM DEMOLITION OPERATIONS FROM THE BUILDING SITE. COORDINATE LOCATION OF DUMPSTER WITH OWNER PRIOR TO ITS DELIVERY. ALL DEBRIS REMOVED FROM SITE SHALL BE DISPOSED OF IN ACCORDANCE WITH ALL STATE AND LOCAL REQUIREMENTS IN A LICENSED DEMOLITION LANDFILL.
5. IF UNANTICIPATED ELECTRICAL, PLUMBING, OR STRUCTURAL ELEMENTS ARE ENCOUNTERED WHICH CONFLICT WITH THE INTENDED FUNCTION OR DESIGN, NOTIFY ENGINEER IMMEDIATELY.
6. GENERAL CONTRACTOR TO COORDINATE ALL PHASING OF DEMOLITION AND NEW CONSTRUCTION WITH CONSTRUCTION MANAGER.
7. PROMPTLY REPAIR DAMAGES TO ADJACENT AREAS SCHEDULED TO REMAIN CAUSED BY DEMOLITION WORK.
8. ALL SEWER STRUCTURES TO BE ABANDONED SHALL HAVE THE STRUCTURE COMPLETELY REMOVED. ALL PIPES TO THE STRUCTURE SHALL BE CAPPED.
9. ALL EXISTING SEWER STRUCTURES TO BE USED IN PLACE (U.I.P.) SHALL BE PROTECTED BY THE PLACEMENT OF BARRICADES OR A SIMILAR DEVICE AROUND THE STRUCTURE.

**PROJECT TITLE**  
**PRIMROSE SCHOOL OF O'FALLON AT WINGHAVEN**  
 7778 WINGHAVEN BLVD, O'FALLON, MISSOURI

**GRIMES CONSULTING, INC.**  
 Civil Engineering & Surveying Services  
 12300 OLD TESSON ROAD SUITE 3000  
 PHOENIX, ARIZONA 85128  
 PH: (314) 849-6100 FAX: (314) 849-6010  
 www.grimesconsulting.com  
 CONTACT: LEMMY MEERS EMAIL: lemmy@grimesconsulting.com

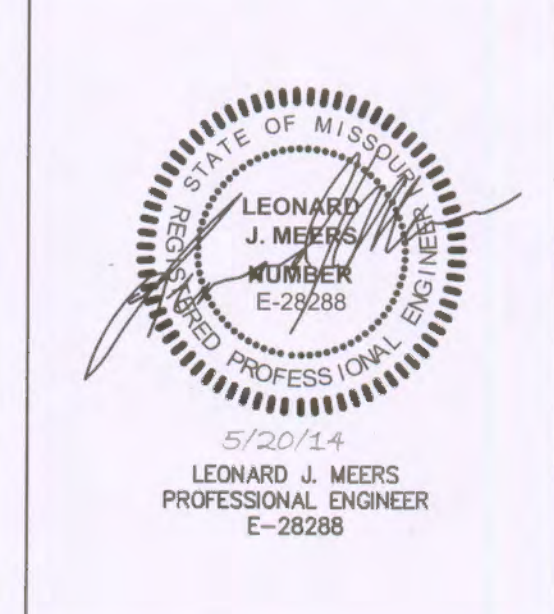

**Developer / Owner Information**  
**EVERGREEN**  
 2390 E CAMELBACK RD, PHOENIX, ARIZONA  
 24 Hr. Emergency Contact: ALEX GONZALEZ  
 Phone: (602) 906-8600 Fax: (602) 367-7101  
 Email: ogonzale@evergre.com

**P+Z No.** 983154.03  
**City No.** TBD  
**Page No.** C5  
 GC# 1482D