

- GENERAL NOTES:**
- REFER TO SHEETS C22, "ROUND-ABOUT WARPING AT PROGRESS POINT PKWY", AND C23, "ROUND-ABOUT WARPING AT WATERBURY FALLS DRIVE", FOR MORE DETAILS AT ROUND-ABOUTS.
  - PAVEMENT REMOVAL SHOWN ALONG WELDON SPRING ROAD SHALL OCCUR AFTER COMPLETION OF CONSTRUCTION OF WATERBURY FALLS, TECHNOLOGY DRIVE AND PROGRESS POINT PKWY, AS INDICATED ON THESE DRAWINGS. NO PAVEMENT REMOVAL SHALL OCCUR, EXCEPT AS REQUIRED FOR SEWER INSTALLATION OR NEW ROAD CONSTRUCTION, UNTIL CITY APPROVAL IS OBTAINED FOR THE SPECIFIED PAVEMENT REMOVAL AND THE R.O.W. IS VACATED.

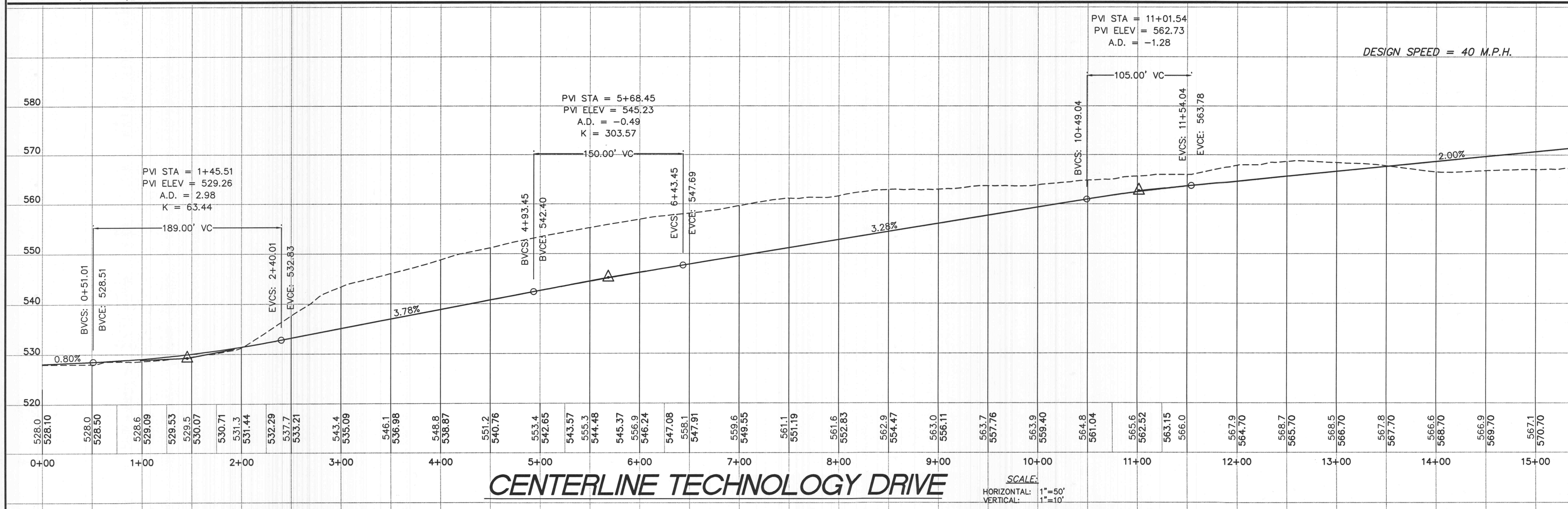

STATE OF MISSOURI  
 GEORGE MICHAEL STOCK  
 NUMBER E-25116  
 REGISTERED PROFESSIONAL ENGINEER

GEORGE MICHAEL STOCK E-25116  
 Civil Engineer

**STOCK & ASSOCIATES**  
 CONSULTING ENGINEERS, INC.

425 NORTH NEW BALLAS ROAD  
 SUITE 165  
 ST. LOUIS, MO. 63141  
 PH. (314) 432-8100  
 FAX (314) 432-8171  
 e-mail: general@stockassoc.com

Architect  
 Structural Engineer  
 Fire Protection Engineer  
 Plumbing Engineer  
 Mechanical Engineer  
 Electrical Engineer

**CLAYCO**

CLAYCO CONSTRUCTION COMPANY  
 2199 Innerbelt Business Center Dr.  
 St. Louis, MO 63114  
 Ph 314.429.5100 Fx 314.429.3165

**TRISTAR**  
 BUSINESS COMMUNITIES

TRISTAR BUSINESS COMMUNITIES  
 13397 Lakefront Drive  
 St. Louis, MO. 63045  
 Ph 314.291.0814

**Progress Point**  
 O'Fallon, MO

Rev. No.	Description	Date
1	ISSUED	11-05-01
2	CITY & DUCKETT CREEK	12-28-01
3	CITY & DUCKETT CREEK	02-08-02
4	CITY & DUCKETT CREEK	03-18-02
5	CITY COMMENTS	04-18-02
6	CITY COMMENTS	04-29-02
7	REV. CONSTR. SEQUENCE	05-23-02
8	CITY COMMENTS	07-15-02
9	FIELD COORD.	07-23-02
10	FIELD COORD.	08-02-02
11	NEW LIGHTING PLAN	11-18-02

The Professional Engineer's seal affixed to this sheet indicates that the named Engineer has prepared or directed the preparation of the material shown only on this sheet. Other drawings and documents not exhibiting this seal shall not be considered prepared by or the responsibility of the undersigned.

Drawing Title  
**TECHNOLOGY DRIVE**  
**PLAN AND PROFILE**

Drawing No.  
**C7**

Scale  
 1"=50'

Dwg By: PKB  
 Check By: GMS  
 Clayco 200 No.: 1-101-031  
 Consult. No.: 200-2180.2

F:\Draw\12K\Draw\2100\21002180\PLANS\07-TECH.dwg Tue Nov 19 08:30:44 2002 Jrbth Stock & Assoc.