

**PROPOSED 12" WATER LINE PROFILE #1**

HORIZONTAL SCALE: 1"=50'  
VERTICAL SCALE: 1"=10'

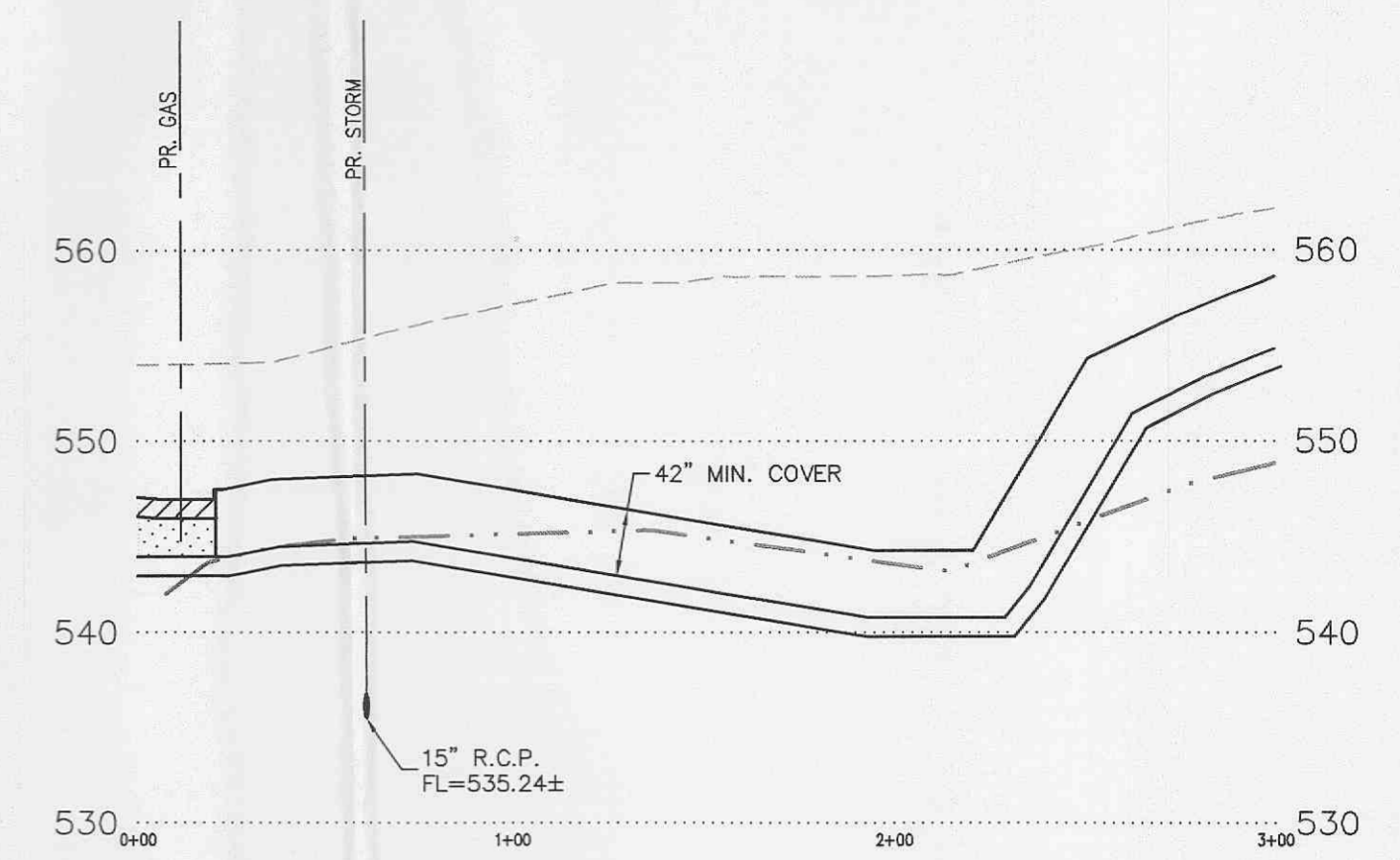

**PROPOSED 12" WATER LINE PROFILE #2**

HORIZONTAL SCALE: 1"=50'  
VERTICAL SCALE: 1"=10'

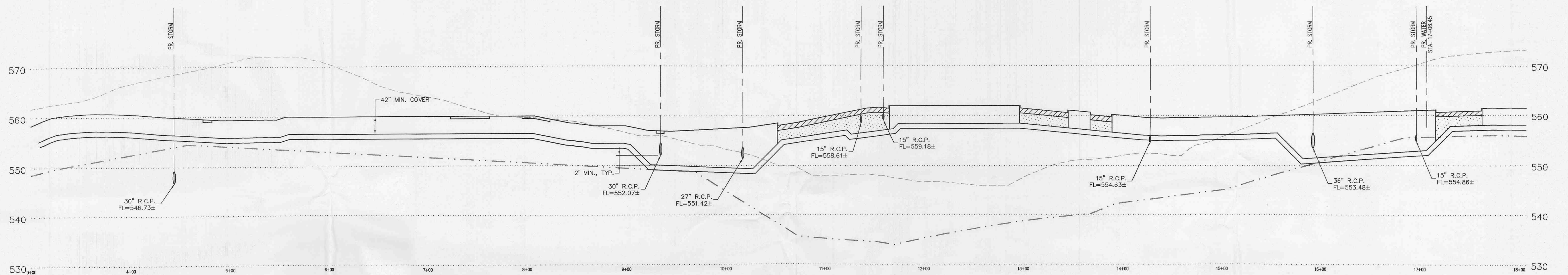

**PROPOSED 12" WATER LINE PROFILE #2 (cont.)**

HORIZONTAL SCALE: 1"=50'  
VERTICAL SCALE: 1"=10'

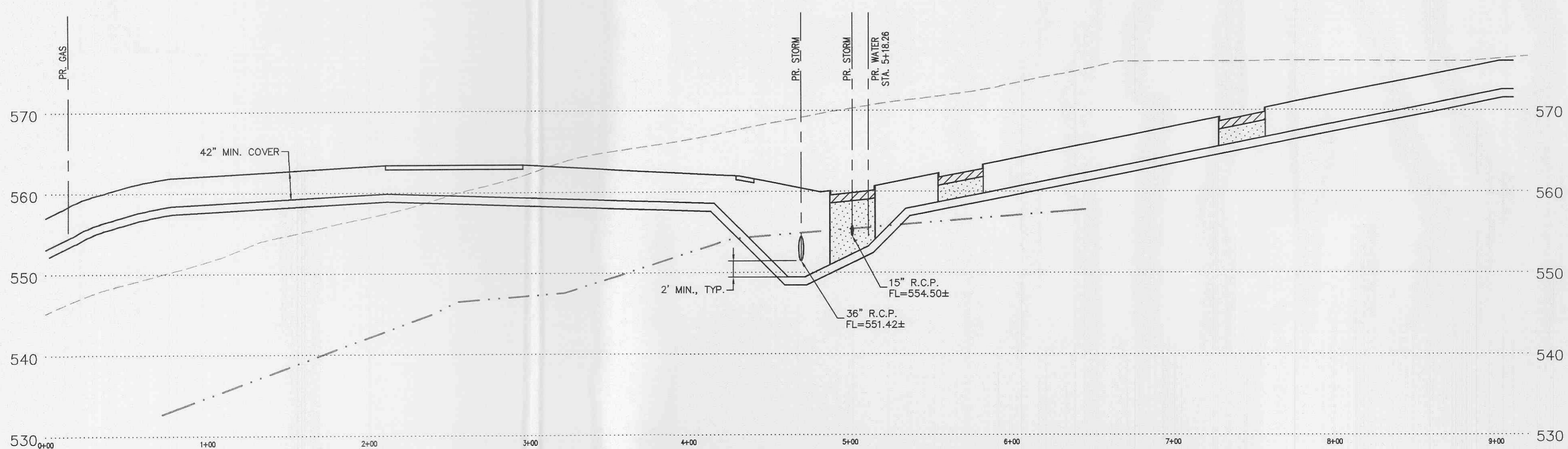

**PROPOSED 12" WATER LINE PROFILE #3**

HORIZONTAL SCALE: 1"=50'  
VERTICAL SCALE: 1"=10'

**LINETYPE LEGEND**

EXISTING GRADE.....	---
PROPOSED GRADE.....	—
ESTIMATED ROCK GRADE.....	- - - - -
HYDRAULIC GRADE.....	— · — · —
PROPOSED PAVEMENT.....	▨
GRANULAR BACKFILL.....	▩
COMPACTED FILL.....	▧

- 5 - 03/02/05 REVISED PER CITY & COORDINATING COMMENTS
- 4 - 02/02/05 REVISED PER CITY, DUCKET CREEK AND MODOT COMMENTS
- 3 - 12/08/04 REVISED SANITARY SEWER ROUTE
- 2 - 12/01/04 REVISED PER FIRE DISTRICT, SEWER DISTRICT AND CITY COMMENTS
- 1 - 11/22/04 REVISED PER COORDINATION ISSUES

**PROGRESS WEST HEALTHCARE CENTER - UTILITY PACKAGE**

**WATERLINE PROFILES**

P & Z FILE NUMBER 99104.09.03

March 02, 2005

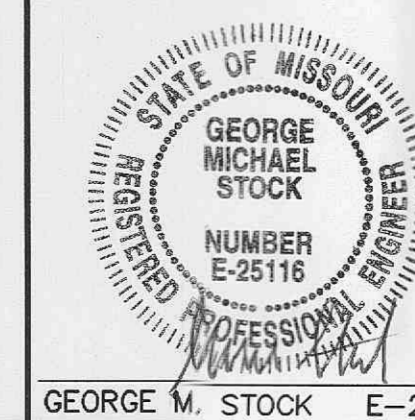

GEORGE M. STOCK E-25116

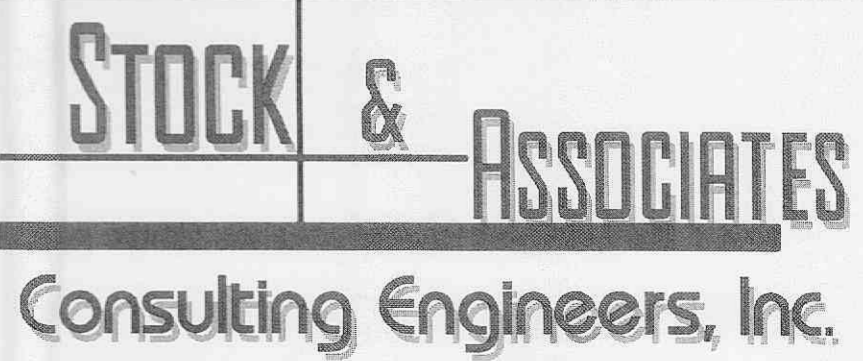

257 Chesterfield Business Parkway  
St. Louis, MO 63005  
PH. (636) 530-9100  
FAX (636) 530-9130  
e-mail: general@stockassoc.com  
Web: www.stockassoc.com

DRAWN BY:	DATE:	CHECKED BY:	DATE:	JOB NUMBER:	SHEET:
J.E.F.	10/21/04	G.M.S.	10/21/04	204-3224	C20 of 22

D:\DRAWING\2005\04\24\1-P&Z\UTILITY PACKAGE\CDP-WP-Profile.dwg, 3/2/2005 10:25:40 AM, RDP 6054p3