

**PROPOSED 12" WATER LINE PROFILE #1**  
 HORIZONTAL SCALE: 1"=50'  
 VERTICAL SCALE: 1"=10'

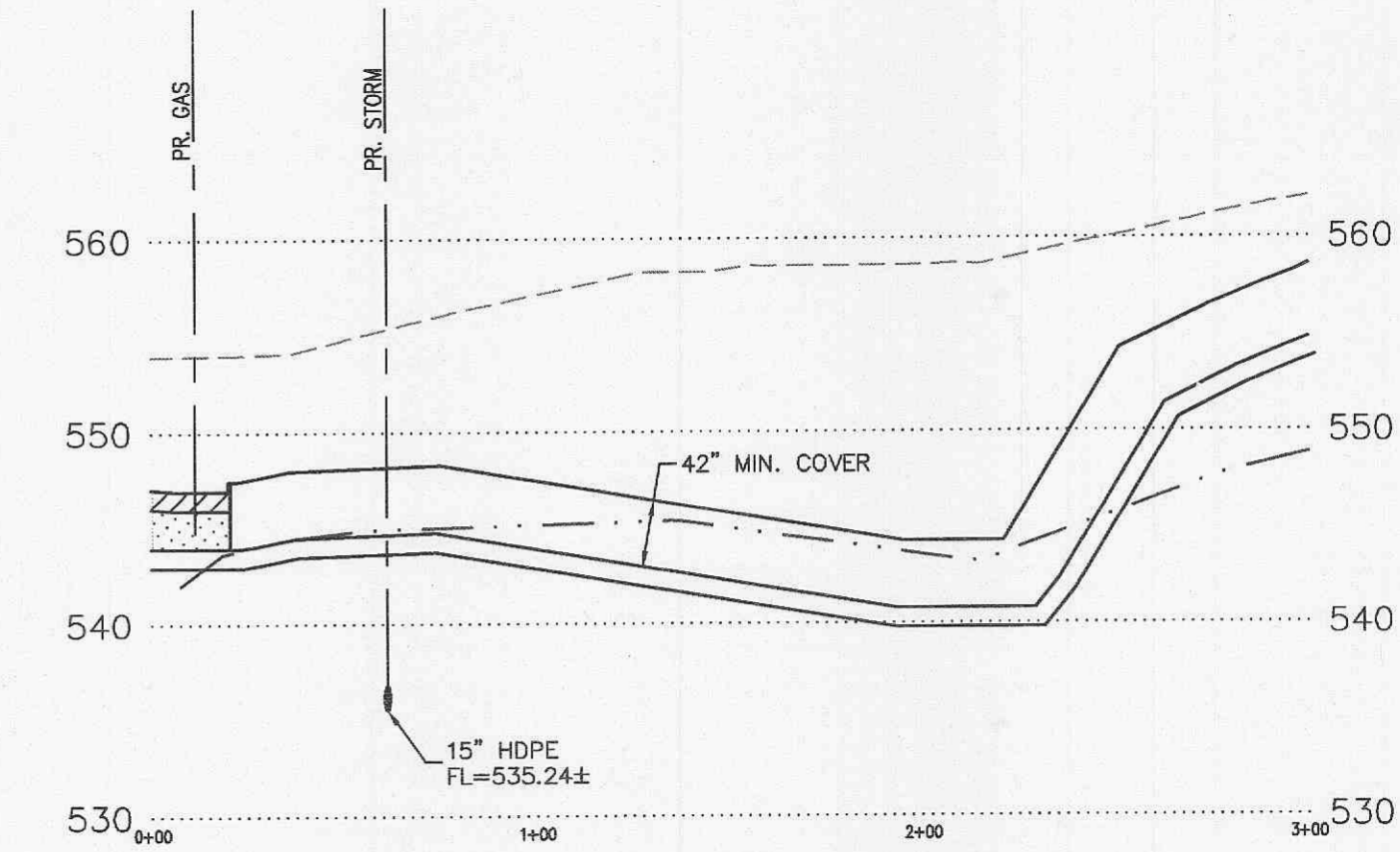

**PROPOSED 12" WATER LINE PROFILE #2**  
 HORIZONTAL SCALE: 1"=50'  
 VERTICAL SCALE: 1"=10'

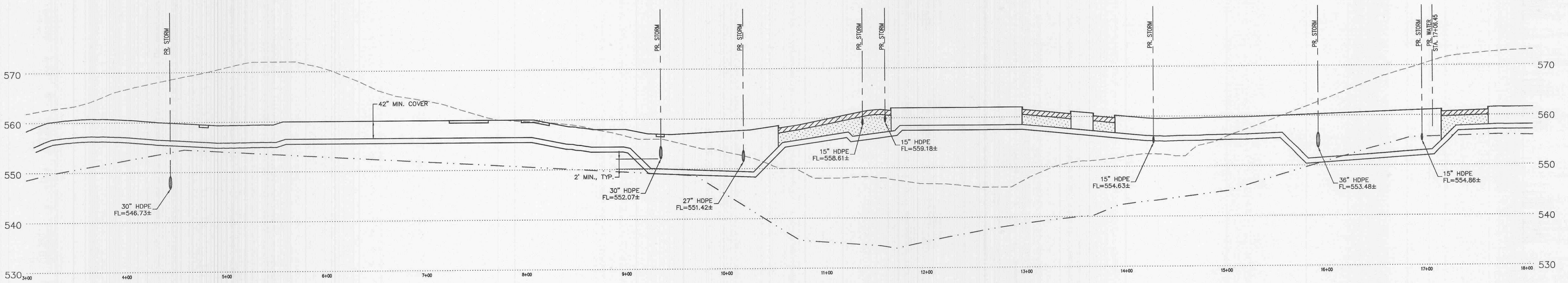

**PROPOSED 12" WATER LINE PROFILE #2 (cont.)**  
 HORIZONTAL SCALE: 1"=50'  
 VERTICAL SCALE: 1"=10'

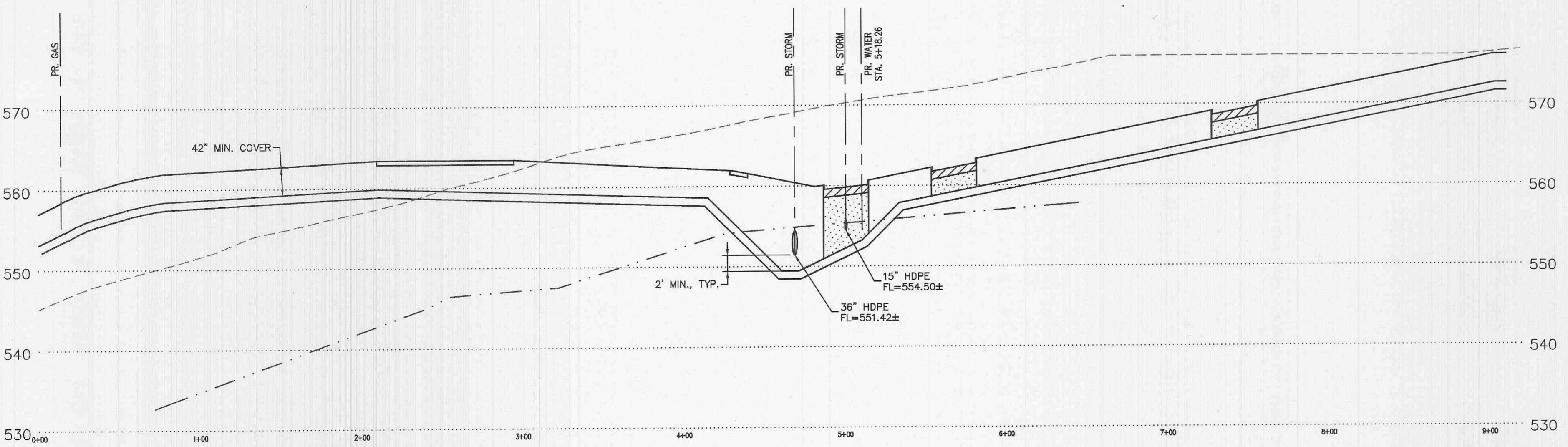

**PROPOSED 12" WATER LINE PROFILE #3**  
 HORIZONTAL SCALE: 1"=50'  
 VERTICAL SCALE: 1"=10'

**LINETYPE LEGEND**

- EXISTING GRADE.....
- PROPOSED GRADE.....
- ESTIMATED ROCK GRADE.....
- HYDRAULIC GRADE.....
- PROPOSED PAVEMENT.....
- GRANULAR BACKFILL.....
- COMPACTED FILL.....

July 29, 2005  
 GEORGE M. STOCK  
 E-25116

REVISIONS 7/29/05 PER CITY OF O'FALLON COMMENT LETTER  
 6/16/05 BID PACKAGE #6  
 6/6/05 BUILDING PERMIT APPLICATION SET  
 REVISIONS 5/18/05 PER CITY OF O'FALLON COMMENT LETTER

**PROGRESS WEST**  
**WATERLINE PROFILES**

**Stock & Associates**  
 Consulting Engineers, Inc.

257 Chesterfield Business Parkway  
 St. Louis, MO 63005  
 PH. (636) 530-9100  
 FAX (636) 530-9130  
 e-mail: general@stockassoc.com  
 Web: www.stockassoc.com

DRAWN BY: J.E.F. DATE: 05.09.05 CHECKED BY: G.M.S. DATE: 05.09.05 SHEET: 204-3224 C33 of 36