

OWNER
CITY OF OFFALLO
100 NORTH MAIN STREET
OFFALLO, MO 63366
636.379.5590

PROJECT TEAM
CIVIL ENGINEER
PREMIER DESIGN GROUP
100 MIDLAND PARK DRIVE
WENTZVILLE, MO 63385
314.925.7444

MAINTENANCE CONSULTANT
HDR ENGINEERING, INC.
17725 KATY FREEWAY SUITE 102
HOUSTON, TX 77094
813.360.2700

STRUCTURAL ENGINEER
METTEMAYER ENGINEERING
2225 W CHESTERFIELD BLVD., SUITE 300
SPRINGFIELD, MO 65807
417.890.8002

MEP ENGINEER
HENDERSON ENGINEERS, INC.
8345 LENEXA DR., #300
LENEXA, KS 66214
913.742.5000

LIST OF ACCEPTABLE NATIVE GRASSES/SEDGES FOR DETENTION BASIN PLANTING AREAS
PER MSD BMP LANDSCAPE GUIDE GRASSES/SEDGES FOR POND EDGE & PERMANENT WATER

Latin Name	Common Name
Carex acuticarpa	Yellow tufted sedge
Carex grisea	Bur sedge
Carex lasiocarpa	Fringed sedge
Carex muskingumensis	Palm sedge
Carex vulpinoidea	Fox sedge
Scirpus atrovirens	Great green bulrush
Carex acuticarpa	Yellow tufted sedge
Carex grisea	Bur sedge
Carex muskingumensis	Palm sedge
Carex proserpicata	Tulway sedge
Carex shortiana	Short s sedge
Carex vulpinoidea	Fox sedge
Juncus effusus	Soft rush
Scirpus atrovirens	Great green bulrush
Spartina pectinata	Proarie cordgrass

SPACING TO	ROW TO	NUMBER OF PLANTS/00 FT.
30"	26"	180
24"	20"	90
18"	15"	40
15"	13"	30
12"	10"	15
10"	8"	10
8"	6"	5

NOTE: PLANT QUANTITIES WERE DETERMINED BY MULTIPLYING AREA OF PLANTING BY PLANTING RATE PER REQUIRED SPACING.

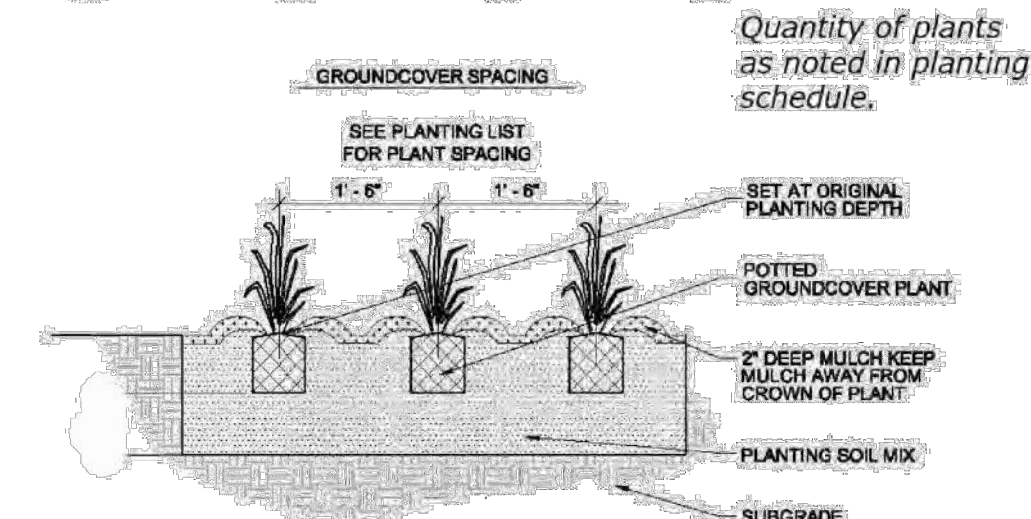
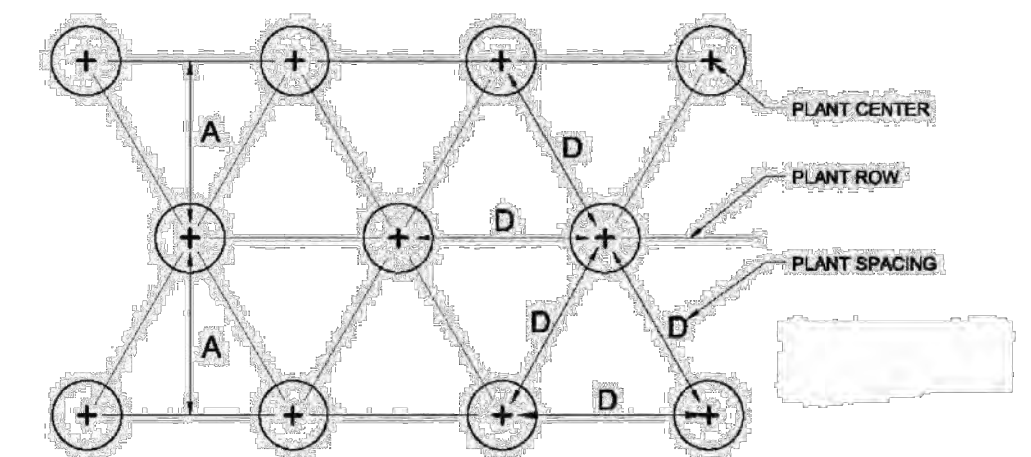

NOTES:
1. REMOVE SPENT FLOWERS PRIOR TO PLANTING.
2. LOCATE ROOT MASS AT BOTTOM OF ROOTBALL.
3. TOP OF ROOTBALL IS TYPICAL 2" SURFACE GROWING MEDIA AND COVER WITH 1" LANDSCAPE RED MIX PLUS SURFACE MULCH.

Plant Spacing Plan
Figure 9
Planting Detail Courtesy of Ted Spald, SWT Design, St. Louis, MO
MSD Landscape Guide for Stormwater Best Management Practices

Planting, Water and Mulch Requirements for Stormwater BMPs

Table 3: Planting, Water and Mulch Requirements

Water Availability	Required Planting Period	Minimum Container Size	Water Requirement First 3 Weeks*	Water Requirement After 3 Weeks*	Maximum Mulch Depth****
No ability to water after	Late Feb. - April only	2.25" x 3.75" or larger	Water each plug immediately	1" (60 min) every 7 days until plants established***	1.5" for plugs
Manual watering with standard sprinkler	Late Feb. - Early June Sept. - October	4.5" x 9" (quart) or larger in summer & fall	1" (60 min) every 4 days	1" (60 min) every 7 days until plants established***	1.5" for plugs 2.5" for quarts
Automatic irrigation (set to water more frequently than normal during first two months after planting)	Late Feb. - Early Oct.	2.25" x 3.75" (plug) or larger in spring 4.5" x 9" (quart) or larger in summer & fall	1" (60 min) every 4 days in spring and fall 1" (60 min) every 3 days in summer	1" (60 min) every 7 days until plants established***	1.5" for plugs 2.5" for quarts

*This water amount includes natural rainfall. If you get a 1/2 inch of natural rain then you will need to add a 1/2 inch of water to meet the 1 inch requirement.
**Requires transport of water to the planting site in large containers and pouring enough water onto each plant (after planting) to moisten the entire planting pit.
***Plants are established when roots have grown out of the container soil and into the native soil by 3-5 inches. This normally takes 3-4 months for most perennials and grasses and up to 6-7 months for trees and shrubs.
****Shredded leaf compost is recommended for use with perennials and grasses. Shredded bark mulch is recommended for tree and shrub plantings at a depth of 3 inches.

REVISIONS

NO.	DESCRIPTION	DATE
1	ADDENDUM #01	10/5/2023

PROJECT NO.: 2207920 DRAWN BY: A. JONES
DATE: 9-15-2023 REVIEWED BY: M. FOGARTY

PROFESSIONAL SEAL



ENGINEERS AUTHENTICATION
The responsibility for professional engineering liability on this project is hereby accepted by the set of plans authorized by the seal, signature, and date hereunder attached. Responsibility is disclaimed for all other engineering plans prepared in this project and specifically requires retention of this seal.

PROJECT TITLE
O'FALLON PUBLIC WORKS FACILITY

PROJECT ADDRESS:
1101 OLD E TERRA LANE
OFFALLO, MO 63366

BASIN SECTIONS AND DETAILS

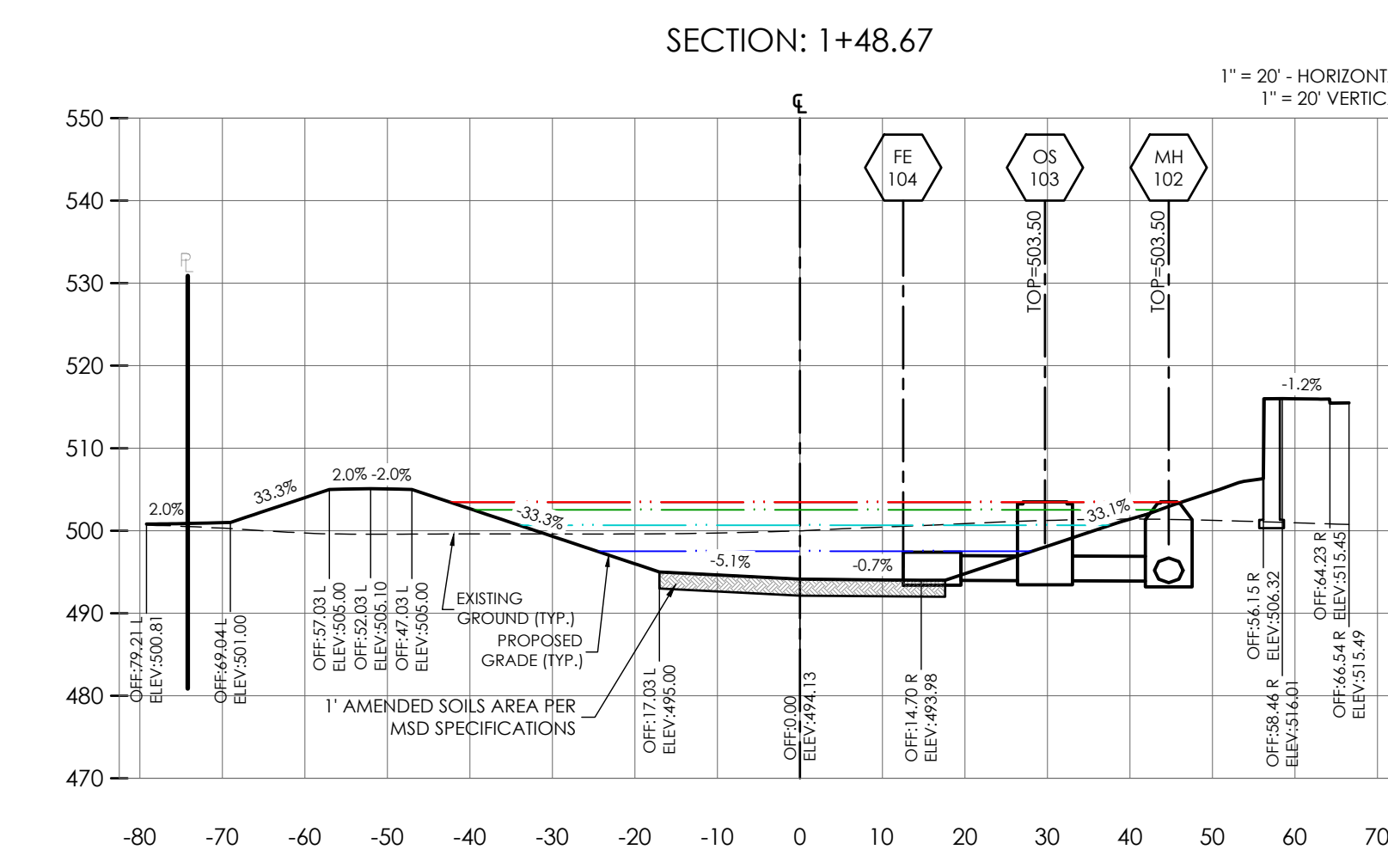
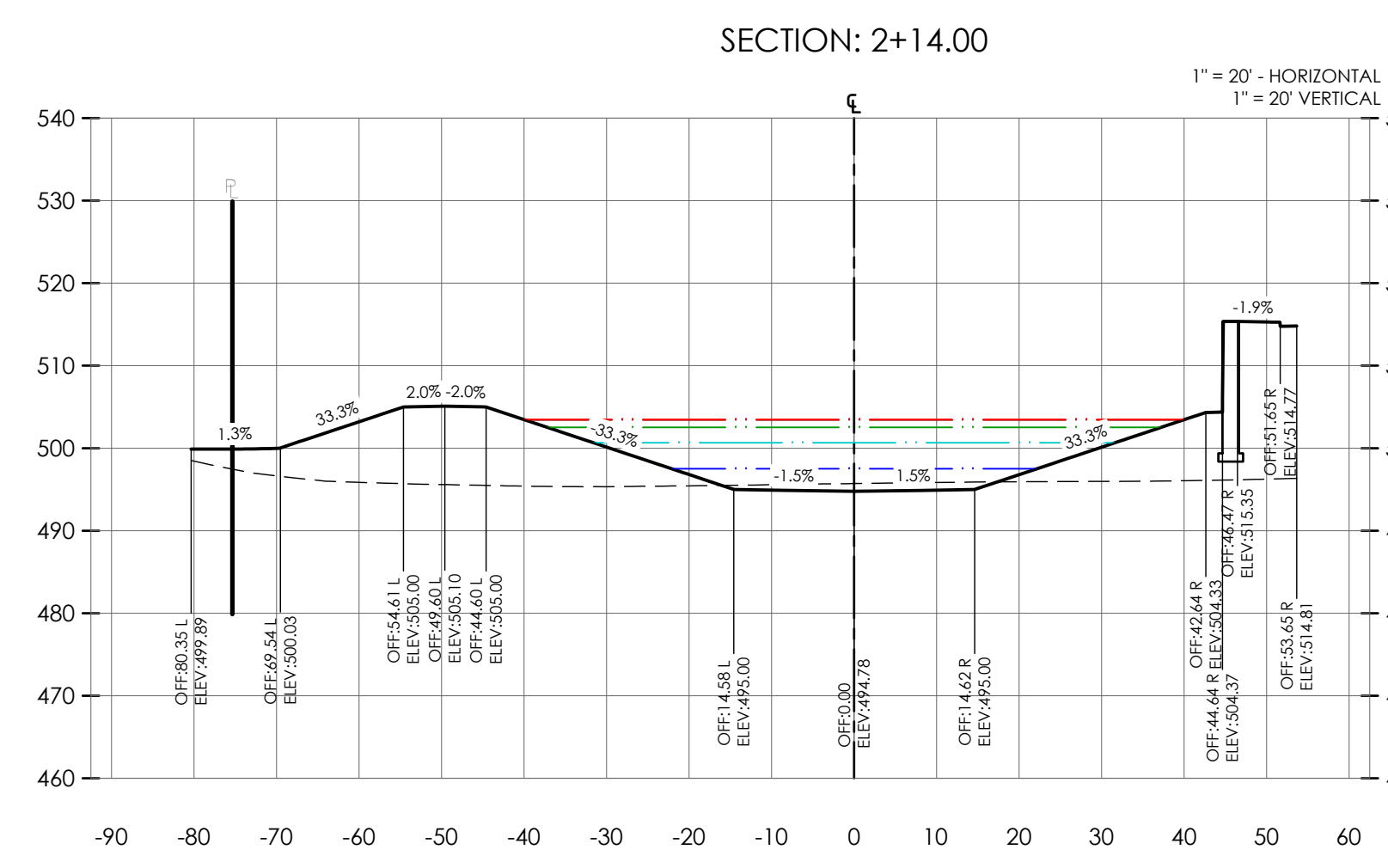
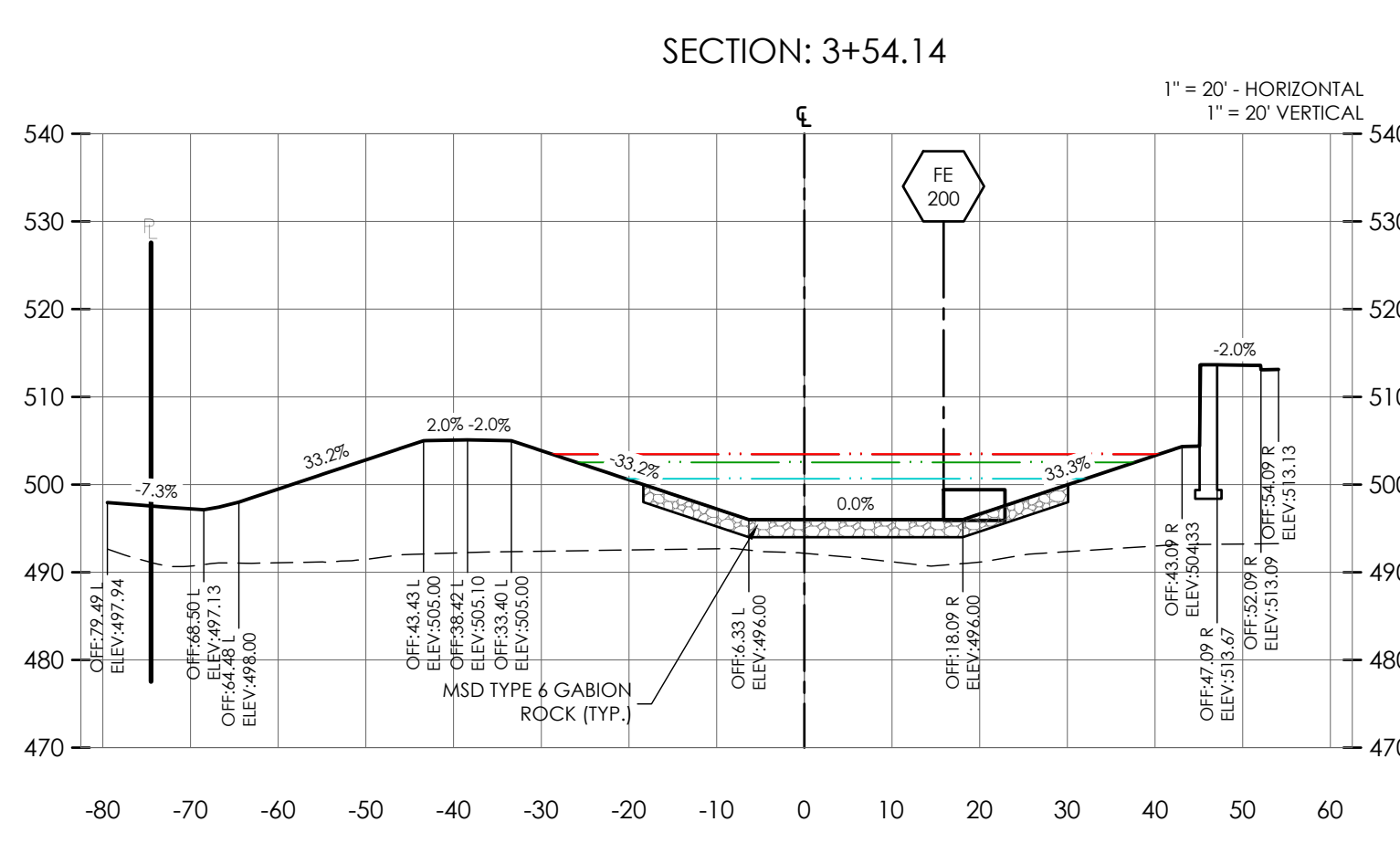

\\s01cvs01\cvs01\PROJECTS\2023\2207920_000_City of Offalonn MO Public Works\Engineering\Phase 1 Construction\DOCUMENTS\600 DETENTION BASIN PLAN DETAIL.dwg



UNDERGROUND UTILITIES AND OSHA SAFETY NOTE:
Underground utilities and structures have been plotted from available information and therefore, their location must be considered approximate only. It is the responsibility of the individual contractors to notify the utility companies before actual construction. All O.S.H.A. rules and regulations established for the type of construction required by these plans shall be strictly followed (ie. trenching, blinding, etc.)