

**UTILITIES:**

Electric: Ameren UE  
Wentzville District Office  
200 North Collihan Rd  
Wentzville MO 63385-1999  
(314) 639-8317

Telephone: Southwestern Bell Telephone  
402 North Third Street  
St. Charles, MO 63301  
William Bostic (314) 949-1320

Gas: St. Charles Gas Co  
1 Westbury Blvd  
St. Charles, MO 63301  
(314) 639-8210

Sewer: Duckett Creek Sewer Dist.  
2950 Greens Bottom Rd  
St. Charles, MO 63303  
(314) 441-1244

Water: St. Charles Public Water Dist. 2  
100 Water Dr  
PO Box 967  
O'Fallon, MO 63366  
(314) 561-3737

Fire District: Cottleville Fire Protection  
1385 Motherhood Dr.  
(636) 447-6655

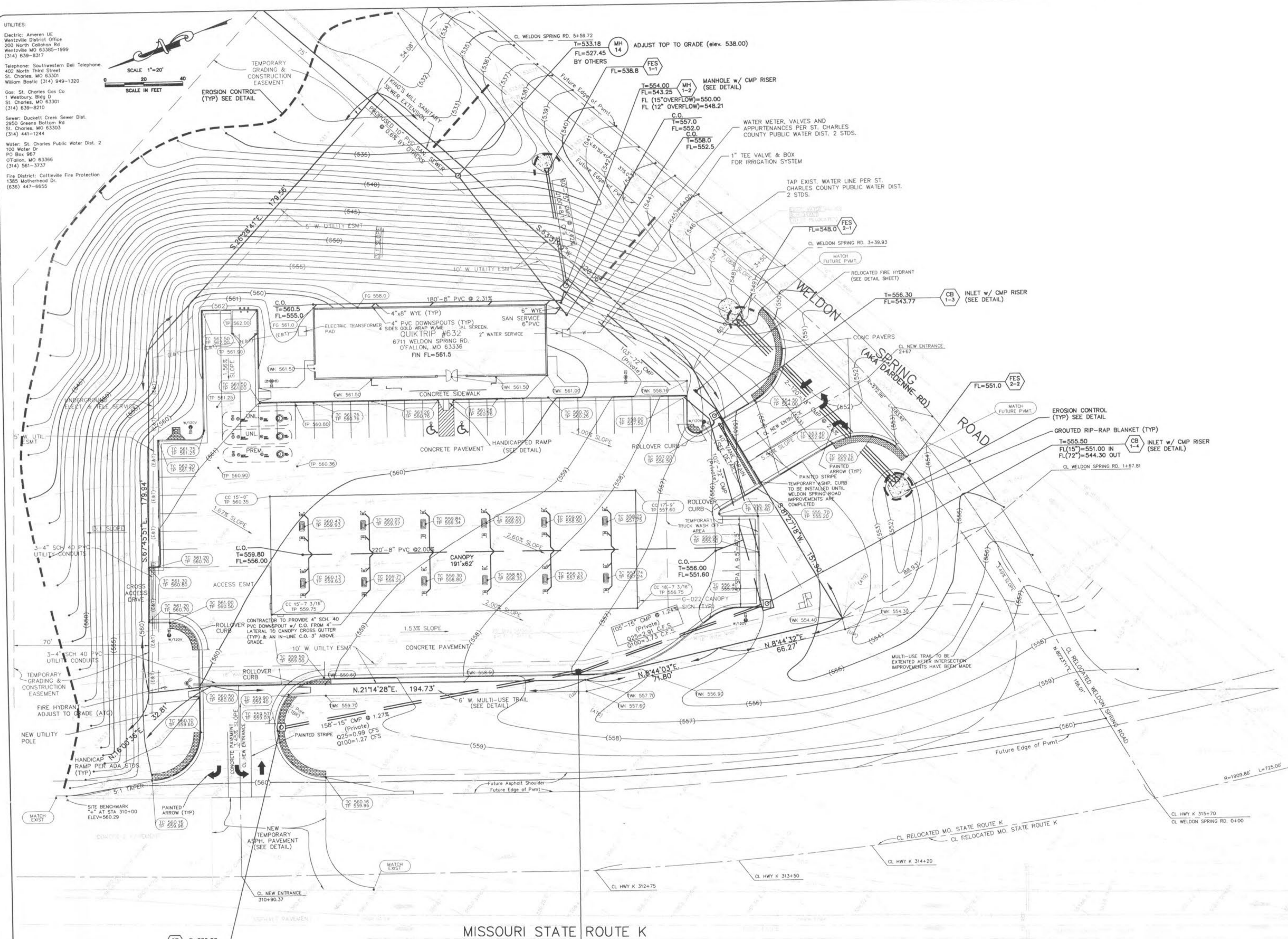
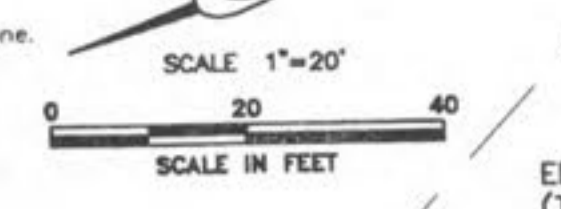

NOTE:  
RIGHT OF WAY TO BE GRADED PER MODOT PLANS. CURRENT MODOT PLANS ARE PRELIMINARY AND DO NOT PROVIDE FOR STORM WATER DRAINAGE AT THIS TIME. QUIKTRIP PLANS WILL BE REVISED AS REQUIRED UPON COMPLETION OF MODOT PLANS.

- NOTES**
- ROUTE CANOPY AND BUILDING ROOF DRAINS AND DOWNSPOUTS TO DRAINAGE SYSTEM WITH SCHEDULE 40 PVC (ABOVE GRADE ONLY). USE SDR 35 PVC BELOW GRADE.
  - CONTRACTOR TO VERIFY DEPTH, TYPE, SIZE AND LOCATION OF ALL EXISTING UTILITIES PRIOR TO EXCAVATION.
  - ALL EXISTING ON-SITE STRUCTURES, SIDEWALK, CONCRETE OR ASPHALT SURFACES, CURBING, UTILITY POLES, SEWER STRUCTURES, UTILITY SERVICES, FENCES, TREES, SHRUBS AND DEBRIS SHALL BE DEMOLISHED AND REMOVED FROM THE SITE AND PROPERLY DISPOSED OF ALL IN A MANNER APPROVED BY THE REGULATING GOVERNMENTAL AGENCIES, UNLESS OTHERWISE NOTED.
  - CONTRACTOR SHALL PRESERVE AND PROTECT ALL EXISTING IMPROVEMENTS (WHICH ARE NOT TO BE REMOVED) WITHIN THE PROJECT LIMITS OR ADJACENT THERETO FROM DAMAGE AS A RESULT OF HIS ACTIVITIES IN THE PERFORMANCE OF WORK. ALL "ON SITE" STORM SEWERS SHALL REMAIN PRIVATE.

NO.	DATE	BY	REVISIONS
4	11/2/99	EJK	REVISED PER DUCKETT CREEK SEWER DISTRICT REVIEW
3	10/12/99	EJK	REVISED PER QUIKTRIP REVIEW
2	10/1/99	BLM	REVISED PER QUIKTRIP REVIEW
1	8/26/99	JTG	REVISED PER QUIKTRIP REVIEW

**QT**  
QUIKTRIP CORPORATION  
2255 BLUESTONE DRIVE  
ST. CHARLES, MO 63303  
PH # (314) 916-5706  
FAX # (314) 916-5754

**QUIKTRIP #632**  
GRADING & UTILITY PLAN

6711 WELDON SPRING RD. OF FALLON, MO 63336

the clayton engineering company, inc.  
ENGINEERS • SURVEYORS • PLANNERS  
11920 WESTLINE INDUSTRIAL DRIVE  
ST. LOUIS, MISSOURI 63146  
(314) 862-8888 FAX (314) 862-8888  
EMAIL: CLAYTON@PRIMARY.NET

Designed: DJB  
Drawn: HRL  
Checked: EJK  
Date: 8/16/99  
Project Number: 99051  
Sheet Number: 2 of 11

FILE P:\99051\PLANS\SITE\PLN.DWG PLOTTED 11/02/1999 11:05 AM  
F.S. F.B. SUR

Call Before you DIG  
TOLL FREE  
1-800-344-7483  
MISSOURI ONE-CALL SYSTEM INC.

Underground facilities, structures & utilities have been plotted from available surveys, records & information, and therefore, do not necessarily reflect the actual existence, nonexistence, size, type, number, or location of these facilities, structures, & utilities.  
The Contractor shall be responsible for verifying the actual location of all underground facilities, structures, & utilities, either shown or not shown on these plans. The underground facilities, structures, & utilities shall be located in the field prior to any grading, excavation or construction of improvements. These provisions shall in no way absolve any party from complying with the Underground Facility Safety and Damage Prevention Act, Chapter 319, RSMo.

STANDARD GRATE INLET W/SIDE INTAKE  
T=556.95  
FL=552.50 IN  
FL=552.30 OUT

PROJECT BENCHMARK: Missouri State Route "K" BM #27-85, 80d spike 5" Elm group of 4, 64 feet left of centerline station 316+25+/-, 30 feet +/- North of Weldon Spring Road. Elevation=549.09.

SITE BENCHMARK: "+" of stamped station 310+00, located at edge of pavement 40 feet Eastwrdy of centerline station 310+00 of Relocated Missouri State Route "K". Elevation=560.29

WE CERTIFY THAT WE HAVE EXAMINED COMMUNITY PANEL NUMBER 290316-0430 ( MAP NUMBER 29183-C0430 E, DATED AUGUST 1996) OF THE FLOOD INSURANCE RATE MAPS, PREPARED BY THE FEDERAL EMERGENCY MANAGEMENT AGENCY, FOR THE AREA CONTAINING THE SUBJECT PROPERTY. SAID PROPERTY APPEARS TO BE LOCATED IN "ZONE X", OUTSIDE OF THE 500 YEAR FLOOD PLAIN LIMITS AS SHOWN ON THAT MAP.