

LANDSCAPE SCHEDULE					
SYMBOL	COMMON NAME	DIVISIONS	MINIMUM SIZE/HEIGHT/SPREAD	SPACING	COMMENTS
	CRIMSON PYGMY BARBERRY <i>berberis thunbergii</i>	ALL DIVISIONS	3 GAL 12" x 15" HT MIN	18" C/C	SPACING FROM BARBERIES TO BARBERIES ARE TO BE 24" C/C
	SEA GREEN JUNIPER <i>Juniperus sibirica</i> (VERTICAL VARIETY)	ALL DIVISIONS	5 GAL 24" x 24" HT MIN	24" C/C	
	SCOTS PINE <i>Pinus sylvestris</i>	NORTHERN ZONES ONLY	7 GAL 5' HT		PLACEMENT AND SPACING ARE PER EACH DIVISION'S LOCAL LANDSCAPE ORDINANCE
	ARISTOCRAT PEAR <i>pyrus calleryana</i>	ALL DIVISIONS	1-1/2" CALIPER 12' HT		
	LOCUST <i>robinia pseudoacacia</i>	ALL DIVISIONS	3" CALIPER 15'		

SOD	MULCH
BERMUDA FESCUE BLUE GRASS	CYPRESS MULCH PINE STRAW
ATLANTA & ILL. SA MONTA, KANSAS CITY, & ST. LOUIS IOWA & OMAHA	ALL DIVISIONS EXCEPT ATLANTA ATLANTA

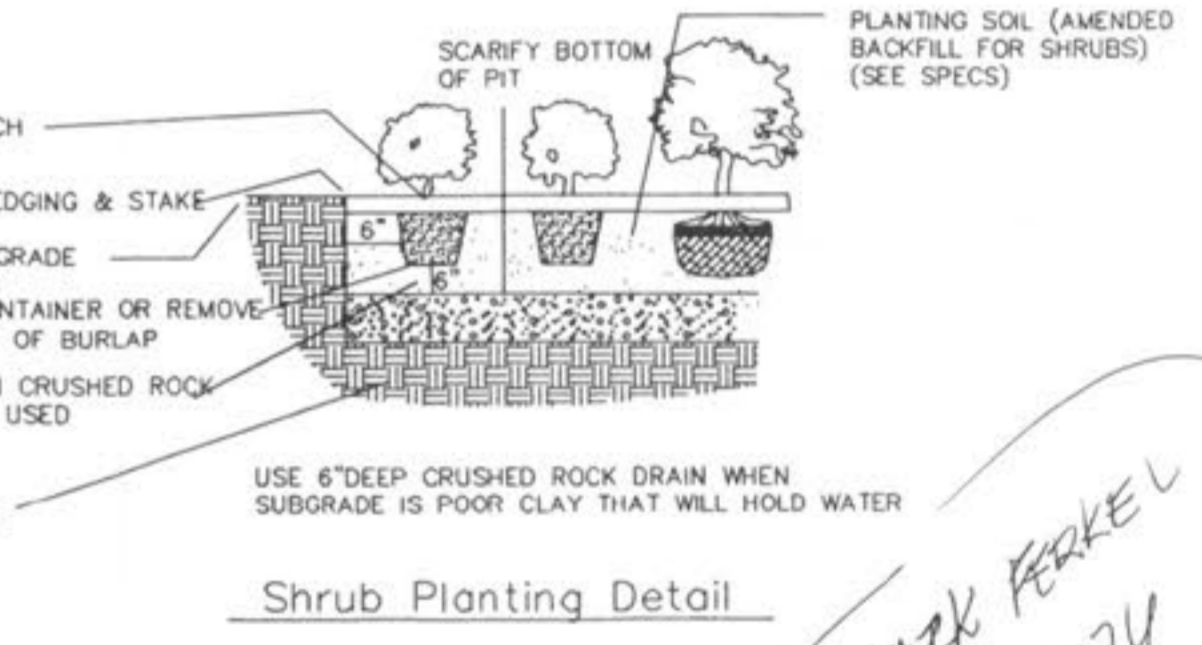

MARK FERKE  
741-4674

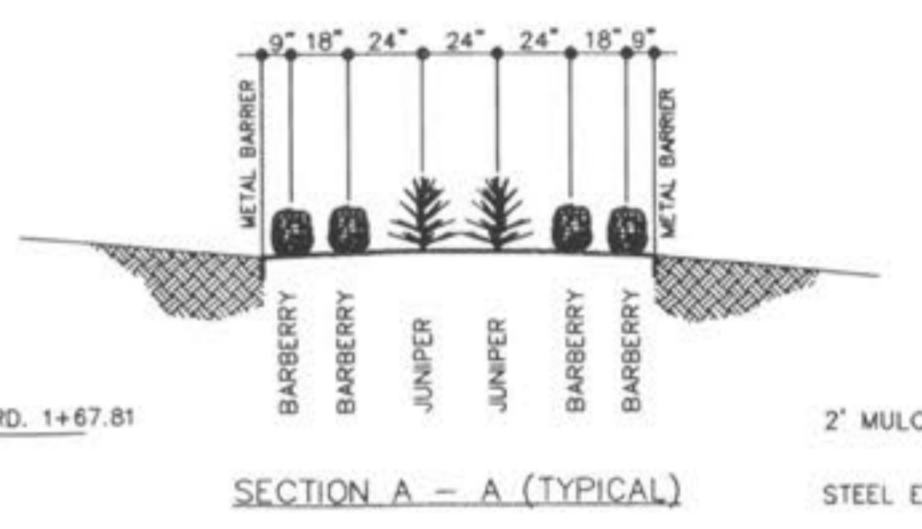
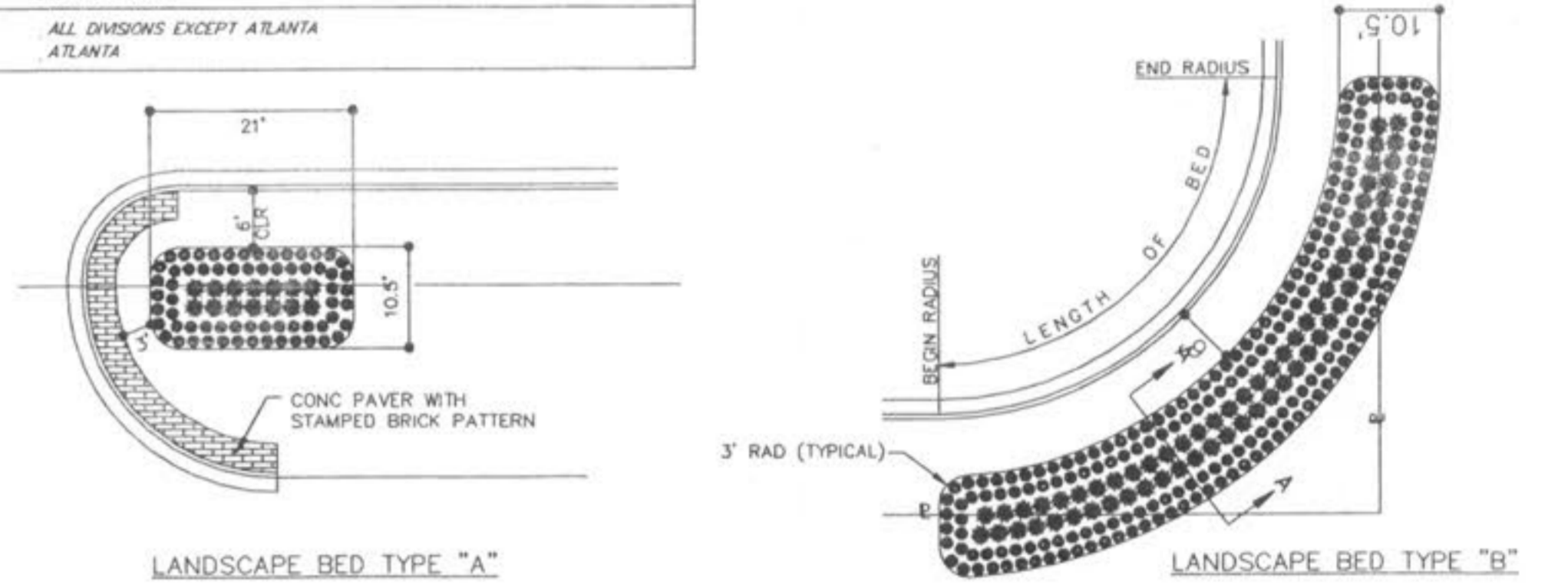
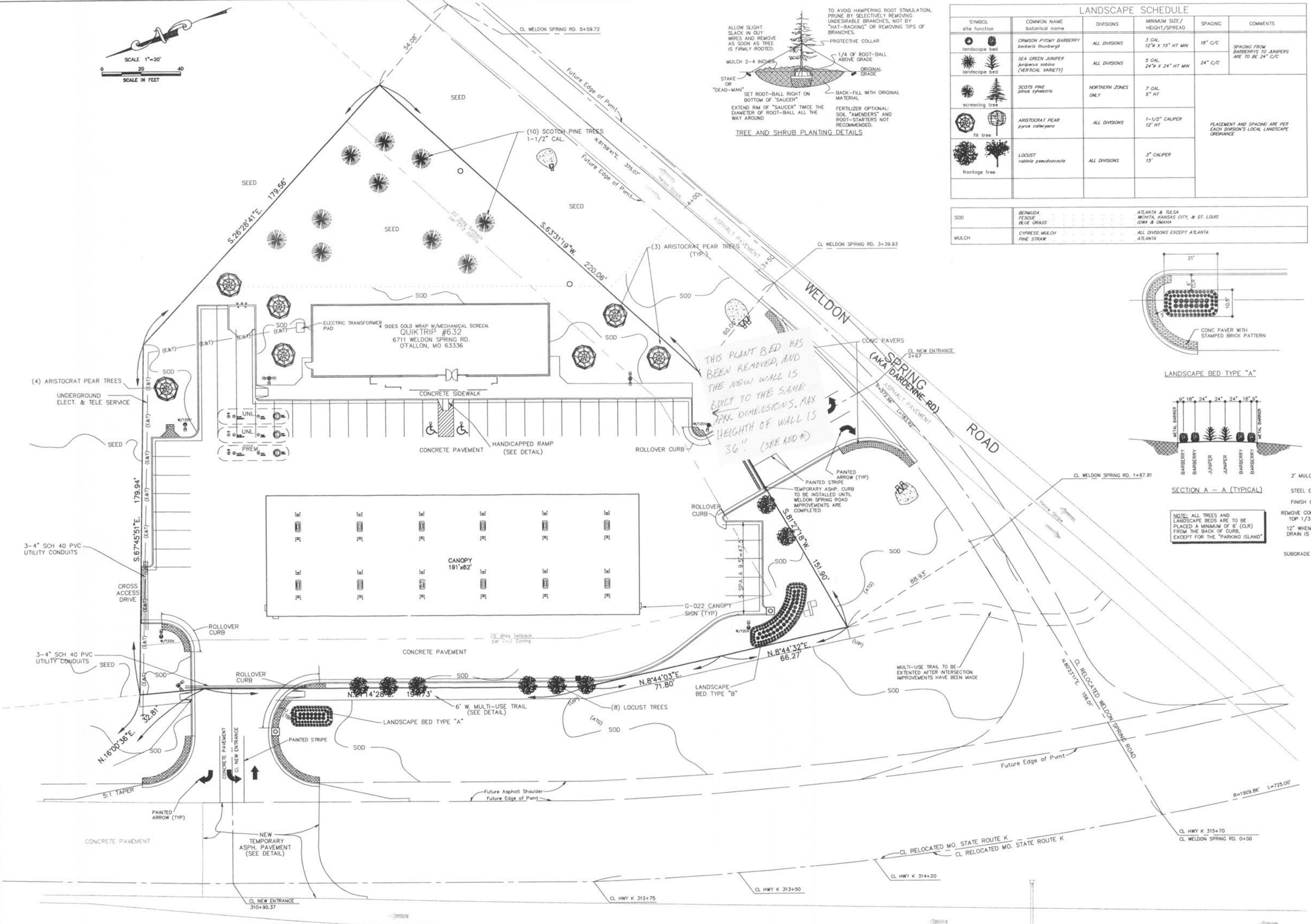

LANDSCAPE CALCULATIONS:  
 TOTAL AREA=73,312 SQ. FT.=100%  
 BUILDING AREA=4,554 SQ. FT.=6±%  
 PAVEMENT AREA=45,339 SQ. FT.=62±%  
 LANDSCAPE AREA REQUIRED=4,399 SQ. FT.=6±%  
 LANDSCAPE AREA PROVIDED=23,419 SQ. FT.=32±%  
 1 TREE REQUIRED PER 3,000 SQ. FT. OF LANDSCAPE AREA; 23,419/3,000=8 TREES

TREE PRESERVATION ORDINANCE:  
 EXISTING TREES=0  
 SAVED TREES=0  
 TREES REMOVED=0  
 TREES REPLACED=0  
 TREES REQUIRED PER ACRE=15 (1.68x15=25)  
 TOTAL TREES REQUIRED=25  
 TOTAL TREES PROVIDED=25

NO.	DATE	BY	REVISIONS
3	10/12/99	EJK	REVISED PER QUIKTRIP REVIEW
2	10/1/99	TLM	REVISED PER QUIKTRIP REVIEW
1	8/26/99	BJG	REVISED PER QUIKTRIP REVIEW

QUIKTRIP CORPORATION  
 2255 BLUESTONE DRIVE  
 ST. CHARLES, MO. 63303  
 PH # (314) 916-5706  
 FAX # (314) 916-5754

**QUIKTRIP #632**  
**LANDSCAPE PLAN**

8711 WELDON SPRING RD. OFALLON, MO 63336  
 the clayton engineering company, inc.  
 ENGINEERS • SURVEYORS • PLANNERS  
 1180 WESTLINE INDUSTRIAL DRIVE  
 ST. LOUIS, MISSOURI 63144  
 (314) 862-0800 FAX (314) 862-0808  
 EMAIL: CLAYTON@PRIMARY.NET

Project Number: 99051  
 Sheet Number: 3 of 11

FILE: P:\99051\PLANS\SITEPLAN.DWG PLOTTED: 10/12/1999 3:22 PM  
 F.S. F.B. SUR.