

UTILITIES:  
 Electric: Ameren UE  
 Wentzville District Office  
 200 North Colchoun Rd  
 Wentzville, MO 63385-1999  
 (314) 639-8317  
 Telephone: Southwestern Bell Telephone  
 402 North Third Street  
 St. Charles, MO 63301  
 William Bostic (314) 949-1320  
 Gas: St. Charles Gas Co  
 1 Westbury, Bldg D  
 St. Charles, MO 63301  
 (314) 639-8210  
 Sewer: Duckett Creek Sewer Dist.  
 2950 Greens Bottom Rd  
 St. Charles, MO 63303  
 (314) 441-1244  
 Water: St. Charles Public Water Dist. 2  
 100 Water Dr  
 PO Box 967  
 O'Fallon, MO 63366  
 (314) 561-3737  
 Fire District: Cottleville Fire Protection  
 1385 Matherland Dr.  
 (636) 447-6655

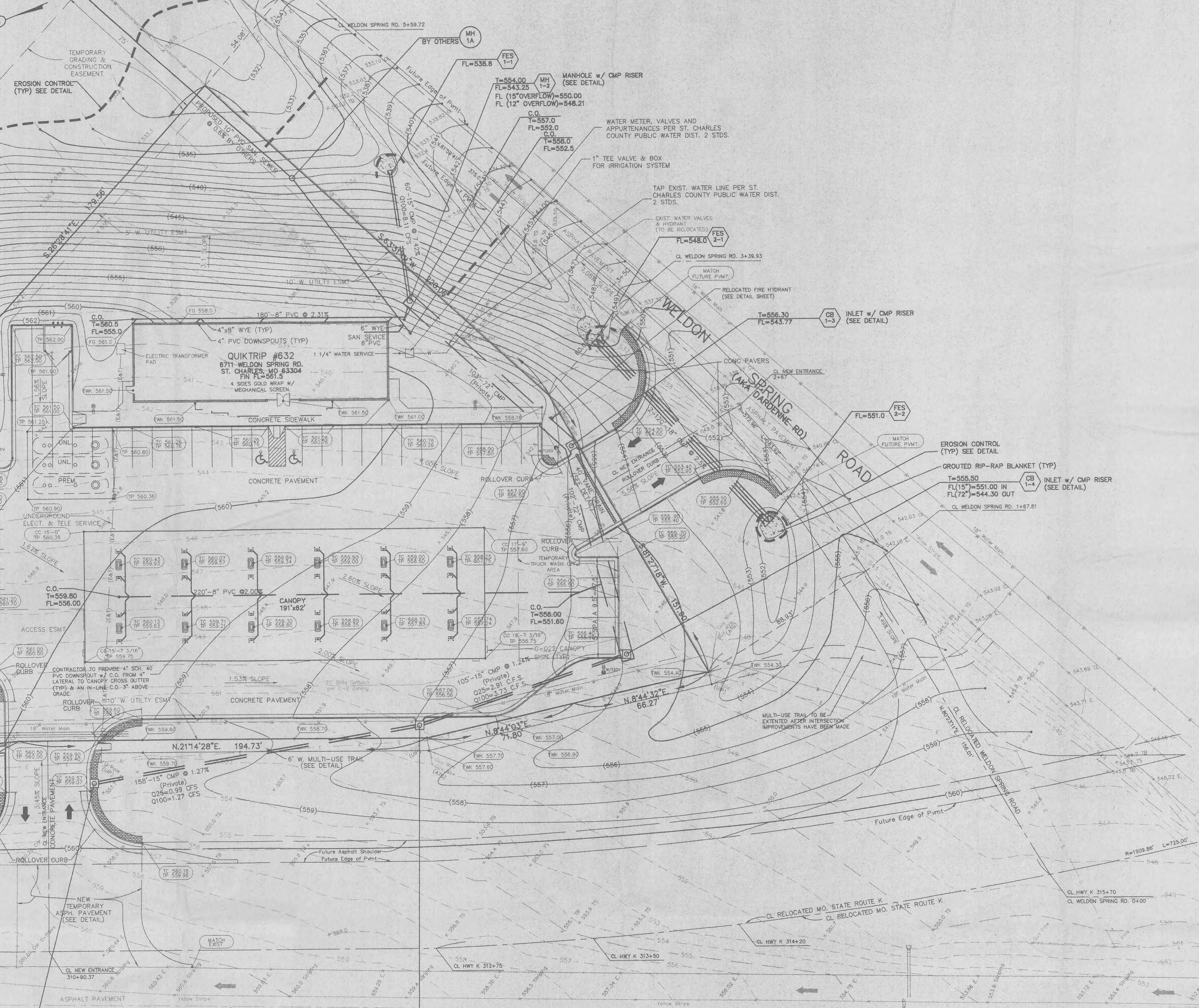
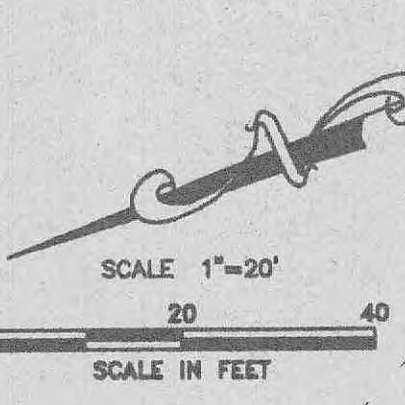

NOTE:  
 RIGHT OF WAY TO BE GRADED PER MODOT PLANS. CURRENT MODOT PLANS ARE PRELIMINARY AND DO NOT PROVIDE FOR STORM WATER DRAINAGE AT THIS TIME. QUIKTRIP PLANS WILL BE REVISED AS REQUIRED UPON COMPLETION OF MODOT PLANS.

- NOTES
- ROUTE CANOPY AND BUILDING ROOF DRAINS AND DOWNSPOUTS TO DRAINAGE SYSTEM WITH SCHEDULE 40 PVC (ABOVE GRADE ONLY). USE SDR 35 PVC BELOW GRADE.
  - CONTRACTOR TO VERIFY DEPTH, TYPE, SIZE AND LOCATION OF ALL EXISTING UTILITIES PRIOR TO EXCAVATION.
  - ALL EXISTING ON-SITE STRUCTURES, SIDEWALK, CONCRETE OR ASPHALT SURFACES, CURBING, UTILITY POLES, SEWER STRUCTURES, UTILITY SERVICES, FENCES, TREES, SHRUBS AND DEBRIS SHALL BE DEMOLISHED AND REMOVED FROM THE SITE AND PROPERLY DISPOSED OF ALL IN A MANNER APPROVED BY THE REGULATING GOVERNMENTAL AGENCIES, UNLESS OTHERWISE NOTED.
  - CONTRACTOR SHALL PRESERVE AND PROTECT ALL EXISTING IMPROVEMENTS (WHICH ARE NOT TO BE REMOVED) WITHIN THE PROJECT LIMITS OR ADJACENT THERETO FROM DAMAGE AS A RESULT OF HIS ACTIVITIES IN THE PERFORMANCE OF WORK.

Call Before you DIG  
 TOLL FREE  
 1-800-344-7483  
 MISSOURI ONE-CALL SYSTEM INC.

Underground facilities, structures & utilities have been plotted from available surveys, records & information, and therefore, do not necessarily reflect the actual existence, nonexistence, size, type, number or location of these facilities, structures, & utilities.  
 The Contractor shall be responsible for verifying the actual location of all underground facilities, structures, & utilities, either shown or not shown on these plans. The underground facilities, structures, & utilities shall be located in the field prior to any grading, excavation or construction of improvements. These provisions shall in no way activate any party from complying with the Underground Facility Safety and Damage Prevention Act, Chapter 316, RSMo.

CB 1-8  
 T=559.50  
 FL=554.50  
 STD. MODOT  
 TYPE "T" INLET  
 (SEE DETAIL)

MISSOURI STATE ROUTE K  
 ASPHALT PAVEMENT

STANDARD CURB INLET  
 CB 1-3  
 T=557.50  
 FL=552.50 IN  
 FL=552.30 OUT

PROJECT BENCHMARK: Missouri State Route "K" BM #27-85. 80d spike 5' Elm group of 4, 64 feet left of centerline station 316+25+/-, 30 feet +/- North of Weldon Spring Road. Elevation=549.09.

SITE BENCHMARK: "4" of stamped station 310+00, located at edge of pavement 40 feet Eastwardly of centerline station 310+00 of Relocated Missouri State Route "K", Elevation=560.29

WE CERTIFY THAT WE HAVE EXAMINED COMMUNITY PANEL NUMBER 290316-0430 (MAP NUMBER 29183-00430 E, DATED AUGUST 1996) OF THE FLOOD INSURANCE RATE MAPS, PREPARED BY THE FEDERAL EMERGENCY MANAGEMENT AGENCY, FOR THE AREA CONTAINING THE SUBJECT PROPERTY. SAID PROPERTY APPEARS TO BE LOCATED IN "ZONE X", OUTSIDE OF THE 500 YEAR FLOOD PLAIN LIMITS AS SHOWN ON THAT MAP.

		<b>QUIKTRIP #632</b> <b>GRADING &amp; UTILITY PLAN</b>	
8711 WELDON SPRING RD. ST. CHARLES, MO 63304		Designed: DJG Drawn: HRL Checked: EEK Date: 8/16/99 Project Number: 99051 Sheet Number: 2 of 11	
the clayton engineering company, inc. ENGINEERS • SURVEYORS • PLANNERS 11800 WESTLINE INDUSTRIAL DRIVE ST. LOUIS, MISSOURI 63146 (314) 962-8888 FAX: (314) 962-8888 EMAIL: CLAYTON@PRIMARY.NET		FILE # 99051 PLANS SITE PLAN.DWG PLOTTED: 09/13/1999 8:25 AM F.S. F.B. SUR.	