

UTILITIES:
 Electric: Ameren UE
 Wentzville District Office
 200 North Callahan Rd
 Wentzville MO 63385-1999
 (314) 639-8317
 Telephone: Southwestern Bell Telephone
 402 North Third Street
 St. Charles, MO 63301
 William Boetic (314) 949-1320
 Gas: St. Charles Gas Co
 1 Westbury Blvd D
 St. Charles, MO 63301
 (314) 639-8210
 Sewer: Duckett Creek Sewer Dist.
 2850 Greens Bottom Rd
 St. Charles, MO 63303
 (314) 441-1244
 Water: St. Charles Public Water Dist. 2
 100 Water Dr
 PO Box 967
 O'Fallon, MO 63366
 (314) 561-3737
 Fire District: Cottleville Fire Protection
 1385 Motherhead Dr.
 (636) 447-6655

SCALE 1"=20'
 SCALE IN FEET
 0 20 40
 MICHAEL STANN & DEBORAH STANN
 TRUSTEES OF THE LARRY P. STANN &
 JOINT REVOCABLE LIVING TRUST
 ASHLEY CORPORATION
 DB 180, PG 500
 1/3 INTEREST
 GORDON A. & JOYMA LEE GUNDAKER, H/W
 1/3 INTEREST
 CURRENT ZONING C-3

7'-8" HIGH SIGHT PROOF REFUSE ENCLOSURE w/ BOLLARDS SEE ARCH. PLANS
 5' W. UTIL. ESMT
 3-4" SCH 40 PVC UTILITY CONDUITS
 TEMPORARY EXTRUDED CONCRETE CURB (SEE DETAIL)
 P-011V SIGN w/ CREDIT CARD PANEL
 TEMPORARY GRADING & CONSTRUCTION EASEMENT
 FIRE HYDRANT ADJUST TO GRADE (ATQ)

5' W. UTIL. ESMT
 3-4" SCH 40 PVC UTILITY CONDUITS
 TEMPORARY EXTRUDED CONCRETE CURB (SEE DETAIL)
 P-011V SIGN w/ CREDIT CARD PANEL
 TEMPORARY GRADING & CONSTRUCTION EASEMENT
 FIRE HYDRANT ADJUST TO GRADE (ATQ)

5' W. UTIL. ESMT
 3-4" SCH 40 PVC UTILITY CONDUITS
 TEMPORARY EXTRUDED CONCRETE CURB (SEE DETAIL)
 P-011V SIGN w/ CREDIT CARD PANEL
 TEMPORARY GRADING & CONSTRUCTION EASEMENT
 FIRE HYDRANT ADJUST TO GRADE (ATQ)

5' W. UTIL. ESMT
 3-4" SCH 40 PVC UTILITY CONDUITS
 TEMPORARY EXTRUDED CONCRETE CURB (SEE DETAIL)
 P-011V SIGN w/ CREDIT CARD PANEL
 TEMPORARY GRADING & CONSTRUCTION EASEMENT
 FIRE HYDRANT ADJUST TO GRADE (ATQ)

Call Before you DIG
 TOLL FREE
 1-800-344-7483
 MISSOURI ONE-CALL SYSTEM INC.
 Underground facilities, structures & utilities have been plotted from available surveys, records & information, and therefore, do not necessarily reflect the actual existence, non-existence, size, type, number of, or location of these facilities, structures, & utilities.
 The Contractor shall be responsible for verifying the actual location of all underground facilities, structures, & utilities, either shown or not shown on these plans. The underground facilities, structures, & utilities shall be located in the field prior to any grading, excavation or construction of improvements. These provisions shall in no way absolve any party from complying with the Underground Facility Safety and Damage Prevention Act, Chapter 319, RSMo.

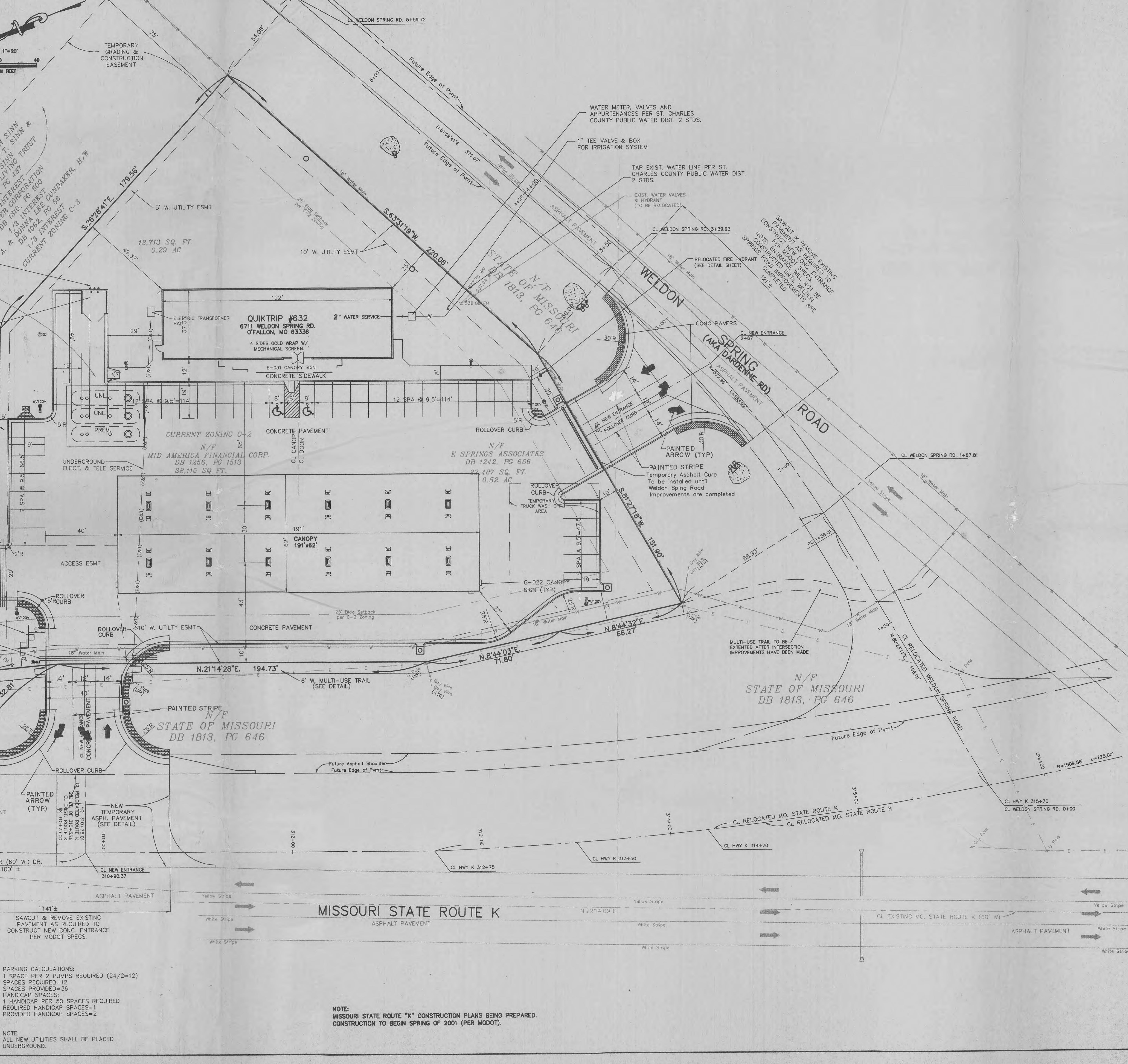

PARKING CALCULATIONS:
 1 SPACE PER 2 PUMPS REQUIRED (24/2=12)
 SPACES REQUIRED=12
 SPACES PROVIDED=36
 HANDICAP SPACES:
 1 HANDICAP PER 50 SPACES REQUIRED
 REQUIRED HANDICAP SPACES=1
 PROVIDED HANDICAP SPACES=2

NOTE:
 MISSOURI STATE ROUTE "K" CONSTRUCTION PLANS BEING PREPARED.
 CONSTRUCTION TO BEGIN SPRING OF 2001 (PER MODOT).

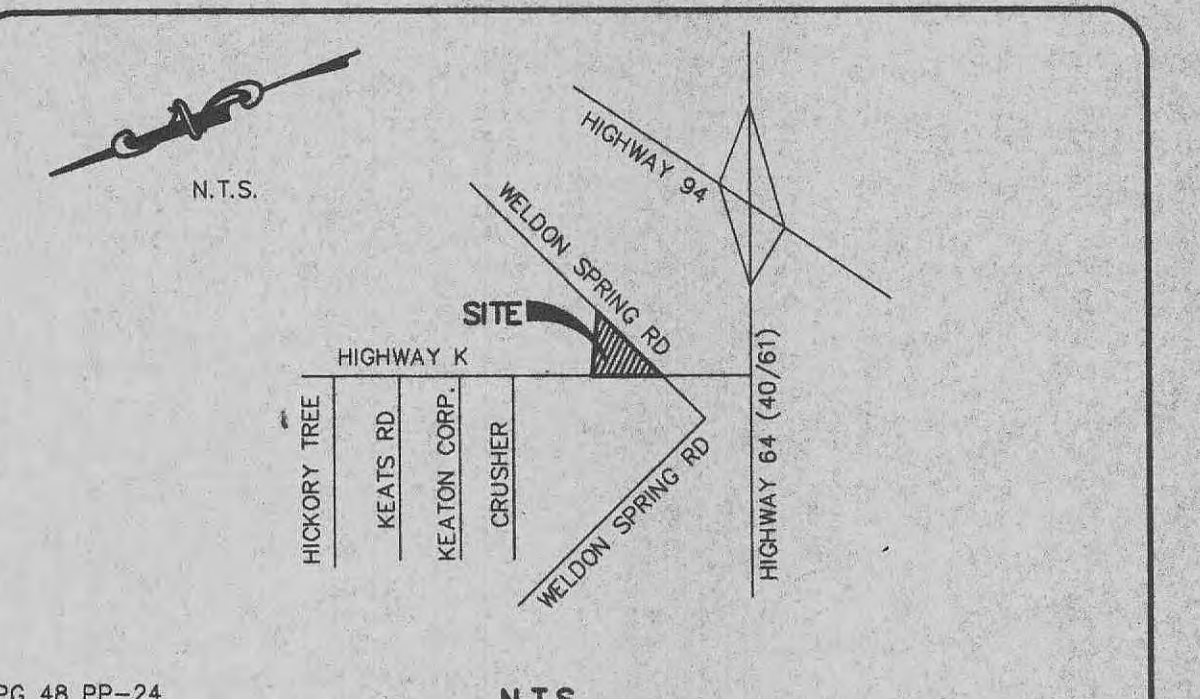

PG 48 PP-24 N.T.S. LOCATION MAP

ABBREVIATIONS	LEGEND
ATG	Adjust To Grade
B/B	Back to Back
BW	Bottom of Wall
CC	Canopy Clearance
CL	Centerline
DB	Deed Book
ED	Edge of Pavement
FG	Finished Grade
F/F	Face to Face
FL	Flow Line
HDCP	Handicap
HT	Not To Scale
OC	On Center
PB	Plot Book
R	Radius
R/W	Right of Way
TB	Top of Bank
TBR	To Be Removed
TBRR	To Be Removed & Replaced
TI	Top of Island
TP	Top of Pavement
TS	Toe of Slope
TW	Top of Wall
TWK	Top of Walk
UP	Use in Place
AI	Area Inlet
CB	Curb Inlet / Catch Basin
CO	Clean Out
DS	Down Spout
FES	Flared End Section
G	Gated Inlet
MH	Manhole
CMF	Corrugated Metal Pipe
CP	Non-reinforced Concrete Pipe
DIP	Ductile Iron Pipe
PVC	Polyvinyl Chloride Pipe
RPC	Reinforced Concrete Pipe
VCP	Vitrified Clay Pipe
AL	Area Light
AL	Area Light w/110v. Recept.
CON	Connection (Proposed)
CON	Existing Contour
CON	Proposed Contour
CON	Existing Elevation
CON	Proposed Elevation
CON	Fire Hydrant
CON	Concrete
CON	Doorway Entrance
CON	Drainage Flow
CON	Swale
CON	Water Meter Or Valve
CON	Gas Meter Or Valve
CON	Code TV
CON	Electric Service
CON	Underground Electric Service
CON	Gas Service
CON	Telephone Service
CON	Underground Tele. Service
CON	Water Service
CON	Exist. Sanitary Sewer
CON	Exist. Storm Sewer
CON	Proposed Sanitary Sewer
CON	Proposed Storm Sewer
CON	Utility Pole w/ Guy Wires
CON	Right Angle
CON	Handicap Parking Space
CON	Direction of Traffic

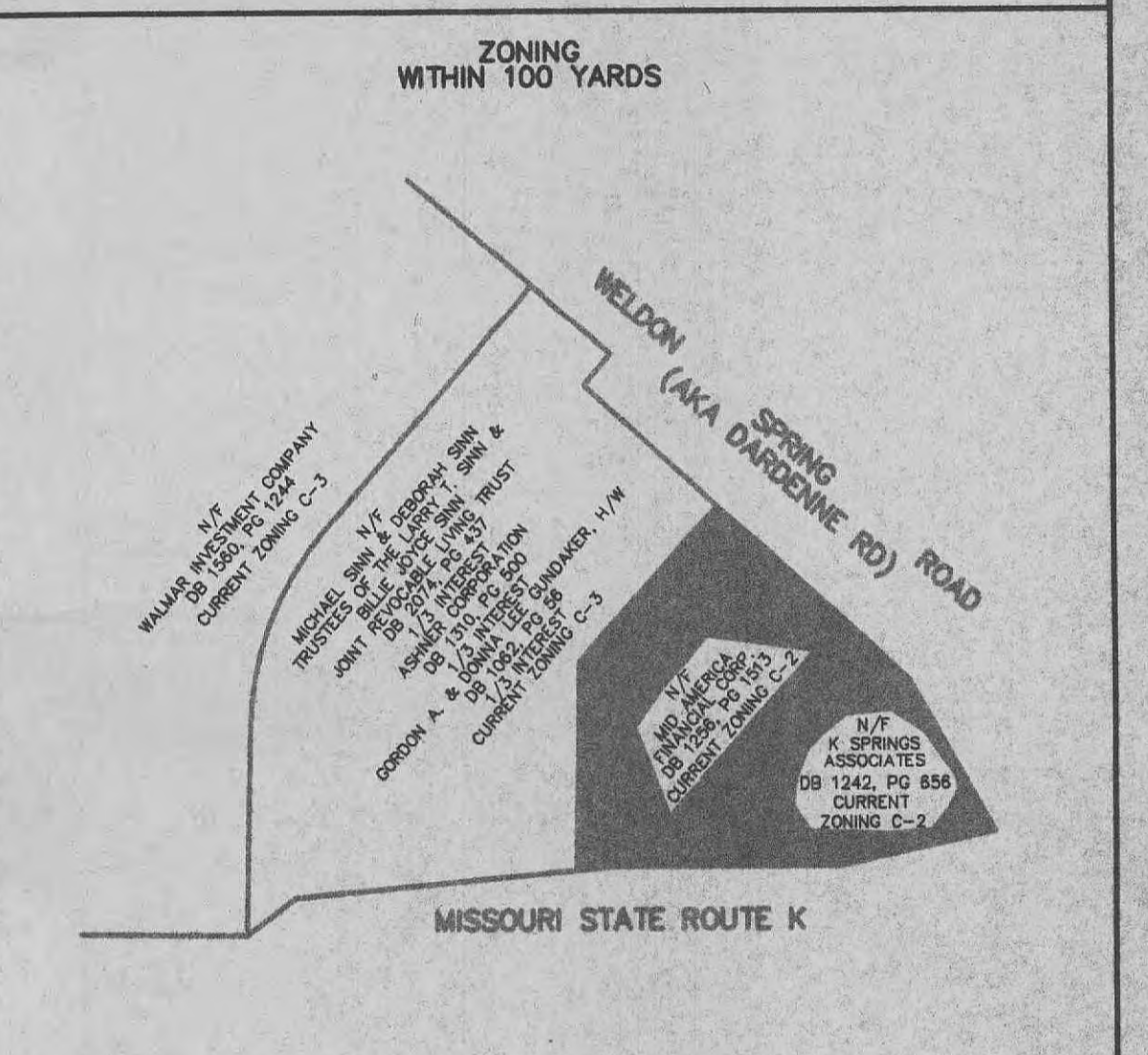

The original of this drawing is on file at the office of The Clayton Engineering Company. Any modifications to this drawing shall release said Clayton Engineering Company, the Engineer and/or the Surveyor whose seal appears hereon from any liability resulting from said unauthorized modifications.

APPROVED
 AS NOTED
 10-29-99
 [Signature]
 Chris Longwell

NO.	DATE	BY	DESCRIPTION
1	8/26/99	BJG	REVISED PER QUIKTRIP REVIEW
2	9/13/99	HRL	REVISED PER CITY & FIRE DIST. COMMENTS
3	10/1/99	EEX	Added Temp. Asphalt Curb per City review
4	10/14/99	BJG	Added Pavement Marking @ Entr.

QUIKTRIP #632
 SITE DIMENSION PLAN

8711 WELDON SPRING RD. O'FALLON, MO 63336

the clayton engineering company, inc.
 ENGINEERS • SURVEYORS • PLANNERS
 11920 WESTLINE INDUSTRIAL DRIVE
 ST. CHARLES, MO. 63303
 PH # (314) 916-5706
 FAX # (314) 916-5754

Designed: DJB
 Drawn: HRL
 Checked: EEX
 Date: 8/16/99
 Project Number: 99051
 Sheet Number: 1 of 11

FILE P:\99051\PLANS\STEPAN.DWG PLOTTED 10/01/1999 10:47 AM
 F.S. F.B.1222 SUR.