

LANDSCAPE SCHEDULE				
SYMBOL	COMMON NAME	MINIMUM SIZE/ HEIGHT/SPREAD	SPACING	COMMENTS
	CRIMSON PYGMY BARBERRY <i>berberis thunbergii</i>	3 GAL. 12" x 15" HT MIN	18" C/C	SEE LANDSCAPE SHEET FOR BED LOCATIONS, DETAILS AND PLANT SPACING
	SEA GREEN JUNIPER <i>Juniperus sabina</i> (VERTICAL VARIETY)	5 GAL. 24" x 24" HT MIN	24" C/C	
	SCOTS PINE <i>pinus sylvestris</i>	1" CALIPER 6' MINIMUM HT		VERIFY TREE TYPE, LOCATION, SIZE, HEIGHT, AND SPREAD WITH OT REPRESENTATIVE PRIOR TO INSTALLATION
	ARISTOCRAT PEAR <i>pyrus calleryana</i>	1-1/2" CALIPER 12' HT		
	SKYLINE HONEY LOCUST <i>gleditsia triacanthos (skyline)</i>	3" CALIPER 15'		
	FESCUE CYPRUS MULCH			

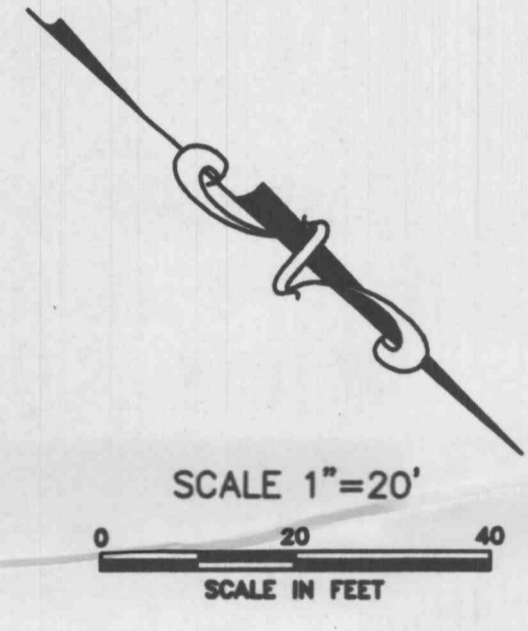

LANDSCAPE NOTES:
THERE ARE NO EXISTING TREES ON SITE.

REQUIRED LANDSCAPING:
1 TREE FOR EACH 40' OF STREET FRONTAGE
460' OF STREET FRONTAGE = 12 TREES
1 TREE FOR EACH 3000 S.F. OF OPEN SPACE
11,579 S.F. OF OPEN SPACE = 4 TREES
REQUIRED TO PROVIDE 16 TREES
PROVIDING 22 TREES

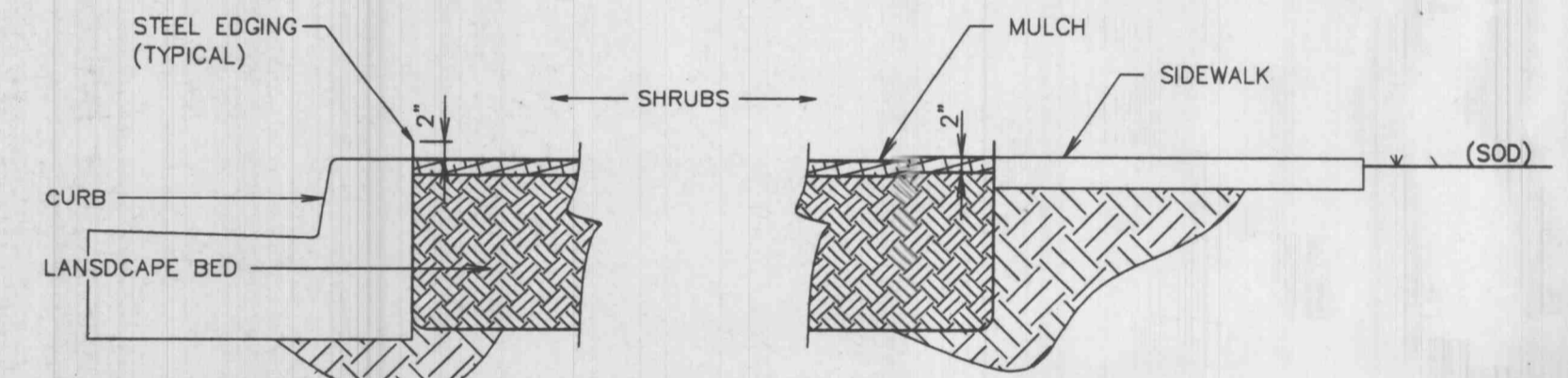

ALTERNATE EDGE OF LANDSCAPE BED DETAIL WHEN ADJACENT TO SIDEWALK OR CURB

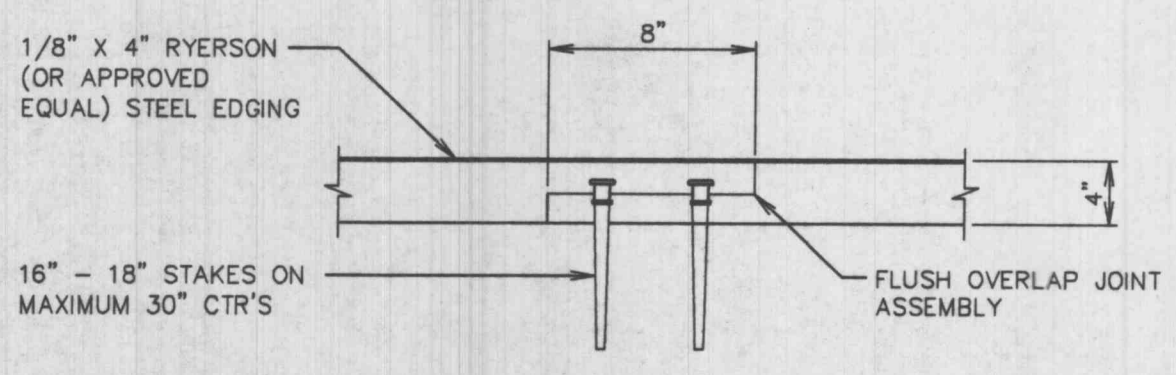

TYPICAL STEEL EDGING DETAIL

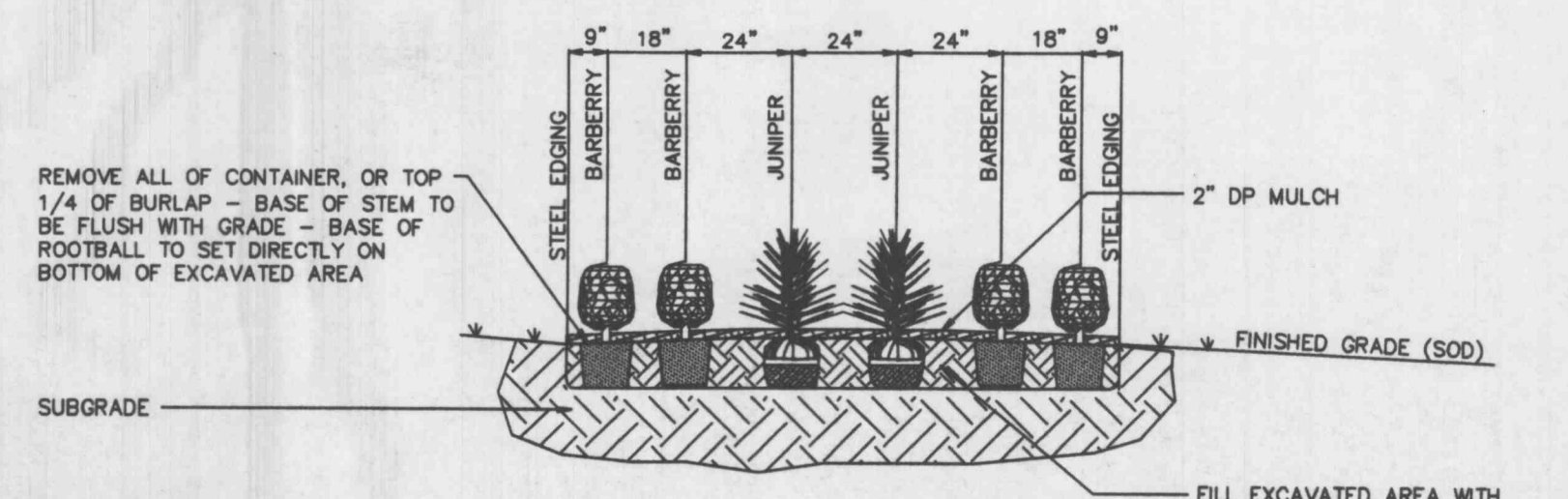

SHRUB PLANTING DETAIL (SECTION A - A)

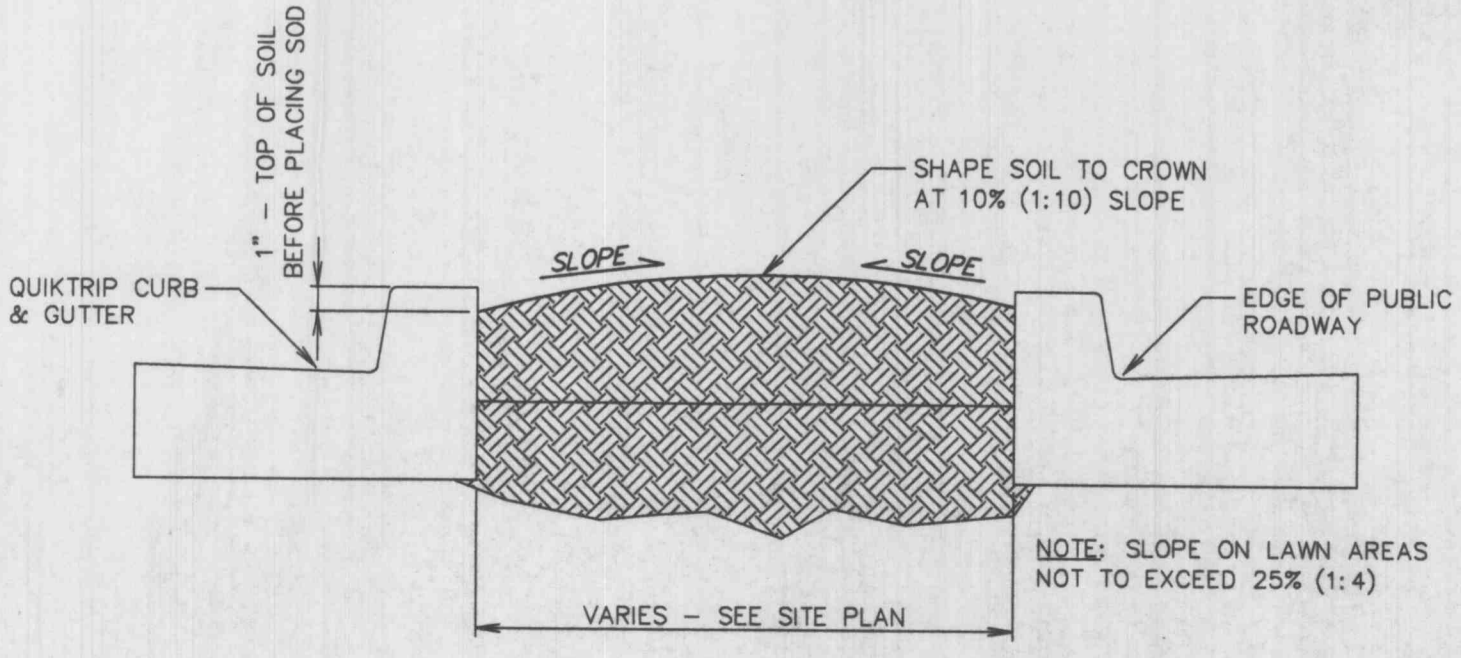

LAWN SECTION

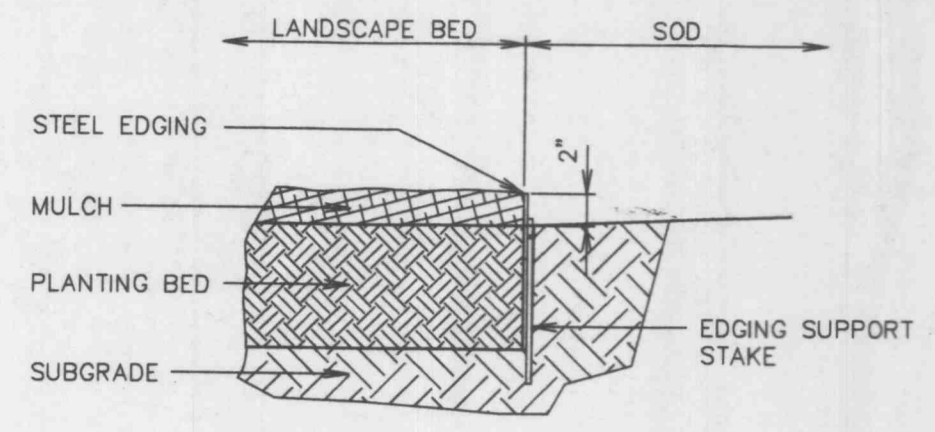

EDGE OF LANDSCAPE BED DETAIL WHEN ADJACENT TO SOD AREA

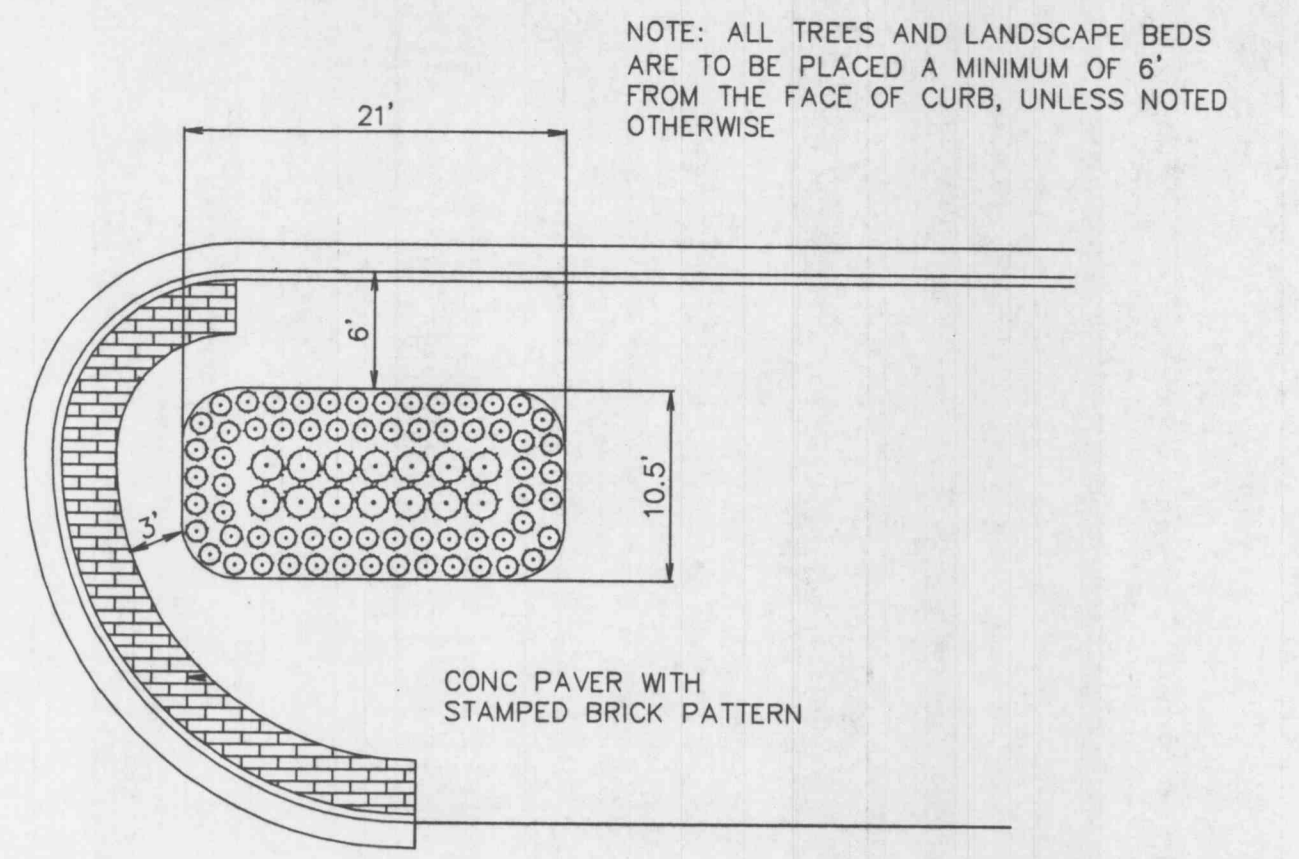
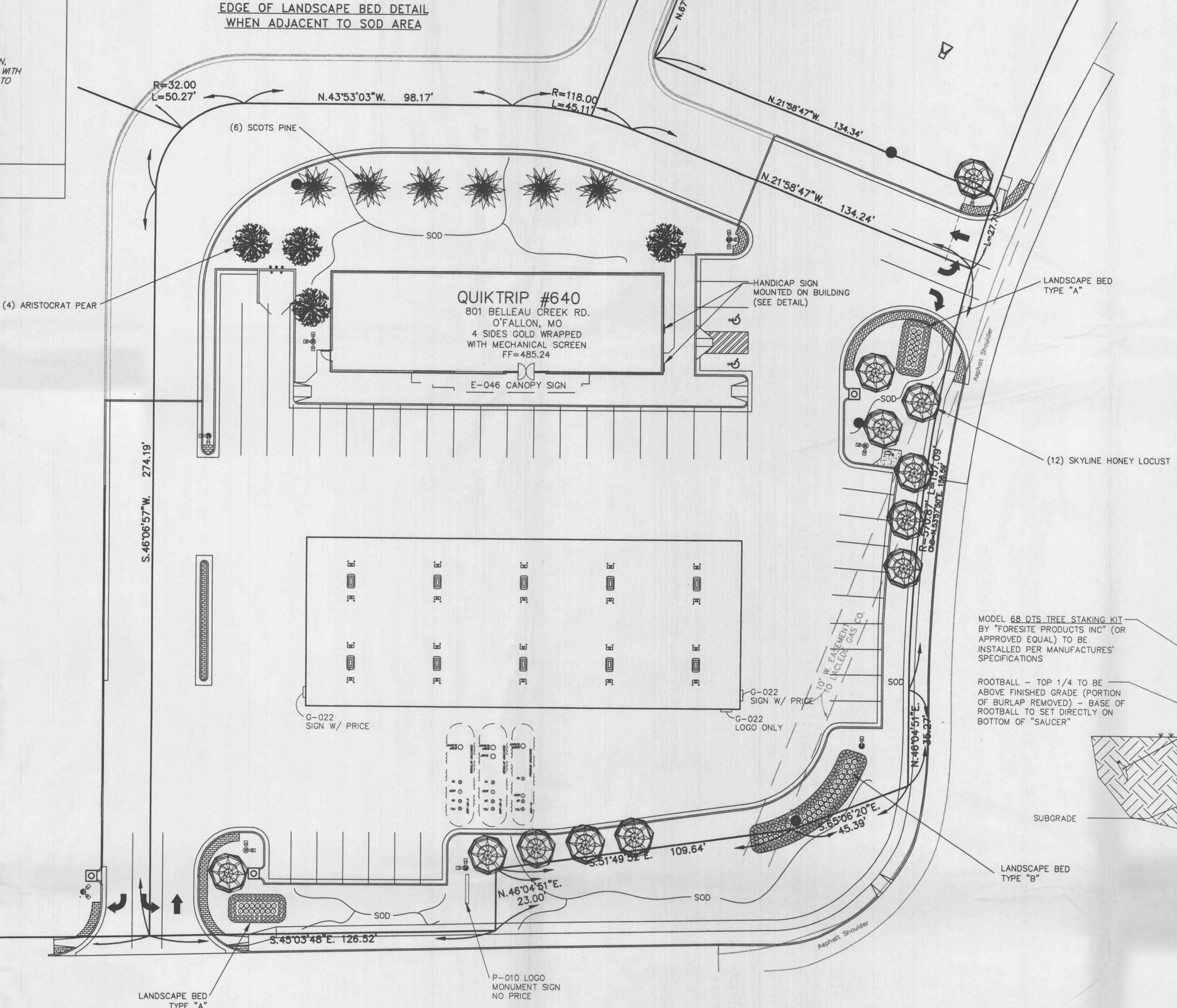

LANDSCAPE BED TYPE "A"

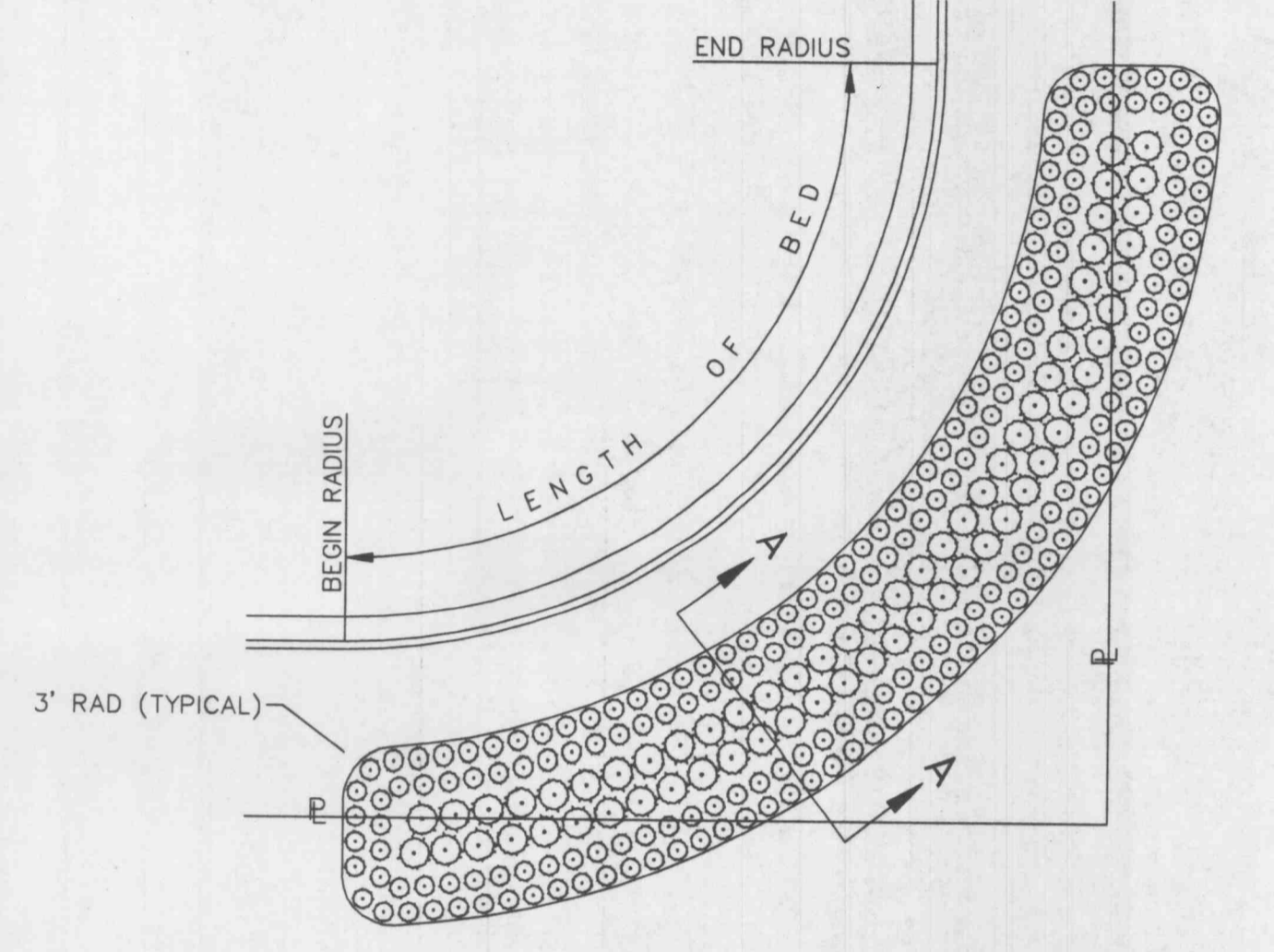

LANDSCAPE BED TYPE "B"

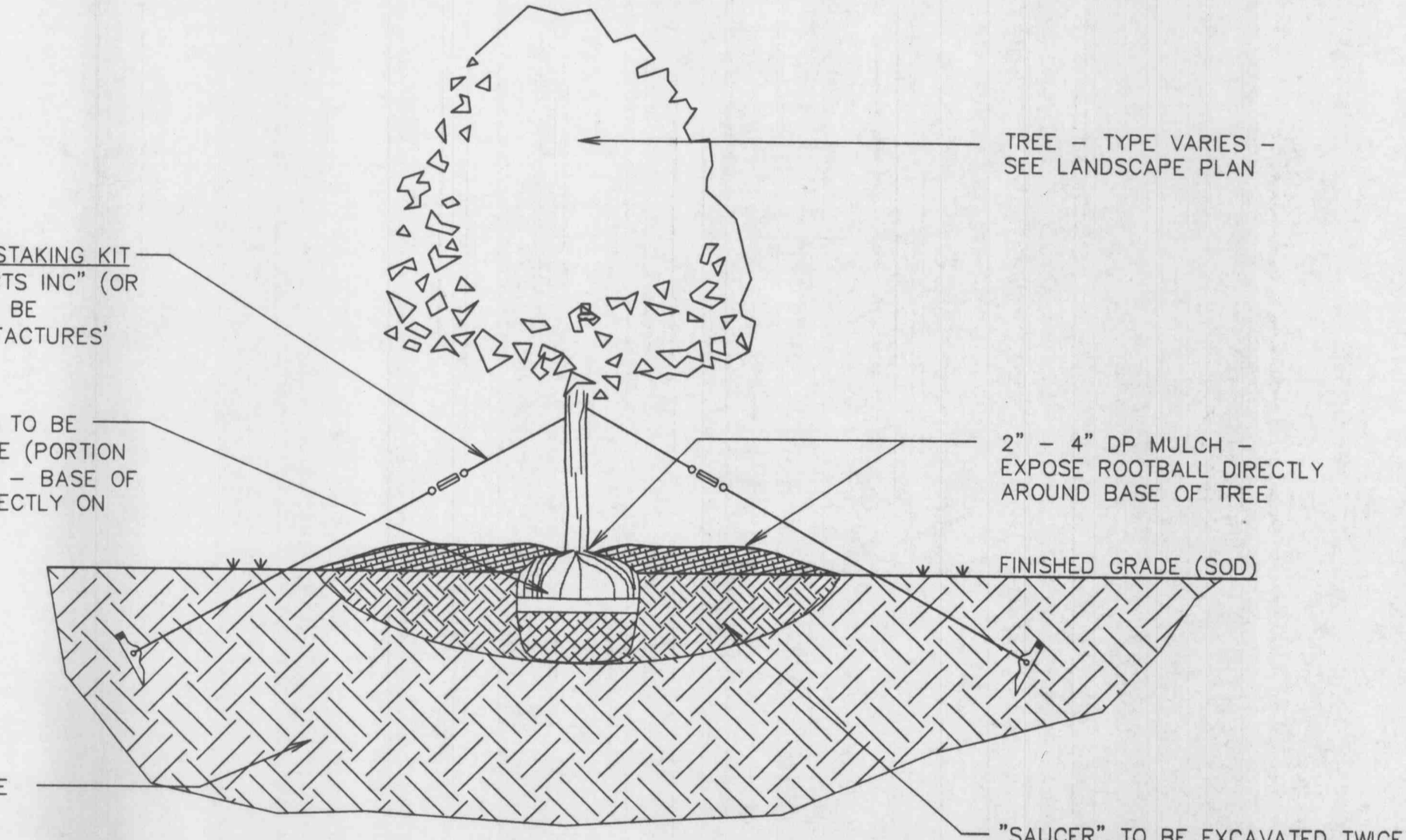

TREE PLANTING DETAIL FOR TREES 3"Ø OR GREATER

NOTE: TREES THAT ARE LESS THAN 3"Ø SHALL BE SECURED WITH TYPICAL WIRE/TWINE SUPPORTS FASTENED TO WOOD STAKES AT THE GROUND AND PADDED AROUND THE TREE TRUNK WITH RUBBER HOSE. STAKES SHALL BE DRIVEN SO AS TO PROTRUDE 2" ± ABOVE GROUND LEVEL

The original of this drawing is on file at the office of The Clayton Engineering Company. Any modifications to this drawing shall release said Clayton Engineering Company, the Engineer and/or the Surveyor whose seal appears hereon from any liability resulting from said unauthorized modifications.

NO.	DATE	BY	REVISIONS
5.	3/1/01	AJM	REVISED PER MODOT
4.	1/18/01	AJM	REVISED PER CITY
3.	1/3/01	AJM	REVISED PER QUICKTRIP & CITY
2.	12/12/00	AJM	REVISED PER QUICKTRIP
1.	11/9/00	AJM	REVISED PER QUICKTRIP

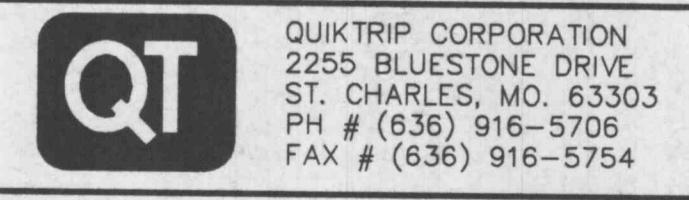

QUICKTRIP #640 LANDSCAPE PLAN

801 BELLEAU CREEK ROAD O'FALLON, MISSOURI 63366

the clayton engineering company, inc.
ENGINEERS • SURVEYORS • PLANNERS
11920 WESTLINE INDUSTRIAL DRIVE
ST. LOUIS, MISSOURI 63146
(314) 692-8888 FAX: (314) 692-8688
clayton-engineering.com

Designed: ECK/AJM
Drawn: AJM
Checked: DAC
Date: 10/10/00
Project Number: 99301
Sheet Number: 3 of 11



Underground facilities, structures and utilities have been plotted from available surveys, records and information, and therefore, do not necessarily reflect the actual existence, non-existence, size, type, number of, or location of these facilities, structures, and utilities. The Contractor shall be responsible for verifying the actual location of all underground facilities, structures, and utilities, either shown or not shown on these plans. The underground facilities, structures, and utilities shall be located in the field prior to any grading, excavation or construction of improvements. These provisions shall in no way absolve any party from complying with the Underground Facility Safety and Damage Prevention Act, Chapter 319, RSMo.