

FILE LOCATION: K:\141029 - QuikTrip #0643 Mexico and Highway K\Civil\06-0643 DETAILS PAVING.DWG TAB NAME: Paving Detail Sheet 4 USER: rkrmyer SAVED: 6/11/2015 7:22 AM PLOTTED: 12/16/2015 8:16 AM

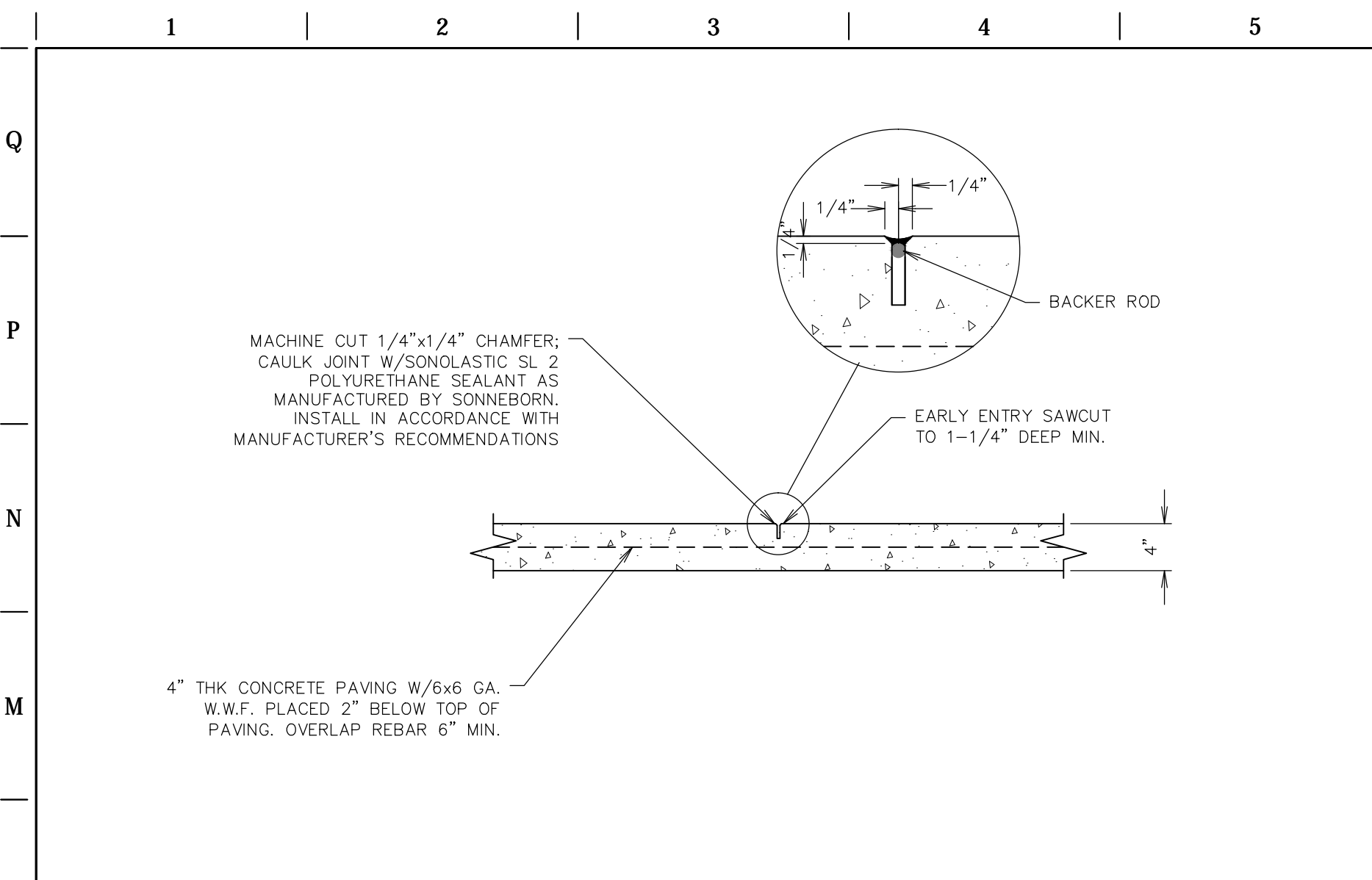

**L1** BUILDING SIDEWALK JOINT - CONTRACTION  
NTS SN: PD061A001

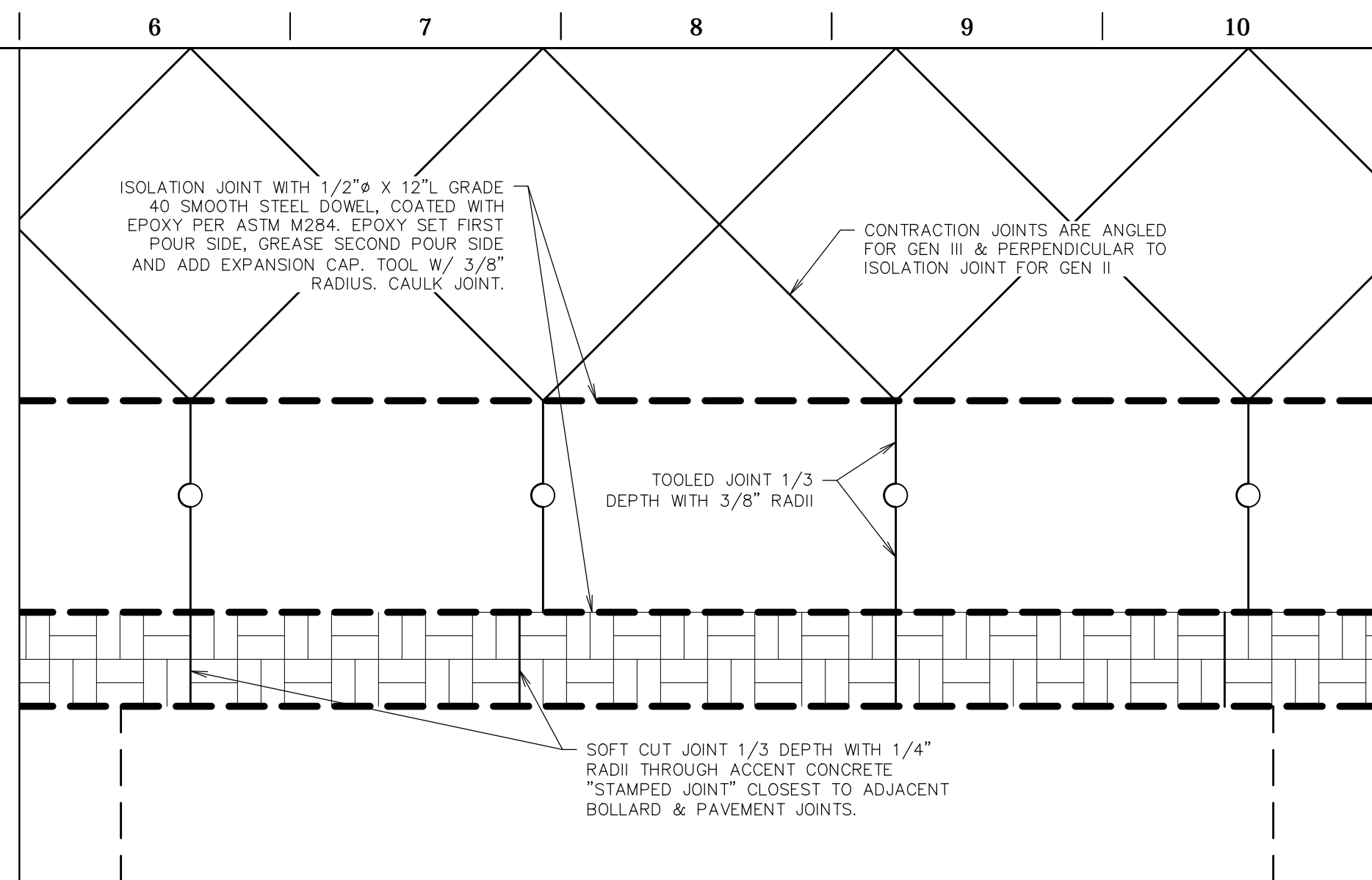

**L6** QT ACCENT CONCRETE STRIP JOINTING DETAIL  
NTS SN: PD041A003

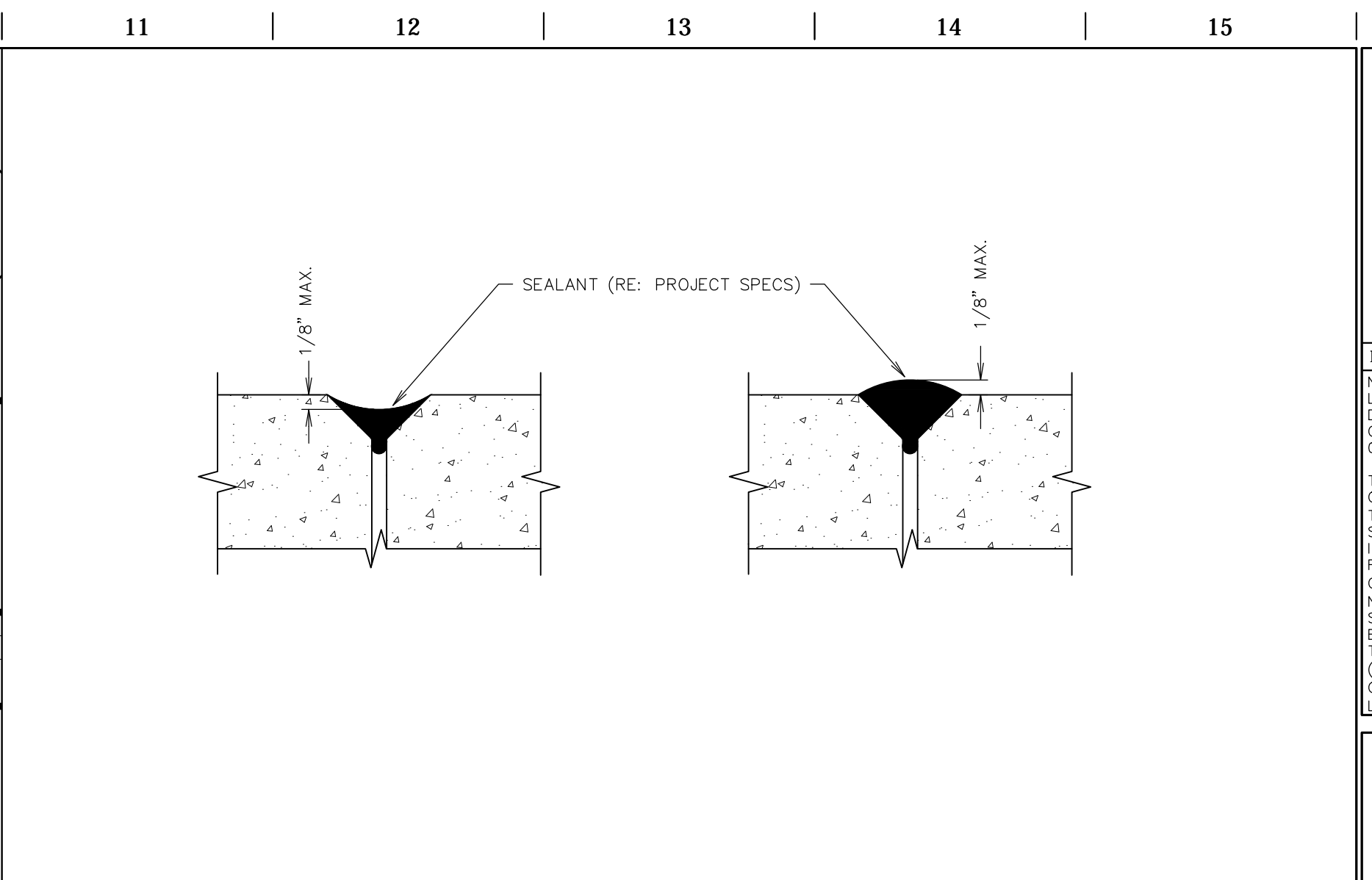

**L11** PAVING JOINT - SEALANT TOLERANCE DETAIL  
NTS SN: PD042A003

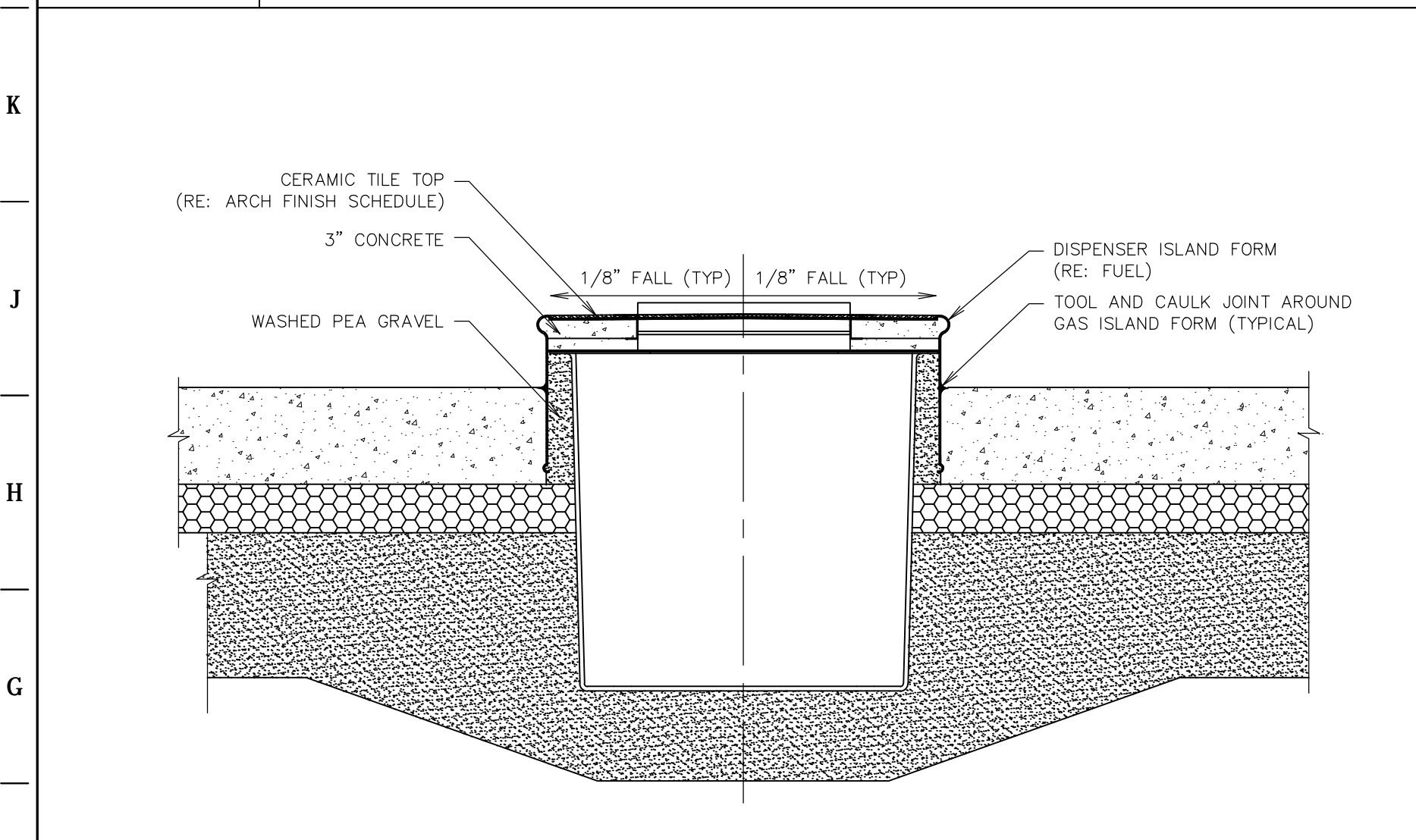

**F1** DISPENSER ISLAND FORM - CONCRETE FILL & JOINTING DETAIL  
NTS SN: PD047A003

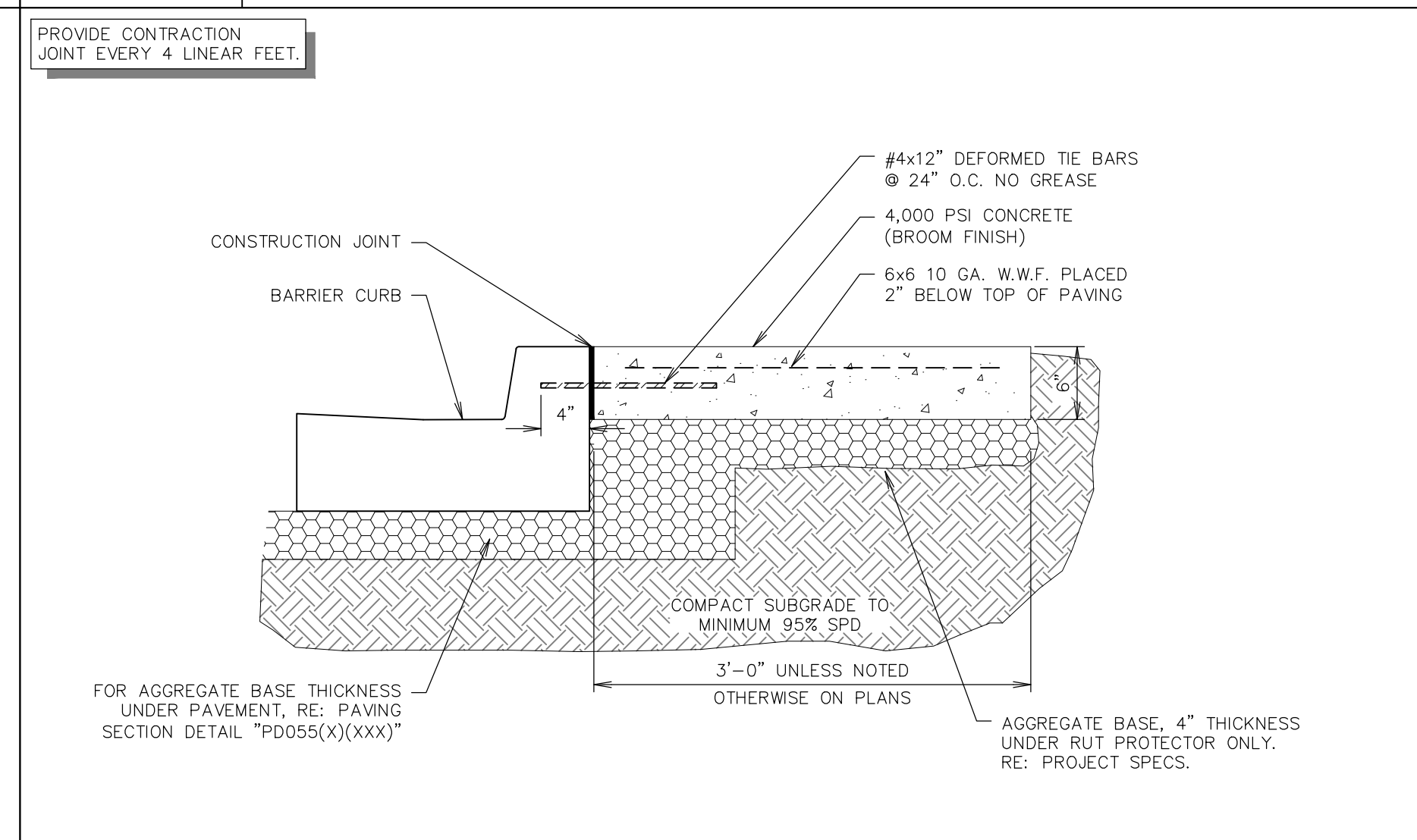

**F6** RUT PROTECTOR SECTION  
NTS SN: PD060A001

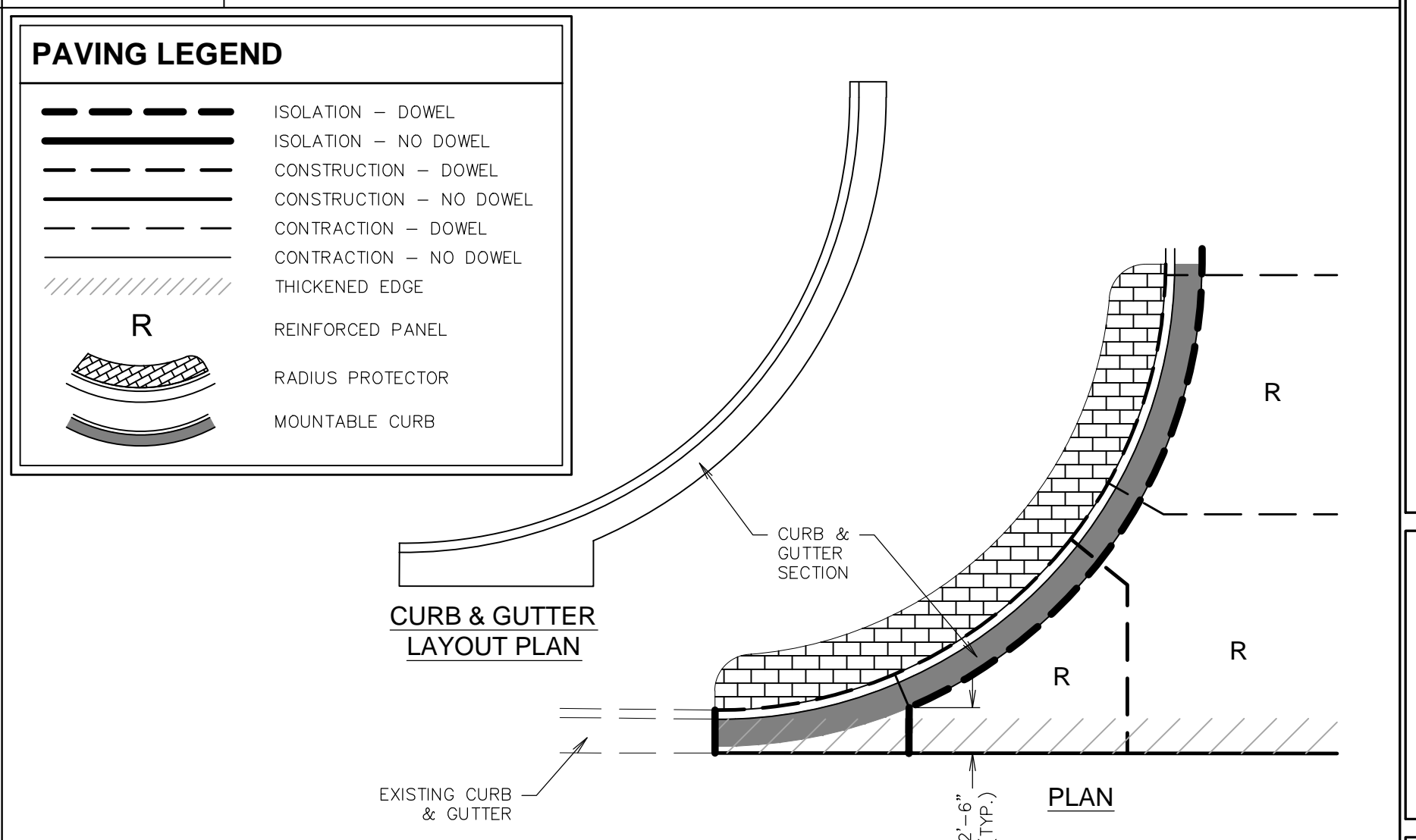

**F11** CURB DETAIL - DRIVE ENTRANCE  
NTS SN: PD043A001

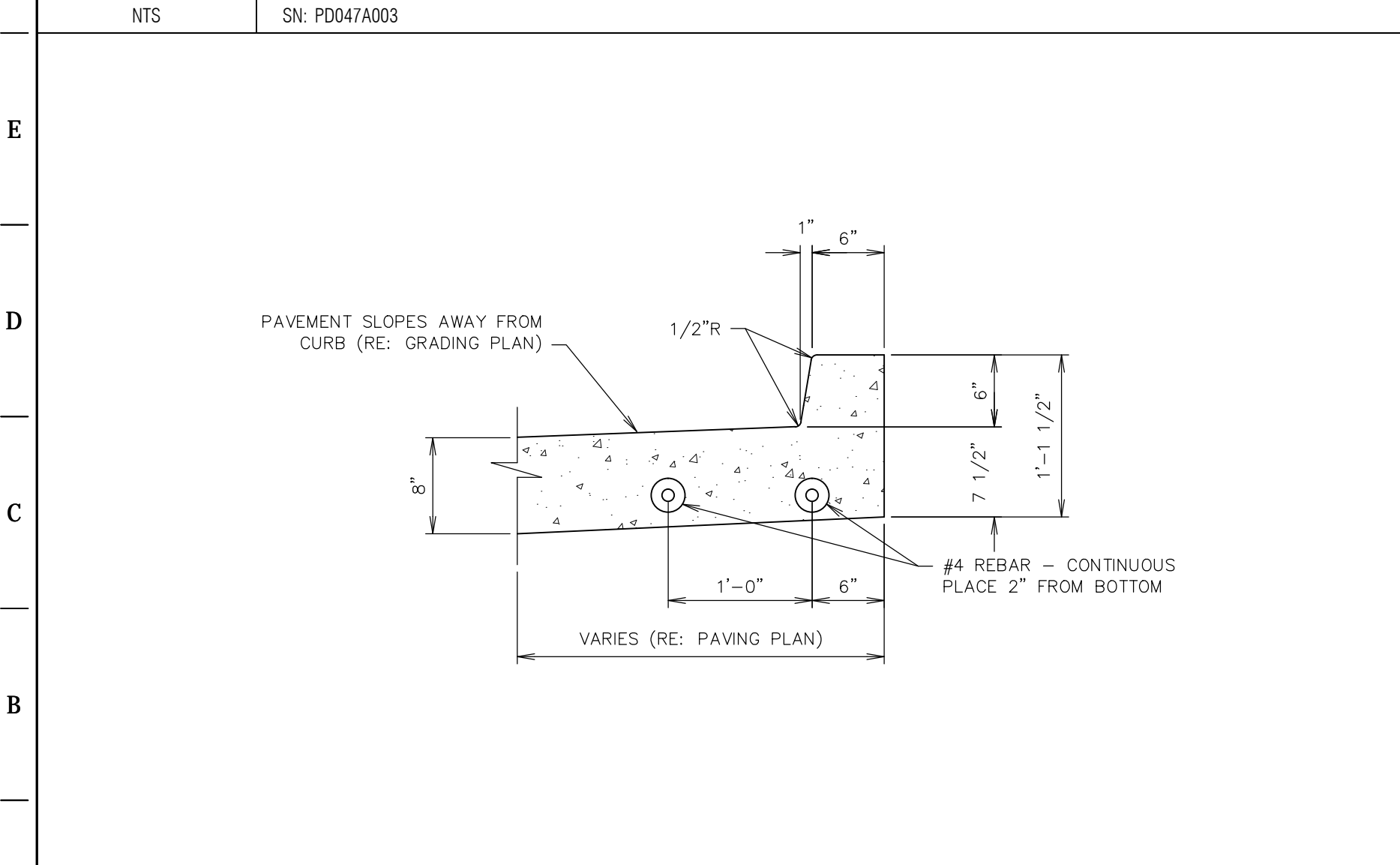

**A1** CURB DETAIL - MONOLITHIC @ TANK BUMP OUT  
NTS SN: PD048A001

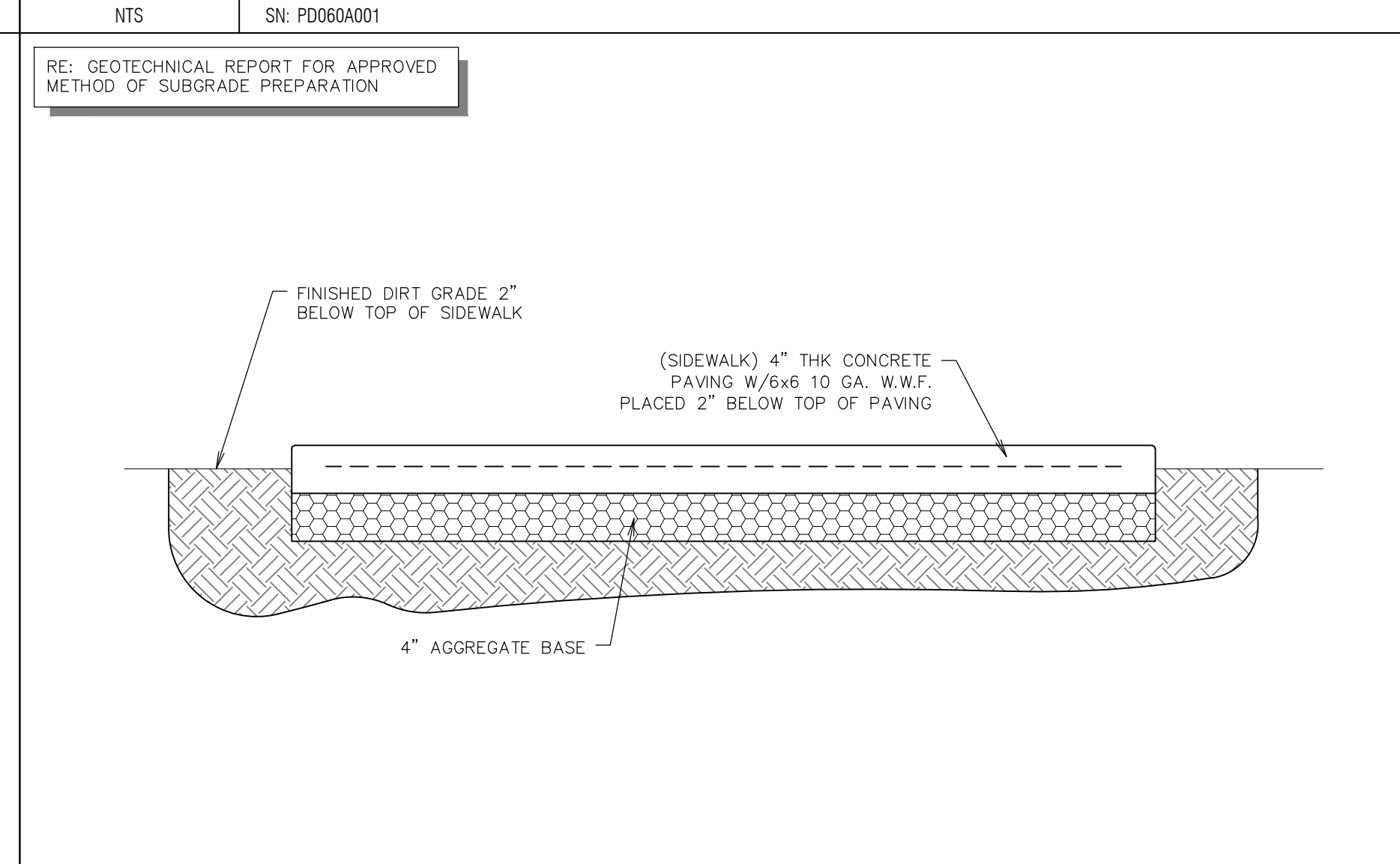

**A6** SIDEWALK SECTION  
NTS SN: PD057A001

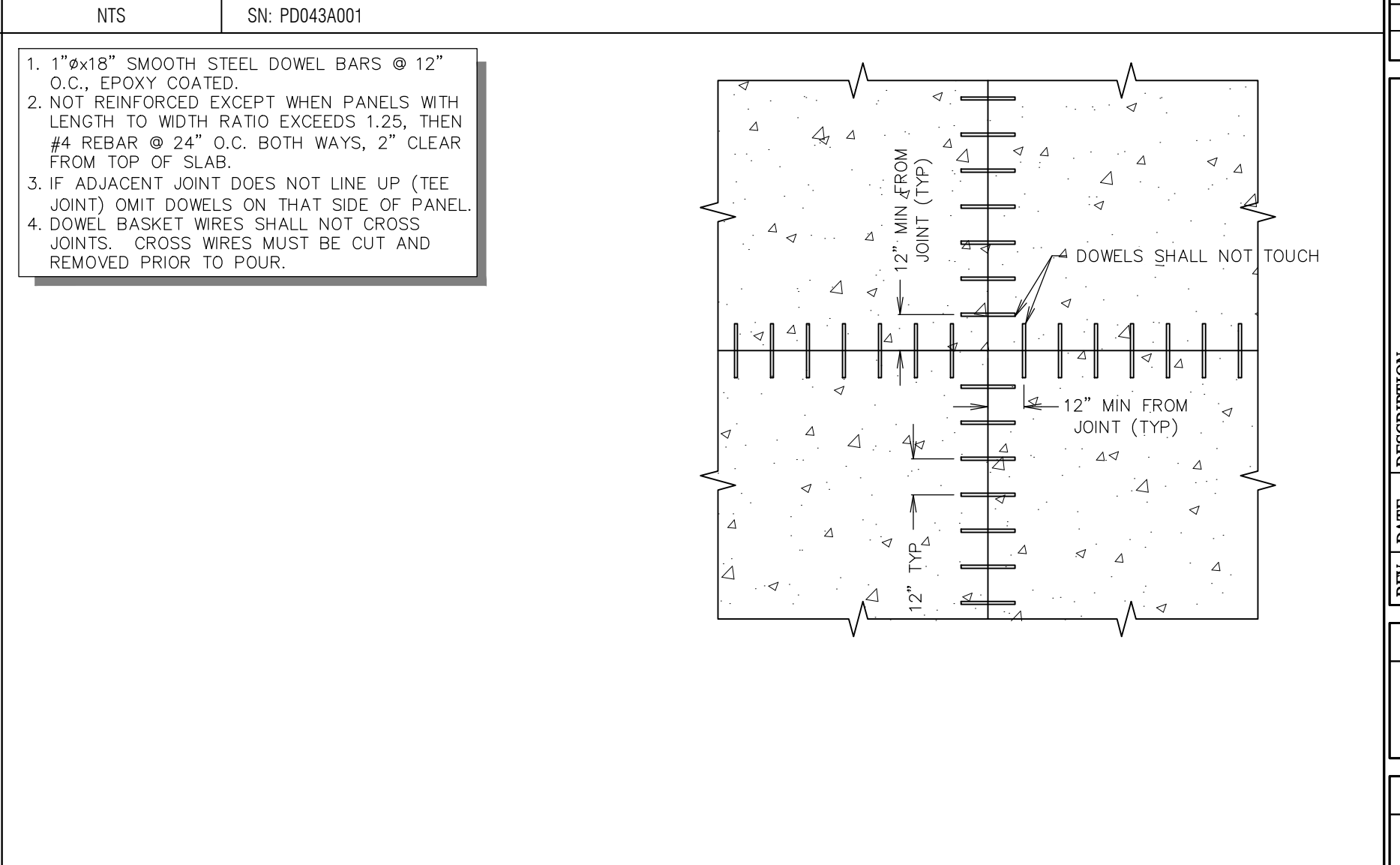

**A11** DOWEL - JOINT SEPARATION DETAIL  
NTS SN: PD046A001

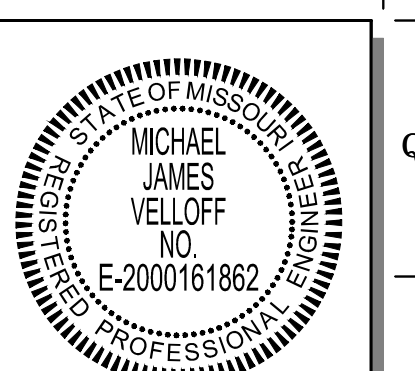

PROJECT NO.: 141029  
NAME: MICHAEL J. VELLOFF  
LICENSE NUMBER: E-2000161862  
DISCIPLINE: CIVIL  
CORPORATION AUTHORITY NUMBER: 00184  
THE SEAL OF MICHAEL J. VELLOFF ON THIS DRAWING APPLIES ONLY TO THE CIVIL/SITE ENGINEERING SHOWN. IT DOES NOT APPLY, NOR IS ANY RESPONSIBILITY TAKEN FOR ENVIRONMENTAL, GEOTECHNICAL (INCLUDING BUT NOT LIMITED TO SLOPE STABILITY), STRUCTURAL, HVAC, PLUMBING, ELECTRICAL, FIRE PROTECTION, TRAFFIC ENGINEERING, SURVEYING (BOUNDARY AND TOPOGRAPHIC), OR ARCHITECTURAL (BUILDING OR LANDSCAPE).

**QuikTrip No. 0643S**  
8601 Mexico Road  
O'Fallon, Missouri 63366

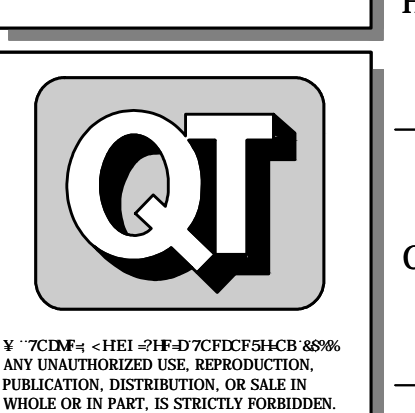

PROTOTYPE: P-83  
DIVISION: 06  
VERSION: 001  
DESIGNED BY: RKF  
DRAWN BY: RKF  
REVIEWED BY: MJV

REV	DATE	DESCRIPTION

SHEET TITLE:  
PAVING DETAILS

SHEET NUMBER:  
**C523**

ORIGINAL ISSUE DATE: 07-24-15