



QuikTrip.

2255 Bluestone Drive
St. Charles, MO 63303
(636) 916-5706

GENERAL NOTES

UTILITY INSTALLATION CONSIDERATIONS
AS POSSIBLE, ALL PROPOSED UTILITIES SHALL BE ROUTED THROUGH IMPERVIOUS AREAS SPECIFICALLY AVOIDING ON-SITE PAVED AREAS DESIGNATED FOR PARKING, ACCESS, AND VEHICULAR TRAFFIC FLOW.
REFER TO THIS SHEET FOR LOCATION, AND SHEETS 15 AND 16 FOR TRENCHING, BACKFILL, AND REPLACEMENT DETAILS.

© COPYRIGHT
1998 QUIKTRIP CORPORATION
DESIGN PATENTS
QUIKTRIP PLANS ARE THE EXCLUSIVE PROPERTY OF QUIKTRIP CORPORATION, TULSA, OKLAHOMA. THESE PLANS ARE PROTECTED BY THEIR EXISTING U.S. DOMESTIC AND INTERNATIONAL COPYRIGHT AND PATENT STATUTES. ANY UNAUTHORIZED USE, REPRODUCTION, PUBLICATION, DISTRIBUTION OR SALE IN WHOLE OR IN PART, IS STRICTLY FORBIDDEN.

No.	Revision	Date
3	OWNER REVISIONS	3/24/09
1	CITY COMMENTS	9/20/07

EFK•Moen, LLC
Civil Engineering Design
13523 Barrett Parkway Dr. Suite 250
St. Louis, MO 63021
Phone (314)729-4100 Fax (314)729-4199

STORM PROFILES - 2

DRAWN BY: JAA	SHEET
DESIGNED BY: CDL	13
CHECKED BY: PJK	
ISSUE DATE: Mar 24, 2009	OF 27

SCALE:
VERT: 1" = 5'
HORIZ: 1" = 10'

NOTE:
PIPE REACHES LABELED AS PRIVATE MAY BE PVC AS INDICATED OR A SMOOTH WALL HDPE EQUIVALENT.

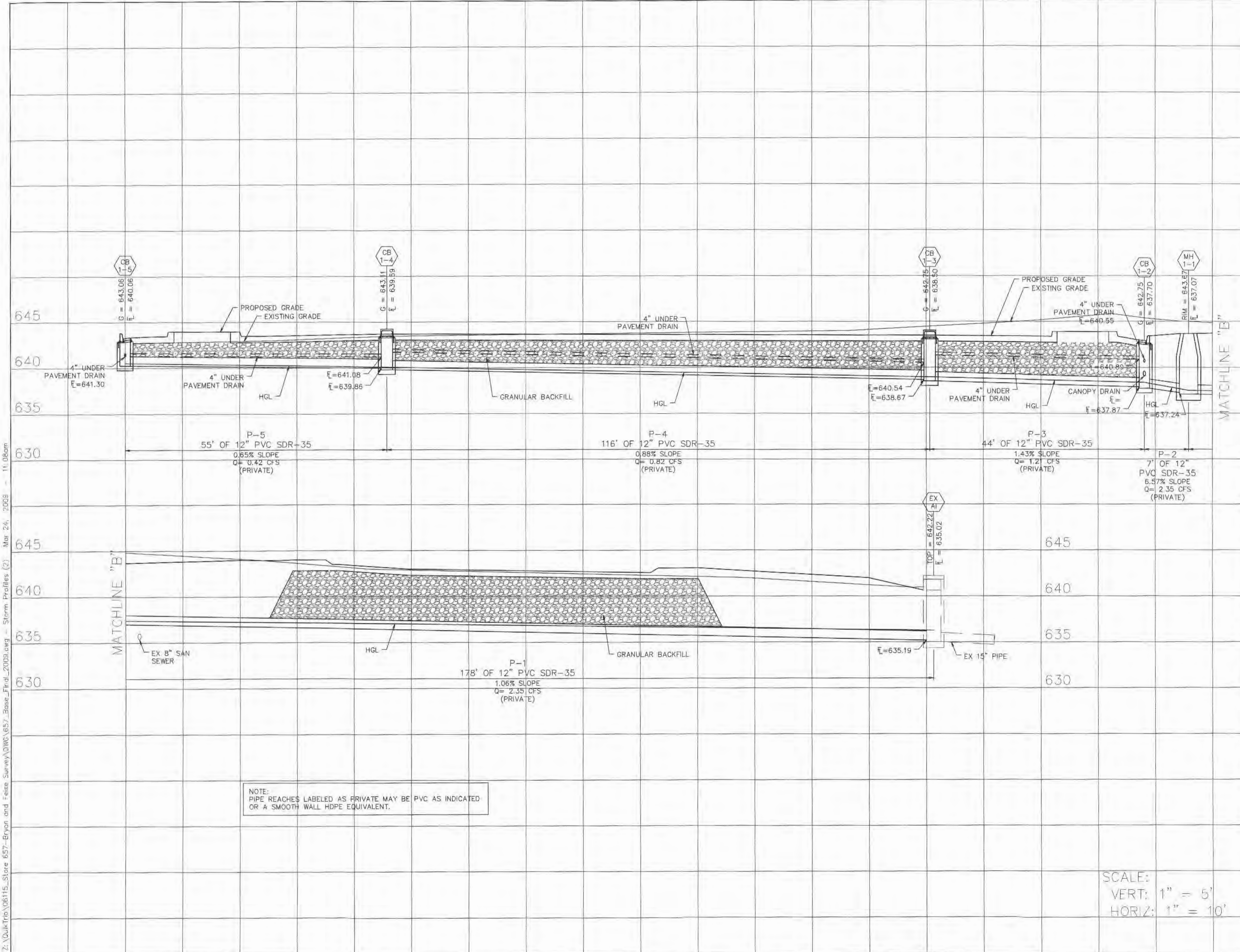

Z:\QuikTrip\06115_Store 657-Erjon and Feise Survey\DWG\657_Base_Final_2009.dwg - Storm Profiles (2) Mar 24, 2009 11:08am

DARDENNE PRAIRIE, MISSOURI

1150 FEISE ROAD

QuikTrip Store No. : 657