

GENERAL NOTES:

- A. IN ACCORDANCE WITH GENERALLY ACCEPTED CONSTRUCTION PRACTICES... B. CONTRACTOR SHALL BE RESPONSIBLE FOR RAZING AND REMOVAL... C. CONTRACTOR IS TO REMOVE AND DISPOSE OF ALL DEBRIS... D. THE GENERAL CONTRACTOR WILL BE HELD SOLELY RESPONSIBLE FOR AND SHALL TAKE ALL PRECAUTIONS NECESSARY TO AVOID PROPERTY DAMAGE TO ADJACENT PROPERTIES... E. ALL CONSTRUCTION IN STATE HIGHWAY DEPARTMENT RIGHT-OF-WAY SHALL BE COORDINATED WITH THE HIGHWAY DEPARTMENT... F. ALL SITE WORK FOR THIS PROJECT SHALL MEET OR EXCEED THE SPECIFICATIONS OF THE RELEVANT UTILITY COMPANY OR REGULATORY AUTHORITY...

WETLANDS NOTICE:

ANY DEVELOPMENT, EXCAVATION, CONSTRUCTION, OR FILLING IN A U.S. CORPS OF ENGINEERS DESIGNATED WETLAND IS SUBJECT TO LOCAL, STATE AND FEDERAL APPROVALS. THE CONTRACTOR SHALL COMPLY WITH ALL PERMIT REQUIREMENTS AND/OR RESTRICTIONS AND ANY VIOLATION WILL BE SUBJECT TO FEDERAL PENALTY.

WARRANTY/DISCLAIMER:

THE DESIGNS REPRESENTED IN THESE PLANS ARE IN ACCORDANCE WITH ESTABLISHED PRACTICES OF CIVIL ENGINEERING FOR THE DESIGN FUNCTIONS AND USES INTENDED BY THE OWNER AT THIS TIME. HOWEVER, NEITHER THE ENGINEER NOR ITS PERSONNEL CAN OR DO WARRANT THESE DESIGNS OR PLANS AS CONSTRUCTED EXCEPT IN THE SPECIFIC CASES WHERE THE ENGINEER INSPECTS AND CONTROLS THE PHYSICAL CONSTRUCTION ON A CONTEMPORARY BASIS AT THE SITE.

NOTICE TO BIDDERS:

ALL QUESTIONS REGARDING THE PREPARATION OF THE GENERAL CONTRACTOR'S BID SHALL BE DIRECTED TO THE OWNER'S CONSTRUCTION REPRESENTATIVE. SUBCONTRACTORS MUST DIRECT THEIR QUESTIONS THROUGH THE GENERAL CONTRACTOR, THE CONSULTING ARCHITECT AND/OR THE CONSULTING ENGINEER SHALL NOT BE CONTACTED DIRECTLY WITHOUT PRIOR AUTHORIZATION FROM THE OWNER/DEVELOPER.

FLOOD CERTIFICATION:

AS DETERMINED THROUGH GRAPHIC PLOTTING ONLY, SUBJECT TRACT FALLS IN ZONE "X"; AREAS DETERMINED TO BE OUTSIDE THE 0.2% ANNUAL CHANCE FLOODPLAIN PER THE FEDERAL EMERGENCY MANAGEMENT AGENCY FLOOD INSURANCE RATE MAP FOR ST CHARLES COUNTY, MISSOURI AND INCORPORATED AREAS, MAP NUMBER 29183C0240G, EFFECTIVE DATE OF JANUARY 01, 2016.

BENCHMARKS:

BENCHMARK INFORMATION: ELEV. 558.64 (USGS D 149)(NAVD 88) 2.3 MIIES WEST FROM O'FALLON 2.3 MILES WEST ALONG THE WABASH RAILROAD FROM THE STATION AT O'FALLON, ST. CHARLES COUNTY, 42 FEET SOUTHWEST OF MCGREE ROAD 25 FEET WEST OF A FENCE GATE, AND 2 FEET NORTH OF THE FENCE. A STANDARD DISK, STAMPED D 149 1935 AND SET IN THE TOP OF A CONCRETE POST PROJECTING 6 INCHES ABOVE GROUND.

SITE BENCHMARK: ELEV. 625.73 CUT "4" ON EAST RIM OF A MANHOLE AT THE NORTHEAST CORNER OF ADJUSTED PARCEL 1 OF QUIKTRIP NO. 662, A SUBDIVISION IN ST. CHARLES COUNTY, MISSOURI AS PER PLAT THEREOF RECORDED IN PLAT BOOK 38 PAGE 366.

CITY OF O'FALLON NOTES:

- 1. CONSTRUCTION WORK SHALL ONLY BE ALLOWED DURING THE FOLLOWING HOURS: OCTOBER 1 -- MAY 1 7:00AM TO 7:00PM MONDAY - SUNDAY JUNE 1 -- SEPTEMBER 30 6:00AM TO 8:00PM MONDAY - FRIDAY 7:00AM TO 8:00PM SATURDAY AND SUNDAY CONSTRUCTION WORK TO BE DONE OUTSIDE OF THESE HOURS REQUIRES PRIOR WRITTEN APPROVAL FROM THE CITY ADMINISTRATOR OR CITY ENGINEER. CITY APPROVAL OF THE CONSTRUCTION SITE PLANS DOES NOT MEAN THAT ANY BUILDING CAN BE CONSTRUCTED ON THE LOTS WITHOUT MEETING THE BUILDING SETBACKS AS REQUIRED BY THE ZONING CODE.

SITE DEVELOPMENT PLANS FOR QUIKTRIP STORE #0662 955 BRYAN ROAD O'FALLON, MISSOURI 63366

CITY OF O'FALLON COMMUNITY DEVELOPMENT DEPARTMENT ACCEPTED FOR CONSTRUCTION BY: [Signature] DATE: 09/07/2018 PROFESSIONAL ENGINEER'S SEAL INDICATES RESPONSIBILITY FOR DESIGN

CITY OF O'FALLON NOTES (CONT.):

- 1. ALL PROPOSED UTILITIES AND/OR UTILITY RELOCATIONS SHALL BE LOCATED UNDERGROUND. 2. IF MATERIALS SUCH AS TREES, ORGANIC DEBRIS, RUBBLE, FOUNDATIONS AND OTHER DELETERIOUS MATERIAL ARE NOT TO BE REUSED, THEY SHALL BE REMOVED FROM THE SITE AND DISPOSED OF IN COMPLIANCE WITH ALL APPLICABLE LAWS AND REGULATIONS. 3. NO SLOPES SHALL EXCEED 3 (HORIZONTAL): 1 (VERTICAL). 4. ALL FILL PLACED UNDER PROPOSED STORM AND SANITARY SEWERS, PROPOSED ROADS AND/OR PAVED AREAS SHALL BE COMPACTED TO 98% OF MAXIMUM DENSITY AS DETERMINED BY THE MODIFIED AASHTO T-99. ALL FILL PLACED IN PROPOSED ROADS SHALL BE COMPACTED FROM THE BOTTOM OF THE FILL UP. ALL TESTS SHALL BE VERIFIED BY A SOILS ENGINEER CONCURRENT WITH GRADING AND BACKFILLING OPERATIONS. 5. DEVELOPER MUST SUPPLY CITY CONSTRUCTION INSPECTORS WITH AN ENGINEER'S SOIL REPORTS PRIOR TO AND DURING SITE SOIL TESTING. 6. THE PERMITTEE SHALL ASSUME COMPLETE RESPONSIBILITY FOR CONTROLLING ALL SILTATION AND EROSION OF THE PROJECT AREA. THE PERMITTEE SHALL USE WHATEVER MEANS NECESSARY TO CONTROL EROSION AND SILTATION INCLUDING, BUT NOT LIMITED TO, STAKED STRAW BALES AND/OR SILTATION FABRIC FENCES (POSSIBLE METHODS OF CONTROL ARE DETAILED IN THE PLAN). CONTROL SHALL COMMENCE WITH THE CLEARING OPERATIONS AND BE MAINTAINED THROUGHOUT THE PROJECT UNTIL ACCEPTANCE OF THE WORK BY THE CITY OF O'FALLON AND AS NECESSARY BY MODOT. THE PERMITTEE'S RESPONSIBILITIES INCLUDE ALL DESIGN AND IMPLEMENTATION AS REQUIRED TO PREVENT EROSION AND THE DEPOSITING OF SILT. THE CITY OF O'FALLON AND AS REQUIRED BY MODOT MAY AT THEIR OPTION DIRECT THE PERMITTEE IN HIS METHODS AS DEEMED FIT TO PROJECT PROPERTY AND IMPROVEMENTS. ANY DEPOSITING OF SILT OR MUD ON NEW OR EXISTING PAVEMENT SHALL BE REMOVED IMMEDIATELY. ANY DEPOSITING OF SILTS OR MUD IN NEW OR EXISTING STORM SEWERS OR SWALES SHALL BE REMOVED AFTER EACH RAIN AND AFFECTED AREAS CLEANED TO THE SATISFACTION OF THE CITY OF O'FALLON AND AS REQUIRED BY MODOT. 7. ALL EROSION CONTROL SYSTEMS ARE INSPECTED AND CORRECTED WEEKLY, ESPECIALLY WITHIN 48 HOURS OF ANY RAINSTORM RESULTING IN ONE-HALF INCH OF RAIN OR MORE. ANY SILT OR DEBRIS LEAVING THE SITE AND AFFECTING PUBLIC RIGHTS-OF-WAYS OR STORM WATER DRAINAGE FACILITIES SHALL BE CLEANED UP WITHIN 24 HOURS AFTER THE END OF THE STORM. 8. ANY EXISTING WELLS AND/OR SPRINGS WHICH MAY EXIST ON THE PROPERTY MUST BE SEALED IN A MANNER ACCEPTABLE TO THE CITY OF O'FALLON CONSTRUCTION INSPECTION DEPARTMENT AND FOLLOWING MISSOURI DEPARTMENT OF NATURAL RESOURCES STANDARDS AND SPECIFICATIONS. 9. ALL PAVING TO BE IN ACCORDANCE WITH ST. CHARLES COUNTY STANDARDS AND SPECIFICATIONS EXCEPT AS MODIFIED BY THE CITY OF O'FALLON ORDINANCES. 10. SIDEWALKS, CURB RAMPS AND ACCESSIBLE PARKING SPACES SHALL BE CONSTRUCTED IN ACCORDANCE WITH CURRENTLY APPROVED AMERICANS WITH DISABILITIES ACT ACCESSIBILITY GUIDELINES ALONG WITH THE REQUIRED GRADES, SIGNAGE, SPECIFICATIONS AND CONSTRUCTION MATERIALS. IF ANY CONFLICT OCCURS BETWEEN THE ABOVE INFORMATION AND THE PLANS, THE ADAAG GUIDELINES SHALL BE FOLLOWED AND THE CONTRACTOR, PRIOR TO ANY CONSTRUCTION, SHALL NOTIFY THE PROJECT ENGINEER. 11. ALL INSTALLATIONS AND CONSTRUCTION SHALL CONFORM TO THE APPROVED ENGINEERING DRAWINGS. HOWEVER, IF THE DEVELOPER CHOOSES TO MAKE MINOR MODIFICATIONS IN DESIGN AND/OR SPECIFICATIONS DURING CONSTRUCTION, HE/SHE SHALL MAKE SUCH CHANGES AT HIS/HER OWN RISK, WITHOUT ANY ASSURANCE THAT THE CITY ENGINEER WILL APPROVE THE COMPLETED INSTALLATION OR CONSTRUCTION. IT SHALL BE THE RESPONSIBILITY OF THE DEVELOPER TO NOTIFY THE CITY ENGINEER OF ANY CHANGES FROM THE APPROVED DRAWINGS. THE DEVELOPER MAY BE REQUIRED TO CORRECT THE INSTALLED IMPROVEMENTS SO AS TO CONFORM TO THE APPROVED ENGINEERING DRAWINGS. THE DEVELOPER MAY REQUEST A LETTER FROM THE CONSTRUCTION INSPECTION DIVISION REGARDING ANY FIELD CHANGES APPROVED BY THE CITY INSPECTORS. 12. TRAFFIC CONTROL IS TO BE PER MODOT OR MUTCD WHICHEVER IS MORE STRINGENT. 13. ALL TRAFFIC SIGNALS, STREET SIGNS, SIGN POST, BACKS AND BRACKET ARMS SHALL BE PAINTED BLACK USING CARBOLINE RUSTBOND PENETRATING SEALER SG AND CARBOLINE 133 HB PAINT (OR EQUIVALENT AS APPROVED BY THE CITY OF O'FALLON AND MODOT). 14. ALL SANITARY LATERALS AND SANITARY MAINS CROSSING UNDER PAVEMENT MUST HAVE PROPER ROCK BACKFILL AND REQUIRED COMPACTION. 15. LIGHTING VALUES WILL BE REVIEWED ON SITE PRIOR TO THE FINAL OCCUPANCY INSPECTION. 16. CONNECTIONS AT ALL SANITARY OR STORM STRUCTURES TO BE MADE WITH A-LOCK JOINT OR EQUAL. 17. BRICK SHALL NOT BE USED IN THE CONSTRUCTION OF SANITARY OR STORM SEWER STRUCTURES. PRE-CAST CONCRETE STRUCTURES ARE TO BE USED UNLESS OTHERWISE APPROVED BY THE CITY. 18. ALL CONCRETE PIPES WILL BE INSTALLED WITH O-RING RUBBER TYPE GASKETS. 19. HDPE PIPE IS TO BE N-12WT OR EQUAL AND TO MEET ASTM F1417 WATER TIGHT FIELD TEST. 20. REFER TO WATER JETTING SPECIFICATIONS AS A NOTE AS SHOWN IN SECTION 405.210(D)(1). 21. RIP-RAP SHOWN AT FLARED ENDS WILL BE EVALUATED IN THE FIELD BY THE ENGINEER, CONTRACTOR AND CITY INSPECTOR AFTER INSTALLATION FOR EFFECTIVENESS AND FIELD MODIFIED, IF NECESSARY, TO REDUCE EROSION ON AND OFF-SITE. 22. A 3/4" TRASH BAR SHALL BE CENTERED WITHIN THE OPENING(S) OF ALL CURB INLETS AND AREA INLETS. 23. ALL IDENTIFICATION OR DIRECTIONAL SIGN(S) MUST HAVE THE LOCATIONS AND SIZES APPROVED AND PERMITTED SEPARATELY THROUGH THE PLANNING AND DEVELOPMENT DIVISION. 24. NO GRADED AREAS ARE TO REMAIN BARE FOR OVER 14 DAYS WITHOUT BEING SEEDED AND MULCHED. 25. ALL PROPOSED FENCING REQUIRES A SEPARATE PERMIT FROM THE PLANNING AND DEVELOPMENT DIVISION. 26. NO WELLS, CISTERNS OR SPRINGS ARE ANTICIPATED ONSITE. 27. ALL SIGNAGE SHALL BE REVIEWED AND APPROVED BY A SEPARATE PERMIT PROCESS.

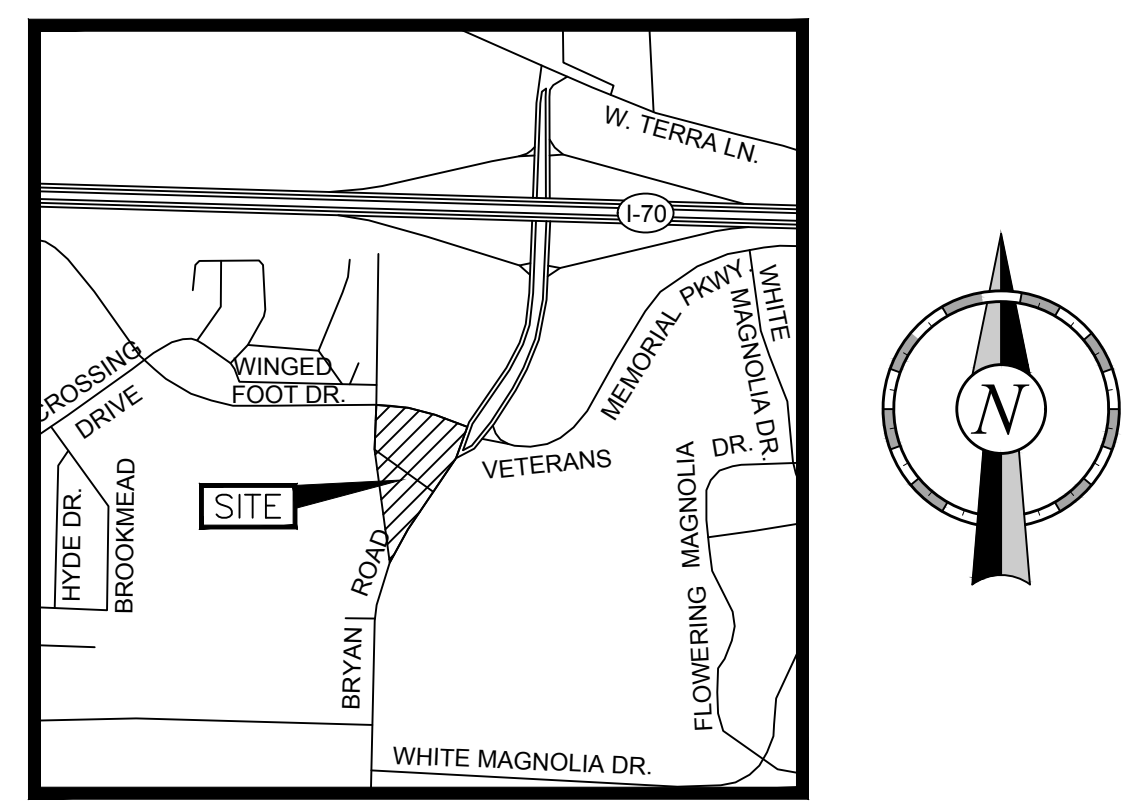

Vicinity Map Not to Scale

MUNICIPAL CONTACT LIST:

- CITY OF O'FALLON PLANNING AND INSPECTIONS DEPARTMENT PLANNING DIVISION 100 NORTH MAIN STREET O'FALLON, MISSOURI, 63366 TEL: 636-379-5541 EMAIL: DWOODS@OFALLON.MO.US CONTACT: DAVID WOODS PLANNING AND INSPECTIONS DEPARTMENT-INSPECTIONS DIVISION 100 NORTH MAIN STREET O'FALLON, MISSOURI, 63366 TEL: 636-379-5596 JAGEE@OFALLON.MO.US CONTACT: JARED AGEE MISSOURI TRANSPORTATION DEPARTMENT 6780 OLD HIGHWAY N ST. CHARLES, MISSOURI, 63304 TEL: 314-565-6714 FAX: 573-522-6491 CONTACT: PAUL GRAHAM CITY OF O'FALLON WATER, STORM AND SANITARY UTILITIES TEL: 636-281-2858 (WATER, SANITARY AND STORM SEWER) TEL: 636-379-3808 (STORM) AMEREN MISSOURI ELECTRIC COMPANY TEL: 636-357-2978 CONTACT: DAN GIESSMANN DGIESSMANN@AMEREN.COM LACLEDE GAS COMPANY TEL: 314-575-8423 CONTACT: DAVID SHERMAN DAVID.SHERMAN@THELACLEDEGROUP.COM CITY OF O'FALLON TRAFFIC LOCATES TEL: 636-379-5602 SURVEYOR OF RECORD COLE AND ASSOCIATES 1520 S. FIFTH STREET ST. CHARLES, MO, 63303 TEL: 636-978-7508 ENGINEER OF RECORD HEIDEMAN ASSOCIATES, INC. MIKE VELLOFF, P.E. 240 LARKIN WILLIAMS IND. CT. FENTON, MO. 63026 TEL: 636-492-3200 FAX: 636-492-3202 QT REAL ESTATE MANAGER QUIKTRIP CORPORATION GWEN KEEN 2255 BLUESTONE DRIVE ST. CHARLES, MO 63303 TEL: 636-627-0003 FAX: 636-578-6664 QT CIVIL PROJECT ENGINEER QUIKTRIP CORPORATION ASHLEY GOODRICH 4705 SOUTH 129TH EAST AVE. TULSA, OK 74134 TEL: 918-615-7273

PROJECT CONTACT LIST:

- STOP! Call Before you DIG 1-800-344-7483 TOLL FREE Missouri One-Call System Inc. 10223 NORTHEAST DR. JEFFERSON CITY, MO 65109 State law requires 2 days advance notice. The law in the State of Missouri defines emergency excavation as one preventing danger to life, health, or property.

SHEET INDEX

Table with 2 columns: NO. and TITLE. Lists sheets from C001 to C140, including Cover Sheet, Demolition Plan, Site Plan, ADA Construction, Grading Plans, Compliance Reference Plan, Storm Sewer Plan, Paving Plan, Building Paving Plan, Erosion Control Plan, Utility Plan, Security Plan, Water Quality Details, Drainage Maps, Detention Drainage Maps, Site Details, Paving Details, Trenching Details, Drainage Details, Erosion Control Details, Erosion Control Details, Metropolitan St. Louis Sewer District Details, Landscape Plan, Irrigation Plan, Landscape Details, Irrigation Details, Irrigation Details, Trash Enclosure, Miscellaneous Sections, Traffic Control Plan, and Truck Turn Movement Plan.

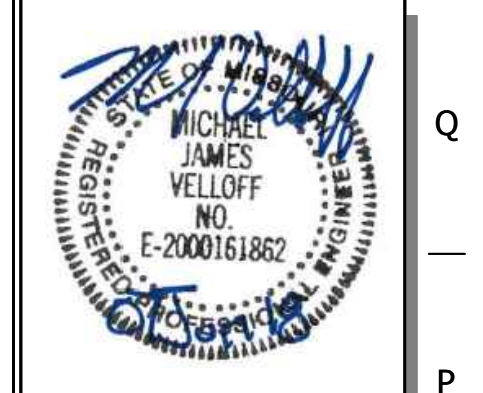

PROJECT NO.: 161105 NAME: MICHAEL J. VELLOFF LICENSE NUMBER: E-2000161862 DISCIPLINE: CIVIL CORPORATION AUTHORITY NUMBER: 00184 THE SEAL OF MICHAEL J. VELLOFF ON THIS DRAWING APPLIES ONLY TO THE CIVIL/SITE ENGINEERING SHOWN. IT DOES NOT APPLY, NOR IS ANY RESPONSIBILITY TAKEN FOR ENVIRONMENTAL, GEOTECHNICAL (INCLUDING BUT NOT LIMITED TO SLOPE STABILITY), STRUCTURAL, HVAC, PLUMBING, ELECTRICAL, FIRE PROTECTION, TRAFFIC ENGINEERING, SURVEYING (BOUNDARY AND TOPOGRAPHIC), OR ARCHITECTURAL (BUILDING OR LANDSCAPE).

QuikTrip No. 0662 955 BRYAN ROAD O'FALLON, MO 63366

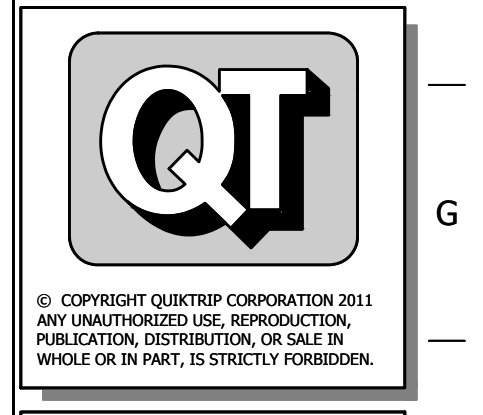

PROTOTYPE: P-94-01 DIVISION: 06 VERSION: 001 DESIGNED BY: RKF DRAWN BY: RKF REVIEWED BY: MJV

PLANNING CONDITIONS:

- 1. THE CONFIGURATION OF THE RIGHT-IN-RIGHT-OUT ON VETERANS MEMORIAL PARKWAY SHALL BE REVISED TO FURTHER RESTRICT LEFT-IN TURNS. 2. REVISE THE TRUCK MOVEMENTS TO MAKE THE MOVEMENTS CONTINUOUS. 3. THE APPLICANT SHALL ABIDE BY THE MUNICIPAL CODE REQUIREMENTS LISTED ABOVE. 4. A BOUNDARY ADJUSTMENT PLAT WILL BE REQUIRED TO CONSOLIDATE THE THREE (3) LOTS INTO ONE AS SHOWN. 5. LIGHTING UNDER THE CANOPY SHALL NOT BE EXPOSED AND SHALL BE RECESSED. 6. ALL SIGNAGE SHALL BE REVIEWED AND APPROVED THROUGH A SEPARATE PERMITTING PROCESS. 7. A REVISED PHOTOMETRIC LIGHTING PLAN SHALL BE SUBMITTED PRIOR TO CONSTRUCTION PLAN APPROVAL. FOOT-CANDLES SHALL NOT EXCEED 0.5 AT THE PROPERTY LINES. 8. THE CITY OF O'FALLON HAS CREATED CONSTRUCTION PLAN SHEETS WHICH FORMAT SHALL BE USED WHEN SUBMITTING CONSTRUCTION PLANS FOR REVIEW. THE CONSTRUCTION PLAN SHEETS CAN BE FOUND AT HTTP://WWW.OFALLON.MO.US/ENGINEERING \* THE SITE PLAN APPROVAL SHALL EXPIRE, AND BE OF NO EFFECT, ONE (1) YEAR AFTER THE DATE OF ISSUANCE THEREOF, UNLESS WITHIN SUCH TIME CONSTRUCTION PLANS OR BUILDING PERMITS FOR ANY PROPOSED WORK AUTHORIZED UNDER THE SAID SITE PLAN APPROVAL HAS BEEN ISSUED. \* PRIOR TO APPROVAL OF A BUILDING PERMIT, A CONSTRUCTION SITE PLAN MUST BE REVIEWED AND APPROVED BY CITY STAFF. THE APPLICATION IS AVAILABLE ON CITY'S WEBSITE VIA WWW.OFALLON.MO.US (CITY DEPARTMENTS, PUBLIC WORKS, ENGINEERING) THROUGH THE O'FALLON PERMITTING, LICENSING, AND ENFORCEMENT (OPLE) SYSTEM. \* THE APPROPRIATE FIRE DISTRICT WILL NEED TO REVIEW AND APPROVE THE DEVELOPMENT. \* ANY SIGNAGE TO BE PLACED ON THE SUBJECT PROPERTY REQUIRES A SEPARATE SIGN PERMIT. \* ANY BUSINESS OCCUPYING THE SITE REQUIRES APPROVAL OF A BUSINESS LICENSE. \* ALL CONDITIONS OF APPROVAL SHALL BE NOTED ON THE CONSTRUCTION SITE PLANS. CUP#7001.01, APPROVAL#7001.02, APPROVED DATE 10-06-16

Table with 2 columns: REV. DATE and DESCRIPTION. Includes a vertical label ORIGINAL ISSUE DATE: 06/18/18.

SHEET TITLE: COVER SHEET

SHEET NUMBER: C001

FILE LOCATION: \\161105 - QuikTrip #662 - Bryan Road and Veterans Memorial Parkway\Civil\06-0662 Civil.dwg USER: rkrkyer TAB NAME: C001 Cover DATE: 06/12/2018 11:52 AM PLOTTED: 06/12/2018 12:26 PM