

FILE LOCATION: \\16105 - QuikTrip #662 - Bryan Road and Veterans Memorial Parkway\Civil\06-0662\Civil.dwg TAB NAME: C111 Detailed Grading USER: rkrfyler SAVETIME: 12/12/2018 11:52 AM PLOTTED: 12/12/2018 12:28 PM

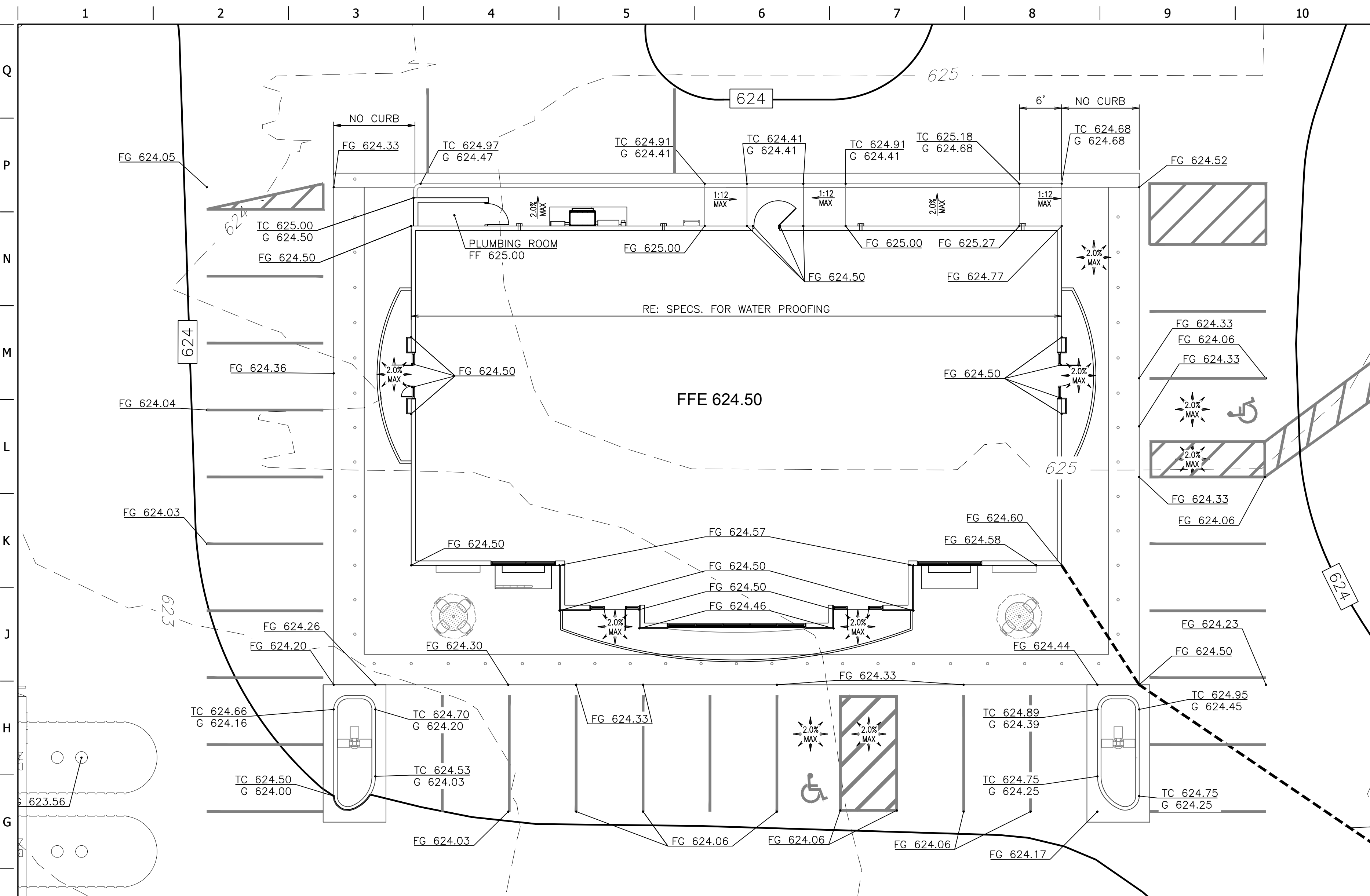

**F1** BUILDING ISLAND GRADING DETAIL  
1"=10'

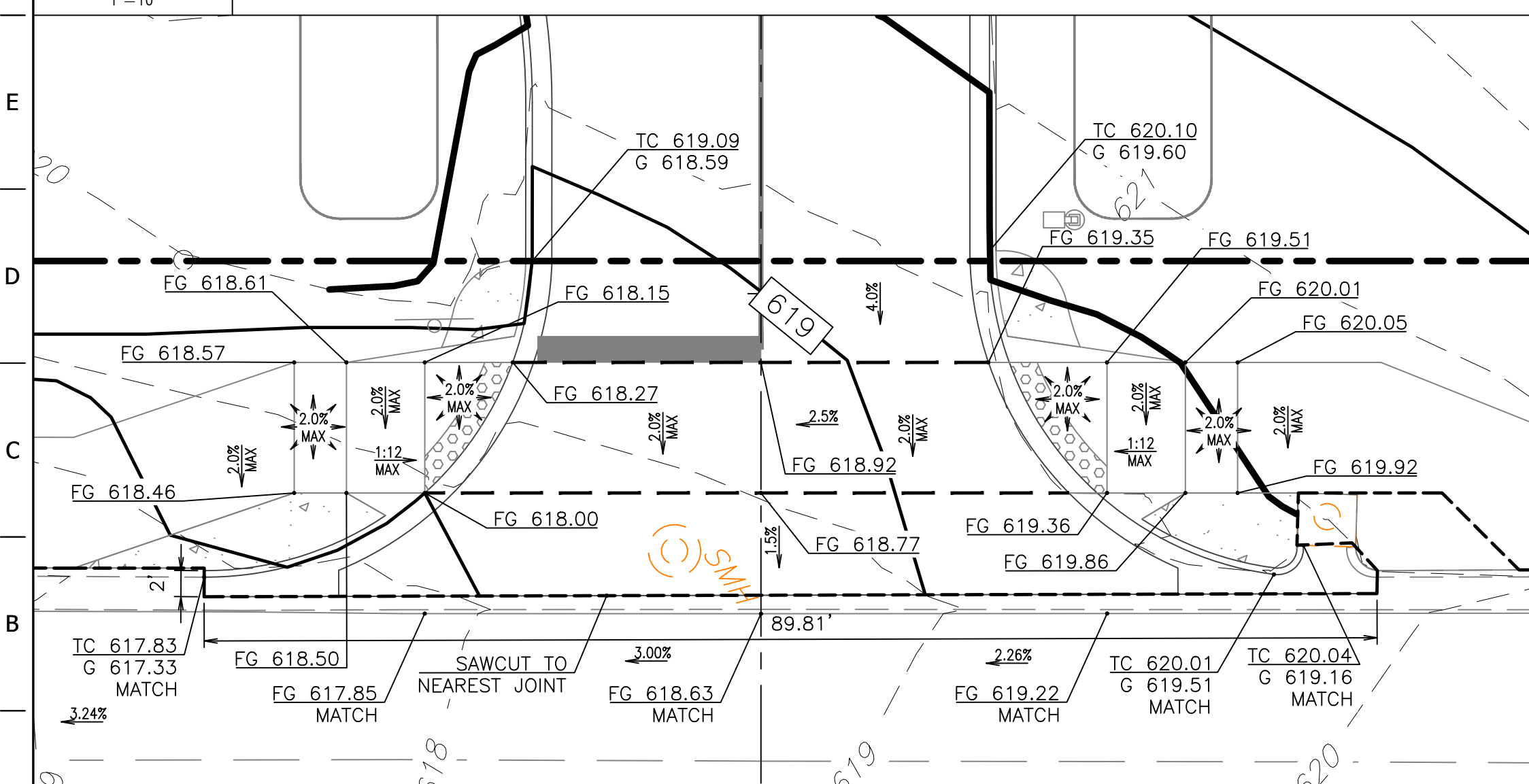

**A1** BRYAN ROAD - ADA GRADING DETAIL  
1"=10'

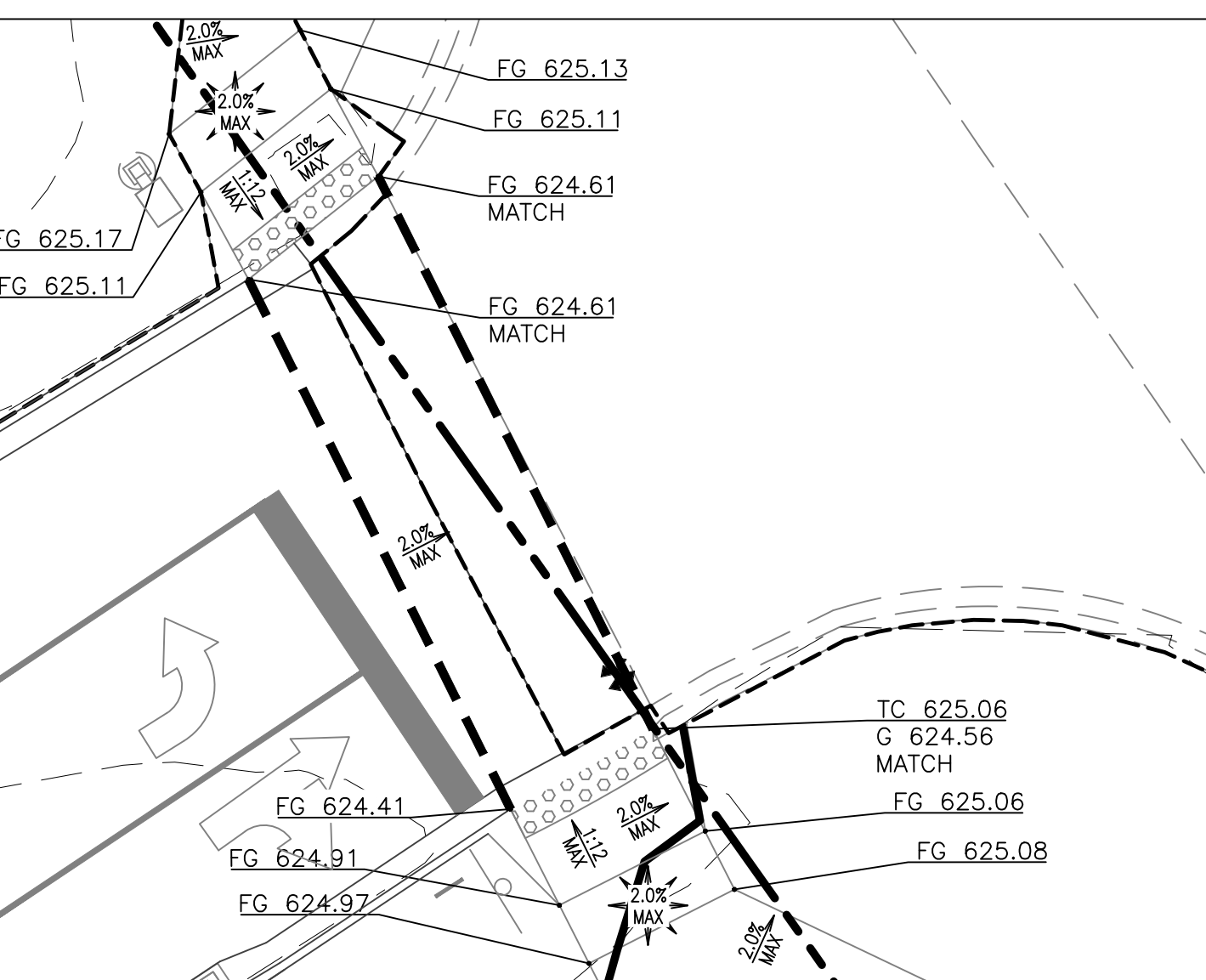

**A7** SHARED DRIVE - ADA GRADING DETAIL  
1"=10'

**BENCHMARKS:**  
BENCHMARK INFORMATION: ELEV. 558.64 (USGS D 149)(NAVD 88) 2.3 MILES WEST FROM O'FALLON 2.3 MILES WEST ALONG THE WABASH RAILROAD FROM THE STATION AT O'FALLON, ST. CHARLES COUNTY, 42 FEET SOUTHWEST OF MCGREE ROAD 25 FEET WEST OF A FENCE GATE, AND 2 FEET NORTH OF THE FENCE. A STANDARD DISK, STAMPED D 149 1935 AND SET IN THE TOP OF A CONCRETE POST PROJECTING 6 INCHES ABOVE GROUND.  
SITE BENCHMARK: ELEV. 625.73 CUT "4" ON EAST RIM OF A MANHOLE AT THE NORTHEAST CORNER OF ADJUSTED PARCEL 1 OF QUIKTRIP NO. 662, A SUBDIVISION IN ST. CHARLES COUNTY, MISSOURI AS PER PLAT THEREOF RECORDED IN PLAT BOOK 38 PAGE 366.

**GRADING LEGEND**

- XXXX MAJOR CONTOUR (NEW)
- XXXX MINOR CONTOUR (NEW)
- XXX MAJOR CONTOUR (EXISTING)
- XXX MINOR CONTOUR (EXISTING)
- LIMITS OF DISTURBANCE
- TC XXXX.XX TOP OF CURB ELEVATION (NEW)
- G XXXX.XX GUTTER ELEVATION (NEW)
- FG XXXX.XX FINISHED GRADE ELEVATION (NEW)
- FG XXXX.XX SPOT ELEVATION (EXISTING)
- Storm Grate (NEW)

PRIOR TO PLACING FRAMEWORK ON COMPLEX ADA RAMP DESIGNS, CONTRACTOR SHALL SUBMIT AN RFI WITH ADDITIONAL SURVEY DATA TO THE CONSULTANT. CONSULTANT WILL FINALIZE RAMP DESIGN AND RESPOND TO THE RFI.



PROJECT NO.: 161105  
NAME: MICHAEL J. VELLOFF  
LICENSE NUMBER: E-2000161862  
DISCIPLINE: CIVIL  
CORPORATION AUTHORITY NUMBER: 00194

THE SEAL OF MICHAEL J. VELLOFF ON THIS DRAWING APPLIES ONLY TO THE CIVIL/SITE ENGINEERING SHOWN. IT DOES NOT APPLY, NOR IS ANY RESPONSIBILITY TAKEN FOR ENVIRONMENTAL, GEOTECHNICAL (INCLUDING BUT NOT LIMITED TO SLOPE STABILITY), STRUCTURAL, HVAC, PLUMBING, ELECTRICAL, FIRE PROTECTION, TRAFFIC ENGINEERING, SURVEYING (BOUNDARY AND TOPOGRAPHIC), OR ARCHITECTURAL (BUILDING OR LANDSCAPE).

**QuikTrip No. 0662**  
955 BRYAN ROAD  
O'FALLAN, MO 63366



PROTOTYPE: P-94-01  
DIVISION: 06  
VERSION: 001  
DESIGNED BY: RKF  
DRAWN BY: RKF  
REVIEWED BY: MJV

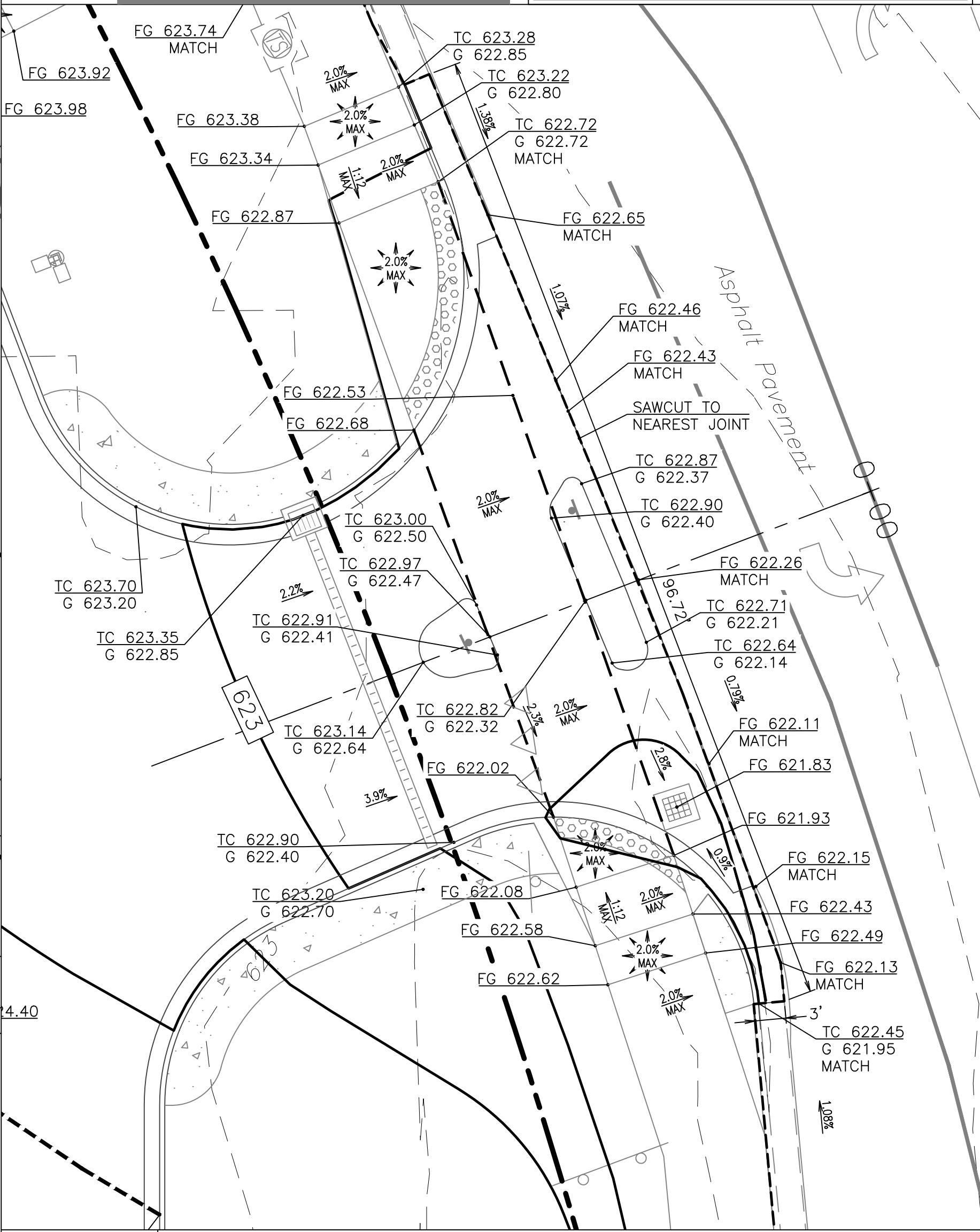

**D11** VETERANS MEMORIAL PARKWAY - ADA GRADING DETAIL  
1"=10'

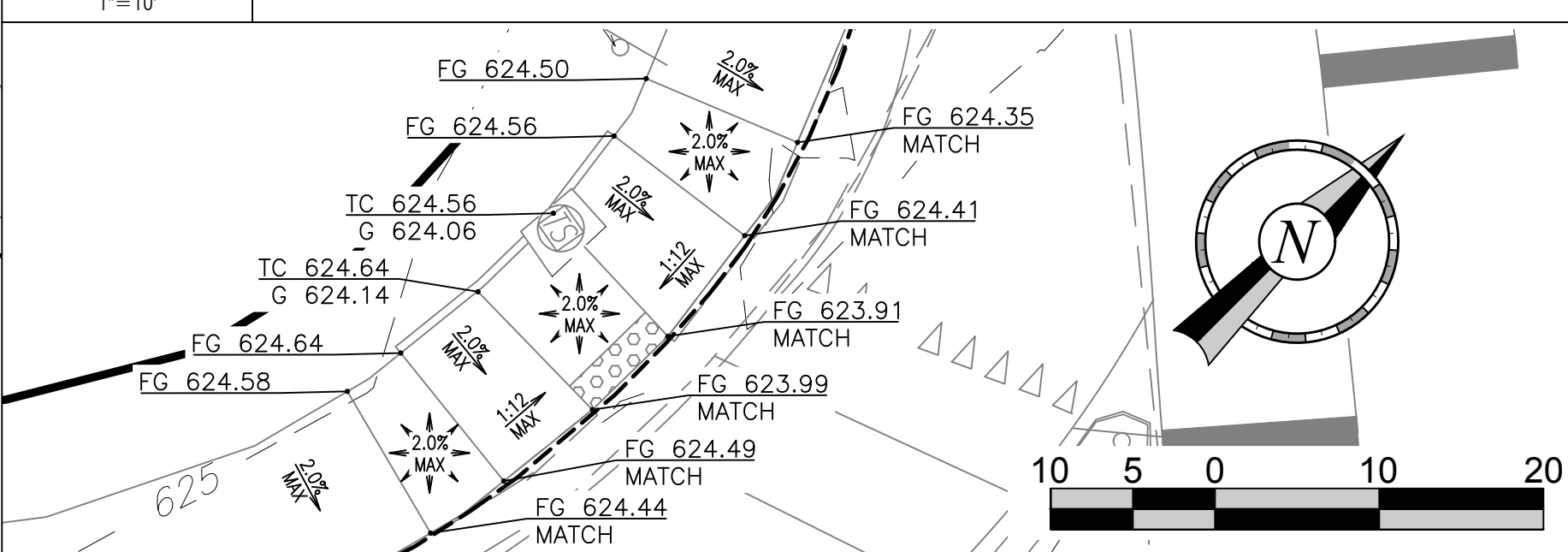

**A11** INTERSECTION-ADA GRADING DETAIL  
1"=10'

| REV | DATE | DESCRIPTION |
|-----|------|-------------|
|     |      |             |
|     |      |             |
|     |      |             |
|     |      |             |
|     |      |             |
|     |      |             |
|     |      |             |
|     |      |             |
|     |      |             |

SHEET TITLE:  
DETAILED GRADING PLAN

SHEET NUMBER:  
**C111**

ORIGINAL ISSUE DATE: 06/18/18