

FILE LOCATION: \\151054 - QuikTrip #0675 - Highway K and Fallon Parkway\Civil\06-0675 Civil.dwg, 9/15/2016 8:55:41 AM, DWG To PDF.pc3

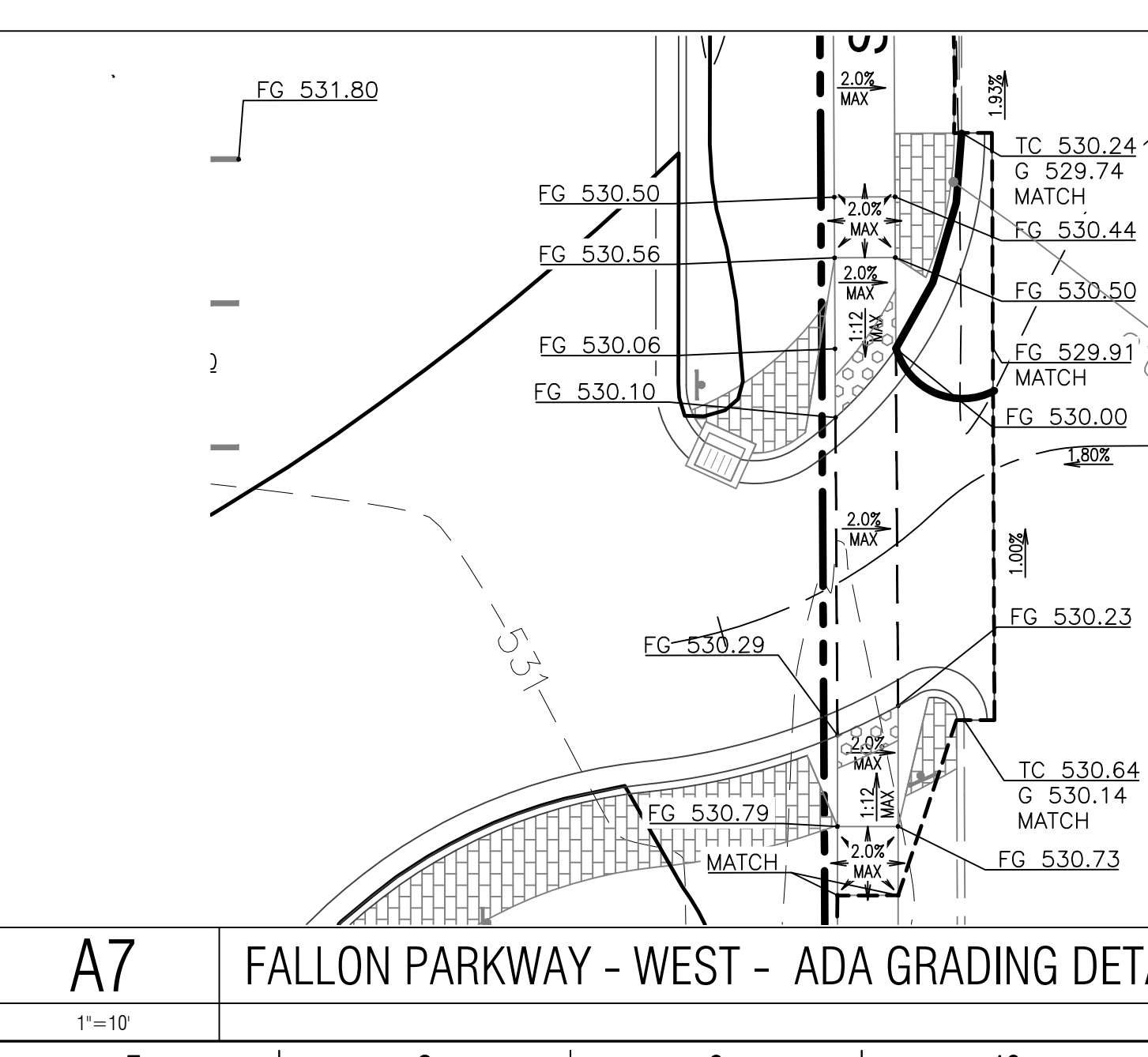
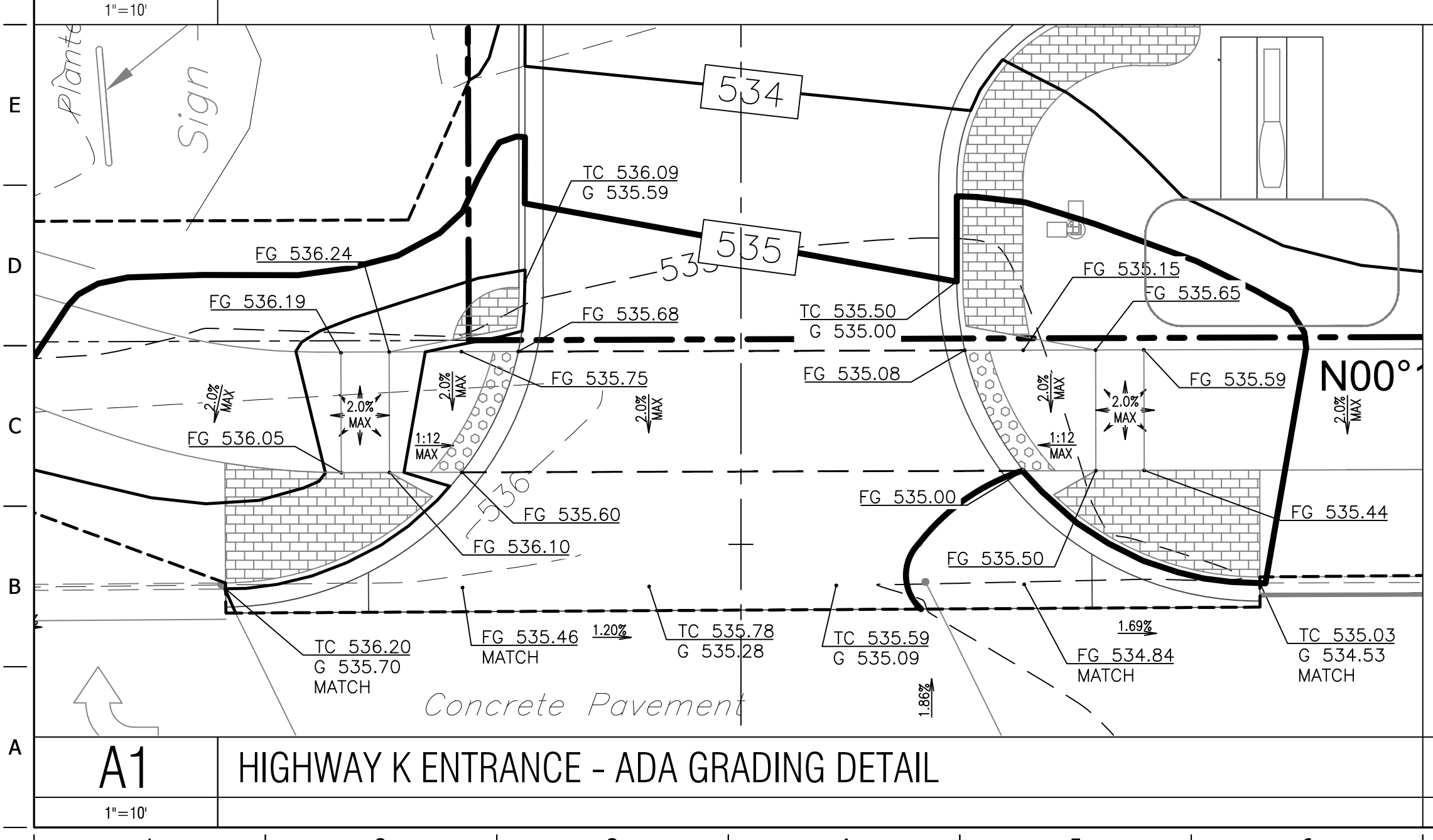
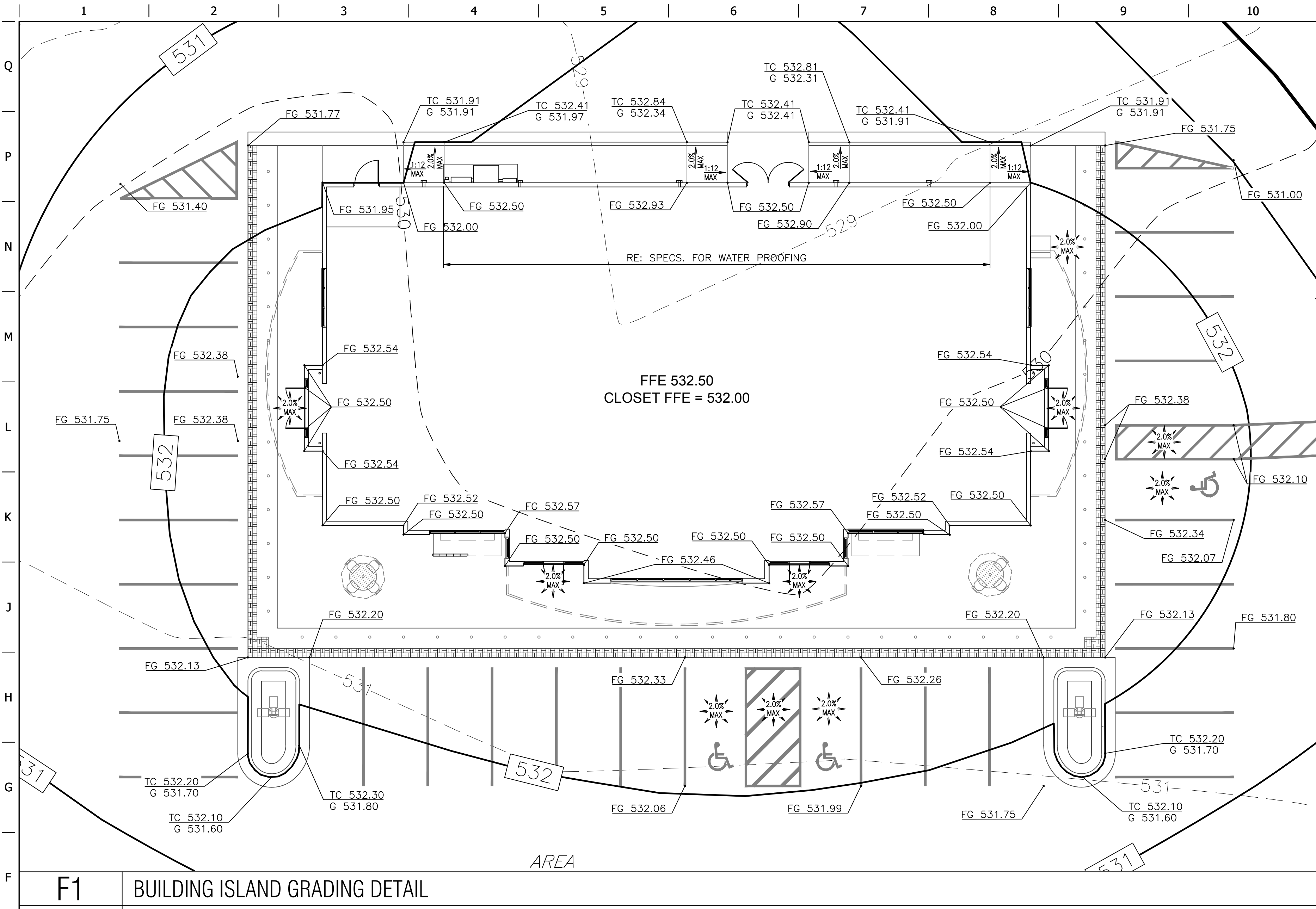

BENCHMARKS
 REFERENCE BENCHMARK: STATION NAME: SC-45
 PID: 183045
 ELEVATION: 432.51
 DESCRIPTION: THE STATION AND AZIMUTH MARK ARE STANDARD MISSOURI DNR GRS ALUMINUM DISKS STAMPED "SC-45 2000" AND "SC-45A 2000". THE STATION IS SET IN A 12 INCH DIAMETER CONCRETE MONUMENT ABOUT 30 INCHES LONG AND FLUSH WITH THE GROUND. THE AZIMUTH IS GROUTED INTO A CONCRETE HEADWALL.

SITE BENCHMARK: BOX ON LIGHT STANDARD
 ELEVATION 529.77
 DESCRIPTION: CUT BOX ON CONC. LIGHT STANDARD 65'± WEST OF THE CENTERLINE OF FALLON LOOP ROAD; 20'± NORTH OF THE NORTH PROPERTY LINE OF SUBJECT PROPERTY; 92'± SOUTHEAST OF THE SOUTHEAST CORNER OF BRICK BUILDING, ADDRESS #110 FALLON PARKWAY.

GRADING LEGEND
 -XXXX- MAJOR CONTOUR (NEW)
 -XXX- MINOR CONTOUR (NEW)
 -XXX- MAJOR CONTOUR (EXISTING)
 -XXX- MINOR CONTOUR (EXISTING)
 --- LIMITS OF DISTURBANCE
 TC XXXX.XX TOP OF CURB ELEVATION (NEW)
 G XXXX.XX GUTTER ELEVATION (NEW)
 FG XXXX.XX FINISHED GRADE ELEVATION (NEW)
 FG XXXX.XX SPOT ELEVATION (EXISTING)
 [Symbol] STORM GRATE (NEW)

PRIOR TO PLACING FRAMEWORK ON COMPLEX ADA RAMP DESIGNS, CONTRACTOR SHALL SUBMIT AN RFI WITH ADDITIONAL SURVEY DATA TO THE CONSULTANT. CONSULTANT WILL FINALIZE RAMP DESIGN AND RESPOND TO THE RFI.

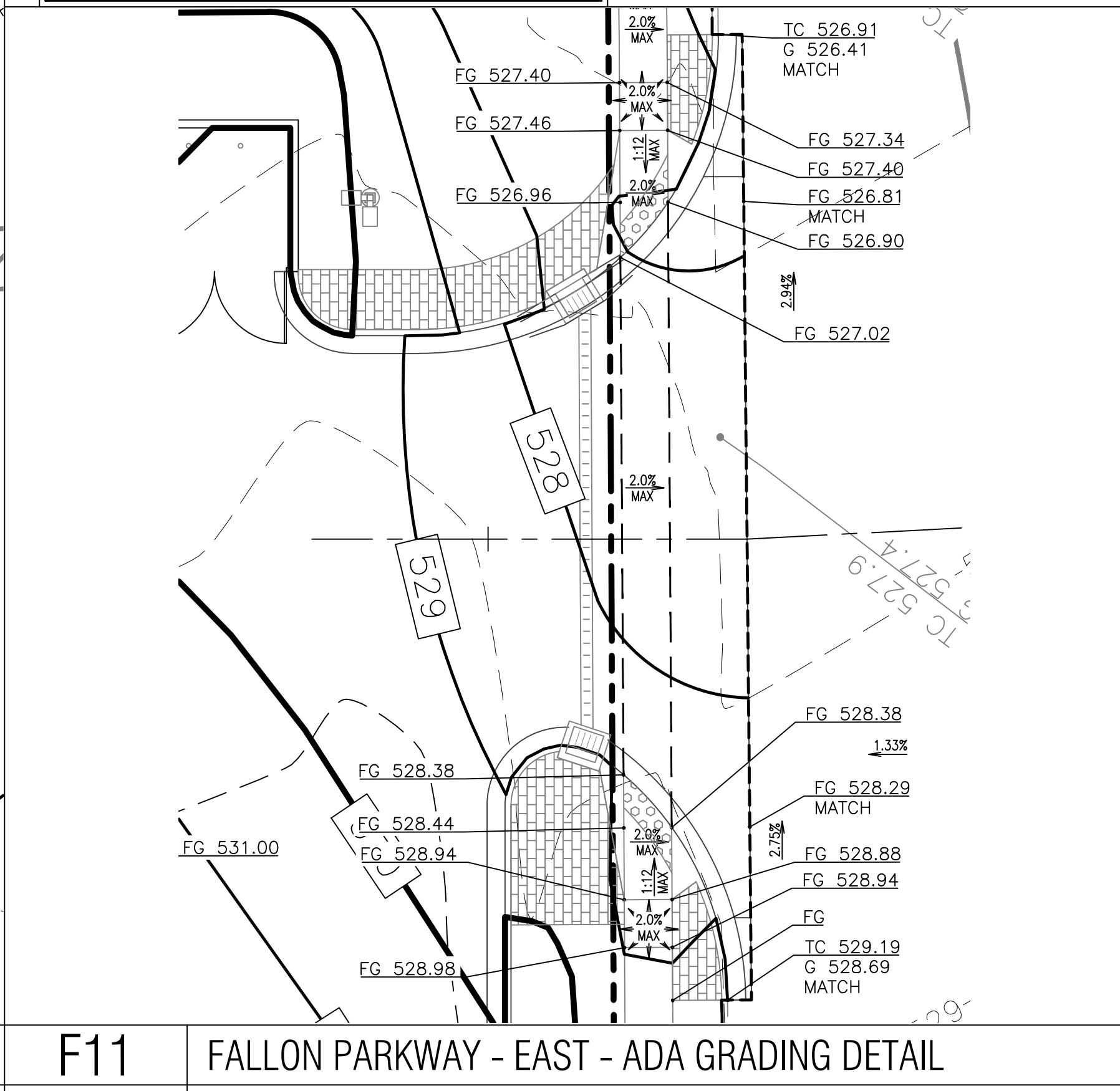

PROFESSIONAL SEAL
 STATE OF MISSOURI
 REGISTERED PROFESSIONAL ENGINEER
 MICHAEL J. VELLOFF
 LICENSE NO. E-2000161862
 PROJECT NO.: 151054

NAME: MICHAEL J. VELLOFF
 LICENSE NUMBER: E-2000161862
 DISCIPLINE: CIVIL
 CORPORATION AUTHORITY NUMBER: 001194

THE SEAL OF MICHAEL J. VELLOFF ON THIS DRAWING APPLIES ONLY TO THE CIVIL/SITE ENGINEERING DESIGN. IT DOES NOT APPLY, NOR IS ANY RESPONSIBILITY TAKEN FOR ENVIRONMENTAL, GEOTECHNICAL (INCLUDING BUT NOT LIMITED TO SLOPE STABILITY), STRUCTURAL, HVAC, PLUMBING, ELECTRICAL, FIRE PROTECTION, TRAFFIC ENGINEERING, SURVEYING (BOUNDARY AND TOPOGRAPHIC), OR ARCHITECTURAL (BUILDING OR LANDSCAPE).

QuikTrip No. 0675
 140 FALLON LOOP ROAD
 O'FALLON, MISSOURI 63368

QT

© COPYRIGHT QUIKTRIP CORPORATION 2011
 ANY UNAUTHORIZED USE, REPRODUCTION, PUBLICATION, DISTRIBUTION, OR SALE IN WHOLE OR IN PART, IS STRICTLY FORBIDDEN.

PROTOTYPE: P-87
 DIVISION: 06
 VERSION: 001
 DESIGNED BY: RKF
 DRAWN BY: RKF
 REVIEWED BY: MJV

| REV | DATE | DESCRIPTION |
|-----|----------|------------------|
| 1 | 08-25-16 | BID SET |
| 2 | 09-15-16 | CONSTRUCTION SET |

SHEET TITLE:
 DETAILED GRADING PLAN

SHEET NUMBER:
C111

ORIGINAL ISSUE DATE: 04-14-16

