

**SANITARY SEWER PROFILE**  
 SCALES:  
 1" = 20' HORIZONTAL  
 1" = 5' VERTICAL

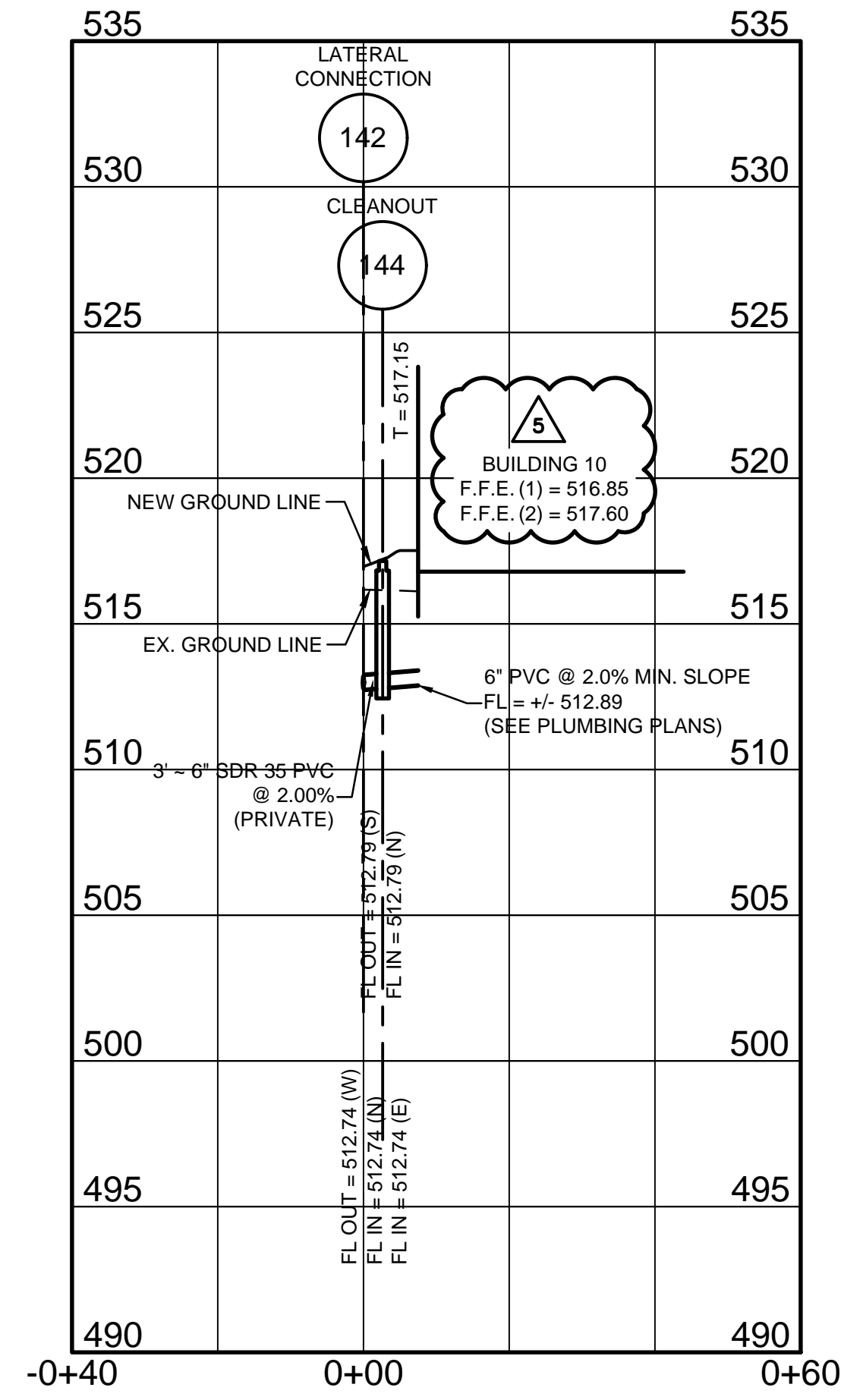

**SANITARY SEWER PROFILE**  
 SCALES:  
 1" = 20' HORIZONTAL  
 1" = 5' VERTICAL

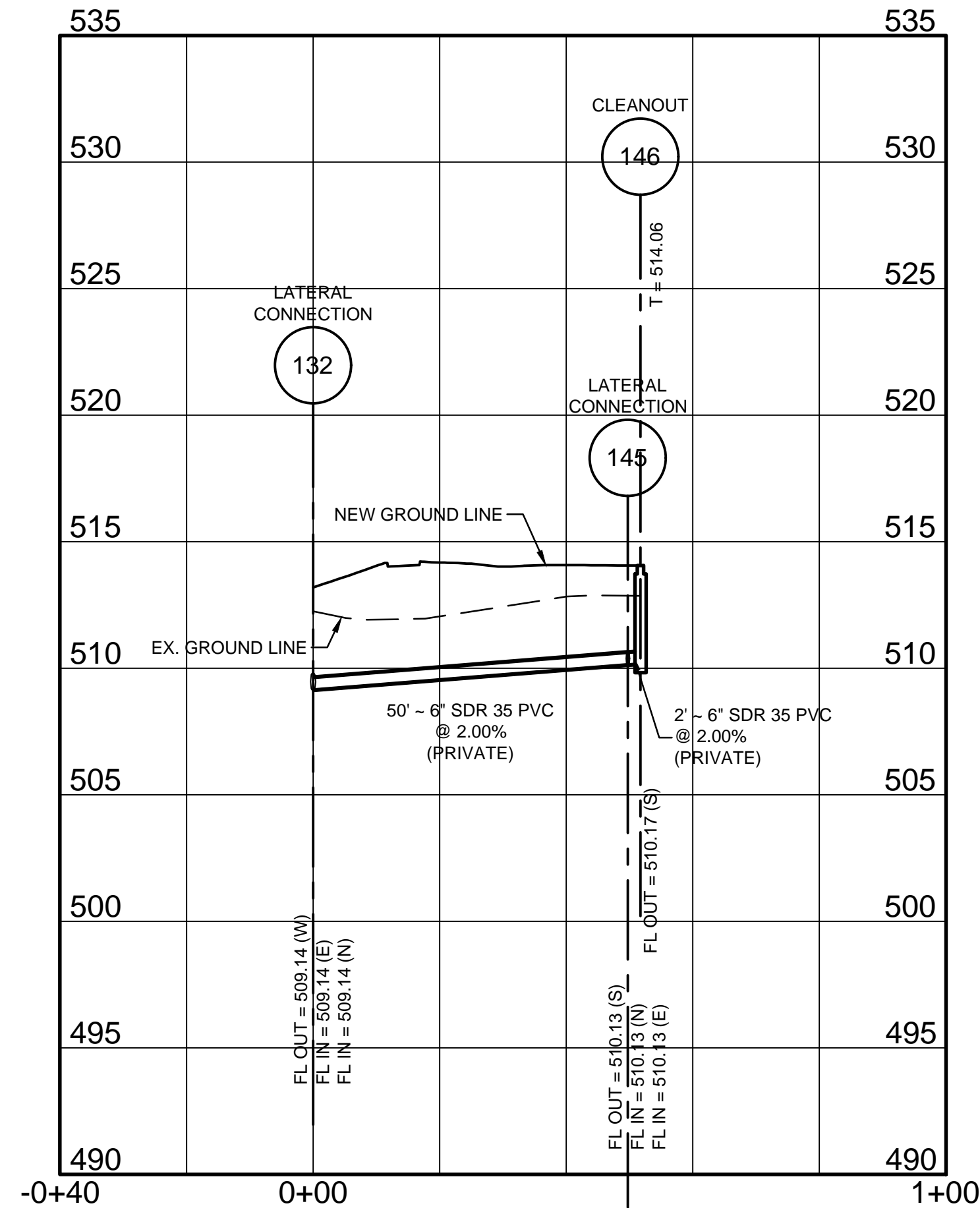

**SANITARY SEWER PROFILE**  
 SCALES:  
 1" = 20' HORIZONTAL  
 1" = 5' VERTICAL

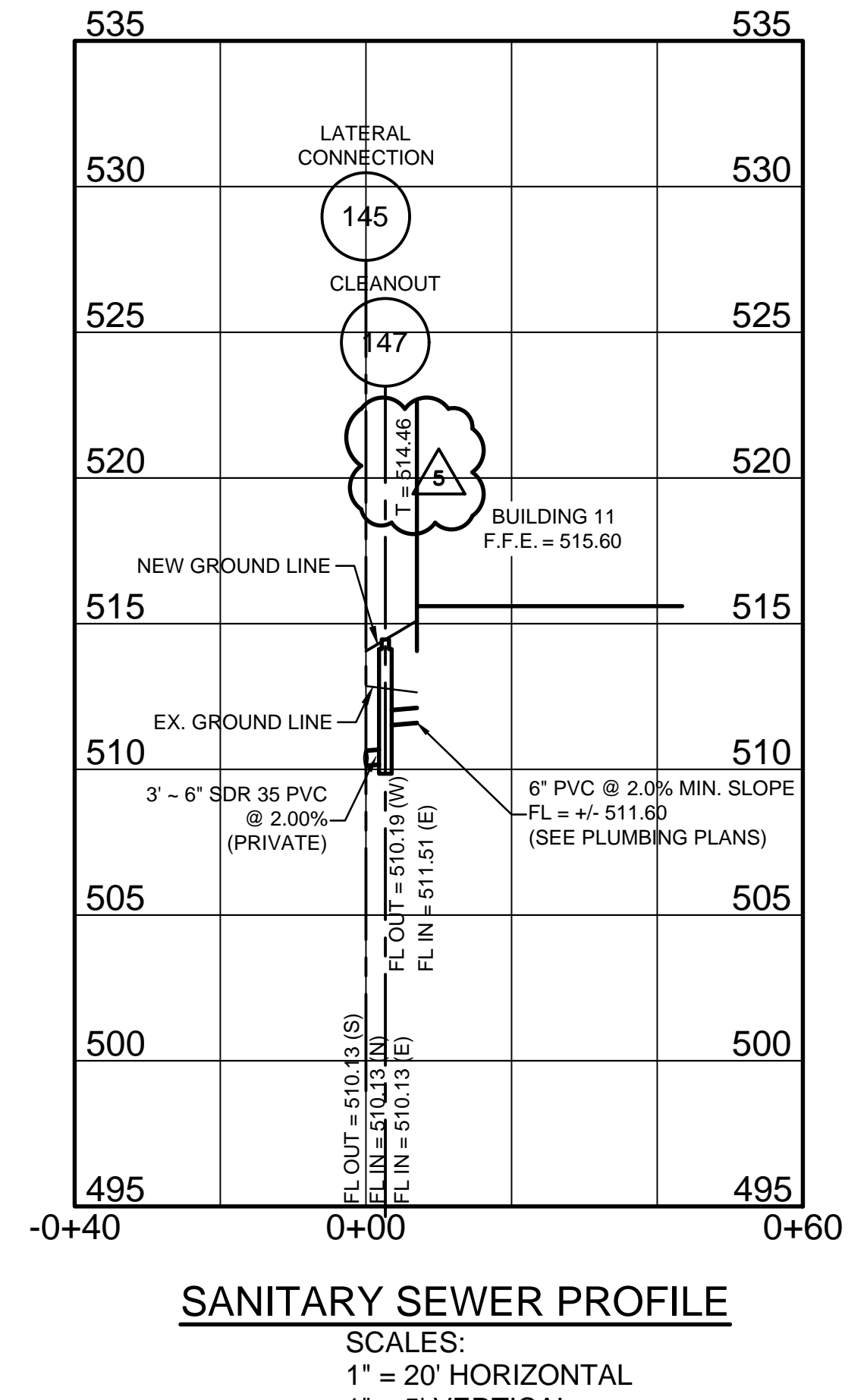

**SANITARY SEWER PROFILE**  
 SCALES:  
 1" = 20' HORIZONTAL  
 1" = 5' VERTICAL

**GENERAL NOTES:**

1. T = TOP OF MANHOLE CASTING OR INLET STONE.
2. ALL SANITARY SEWER PIPE TO BE SDR 35 PVC OR APPROVED EQUAL.
3. ALL SANITARY SEWER LATERALS SHALL BE A MINIMUM OF 6" SCHEDULE 40 PVC PIPE.
4. CONTRACTOR TO PROVIDE COMPACTED GRANULAR BACKFILL TO THE SUBGRADE OF THE PAVEMENT FOR ALL TRENCHES UNDER PAVEMENT.
5. PIPE CENTERLINE APPLIES TO CENTERLINE OF STRUCTURE.
6. LOCATION OF UTILITIES ON PIPE PROFILES ARE APPROXIMATE.
7. DISTANCES BETWEEN STRUCTURES ARE MEASURED TO THE CENTER OF THE STRUCTURES.
8. FILL MATERIAL UPON WHICH THE PROPOSED SEWERS ARE TO BE LAID SHALL BE COMPACTED TO 90% OF MAXIMUM DENSITY AS DETERMINED BY ASTM D-1557-180 AASHTO MODIFIED COMPACTION TEST AND BE VERIFIED BY THE ENGINEER.
9. CONTRACTOR SHALL EXPOSE ALL WATER AND GAS MAINS PRIOR TO SANITARY SEWER PIPE INSTALLATION AND VERIFY TOP OF ELEVATIONS OF UTILITIES.
10. ALL SEWER CONSTRUCTION AND MATERIALS TO BE IN ACCORDANCE WITH THE METROPOLITAN ST. LOUIS SEWER DISTRICT STANDARD CONSTRUCTION SPECIFICATIONS FOR DRAINAGE FACILITIES, 2009.
11. WHEN THE WATER LINES CROSS THE SANITARY SEWER, A MINIMUM SEPARATION OF 18" SHALL BE MAINTAINED BETWEEN WATER LINE AND SANITARY SEWER.

**SPECIAL NOTE TO CONTRACTOR(S):**

EXISTING UNDERGROUND AND ABOVE-GRADE FACILITIES, STRUCTURES, AND UTILITIES HAVE BEEN PLOTTED ON THESE CONTRACT DOCUMENTS BASED ON THE INFORMATION AND SURVEYS AVAILABLE AT THE TIME OF DRAWING PREPARATION. THE LOCATIONS OF THESE FEATURES MUST, THEREFORE, BE CONSIDERED APPROXIMATE, ONLY. IN ADDITION, THERE MAY BE OTHER FACILITIES, STRUCTURES, AND UTILITIES WHICH DID NOT EXIST (OR THE EXISTENCE OF WHICH WAS NOT KNOWN) AT THE TIME OF DRAWING PREPARATION. IT IS THE SOLE RESPONSIBILITY OF THE CONTRACTOR(S) TO HAVE ALL EXISTING FACILITIES, STRUCTURES, AND UTILITIES LOCATED IN THE FIELD PRIOR TO ANY EXCAVATION OR CONSTRUCTION ACTIVITY, AND TO PROTECT ALL SUCH EXISTING FEATURES (EXCEPT THOSE SPECIFICALLY NOTED FOR REMOVAL OR DEMOLITION) DURING CONSTRUCTION.

Call Before you DIG  
 TOLL FREE  
 1-800-344-7483  
 MISSOURI ONE-CALL SYSTEM INC.  
 MODOT (314) 340-4100

PRINTS ISSUED  
 05/11/18 - Permit Set  
 REVISIONS:  
 5 03/26/2019 Addendum #5 (Civil Issue)

**HORNER SHIFRIN**  
 101 LAURA V. DR., STE. 101, OF FALLO, MO 63366-3991  
 636-329-9296 • FAX 636-329-2910 • WWW.HORNERSHIFRIN.COM  
 DISCIPLINE: PROFESSIONAL ENGINEERING  
 CERTIFICATE OF AUTHORITY: 000169  
 EXPIRATION DATE: DECEMBER 31, 2018

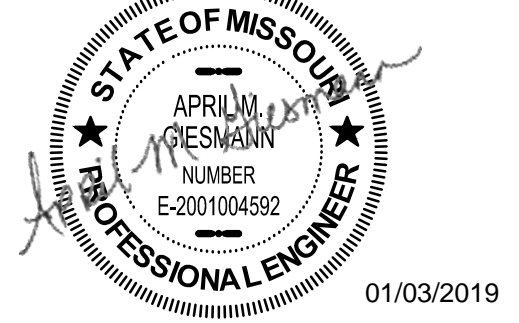

Name: April Geismann  
 Discipline: Civil Engineer  
 License No. E-2001004592  
 Expiration Date: 12/31/2019

**RENEW O'FALLON**  
**T.R. HUGHES BLVD**  
**O'FALLON, MO 63366**

SHEET TITLE: SANITARY SEWER PROFILES

PROJECT NUMBER: 17050

SHEET NUMBER:

**C8.6**

DRAWN BY: AMH CHECKED BY: AMG

OPERATOR: J.MUNTERREINER

DWG: C:\pwworking\shifrin\jmunterreiner\ss197759\Sanitary Sewer Profiles.dwg  
 CTR: Trans-sta-AMH.dwg  
 PLOT DATE: 3/27/2019 9:31:30 AM  
 PAGE SETUP NAME: ...  
 SAVE DATE: 3/27/2019 9:07:59 AM