

WATER MAIN 1 PROFILE
 SCALES:
 1" = 20' HORIZONTAL
 1" = 5' VERTICAL

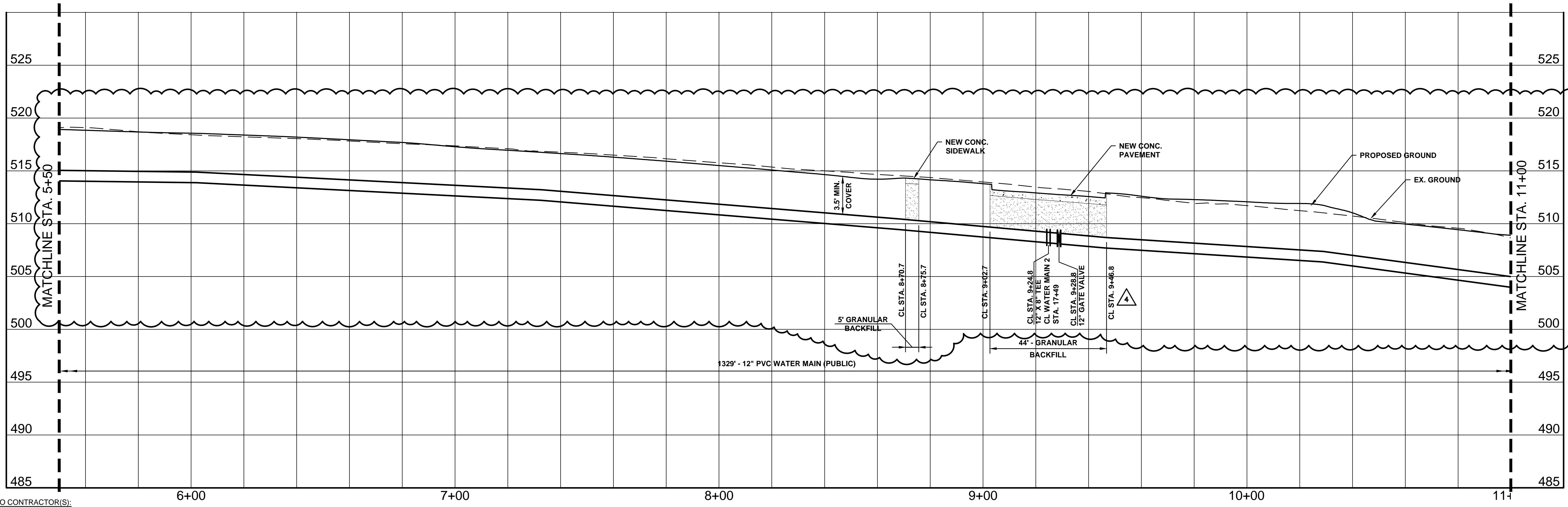

WATER MAIN 1 PROFILE
 SCALES:
 1" = 20' HORIZONTAL
 1" = 5' VERTICAL

SPECIAL NOTE TO CONTRACTOR(S):
 EXISTING UNDERGROUND AND ABOVE-GRADE FACILITIES, STRUCTURES, AND UTILITIES HAVE BEEN PLOTTED ON THESE CONTRACT DOCUMENTS BASED ON THE INFORMATION AND SURVEYS AVAILABLE AT THE TIME OF DRAWING PREPARATION. THE LOCATIONS OF THESE FEATURES MUST, THEREFORE, BE CONSIDERED APPROXIMATE, ONLY. IN ADDITION, THERE MAY BE OTHER FACILITIES, STRUCTURES, AND UTILITIES WHICH DID NOT EXIST (OR THE EXISTENCE OF WHICH WAS NOT KNOWN) AT THE TIME OF DRAWING PREPARATION. IT IS THE SOLE RESPONSIBILITY OF THE CONTRACTOR(S) TO HAVE ALL EXISTING FACILITIES, STRUCTURES, AND UTILITIES LOCATED IN THE FIELD PRIOR TO ANY EXCAVATION OR CONSTRUCTION ACTIVITY, AND TO PROTECT ALL SUCH EXISTING FEATURES (EXCEPT THOSE SPECIFICALLY NOTED FOR REMOVAL OR DEMOLITION) DURING CONSTRUCTION.

Call Before you DIG
 TOLL FREE
 1-800-344-7483
 MISSOURI ONE-CALL SYSTEM INC.
 MODOT (314) 340-4100

PRINTS ISSUED
 05/11/18 - Permit Set
 REVISIONS:
 5 03/26/2019 Addendum #5 (Civil Issue)

HORNER SHIFRIN
 101 LAURA K DR. STE. 101 OFALLON, MO 63366-3991
 636-329-9296 • FAX 636-329-2910 • WWW.HORNERSHIFRIN.COM
 DISCIPLINE: PROFESSIONAL ENGINEERING
 CERTIFICATE OF AUTHORITY: 000159
 EXPIRATION DATE: DECEMBER 31, 2018

STATE OF MISSOURI
 APRIL GEISMANN
 PROFESSIONAL ENGINEER
 NUMBER E-2001004592
 01/03/2019
 Name: April Geismann
 Discipline: Civil Engineer
 License No. E2001004592
 Expiration Date: 12/31/2019

RENEW O'FALLON
T.R. HUGHES BLVD
O'FALLON, MO 63366

SHEET TITLE WATER MAIN PROFILES
 PROJECT NUMBER: 17050
 SHEET NUMBER:

C9.1
 DRAWN BY: BDV CHECKED BY: LEF

DWG: C:\working\horner\shifrin\mnr\renewofallon\17050\Water Main Profiles.dwg
 CTB: Trans-sta.ctb
 PLOT DATE: 3/26/2019 9:32:50 AM
 OPERATOR: JMWINTERREINER
 PAGE SETUP NAME: 24x36 PDF
 SAVE DATE: 3/26/2019 3:02:02 PM