



1-25-06788 APPROVED as noted

Structures to be converted to catch basin are to follow MSD detail sheet 36 and sheet 49 as published in the MSD Standards and Specifications 2000.

All Structures will be adjusted to grade with approved grade rings

### O'FALLON, MO PROTOTYPE 99.10.031

SYMBOL	DESCRIPTION	SYMBOL	DESCRIPTION	SYMBOL	DESCRIPTION
	SECTION TAG-SEE DWG. AS NOTED		ELEVATION TAG-SEE DWG. AS NOTED		DOOR TAG-SEE DOOR SCHED.
	DETAIL TAG-SEE DWG. AS NOTED		INTERIOR/ EXTERIOR FINISH TAG- RESTROOM ACCESSORIES SEE FINISH LEGEND		COLUMN LINE
	ELEVATION BENCHMARK		PLAN KEYNOTES		REVISION TAG
	ELEVATION TAG		MULTIPLE ELEVATION TAG		WINDOW TAG-SEE WINDOW SCHEDULE

#### 1 GENERAL SYMBOL LEGEND

- SCALE: NONE
- DO NOT SCALE DRAWINGS - WRITTEN DIMENSIONS TAKE PRECEDENT.
  - IN CASE OF DISCREPANCIES OR CONFLICTS, NOTIFY ARCHITECT OF RECORD AS SOON AS POSSIBLE.
  - FOR BIDDING PURPOSES: WHERE CONFLICTS EXIST BETWEEN DRAWING DETAILS & SPECIFICATIONS, THE MORE STRINGENT SPECIFICATION SHALL APPLY.
  - G.C. IS RESPONSIBLE FOR ALL ASPECTS OF BUILDING CONSTRUCTION DELINEATED IN THESE DRAWINGS UNLESS SPECIFICALLY NOTED OTHERWISE.
  - THE SOILS REPORT IS PROVIDED UNDER SEPARATE COVER. THE GENERAL CONTRACTOR SHALL REVIEW THE REPORT AND COMPLY WITH ALL REQUIREMENTS OF SOILS REPORT. NOTIFY THE ARCHITECT IF THERE ARE REQUIREMENTS WHICH CANNOT BE MET DUE TO SITE CONDITIONS.
  - CONTRACTOR SHALL VERIFY ALL DIMENSIONS ON DRAWINGS FOR CONFLICTS PRIOR TO CONSTRUCTION. THE CONTRACTOR WILL NOTIFY THE ARCHITECT OF ANY DISCREPANCIES.
  - ANY DAMAGE BY G.C. OR SUBCONTRACTOR TO EXISTING ASPHALT PAVEMENT AND/OR EXISTING LANDSCAPING OUTSIDE OF CONSTRUCTION LIMIT LINE SHALL BE REPAIRED AT NO COST TO OWNER.
  - SIDEWALK ELEVATIONS TO BE COORDINATED WITH SITE AS-BUILT CONDITIONS. ARCHITECT TO BE NOTIFIED OF ANY DISCREPANCIES.
  - G.C. TO COORDINATE SLEEVING FOR AND PLACEMENT OF IRRIGATION LINES UNDER CONCRETE WALKS, CURBS, ETC. WITH IRRIGATION / LANDSCAPE CONTRACTOR. SEE PLANS FOR LOCATIONS.
  - CONTRACTOR SHALL COORDINATE THE LOCATION OF THE THREE (3) ADDRESS SIGNS AS SHOWN ON THE EXTERIOR ELEVATIONS.
  - NO MATERIALS SHALL BE STORED ON PUBLIC PROPERTY UNLESS AN ENCROACHMENT PERMIT IS FIRST OBTAINED FROM THE PUBLIC WORKS DEPT.
  - ALL DEBRIS SHALL BE REMOVED FROM THE PREMISES AND WORK AREAS SHALL BE LEFT IN A CLEAN (BROOM) CONDITION DAILY.
  - CONTRACTOR SHALL PROVIDE A LIST OF SUBCONTRACTORS TO RED ROBIN GOURMET BURGERS.
  - CONTRACTOR SHALL COMPLY WITH ALL STATE AND LOCAL RULES AND REGULATIONS CONCERNING LICENSING WHICH THE APPLICABLE GOVERNING AUTHORITY MAY HAVE ADOPTED.
  - ALL WEATHER-EXPOSED SURFACES SHALL HAVE A WEATHER-RESISTIVE BARRIER TO PROTECT THE INTERIOR WALL COVERING. EXTERIOR OPENINGS SHALL BE FLASHED IN SUCH A MANNER AS TO MAKE THEM WATERPROOF.
  - REFER TO A2.4 FOR BY OWNER (B.O.) AND NOT IN CONTRACT (N.I.C.) ITEMS REFERRED IN THE CONSTRUCTION DOCUMENTS.

#### 3 GENERAL NOTES

- SCALE: NONE
- WALKS, HALLS, CORRIDORS, PASSAGEWAYS, AISLES OR OTHER CIRCULATION SPACES SHALL HAVE 80" MINIMUM CLEAR HEADROOM.
  - GROUND AND FLOOR SURFACES ALONG ACCESSIBLE ROUTES AND IN ACCESSIBLE ROOMS AND SPACES, INCLUDING FLOORS, WALKS, RAMPS, STAIRS, AND CURB RAMPS, SHALL BE STABLE, FIRM, AND SLIP-RESISTANT.
  - OBJECTS PROJECTING FROM WALLS WITH THEIR LEADING EDGES BETWEEN 27" AND 80" ABOVE THE FINISH FLOOR SHALL PROTRUDE NO MORE THAN 4" INTO WALKS, HALLS, CORRIDORS, PASSAGEWAYS, OR AISLES. OBJECTS MOUNTED AT OR BELOW 27" ABOVE FINISH FLOOR MAY PROTRUDE ANY AMOUNT.
  - THE INTERNATIONAL SYMBOL OF ACCESSIBILITY SHALL CONSIST OF A WHITE FIGURE ON A BLUE BACKGROUND. THE BLUE SHALL BE EQUAL TO COLOR NO. 15909 IN FEDERAL STANDARD 599B.
  - IF RAMP EXCEEDS 10' IN LENGTH AND RAMP IS NOT BOUNDED BY WALLS, CURBS OR WHEEL GUIDES SHALL BE PROVIDED.
  - WALL SURFACES ADJACENT TO HANDRAILS SHALL BE FREE OF SHARP OR ABRASIVE ELEMENTS.
  - THE CENTER OF ELECTRICAL AND COMMUNICATION SYSTEM RECEPTACLE OUTLETS SHALL NOT BE INSTALLED LESS THAN 15" A.F.F. OR WORKING PLATFORM.
  - THE CENTER OF THE GRIP OF THE OPERATING HANDLE OF CONTROLS OR SWITCHES INTENDED TO BE USED BY THE OCCUPANT OF THE ROOM OR AREA TO CONTROL LIGHTING AND RECEPTACLE OUTLETS, APPLIANCES, OR COOLING, HEATING, AND VENTILATING EQUIPMENT SHALL NOT BE MORE THAN 48" ABOVE THE FINISH FLOOR OR WORKING PLATFORM.
  - THE CENTER OF FIRE ALARM INITIATING DEVICES (BOXES) SHALL BE LOCATED 48" A.F.F., WORKING PLATFORM, GROUND SURFACE, OR SIDEWALK.
  - IF EMERGENCY WARNING SYSTEMS ARE REQUIRED, THEY SHALL ACTIVATE A MEANS OF WARNING FOR THE HEARING IMPAIRED.
  - APPROVED NOTIFICATION APPLIANCES FOR THE HEARING IMPAIRED SHALL BE INSTALLED IN ACCORDANCE WITH THE PROVISIONS OF NFPA 72G.
  - STROBE SIGNALING DEVICES REQUIRED FOR THE HEARING IMPAIRED SHALL BE STATE FIRE MARSHAL APPROVED AND LISTED.

#### 5 ACCESSIBILITY NOTES

- CONTRACTOR TO PROVIDE A SUFFICIENT NUMBER OF 2A10BC RATED FIRE EXTINGUISHERS IN ORDER THAT ALL PORTIONS OF THE BUILDING ARE WITHIN 75 FT. TRAVEL DISTANCE OF SAID EXTINGUISHER AND SO THAT AT LEAST ONE 2A10BC RATED FIRE EXTINGUISHER IS PROVIDED FOR EACH 3000 SQ. FT. OF FLOOR SPACE OR PORTION THEREOF.
- PROVIDE A PORTABLE FIRE EXTINGUISHER WITH A RATING OF NOT LESS THAN 40-B FOR KITCHEN. LOCATE EXTINGUISHERS PER LOCAL FIRE DEPARTMENT / AUTHORITY DIRECTION.
- PROVIDE FIRE EXTINGUISHERS AS REQUIRED BY FIRE DEPT. PER FIELD INSPECTOR.
- ALL EXIT DOORS SHALL SWING IN THE DIRECTION OF TRAVEL.
- ALL EXIT DOORS SHALL BE OPERABLE FROM THE INSIDE WITHOUT SPECIAL KNOWLEDGE OR EFFORT (NO DEAD BOLTS, NO SLIDING BOLTS, ETC.)
- AN OCCUPANT CONTENT SIGN SHALL BE POSTED IN EACH ASSEMBLY ROOM HAVING AN OCCUPANT CONTENT OF 50 OR MORE.
- MAINTAIN MIN. 44" AISLES TO EXIT OR PUBLIC WAY.
- PROVIDE EXIT SIGNS ABOVE EXITS WITH MIN. 3/4" X 6" LETTERS LIGHTED ON CONTRASTING BACKGROUND.
- EXIT SIGNS MUST BE INTERNALLY ILLUMINATED.
- PROVIDE TWO (2) SEPARATE POWER SUPPLIES FOR EXIT SIGNS CONFORMING TO CODE SECTION.
- PROVIDE EMERGENCY EXIT LIGHTING PROVIDING A VALUE OF ONE FOOT CANDLE AT FLOOR LEVEL.
- ADDITIONAL EXIT SIGNS WILL BE PROVIDED AS/IF DIRECTED BY THE CITY INSPECTOR.
- GENERAL CONTRACTOR RESPONSIBLE FOR SMOKE DENSITY RATING AND FLAME SPREAD RATING OF MATERIALS USED.
- INTERIOR WALL AND CEILING FINISHES FOR ASSEMBLY AREAS SHALL NOT EXCEED AN END POINT FLAME SPREAD RATING OF 200 OR CLASS C.
- ANY DECORATIONS USED SHALL BE NON-COMBUSTIBLE OR FLAME PROOFED IN AN APPROVED MANNER.
- DRAPES AND OTHER DECORATIVE MATERIALS SHALL BE FLAME RETARDANT. CERTIFICATION THEREOF SHALL BE PROVIDED. EXITS, EXIT SIGNS, FIRE ALARM STATIONS, HOSE CABINETS AND EXTINGUISHER LOCATIONS SHALL NOT BE CONCEALED BY DECORATIVE MATERIALS.
- ALL DECORATIVE MATERIALS SHALL BE MAINTAINED IN A FLAME-RETARDANT CONDITION.
- INSULATION SHALL BE INSTALLED TO MEET FLAME SPREAD AND SMOKE DENSITY REQUIREMENTS PER LOCAL CODE.
- PROVIDE OUTSIDE GAS SHUTOFF VALVE CONSPICUOUSLY MARKED.
- G.C. TO PROVIDE AND POST OCCUPANT CONTENT SIGN NEAR FRONT DOOR. PER LOCAL ORDINANCE REQUIREMENTS.
- PROVIDE A "KNOX BOX" FOR FIRE DEPARTMENT ACCESS AND KEY ACCESS. LOCATION AS DETERMINED BY FIRE MARSHAL.
- EXIT SIGNAGE SHALL BE PROVIDED AND MAINTAINED FOR CORRIDORS AND AISLEWAYS LEADING TO EXITS IN ACCORDANCE WITH SECTION SIGNAGE SHALL STATE: "OBSTRUCTIONS, INCLUDING STORAGE, SHALL NOT BE PLACED IN THE REQUIRED WIDTH OF AN EXIT OR EXIT PASSAGEWAY."
- FIRE DEPARTMENT FINAL INSPECTION REQUIRED. SCHEDULE INSPECTIONS TWO (2) DAYS IN ADVANCE.
- STORAGE, DISPENSING OR USE OF ANY FLAMMABLE AND COMBUSTIBLE LIQUIDS, FLAMMABLE AND COMPRESSED GASES, AND OTHER HAZARDOUS MATERIALS SHALL COMPLY WITH LOCAL FIRE CODE REGULATIONS.
- ANY TYPE I HOOD INSTALLATION AND SHAFT CONSTRUCTION MUST COMPLY WITH THE LOCAL CODE REQUIREMENTS. COMPONENTS OF THE SHAFT ASSEMBLY MUST BE OF INCOMBUSTIBLE CONSTRUCTION.
- FIRE BLOCKS SHALL OCCUR AT THE FOLLOWING LOCATIONS:
  - IN CONCEALED SPACES OF STUD WALLS AND PARTITIONS, INCLUDING FURRED SPACES, AT THE CEILING AND FLOOR LEVELS AND AT 10-FOOT INTERVALS BOTH VERTICAL AND HORIZONTAL.
  - AT ALL INTERCONNECTIONS BETWEEN CONCEALED VERTICAL AND HORIZONTAL SPACES SUCH AS OCCUR AT SOFFITS, DROP CEILING AND COVE CEILING.
  - IN CONCEALED SPACES BETWEEN STAIR STRINGERS AT THE TOP AND BOTTOM OF THE RUN AND IN BETWEEN STUDS ALONG AND IN-LINE WITH THE RUN OF STAIRS IF THE WALLS UNDER THE STAIRS ARE UNFINISHED.
  - IN OPENINGS AROUND VENTS, PIPES, DUCTS, CHIMNEYS, FIREPLACES AND SIMILAR OPENINGS WHICH AFFORD A PASSAGE FOR FIRE AT CEILING AND FLOOR LEVELS, WITH NON-COMBUSTIBLE MATERIALS.
  - AT OPENINGS BETWEEN ATTIC SPACES AND CHIMNEY CHASES FOR FACTORY-BUILT CHIMNEYS.

#### 6 FIRE DEPARTMENT NOTES

- FIRE SPRINKLER SYSTEM:** (G.C. TO CONFIRM SYSTEM REQUIREMENTS WITH LOCAL MUNICIPALITY)
- PROVIDE AN AUTOMATIC FIRE SPRINKLER SYSTEM. THE SYSTEM IS REQUIRED TO BE DESIGNED FOR AN ORDINARY HAZARD GROUP 1 DESIGN DENSITY.
  - THE FIRE PROTECTION CONTRACTOR SHALL SUBMIT PLANS AND CALCULATIONS SEPARATELY TO THE LOCAL FIRE DEPARTMENT FOR REVIEW AND PERMIT.
  - THE AUTOMATIC SPRINKLER SYSTEM IS REQUIRED TO BE INSTALLED AND TESTED FOR COMPLIANCE WITH NFPA STANDARD 13 1994 EDITION. STORAGE HEIGHT WILL BE RESTRICTED IN THIS BUILDING TO A MAXIMUM OF 12 FEET IN HEIGHT.
  - ALL COMMERCIAL-TYPE COOKING EQUIPMENT SHALL BE PROTECTED BY AN APPROVED AUTOMATIC FIRE EXTINGUISHING SYSTEM.
- FIRE ALARM SYSTEM:** (G.C. TO CONFIRM SYSTEM REQUIREMENTS WITH LOCAL MUNICIPALITY)
- PROVIDE A FIRE ALARM AND DETECTION SYSTEM CONNECTED TO THE FIRE SPRINKLER SYSTEM.
  - THE FIRE ALARM SYSTEM AND DETECTION SHALL BE INSTALLED IN COMPLIANCE WITH NFPA STANDARD 72.
  - THE FIRE ALARM CONTRACTOR SHALL SUBMIT PLANS AND CALCULATIONS SEPARATELY TO THE LOCAL FIRE DEPARTMENT FOR REVIEW AND PERMIT.
  - THE FIRE ALARM SYSTEM IS REQUIRED TO BE AUDIBLE THROUGHOUT THE BUILDING. ADDITIONAL ALARM DEVICES MAY BE REQUIRED UPON TESTING OF THE SYSTEM. (ONLY REQ'D WHEN THERE ARE 100+ HEADS)
  - THE FIRE ALARM SYSTEM IS REQUIRED TO BE MONITORED BY AN APPROVED CENTRAL STATION.
  - LOCATE FIRE ALARM CONTROL PANEL IN THE OFFICE ROOM THE REQUIRED DUCT SMOKE DETECTORS SHALL BE TIED INTO THE BUILDING MONITORING SYSTEM.
  - FIRE / ALARM SYSTEM TO BE FURNISHED AND INSTALLED BY OWNER.
- ENERGY NOTES:**
- PROVIDE R-19 BATT INSULATION IN EXTERIOR WALLS.
  - FIXED WINDOWS SHALL BE SEALED TO LIMIT AIR INFILTRATION.
  - ALL EXTERIOR DOORS SHALL LIMIT AIR INFILTRATION AROUND THEIR PERIMETER WHEN IN A CLOSED POSITION.
  - PROVIDE SEAL AT HEAD, SILL AND JAMB OF WALL PENETRATIONS.
  - SITE-BUILT DOORS MOUNTED ON THE INSIDE OR THE OUTSIDE OF EXTERIOR WALLS SHALL HAVE A MIN. 1" LAP AT JAMBS.
  - OPEN EXTERIOR JOINTS AROUND WINDOW AND DOOR FRAMES, BETWEEN WALLS AND FOUNDATIONS, BETWEEN WALLS AND ROOF, BETWEEN WALL PANELS AT PENETRATIONS OF UTILITIES THROUGH THE ENVELOPE, SHALL BE SEALED, CAULKED, OR WEATHER STRIPPED TO LIMIT AIR LEAKAGE.
  - PROVIDE A "CERTIFICATION OF COMPLIANCE" SIGNED BY THE OWNER, GENERAL CONTRACTOR, ARCHITECT, OR ENGINEER TO THE BUILDING DEPARTMENT STATING THAT THE WORK HAS BEEN PERFORMED AND MATERIALS INSTALLED ACCORDING TO THE PLANS AND SPECIFICATIONS AFFECTING NONRESIDENTIAL ENERGY DESIGN. CONTACT THE LOCAL BUILDING DEPARTMENT REGARDING EXACT REQUIREMENTS FOR SUBMITTAL.
- HEALTH DEPARTMENT NOTES:**
- ALL EQUIPMENT AND INSTALLATION WILL MEET NATIONAL SANITATION FOUNDATION (NSF) STANDARDS.
  - ALL LAVATORIES OR HAND SINKS MUST HAVE A COMBO FAUCET OR PREMIX FAUCET CAPABLE OF SUPPLYING WARM WATER FOR A MIN. OF 10 SECONDS.
  - THE JANITORIAL SINK FAUCET MUST BE PROTECTED WITH AN APPROVED BACK FLOW PREVENTION DEVICE.
  - ALL SINKS SHALL BE PROVIDED WITH HOT AND COLD RUNNING WATER FROM A MIXING FAUCET.

#### 7 MISCELLANEOUS NOTES

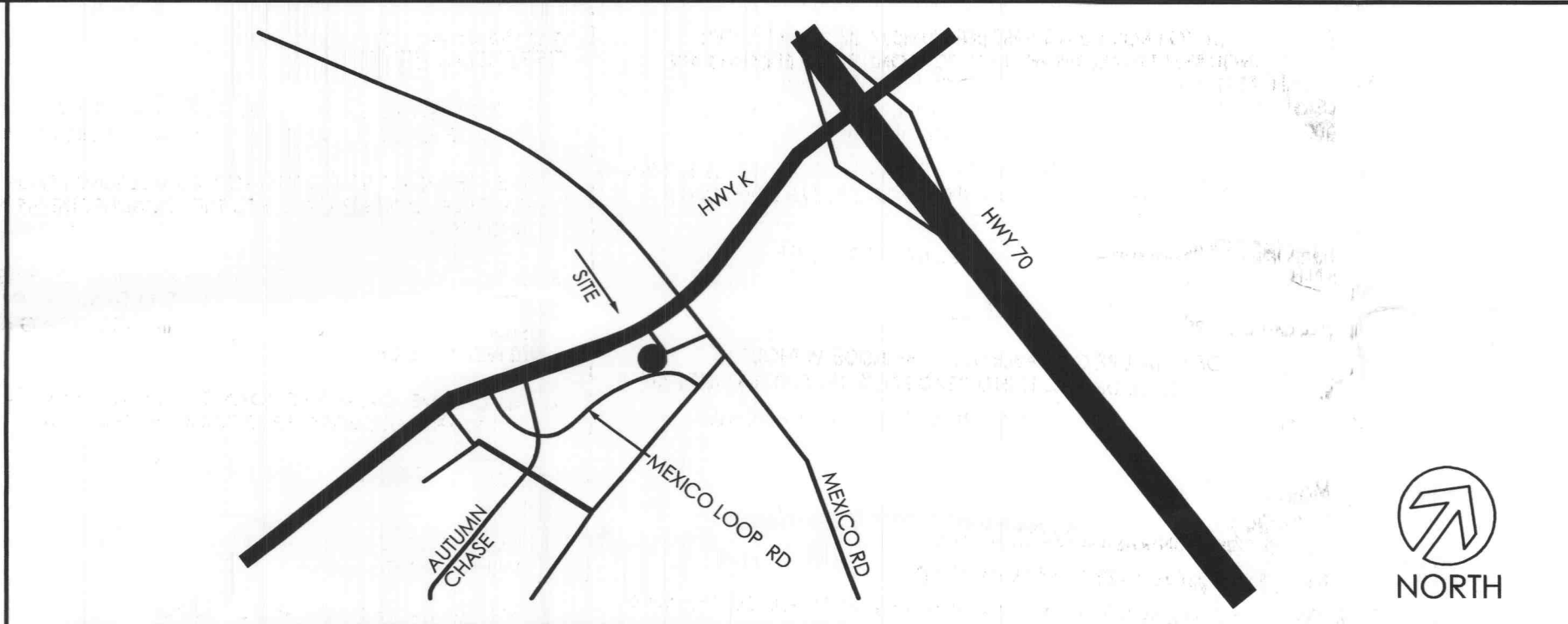

#### 2 AREA MAP

SCALE: N.T.S.

OWNER:		ARCHITECT:	
RED ROBIN GOURMET BURGERS	6312 S. FIDDLERS GREEN CIRCLE	CHIPMAN ADAMS	1550 NORTH NORTHWEST HIGHWAY
	SUITE 200 NORTH GREENWOOD VILLAGE, COLORADO 80111 (303) 846-6000		PARK RIDGE, IL 60068 (847) 298-6900
PROJECT MANAGER:		STRUCTURAL:	
STEVE SMITH	SMITH CONSULTING SERVICES	R.J. JOHNSON & ASSOC.	175 N. WASHINGTON ST.
	40 SOUTH SHORE DRIVE NEWNAN, GA 30263 770-254-9228		WHEATON, IL 60187 (630) 453-9060
CIVIL:		MEP:	
EDWARDS AND KELCEY INC.	1 NORTH FRANKLIN, SUITE 500 CHICAGO, IL 60606 312-251-3000	DALE SCHNACKEL COMPANY	3035 S 72nd STREET SUITE 101 OMAHA, NE 68124 (402) 391-7680

#### 4 PROJECT CONTACTS

SCALE: NONE

DEPARTMENT	CONTACT	PHONE
PLANNING & ZONING	SHANNON GERRARD	-
PLAN REVIEW	DEBBIE CAMMANN	636 379 5599
BUILDING	-	-
STRUCTURAL	-	-
MECHANICAL	-	-
PLUMBING	-	-
ELECTRIC SERVICE	JIM HOVIS	636 639 8316
FIRE PREVENTION	MARK MORRISON	636 272 3493
STREETS & HIGHWAYS	-	-
WATER	DORTHY POND	636 561 3737
SANITARY / SEWER	FRANK GODWIN	636 559 5599
HEALTH DEPT.	ST. CHARLES COUNTY HEALTH	636 949 7400
WASTE MANAG.	JUDY BLANKY	314 506 4700
GAS SERVICE	MIKE LANGAN	636 9782663 - X103

#### 8 LOCAL CONTACTS

REVISIONS	SHEET #	SHEET NAME
CS1.0	COVER SHEET	
-	C1.0	ALTA/ASCM LAND TITLE SURVEY
-	C1.1	EXISTING CONDITIONS AND REMOVAL PLAN
-	C1.2	GENERAL NOTES AND SPECIFICATIONS
-	C2.0	SITE PLAN
-	C2.1	SITE DETAILS
-	C3.0	GRADING AND PAVING PLAN
-	C3.1	UTILITY PLAN
-	C3.2	SEWER PLAN AND PROFILES
-	C3.3	EROSION CONTROL PLAN
-	C3.4	UTILITY DETAILS
-	L1.0	LANDSCAPE PLAN
-	L1.1	LANDSCAPE DETAILS
-	I1.0	IRRIGATION SYSTEM LAYOUT
-	I1.1	IRRIGATION SYSTEM SPECS AND DETAILS
-	A1.0	ARCHITECTURAL SITE PLAN
-	A1.1	ARCHITECTURAL SITE DETAILS
-	A1.2	SERVICE YARD PLAN, ELEVATIONS & DETAILS
-	A2.0	DIMENSION PLAN
-	A2.1	WINDOW, DOOR, HARDWARE AND MATERIAL SCHEDULES
-	A2.2	FLOOR FINISH & CURB PLAN
-	A2.3	ROOF PLAN
-	A2.4	FURNISHING PLAN
-	A2.5	REFLECTED CEILING PLAN
-	A3.0	EXTERIOR ELEVATIONS
-	A4.0	WALL SECTIONS
-	A4.1	ENLARGED SECTIONS
-	A4.2	ENLARGED SECTION & DETAILS
-	A5.0	DINING ROOM ELEVATIONS
-	A5.1	DINING ROOM ELEVATIONS
-	A5.2	KITCHEN ELEVATIONS
-	A5.3	RESTROOM & OFFICE ENLARGED PLANS & ELEVATIONS
-	A6.0	INTERIOR SECTIONS
-	A6.1	INTERIOR DETAILS
-	FN-1	MILLWORK DETAILS
-	K1.0	KITCHEN EQUIPMENT PLAN
-	K1.1	KITCHEN EQUIPMENT SCHEDULES
-	K1.2	KITCHEN EQUIPMENT SCHEDULES
-	K2.0	KITCHEN EQUIPMENT ROUGH-IN FLOOR PLAN
-	K3.0	KITCHEN EQUIPMENT ROUGH-IN ELEVATIONS
-	K3.1	KITCHEN EQUIPMENT ROUGH-IN ELEVATIONS
-	K3.2	KITCHEN EQUIPMENT ROUGH-IN ELEVATIONS
-	S1.0	FOUNDATION PLAN
-	S2.0	ROOF FRAMING PLAN
-	S3.0	FOUNDATION SECTIONS
-	S4.0	FRAMING SECTIONS
-	S5.0	FRAMING DETAILS
-	S6.0	STRUCTURAL SPECIFICATIONS
-	S7.0	GENERAL NOTES
-	ME1.1	MECHANICAL, ELECTRICAL & PLUMBING ROOF PLAN
-	H1.1	HVAC FLOOR PLAN
-	H2.1	HVAC EQUIPMENT SCHEDULES
-	H3.1	HVAC DETAILS
-	H4.1	FIRE SUPPRESSION & EXHAUST HOOD DETAILS
-	P1.1	PLUMBING FLOOR PLAN - WASTE & VENT
-	P1.2	PLUMBING FLOOR PLAN - WATER & GAS
-	P1.3	GENERAL PLUMBING NOTES
-	P2.1	PLUMBING DETAILS
-	P3.1	WASTE & VENT RISER DIAGRAM & PLUMBING DETAILS
-	P3.2	WATER RISER DIAGRAM & PLUMBING DETAILS
-	FP1.1	FIRE PROTECTION PLAN
-	FP1.2	FIRE PROTECTION PLAN
-	E1.1	LIGHTING FLOOR PLAN & NOTES
-	E1.2	POWER FLOOR PLAN & NOTES
-	E1.3	SPECIAL SYSTEMS FLOOR PLAN & DETAILS
-	E2.1	ELECTRICAL SYMBOLS, LEGENDS & NOTES
-	E2.2	ELECTRICAL DETAILS
-	E2.3	ELECTRICAL PANEL SCHEDULE & DETAILS
-	E3.1	ELECTRICAL SITE PLAN & NOTES
-	MEP	MECHANICAL, ELECTRICAL & PLUMBING SPECIFICATIONS
-	SP1.1	SPECIFICATIONS
-	SP2.1	SPECIFICATIONS
-	SP3.1	SPECIFICATIONS
-	SP4.1	SPECIFICATIONS
-	SP5.1	SPECIFICATIONS
-	SP6.1	SPECIFICATIONS
-	SP7.1	SPECIFICATIONS
-	SP8.1	SPECIFICATIONS
-	SP9.1	SPECIFICATIONS
-	SP10.1	SPECIFICATIONS
-	SP11.1	SPECIFICATIONS
-	SP12.1	SPECIFICATIONS
-	VENDOR DRAWINGS	
-	FA-1	FIRE ALARM AND SECURITY SYSTEM PLAN
-	FA-2	FIRE ALARM AND SECURITY SYSTEM DETAILS
-	R-1	REFRIGERATION PLAN
-	MW	MILLWORK DRAWINGS
-	DELFD	DELFD DRAWING
-	EAV-1	AUDIO WIRING DIAGRAM
-	EAV-2	VIDEO WIRING DIAGRAM
-	EAV-3	A/V EQUIPMENT RACK ELEVATION AND DETAILS
-	EAV-4	SPEAKER LAYOUT AND DETAILS
-	EAV-5	VIDEO LAYOUT AND MOUNTING DETAILS

RED ROBIN GOURMET BURGERS  
1440 MEXICO LOOP ROAD EAST  
O'FALLON, MO

COVER SHEET  
PLANNING & ZONING RE-ISSUE: 07/06/05

CHIPMAN ADAMS LTD.  
Architect  
1440 Mexico Loop Road East  
O'Fallon, MO 62456  
Tel: 636-298-4900  
Fax: 636-298-4900

Revisions:  
 06/17/05 PLANNING & ZONING ISSUE  
 07/06/05 PLANNING & ZONING RE-ISSUE  
 07/06/05

Checked By: [Signature]  
 Drawn By: [Signature]  
 Scale: NONE  
 Date: 6/17/05  
 Job No.: 05-4393  
 Sheet No.: CS1.0

# FOR INFORMATIONAL PURPOSES ONLY

File