

Warping Detail - Fawnwood Lane
Top of curb elevations

1" = 10' Horiz.
 1" = 2' Vert.

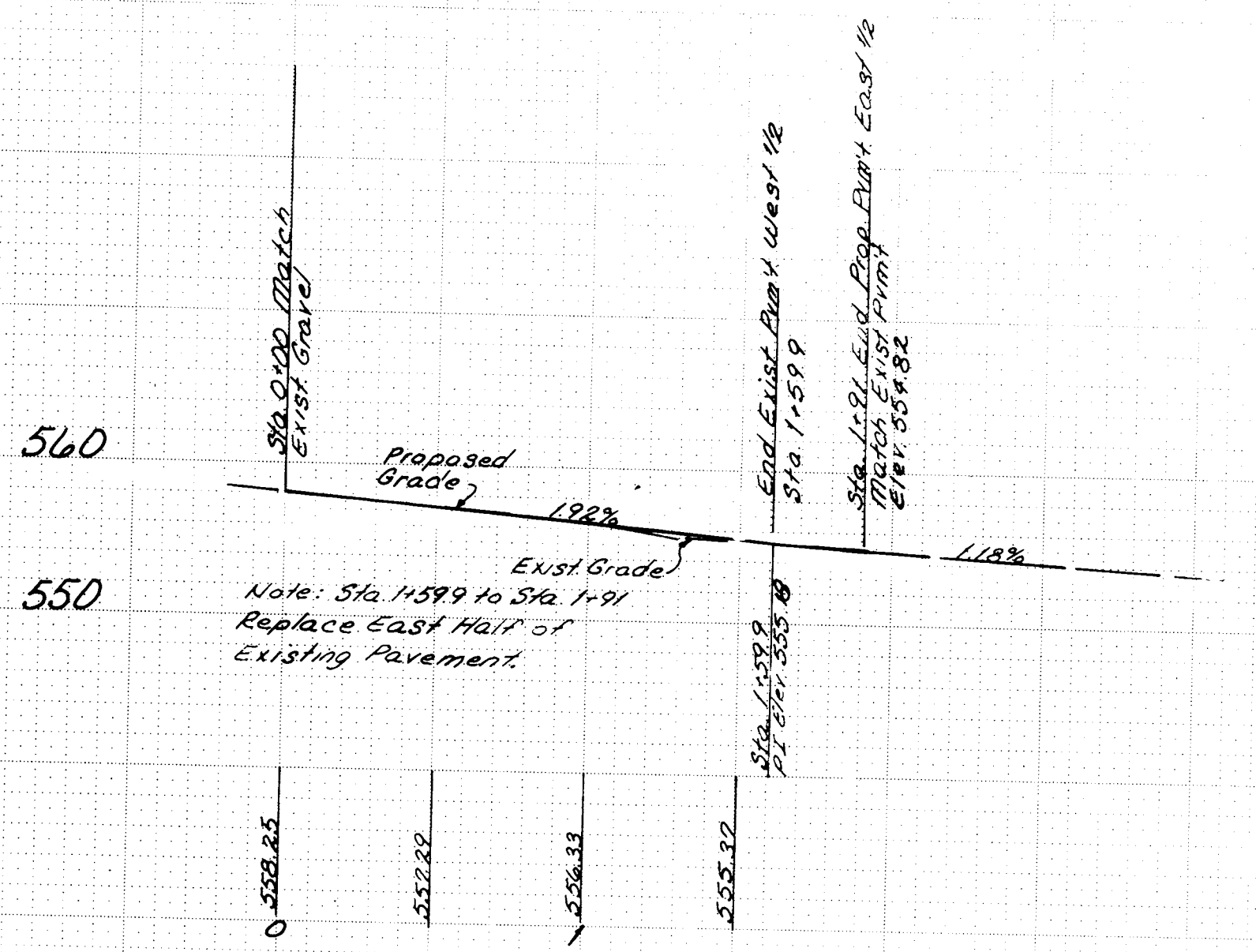

Royal Oaks Drive Profile
 1" = 50' Horiz.
 1" = 10' Vert.

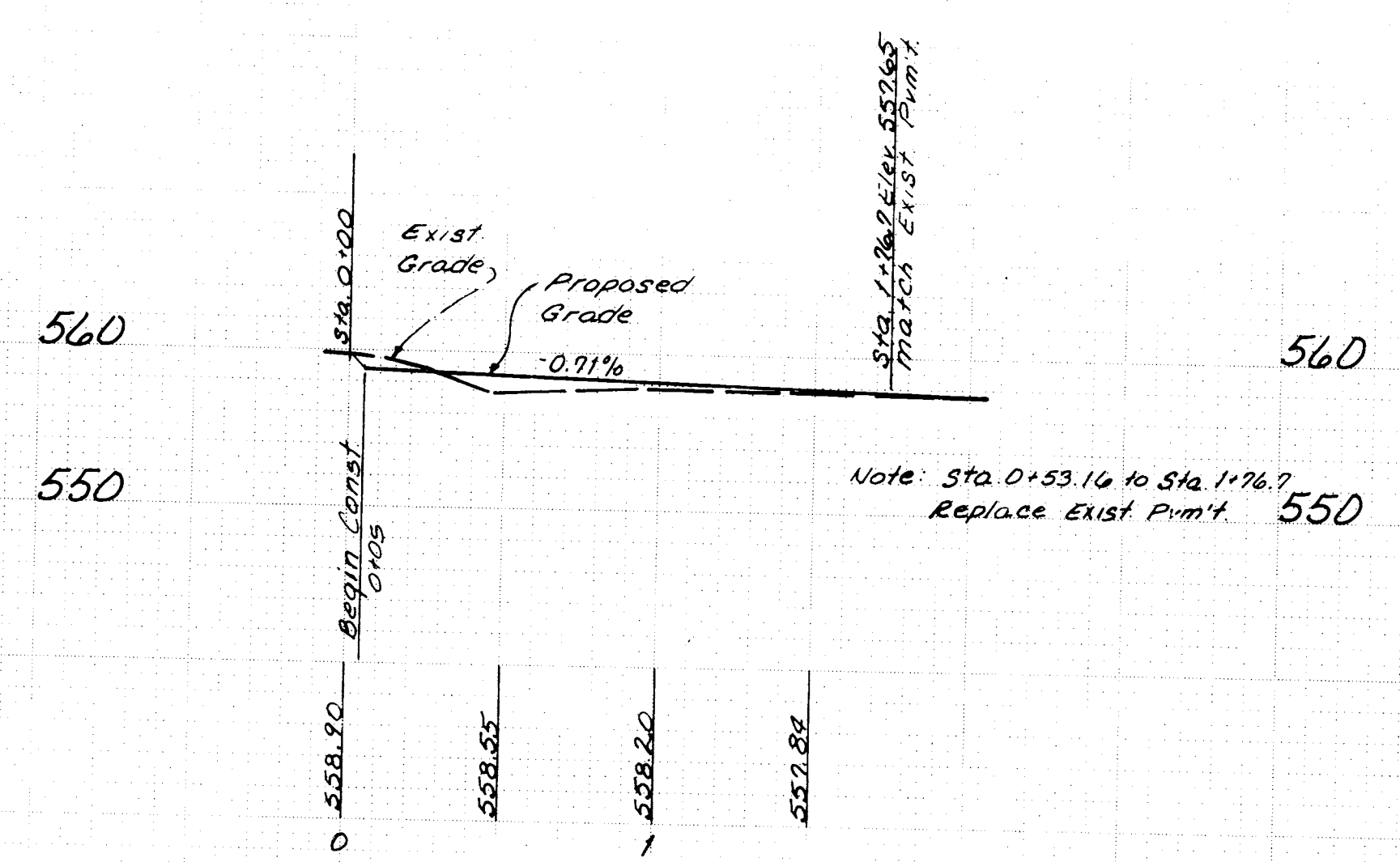

Knightwood Lane Profile
 1" = 50' Horiz.
 1" = 10' Vert.

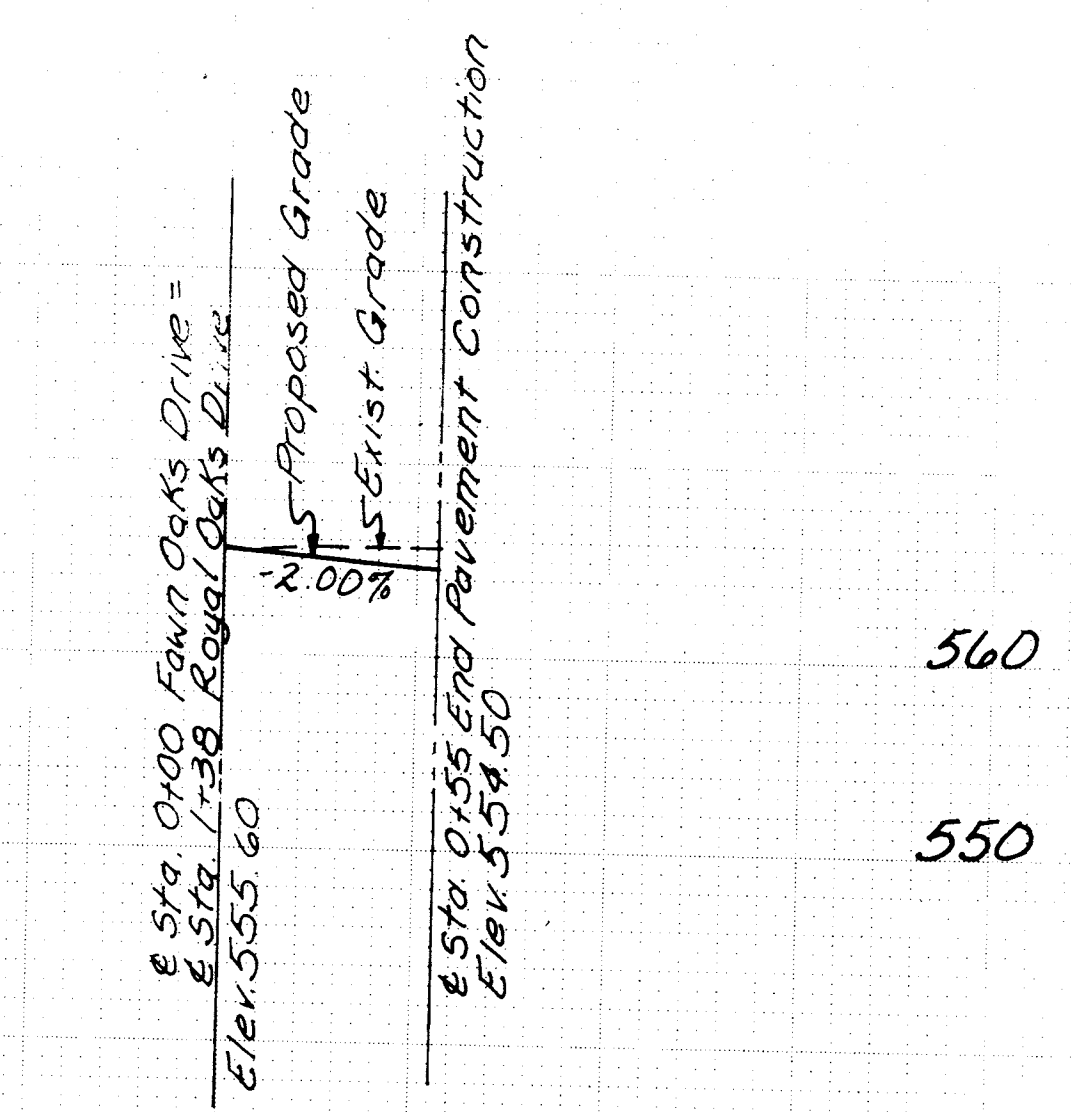

Fawn Oaks Drive
 1" = 50' Horiz.
 1" = 10' Vert.

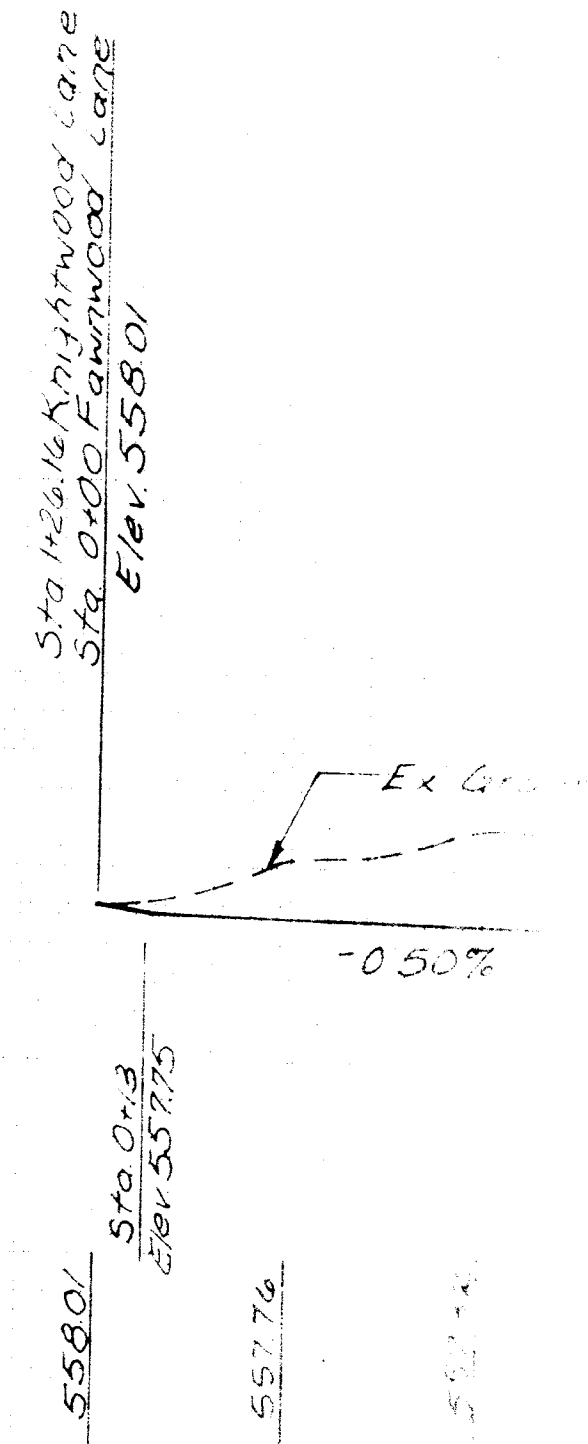

Fawnwood
 1" = 50' Horiz.
 1" = 10' Vert.