

Knightwood Lane Left Radius Return
Warping Detail-Top of Curb Elevations scale: 1"=5' Horiz.
1"=2' Vert.

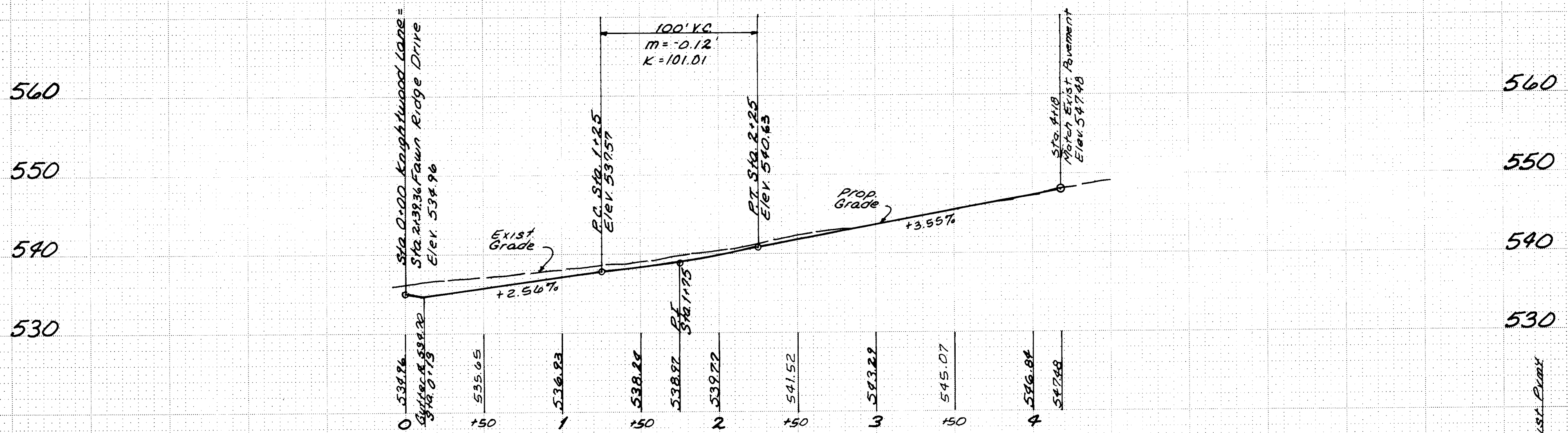

Knightwood Lane
Scale: 1"=10' Vert.
1"=50' Horiz.

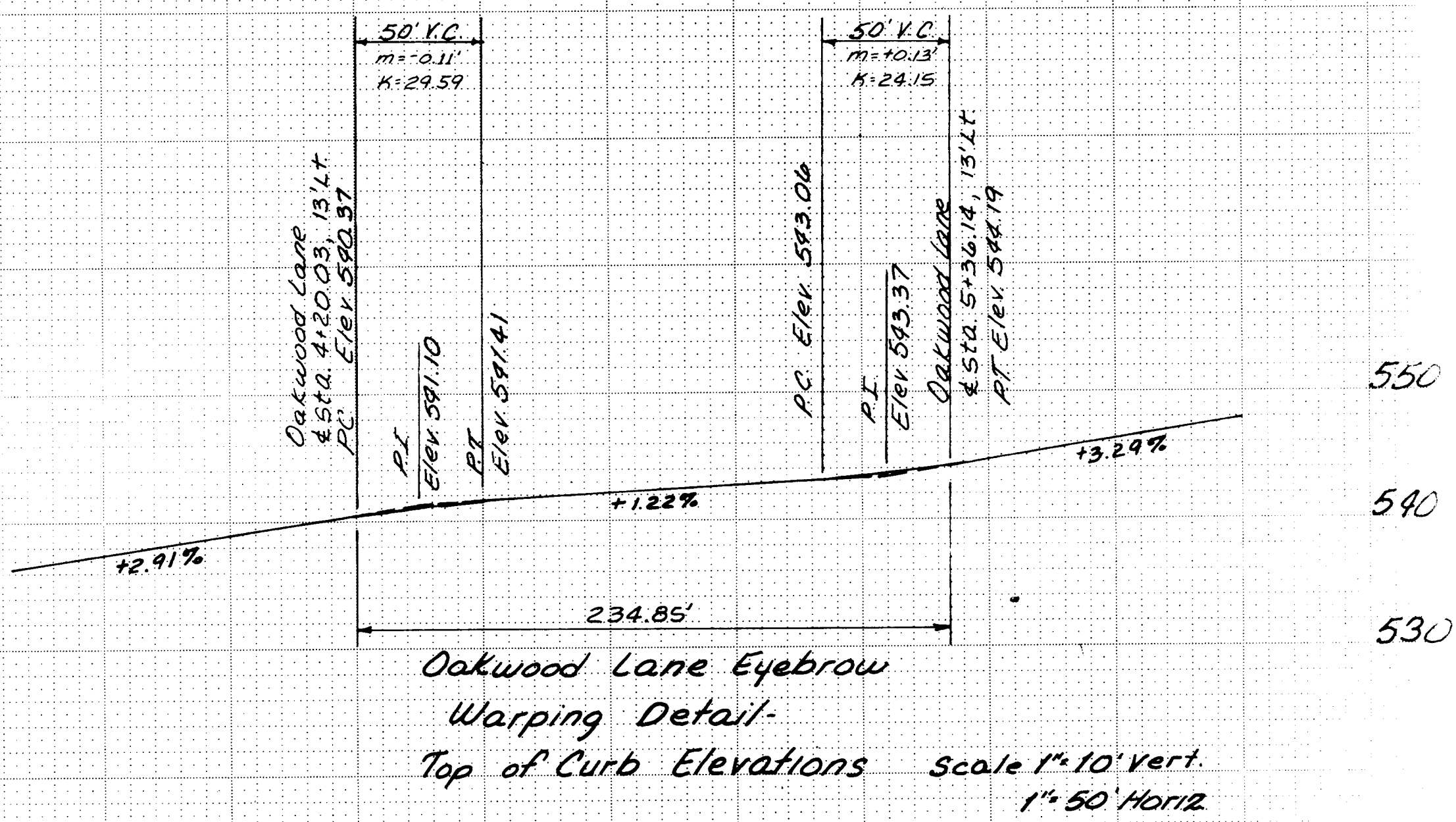

Oakwood Lane Eyebrow
Warping Detail-
Top of Curb Elevations scale 1"=10' Vert.
1"=50' Horiz.

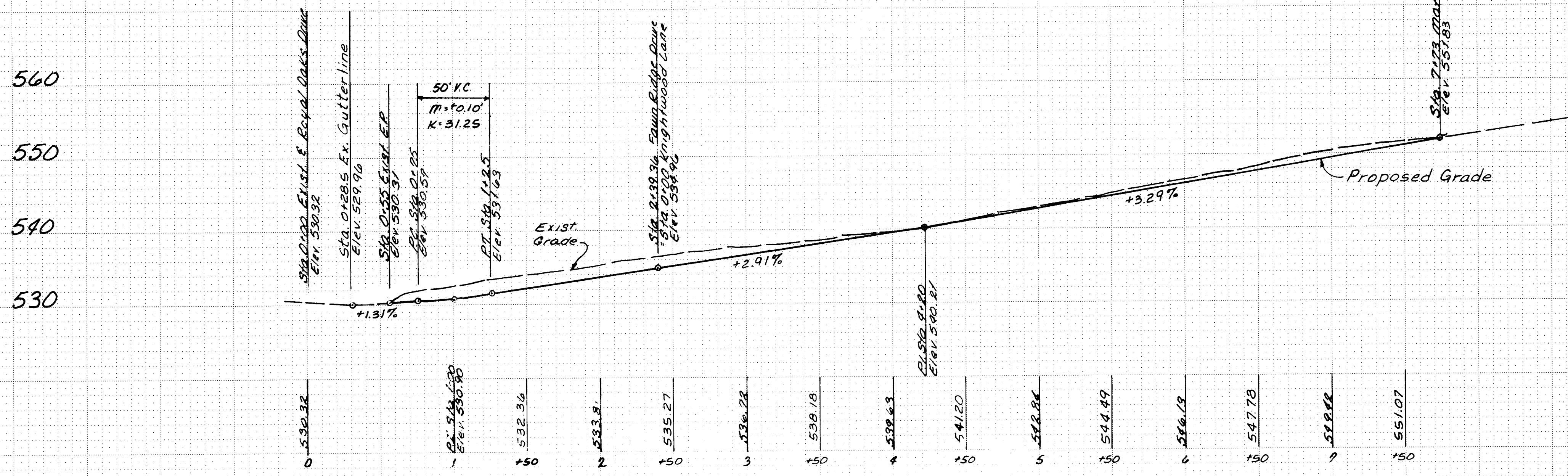

Fawn Ridge Drive
Oakwood Lane
Scale: 1"=10' Vert.
1"=50' Horiz.