

ST. PAUL ESTATES  
P.B. 20 / PG. 108-109  
St. Charles County, Mo.  
Zoned R-1E

**GBA**  
GEORGE BUTLER ASSOCIATES, INC.  
Engineers / Architects / Landscape Architects / Planners  
Kansas City, Mo. / Lenexa, Ka. / O'Fallon, Mo. / Ames, Ia. / Oklahoma City, Ok.

DATE: JUNE 1993  
DESIGN BY: GRH  
DRAWN BY: JG  
PROJECT NO: 6803

**GRADING PLAN**

SHEET NO. **3** TOTAL SHEETS **9**

REVISIONS	BY	DATE
Min COVER note & Runoff Lots 104-107 & 124	JG	7/19/93

- GENERAL NOTES**
- All filled and graded areas shall be seeded with grass within 45 days following completion of filling or grading.
  - Due to extensive grading necessitated by the site topography, if any, existing trees can be retained. Therefore, not later than 2 years following completion of grading fifteen (15) trees per acre shall be planted. These hardwood trees shall be not less than (2) inches in diameter and not less than (8) feet in height.  
15 trees/acre X 1.4 acres = 21 trees
  - No slope shall be more than 3:1.
  - APPROXIMATE ROUGH GRADING QUANTITIES:  
CUT - 11,195 C.Y. FILL - 24,029 C.Y.
  - Use Borrow Area, as shown on sheet 3, as needed from street Sta. 10+00 to Sta. 15+00.

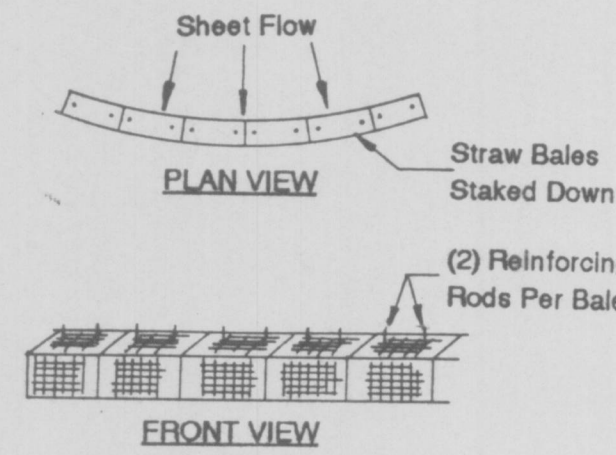

**SILTATION CONTROL NOTE**  
Siltation Control shall be Bales of Straw placed end to end and anchored to ground with 4' long reinforcing rods.  
Note: Siltation control is to be placed in all areas where a potential exists for silt to leave the construction site.  
Note: Straw Bale Erosion Control to be used until vegetation is established.

STRAW BALE DETAIL

**SILTATION CONTROL DETAIL N.T.S.**

STRUCTURE	STA	DISTANCE	STREET
EP #1	8+80	25' RT	FAWN OAKS DRIVE
MH #2	8+56.67	17' RT	FAWN OAKS DRIVE
AI #3	-	-	-
CI #4	8+05.25	17' RT	FAWN OAKS DRIVE
CI #5	2+94.77	17' RT	CRESTWOOD DRIVE
DCI #6	6+90.75	17' RT	FAWN OAKS DRIVE
DCI #7	6+90.75	17' RT	FAWN OAKS DRIVE

SANITARY MANHOLES			
LINE "A"			
EX MH #16	-	-	-
MH #100	14+76.67	25' RT	FAWN OAKS DRIVE
MH #101	11+32.67	25' RT	FAWN OAKS DRIVE
MH #102	9+94.67	25' RT	FAWN OAKS DRIVE
MH #103	7+16.70	26.35' RT	FAWN OAKS DRIVE
MH #104	3+16.39	21' RT	FAWN OAKS DRIVE
MH #105	2+18.24	18' RT	FAWN OAKS DRIVE
MH #106	1+94.36	89' LT	FAWN OAKS DRIVE
LINE "B"			
MH #103	3+23.43	31.55' RT	CRESTWOOD DRIVE
MH #107	1+48.54	17' RT	CRESTWOOD DRIVE

**STORM WATER DETENTION**

**PHASES CONSTRUCTED:**

PHASE 2	10.38 Ac.
PHASE 3A	2.11 Ac.
PHASE 3B	4.87 Ac.
PHASE 3D	1.79 Ac.
PHASE 4A (PROPOSED)	19.15 Ac. X (3.26-2.31) X 1800 = 32,766 c.f.
	5.36 Ac. X (3.26-2.31) X 1800 = 9,168 c.f.
	24.51 Ac. 41,932 c.f.
REQ. SEDIMENT STORAGE	24.51 Ac. X 150 c.f. = 3,677 c.f.
REQ. DETENTION STORAGE	45,609 c.f.

**DETENTION PROVIDED:**

PHASE 2	58,912 c.f. (E. 531)
PHASE 3B	20,100 c.f.
	79,012 c.f.

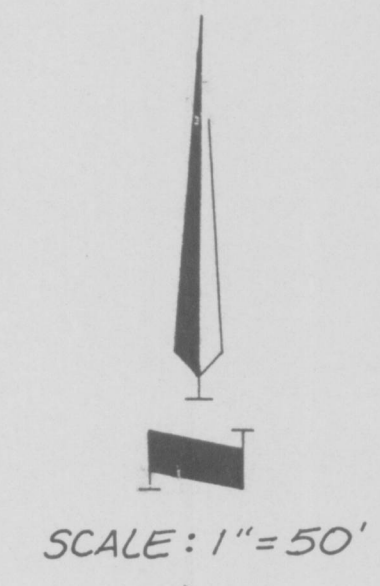
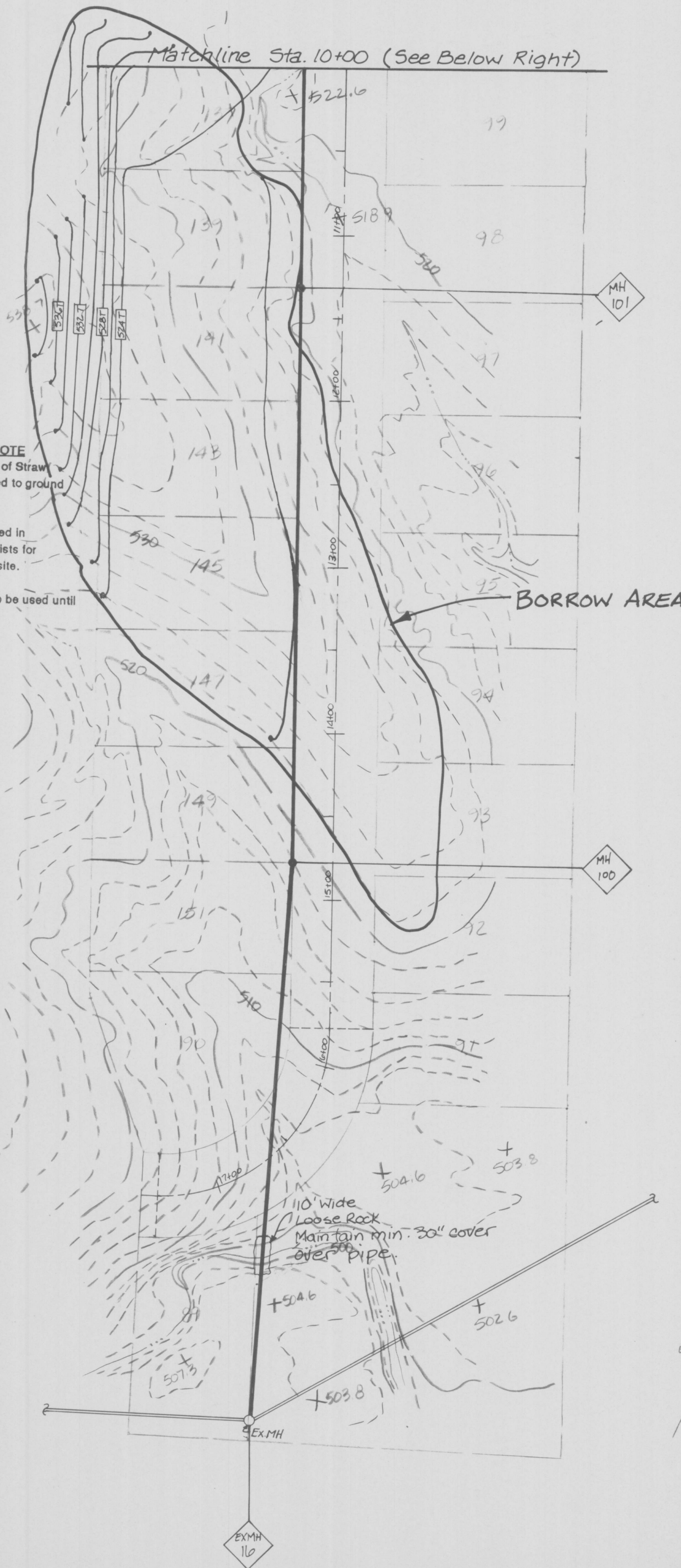

LOT #	FINISH FLOOR
103	542.5
104	545.5
105	547.5
106	551.0
107	552.5
108	553.5
109	554.5
110	555.0
111	555.0
112	555.0
113	555.0
118	554.0
118	553.0
120	550.0
122	546.5
124	546.0
125	542.0
127	546.0
128	544.0

N/F  
Kellerman, Etal.  
878/887  
Zoned P.U.D.

As-Built 5/23/94  
by J.G.

**LEGEND**

