

All catch basins shall be separated from the pavement and curb by boxing out around basin as shown above. Expansion joint material shall extend completely through curb and slab. Movable castings within the pavement limits shall be boxed in like manner except when telescoping type castings are used.

2. When a joint falls within 5 ft. of or contacts basins, manholes, or other structures, shorten one or more panels either side of opening to permit joint to fall on round structures and at or between corners of rectangular structures.

3. All transverse joints must extend through curbs and must be continuous across pavement, except tied transverse construction joints. Expansion joints will not be required except at structures or as shown on the plans.

4. Maximum transverse joint spacing shall be in accordance with the following table:

Max. spacing in ft.	Type of Coarse Agg.	Max spacing in ft.	Type of Coarse Agg.
25	Crushed Granite	15	Siliceous gravel
20	Crushed Limestone	15	Gravel smaller than 3/4 in.
20	Calcareous gravel	15	Slag

5. All soft and yielding material and other portions of the subgrade which will not compact readily when rolled or tamped shall be removed as directed and replaced with suitable material placed and compacted.

The subgrade shall be thoroughly compacted with suitable equipment so as to have uniform density at moisture contents of not less than standard optimum (AASHTO T98).

All sewer trenches and structure excavations shall be backfilled to natural or finished grade as soon as conditions permit. All backfill shall be compacted with mechanical tampers in layers of not over 6 in. loose material. In order to prevent differential heave the backfill material shall be the same material as that of the subgrade adjacent to the trench.

6. The minimum cement content shall not be less than 6.0 sacks (94 lb. per sack) per cu. yd. of concrete. The maximum size aggregate shall not exceed 1/4 of the slab thickness. The maximum slump shall not exceed 3 in. All concrete shall be air entrained in accordance with the following table:

Max. size of Coarse Aggregate, inches	Air Content, per cent by volume
1-1/2, 2	5 ±
3/4, 1	6 ±
3/8, 1/2	7-1/2 ±

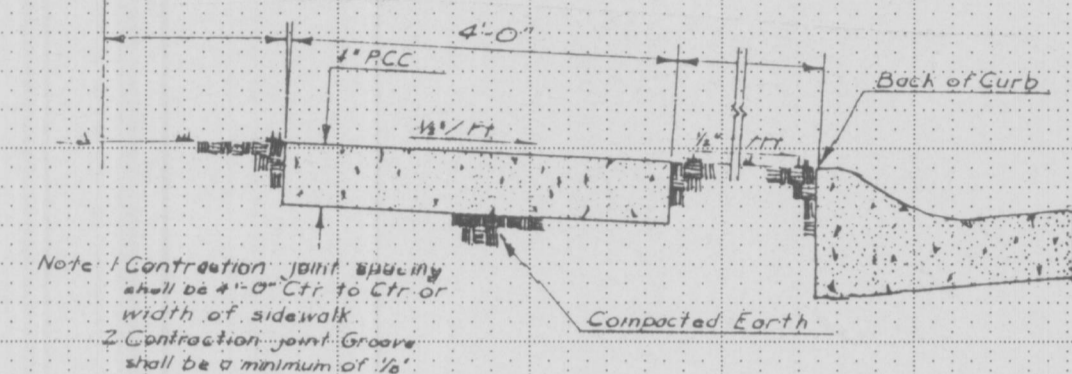

STANDARD SIDEWALK DETAIL
N.T.S.

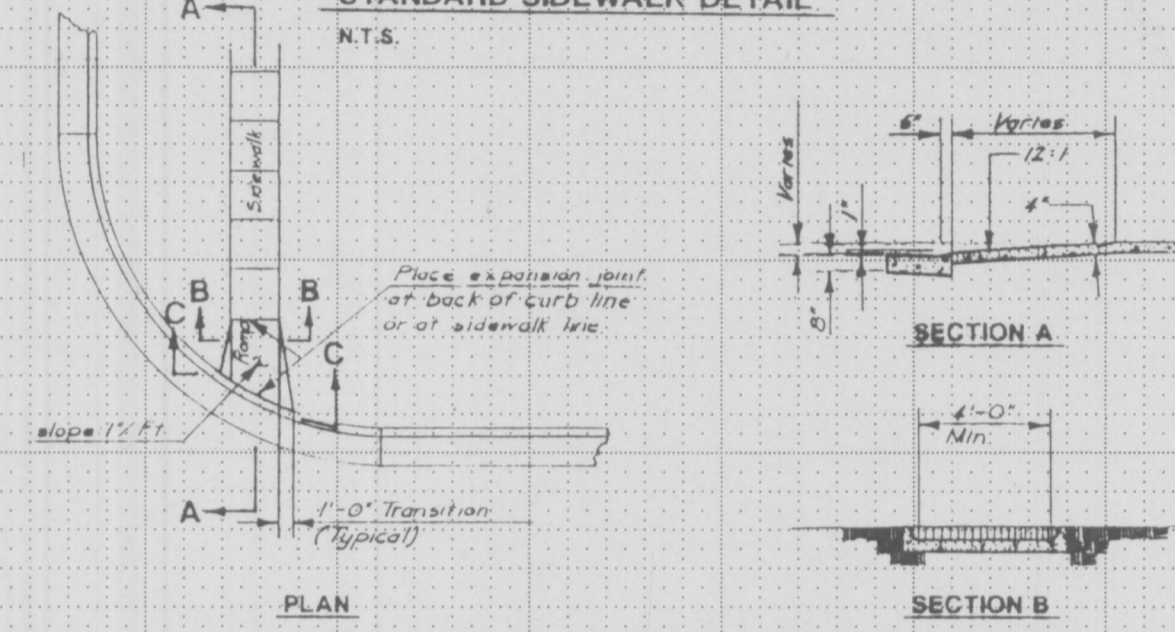

SIDEWALK RAMP DETAILS
N.T.S.

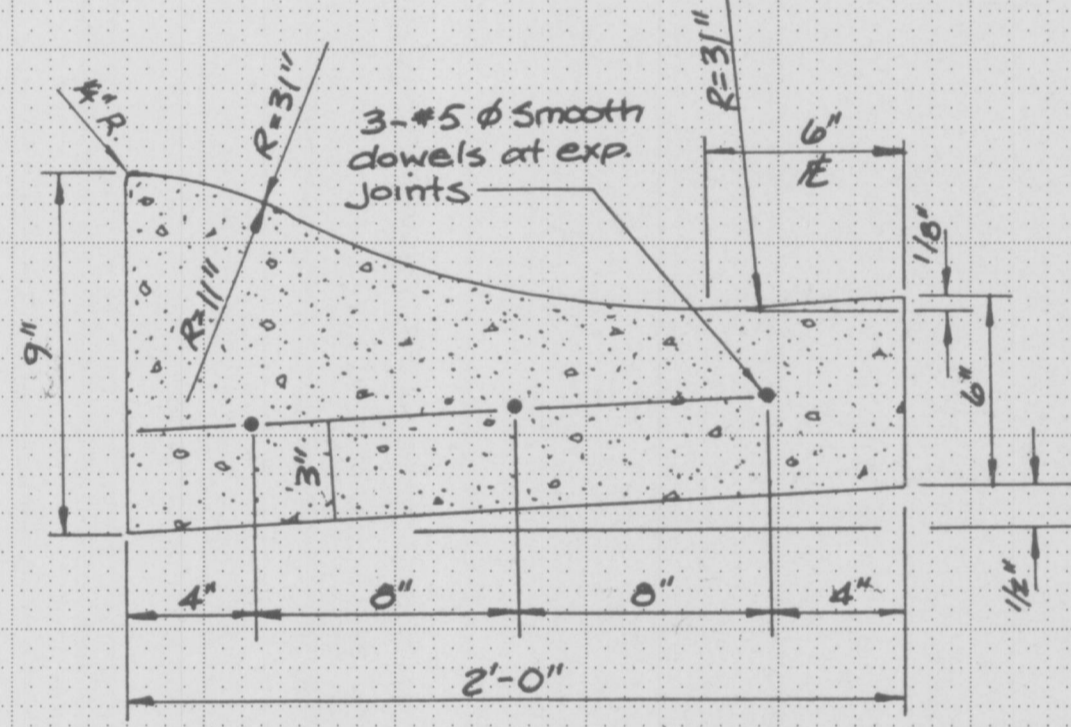
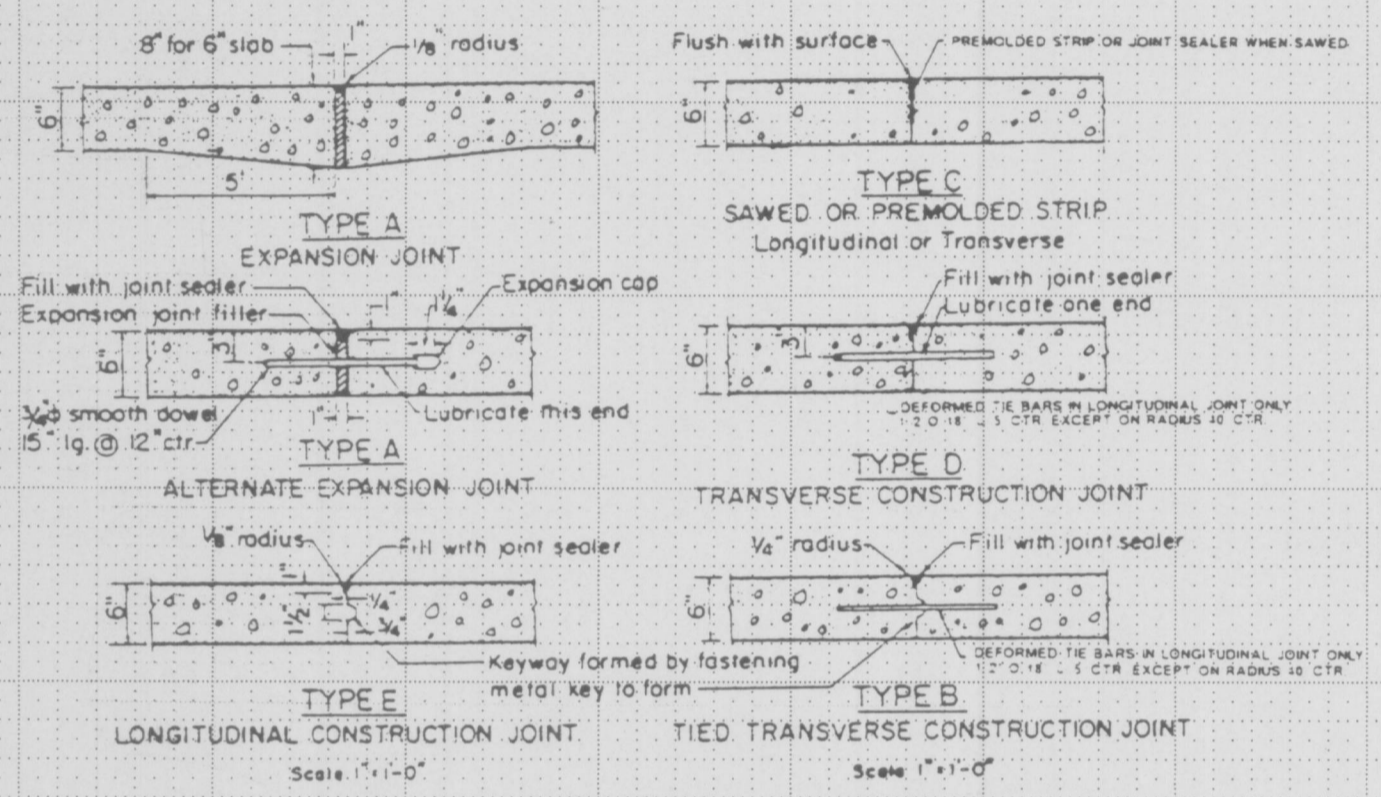

INTEGRAL ROLLED CURB

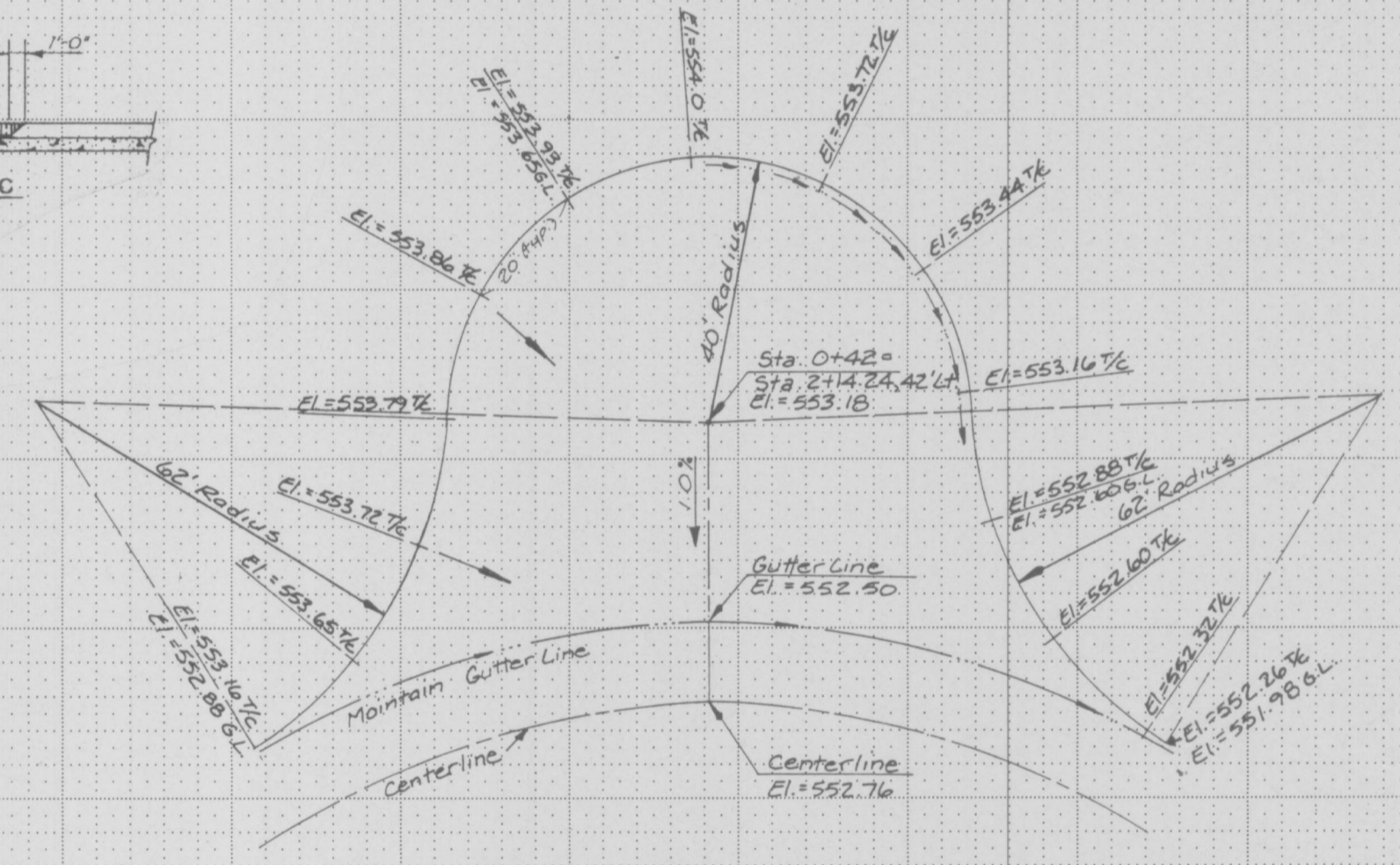

FAWN OAKS DRIVE
PAVEMENT WARPING DETAIL

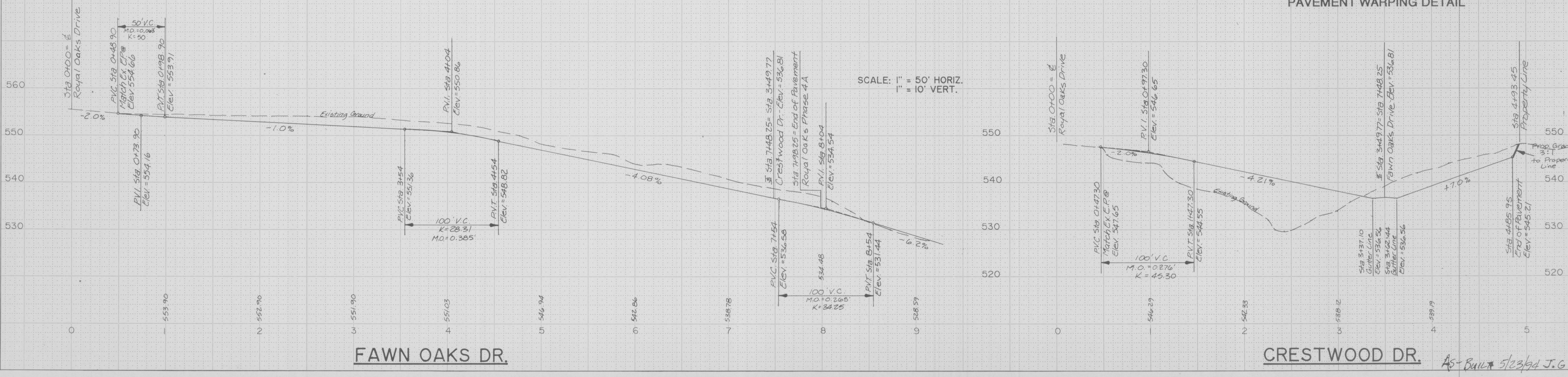

FAWN OAKS DR.

CRESTWOOD DR.

AS-BUILT 5/23/94 J.G.