

**1 Concrete Wheel Stop**

Scale: Not To Scale

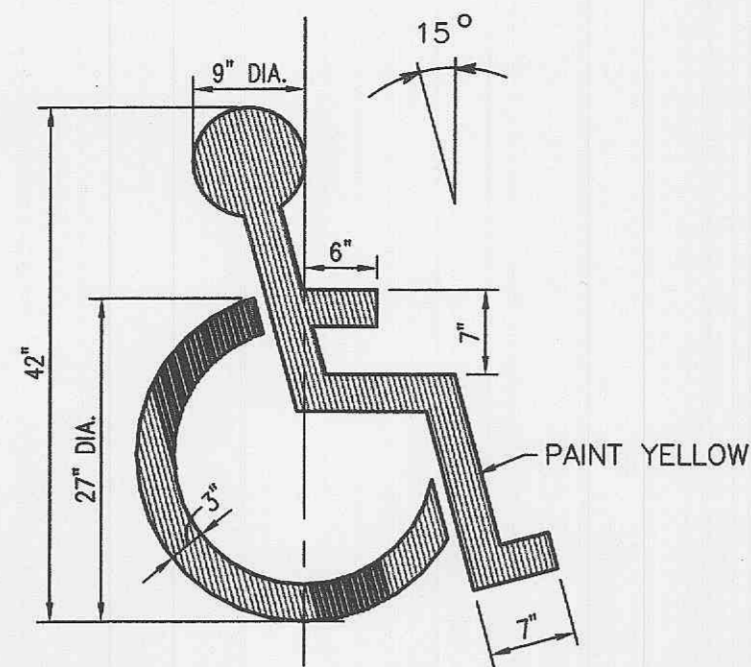

**2 Painted Handicap Parking Symbol**

Scale: Not To Scale

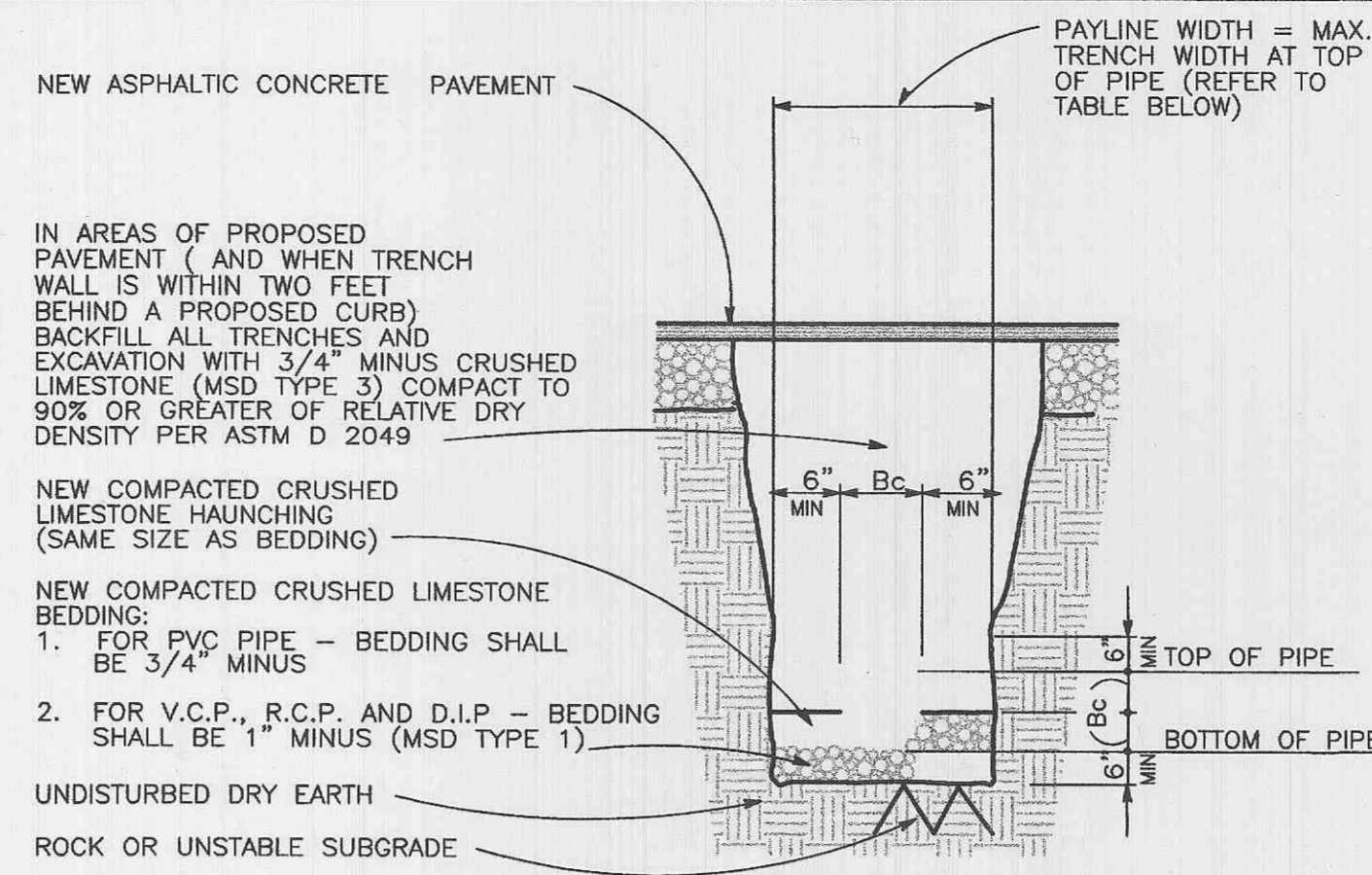

**3 Typical Trench Detail**

Scale: Not To Scale

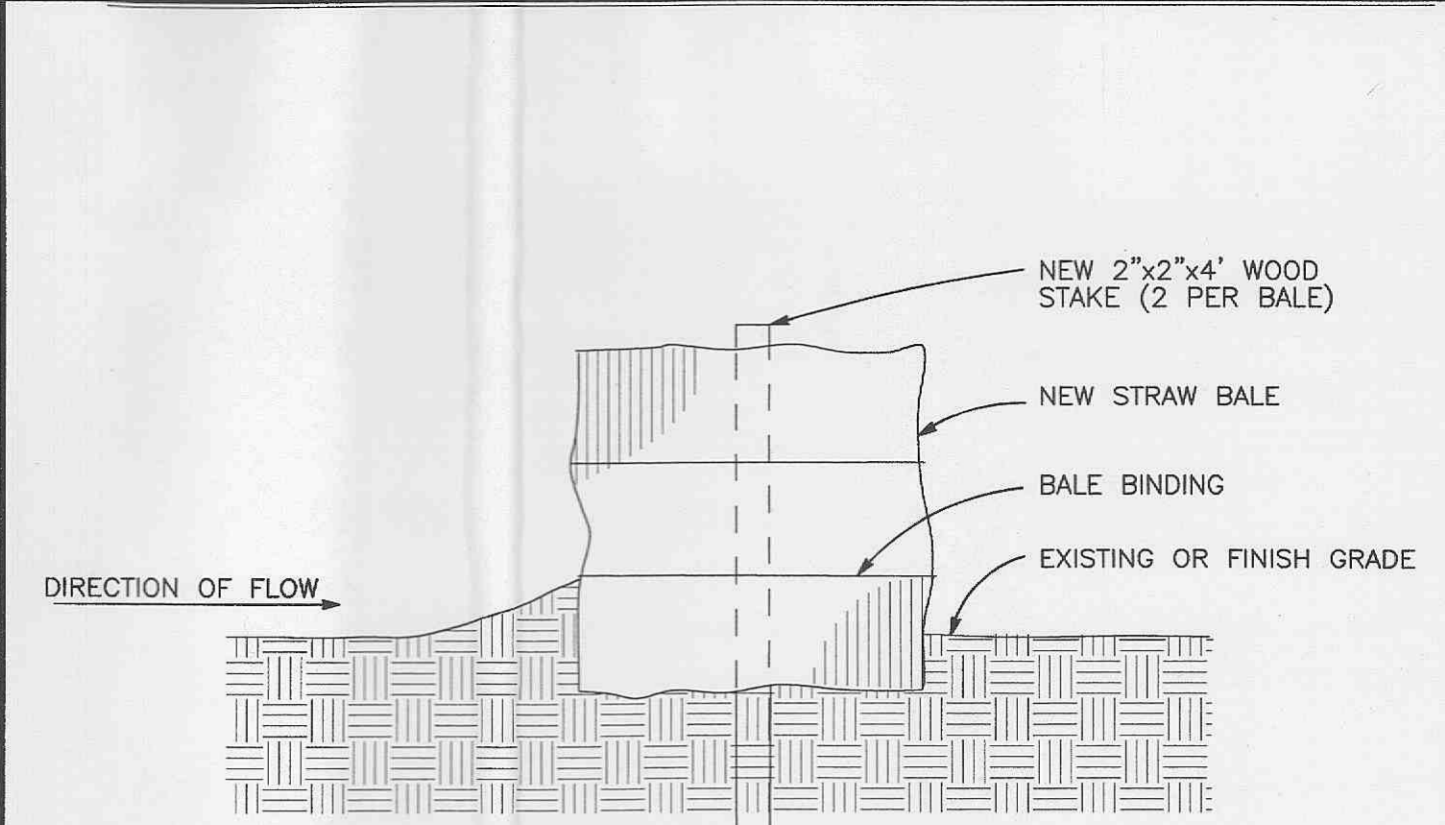

**4 Sediment Barrier Detail**

Scale: Not To Scale

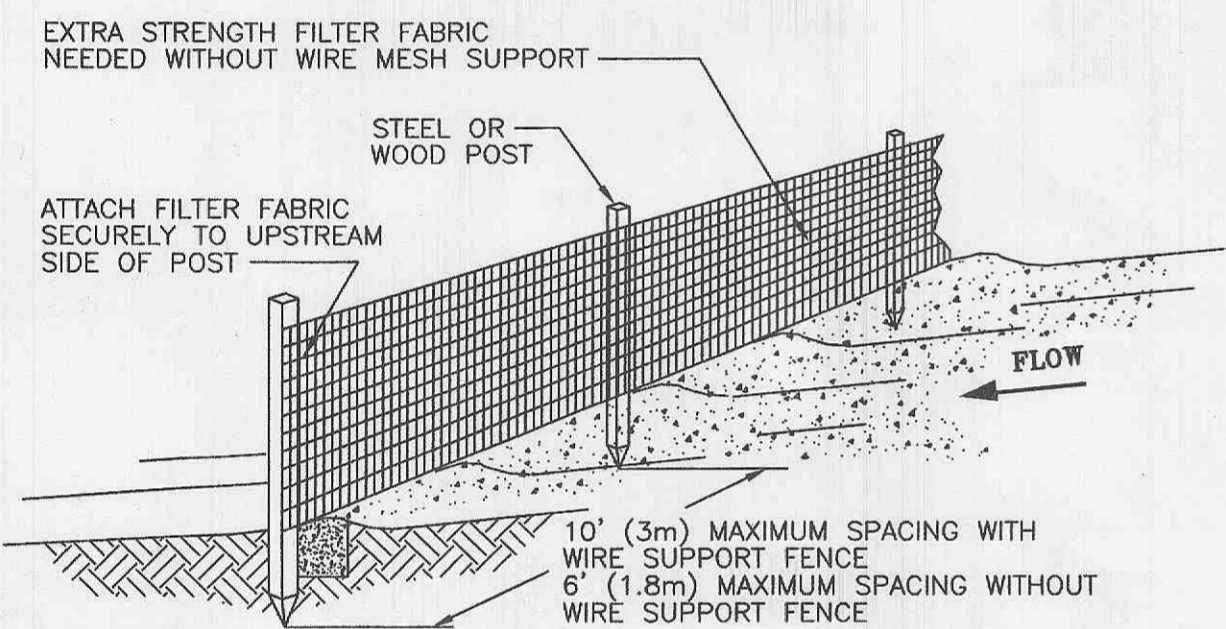

**5 Sediment Barrier Detail**

Scale: Not To Scale

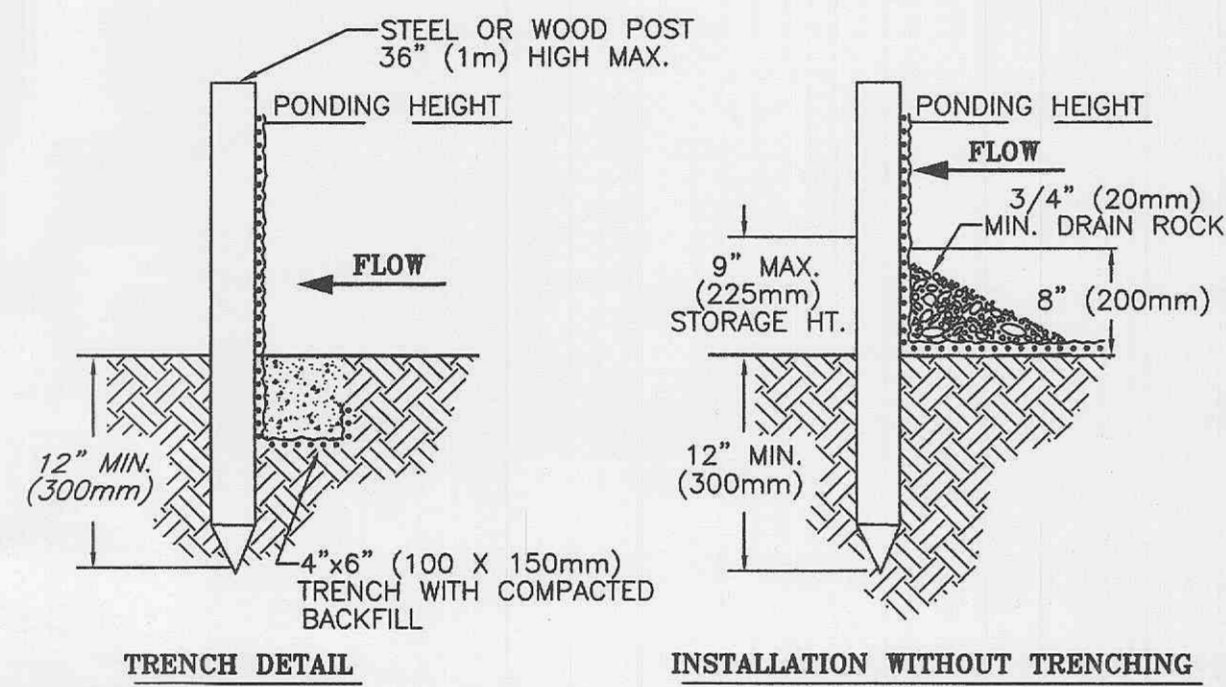

- NOTES:
- SILT FENCE SHALL BE PLACED ON SLOPE CONTOURS TO MAXIMIZE PONDING EFFICIENCY.
  - INSPECT AND REPAIR FENCE AFTER EACH STORM EVENT AND REMOVE SEDIMENT WHEN NECESSARY. 9" (225mm) MAXIMUM RECOMMENDED STORAGE HEIGHT.
  - REMOVED SEDIMENT SHALL BE DEPOSITED TO AN AREA THAT WILL NOT CONTRIBUTE SEDIMENT OFF-SITE AND CAN BE PERMANENTLY STABILIZED.
  - SILT FENCES SHALL BE IN ACCORDANCE WITH ST. CHARLES COUNTY SOIL AND WATER CONSERVATION DISTRICT EROSION AND SEDIMENT CONTROL GUIDELINES.

NOT TO SCALE

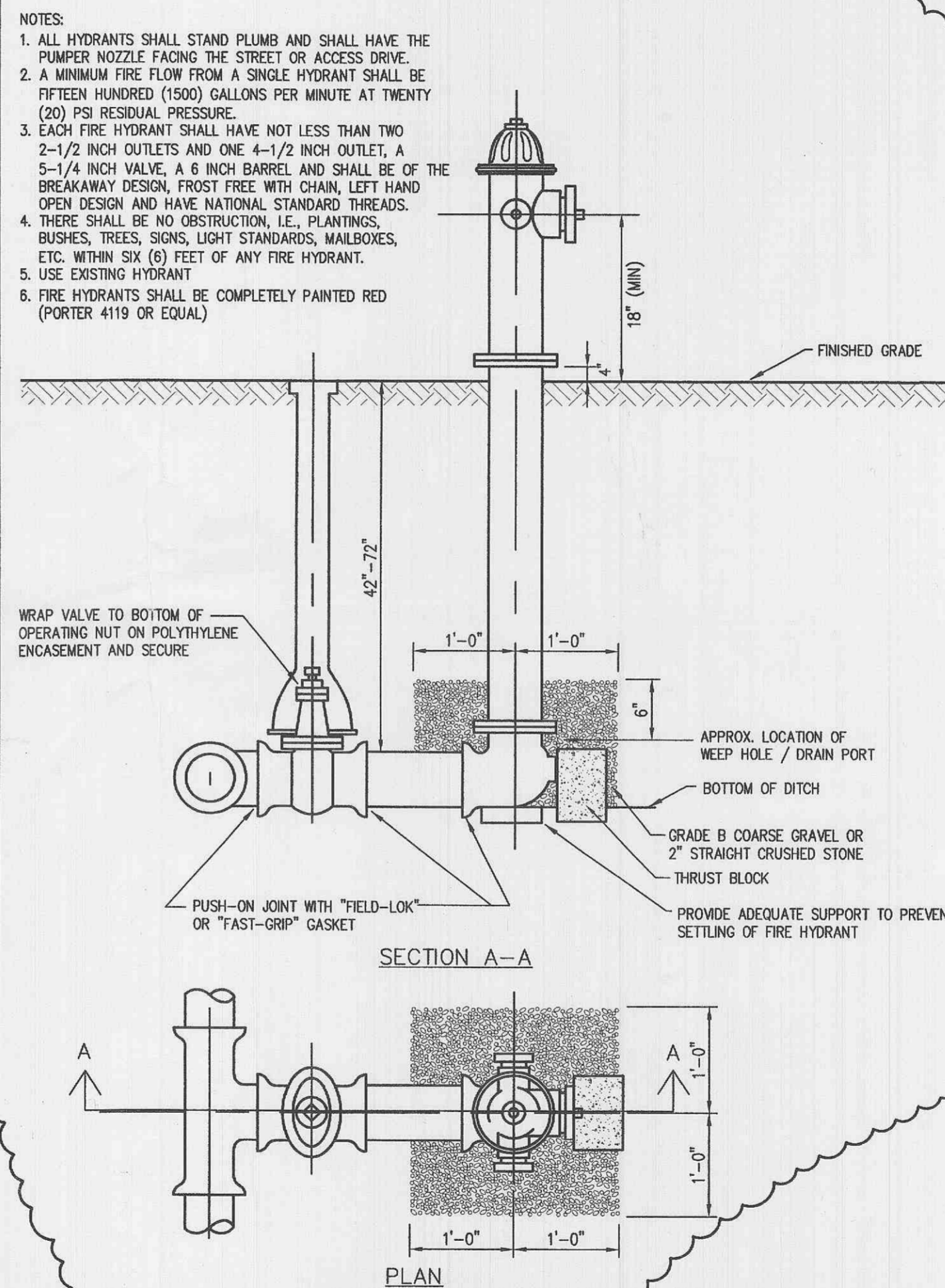

**6 Fire Hydrant Detail (Standard)**

Scale: Not To Scale

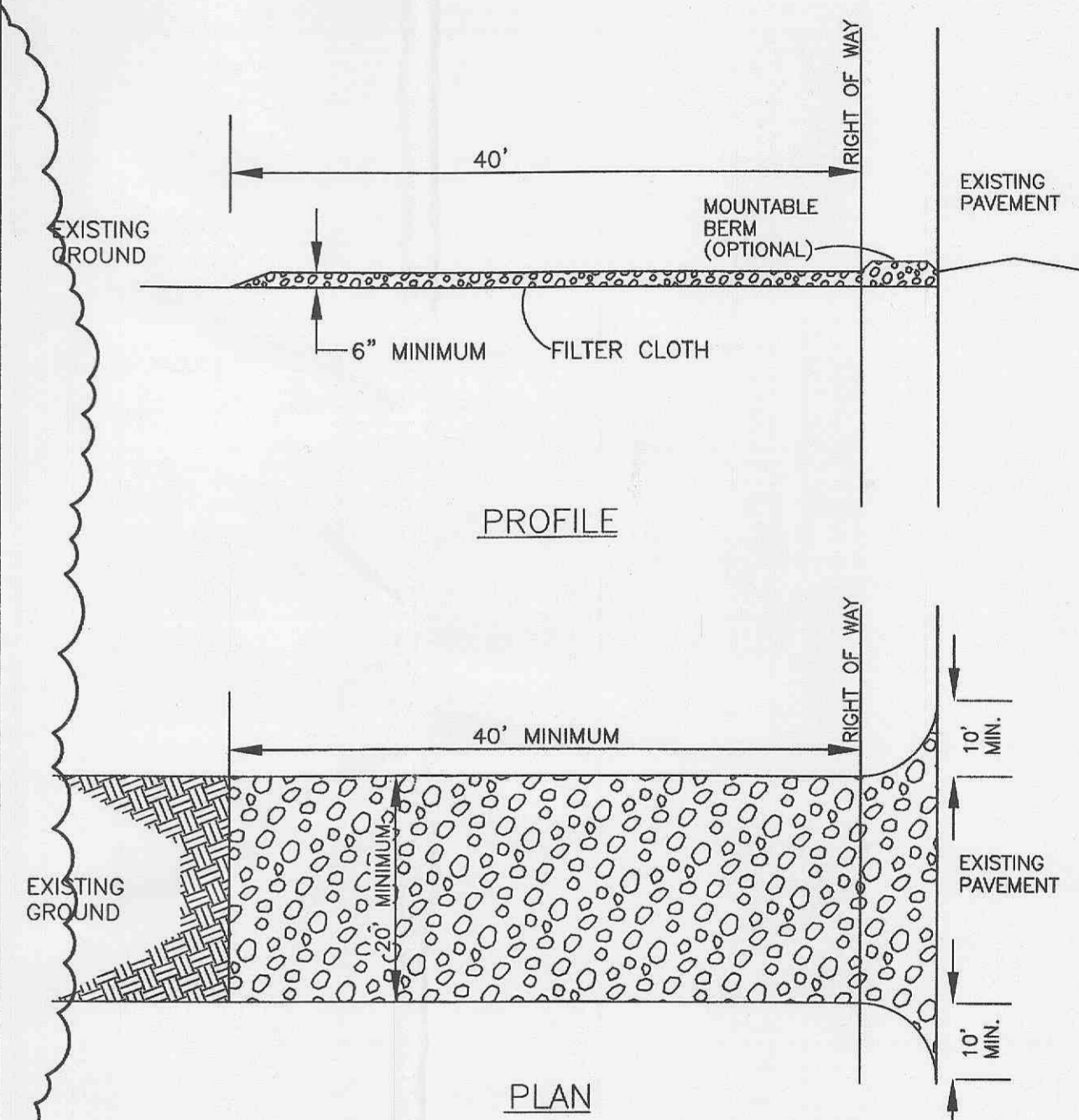

**7 Wash Down Area Detail**

Scale: Not To Scale

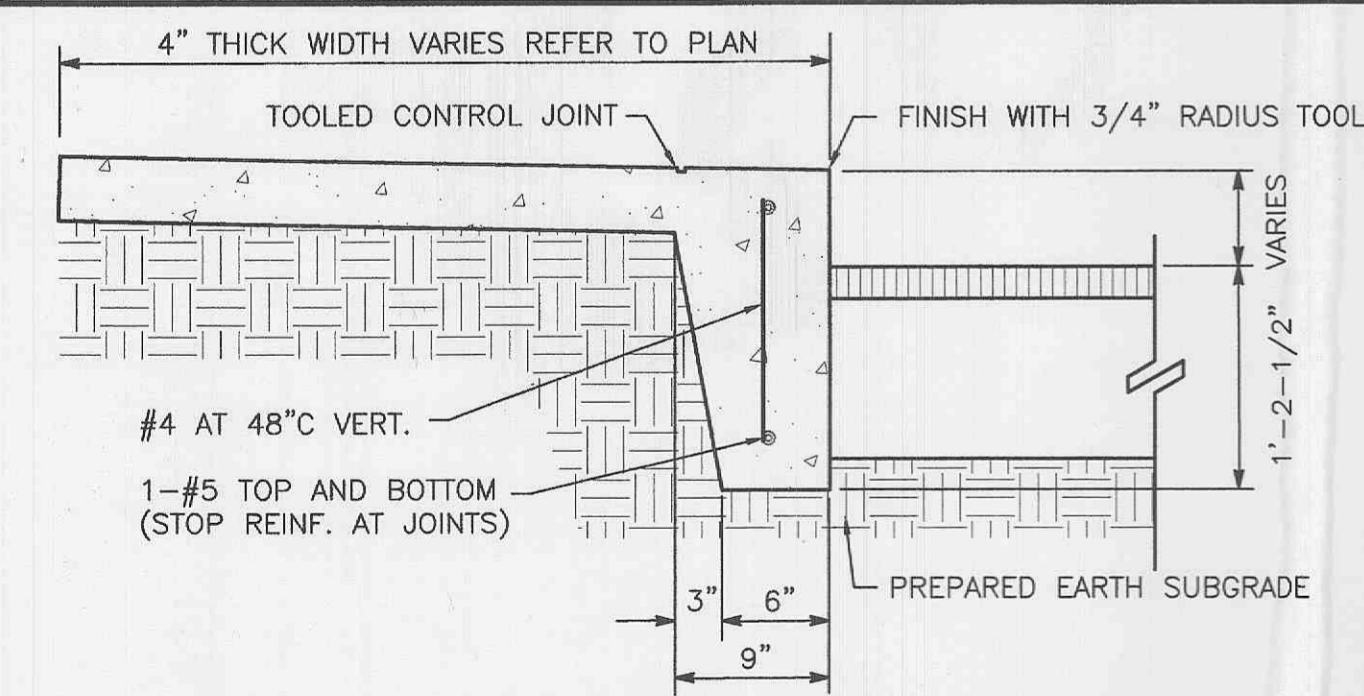

**8 Turned Down Concrete Walk Detail**

Scale: Not To Scale

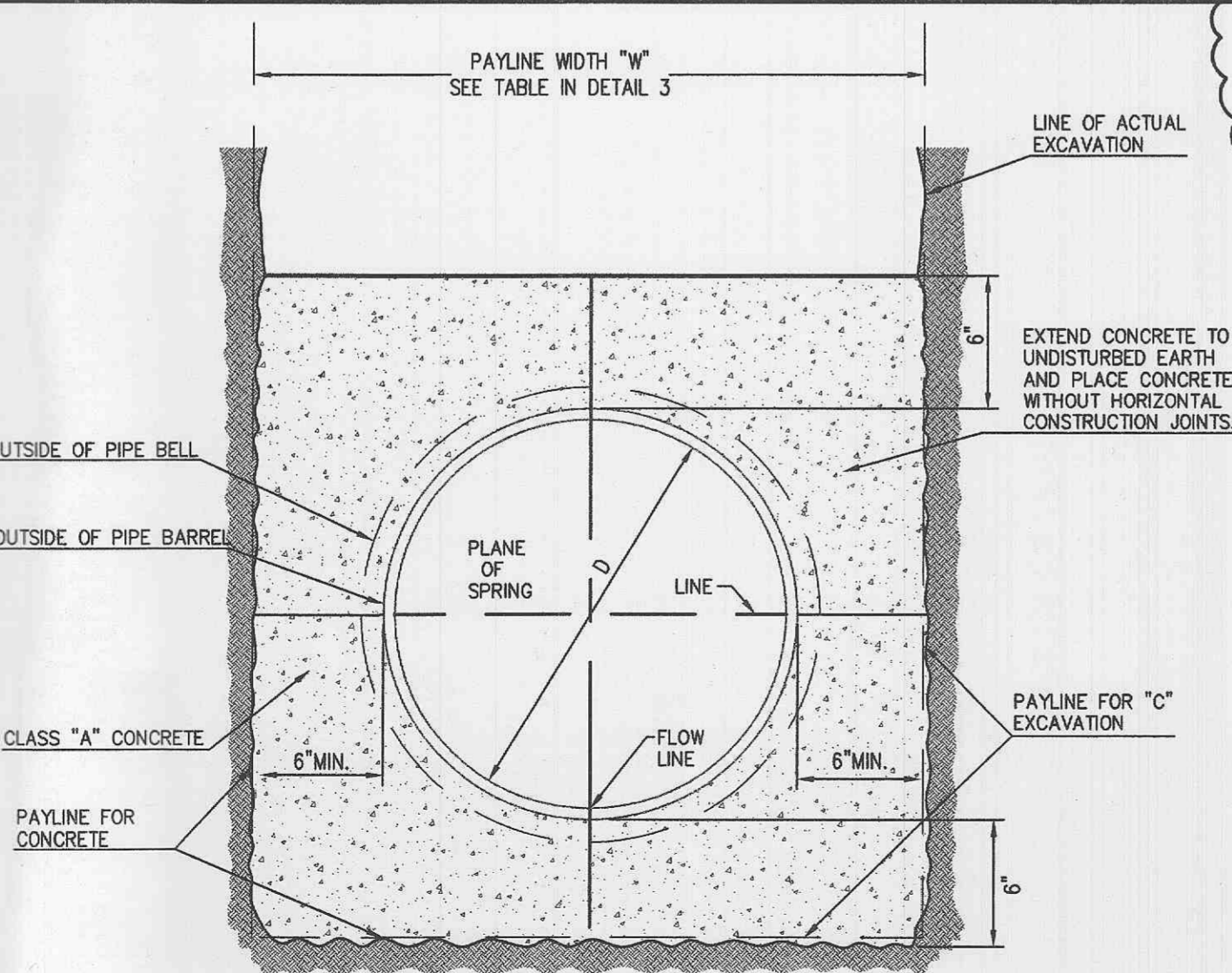

**10 Concrete Encasement Detail**

Scale: Not To Scale

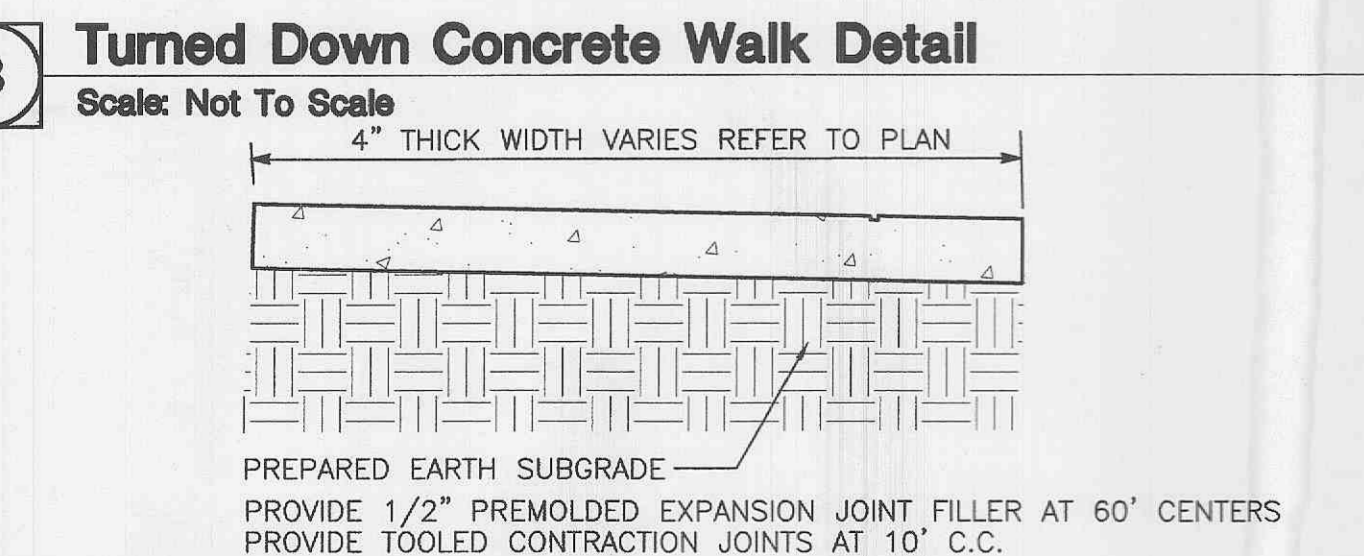

**9 Concrete Walk Detail**

Scale: Not To Scale

- CONSTRUCTION SPECIFICATIONS**
- STONE SIZE - USE 2" STONE, OR RECLAIMED OR RECYCLED CONCRETE EQUIVALENT.
- LENGTH - AS REQUIRED, BUT NOT LESS THAN 50 FEET (EXCEPT ON A SINGLE RESIDENCE LOT WHERE A 30 FOOT MINIMUM LENGTH WOULD APPLY).
- THICKNESS - NOT LESS THAN SIX (6) INCHES.
- WIDTH - TWENTY (20) FOOT MINIMUM, BUT NOT LESS THAN THE FULL WIDTH AT POINTS WHERE INGRESS OR EGRESS OCCURS.
- FILTER CLOTH - WILL BE PLACED OVER THE ENTIRE AREA PRIOR TO THE PLACING OF STONE. FILTER WILL NOT BE REQUIRED ON A SINGLE FAMILY RESIDENCE LOT.
- SURFACE WATER - ALL SURFACE WATER FLOWING OR DIVERTED TOWARD CONSTRUCTION ENTRANCES SHALL BE PIPED ACROSS THE ENTRANCE. IF PIPING IS IMPRACTICAL, A MOUNTABLE BERM WITH 5:1 SLOPES WILL BE PERMITTED.
- MAINTENANCE - THE ENTRANCE SHALL BE MAINTAINED IN A CONDITION WHICH WILL PREVENT TRACKING OR FLOWING OF SEDIMENT ONTO PUBLIC RIGHTS OF WAY. THIS MAY REQUIRE PERIODIC TOP DRESSING WITH ADDITIONAL STONE AS CONDITIONS DEMAND AND REPAIR AND/OR CLEANOUT OF ANY MEASURES USED TO TRAP SEDIMENT. ALL SEDIMENT SPILLED, DROPPED, WASHED, OR TRACKED ONTO PUBLIC RIGHTS OF WAY MUST BE REMOVED IMMEDIATELY.
- WASHING - WHEELS SHALL BE CLEANED TO REMOVE SEDIMENT PRIOR TO ENTRANCE ONTO PUBLIC RIGHTS OF WAY. WHEN WASHING IS REQUIRED, IT SHALL BE DONE ON AN AREA STABILIZED WITH STONE AND WHICH DRAINS INTO A SEDIMENT TRAPPING DEVICE.
- PERIODIC INSPECTION AND NEEDED MAINTENANCE SHALL BE PROVIDED AFTER EACH RAIN.

ENGINEERS  
ARCHITECTS  
SURVEYORS  
SCIENTISTS

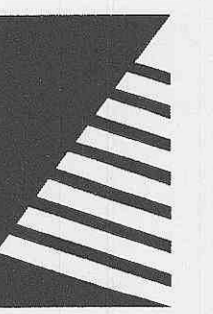

**Farnsworth GROUP**

20 ALLEN AVENUE, SUITE 200  
ST LOUIS, MISSOURI 63119  
(314) 962-7900 / (314) 962-1253 Fax

www.f-w.com

ISSUE:

# Date: Description:  
1 3/28/05 PER CITY OF O'FALLON,  
COTTLEVILLE FIRE PROTECTION,  
DUCKETT CREEK



RUBY TUESDAY RESTAURANT

Lot 2A  
Persimmon Pointe Market  
O'Fallon, Missouri

PROJECT:  
RT ST. LOUIS  
FRANCHISE LLC

**RUBY TUESDAY  
PERSIMMON  
POINTE MARKET**

1140 TECHNOLOGY DRIVE  
O'FALLON, MO

Date: 2-03-05  
Design/Drawn: JPB  
Approved: JTB  
Book No.: -191

SHEET TITLE:  
**SITE  
DETAILS**

SHEET NUMBER:

**C-5**

SHEET 5 OF 11

Project No.: 204390