

OVERALL GRADING PLAN

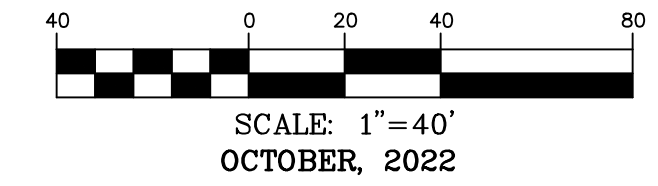
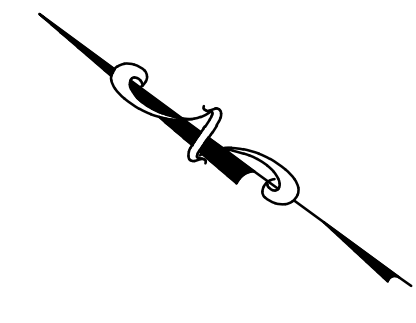

SITE LEGEND

- A 10" DOWNSPOUT COLLECTOR (SEE SHEET C2.2)
- B 12" DOWNSPOUT LATERAL (SEE SHEET C2.2)

LEGEND

EXISTING	PROPOSED
500	INDEX CONTOUR
498	INTERMEDIATE CONTOUR
---	PROPERTY LINE
---	RIGHT-OF-WAY
---	EASEMENT
---	UNDERGROUND ELECTRIC
---	UNDERGROUND TELEPHONE
---	UNDERGROUND FIBER OPTIC
---	SANITARY SEWER
---	SANITARY MANHOLE
---	STORM SEWER
---	INLET
---	GRATED INLET
---	FLARED END SECTIONS
---	GAS LINE (SIZE)
---	WATER LINE (SIZE)
---	FIRE HYDRANTS
---	WATER VALVE
---	WATER METER
---	LIGHT
---	DOWNSPOUT
---	CONCRETE PAVEMENT
---	ASPHALT PAVEMENT

STORM SEWER STRUCTURE

NAME	ELEVATIONS
NEW FLARED END #1	TOP = 584.95 F.L. IN (W) = 582.00
NEW JUNCTION BOX #2	TOP = 590.00 F.L. IN (NW) = 582.31 F.L. OUT = 582.21
NEW CURB INLET #3	TOP = 588.15 F.L. IN (NE) = 583.43 F.L. IN (NW) = 583.43 F.L. OUT = 583.33
NEW AREA INLET #4	TOP = 582.50 F.L. IN (E) = 576.20 F.L. OUT = 575.97
NEW OUTFLOW STRUCTURE #5	TOP = 584.00 F.L. OUT = 577.00
NEW GRATED INLET #6	TOP = 602.50 F.L. OUT = 599.01
NEW CURB INLET #7	TOP = 599.80 F.L. IN (NE) = 592.10 F.L. IN (NW) = 592.10 F.L. OUT = 592.00
NEW CURB INLET #8	TOP = 607.30 F.L. IN (NW) = 602.26 F.L. OUT = 602.16
NEW CURB INLET #9	TOP = 607.30 F.L. IN (NE) = 602.71 F.L. OUT = 602.61
NEW JUNCTION BOX #10	TOP = 609.25 F.L. IN (NW) = 603.30 F.L. OUT = 603.20
NEW CURB INLET #11	TOP = 609.30 F.L. IN (N) = 604.39 F.L. IN (W) = 604.89 F.L. IN (NW) = 604.39 F.L. OUT = 604.29
NEW GRATED INLET #12	TOP = 608.50 F.L. OUT = 605.00
NEW DOUBLE CURB INLET #13	TOP = 588.15 F.L. IN (NE) = 583.98 F.L. OUT = 583.88
NEW AREA INLET #14	TOP = 590.00 F.L. OUT = 584.26
NEW CURB INLET #15	TOP = 599.80 F.L. IN (NW) = 592.55 F.L. OUT = 592.45
NEW GRATED CURB INLET #16	TOP = 602.90 F.L. IN (NW) = 595.21 F.L. OUT = 595.11
NEW GRATED CURB INLET #17	TOP = 603.00 F.L. IN (NW) = 596.77 F.L. OUT = 596.67
NEW GRATED CURB INLET #18	TOP = 602.90 F.L. IN (N) = 597.57 F.L. OUT = 597.47
NEW JUNCTION BOX #19	TOP = 604.750 F.L. IN (N) = 598.71 F.L. OUT = 598.61
NEW CURB INLET #20	TOP = 603.90 F.L. IN (NE) = 598.99 F.L. OUT = 598.89
NEW CURB INLET #21	TOP = 605.80 F.L. IN (NE) = 599.61 F.L. OUT = 599.52
NEW GRATED CURB INLET #22	TOP = 607.80 F.L. IN (NE) = 600.80 F.L. OUT = 600.70
NEW GRATED CURB INLET #23	TOP = 606.75 F.L. IN (E) = 602.62 F.L. OUT = 602.52
NEW CURB INLET #24	TOP = 607.35 F.L. IN (S) = 604.35 F.L. OUT = 603.35

PIPE TABLE

PIPE NAME	SIZE	LENGTH	SLOPE
1-2	36" 41'	0.50%	
2-3	30" 205'	0.50%	
4-5	48" 64'	1.24%	
EX-6	12" 14'	3.12%	
3-7	24" 222'	3.87%	
7-8	15" 377'	2.67%	
8-9	15" 35'	1.00%	
9-10	15" 49'	1.00%	
10-11	12" 97'	1.02%	
11-12	12" 61'	1.00%	
11 - TWD	12" 32'	7.92%	
3-13	24" 45'	1.00%	
13-14	24" 28'	1.00%	
7-15	18" 35'	1.00%	
15-16	18" 155'	1.65%	
16-17	18" 145'	1.00%	
17-18	15" 70'	1.00%	
18-19	15" 104'	1.00%	
19-20	12" 18'	1.00%	
20-21	12" 53'	1.00%	
21-22	12" 108'	1.00%	
22-23	12" 172'	1.00%	
23-24	12" 73'	1.00%	

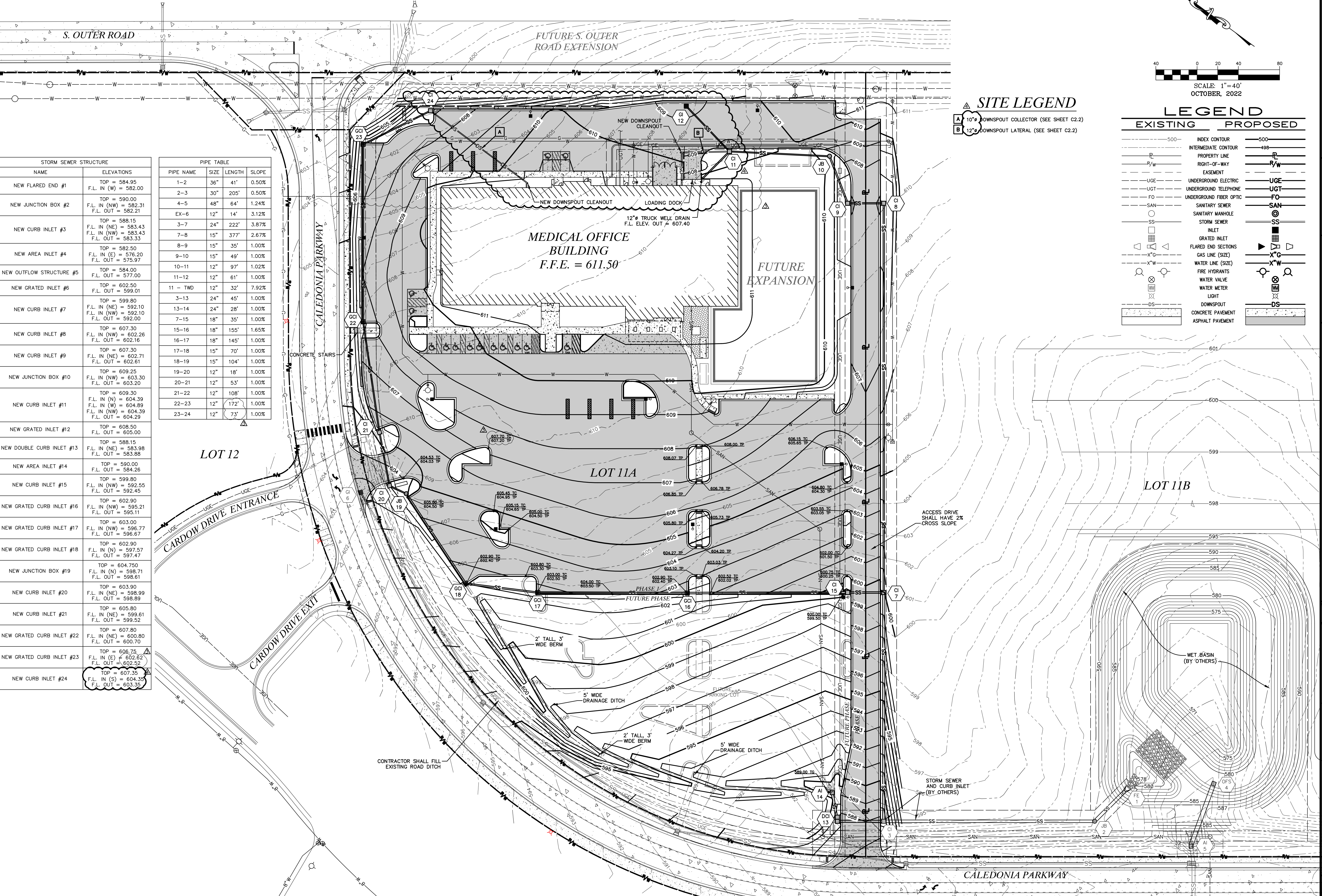

COCHRAN
 Civil Engineering
 Land Surveying
 Architecture
 Site Development
 General Consulting
 Master Planning

530A E. Independence Dr.
 Union, Missouri 63084
 636-594-0540 (tel.)
 636-594-0512 (fax)
 mail@cochrancorp.com

Missouri State Certificate of Authority Numbers:
 Survey: 000380
 Engineering: 001655
 Architecture: 2002014240

Three working days prior to the start of any excavation call 1-800-UGC-RITE for utility location information.
 All OSHA rules & regulations and state regulations apply to these plans and be strictly followed (i.e. trenching, blasting, etc.).

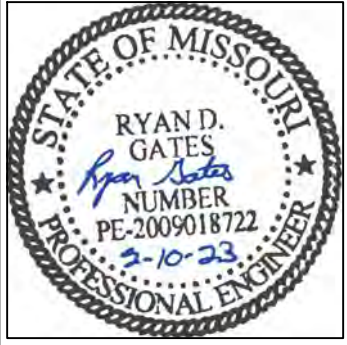

SITE IMPROVEMENTS
SSM HEALTH
O'FALLON, MISSOURI

GRADING PLAN

DATE	BY	APP'D BY	REV	DESCRIPTION
12-14-22	JMM	JMM	1	ISSUE FOR PERMIT
02-10-23	JMM	JMM	2	REVISED FOR COMMENTS
02-10-23	JMM	JMM	3	REVISED FOR COMMENTS
02-10-23	JMM	JMM	4	REVISED FOR COMMENTS

DATE: 12-14-22
 SCALE: 1"=40'
 PROJ NO: 22-9120
 SHEET NO: C2.1

DWG NAME: F:\22-9120 - Professional Design Services for the SSM Medical Building in O'Fallon, MO\AutoCad Drawings\9120 - Plan Sheets\07 - GRADING PLAN.dwg LAYOUT TAB: GRADING OVERALL PLOTTED ON: Feb 15, 2023 - 3:16pm PLOTTED BY: rgates