

# STORM SEWER DRAINAGE MAP

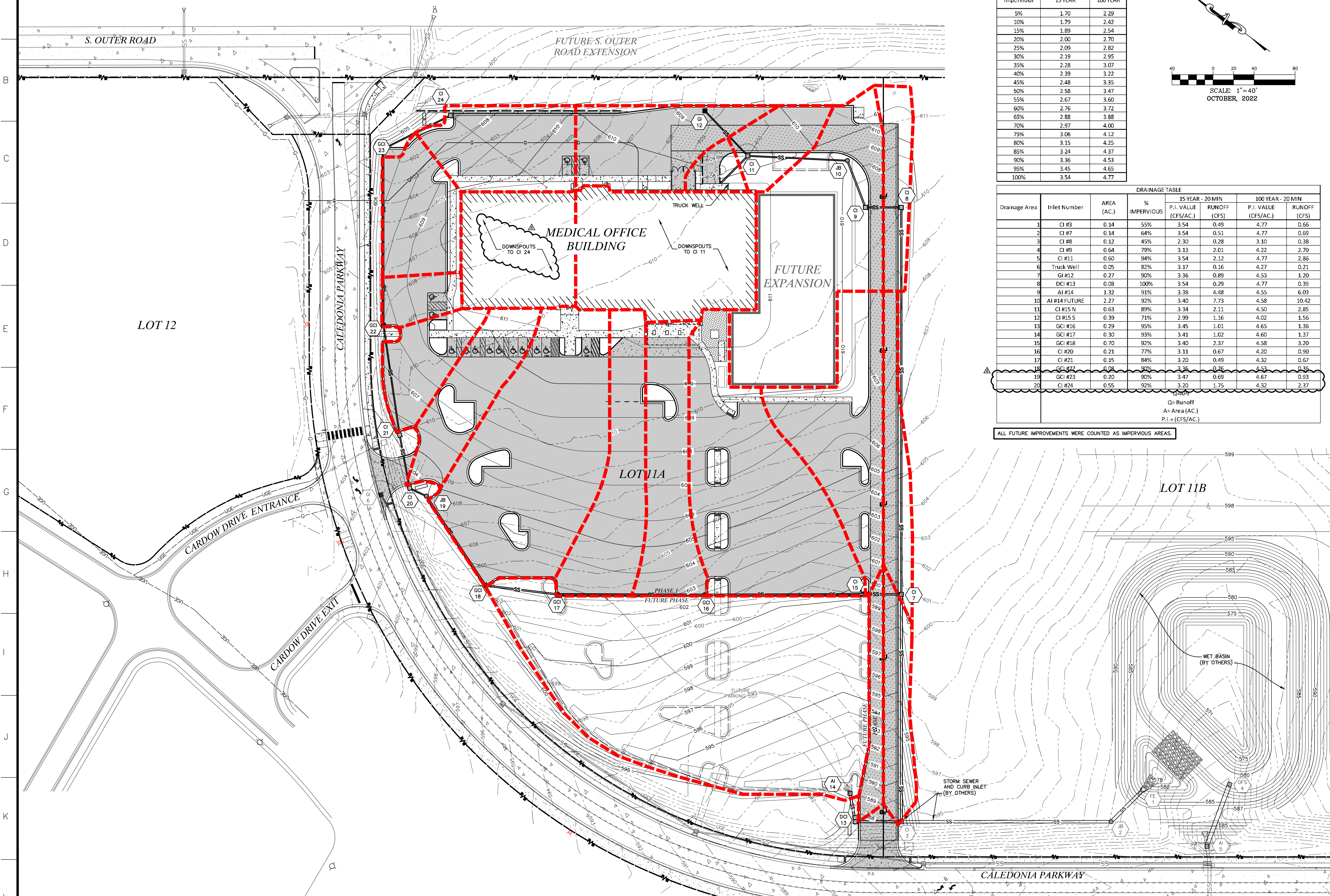

Percent Impervious	20 MIN DURATION	
	15 YEAR	100 YEAR
5%	1.70	2.29
10%	1.79	2.42
15%	1.89	2.54
20%	2.00	2.70
25%	2.09	2.82
30%	2.19	2.95
35%	2.28	3.07
40%	2.39	3.22
45%	2.48	3.35
50%	2.58	3.47
55%	2.67	3.60
60%	2.76	3.72
65%	2.88	3.88
70%	2.97	4.00
75%	3.06	4.12
80%	3.15	4.25
85%	3.24	4.37
90%	3.36	4.53
95%	3.45	4.65
100%	3.54	4.77

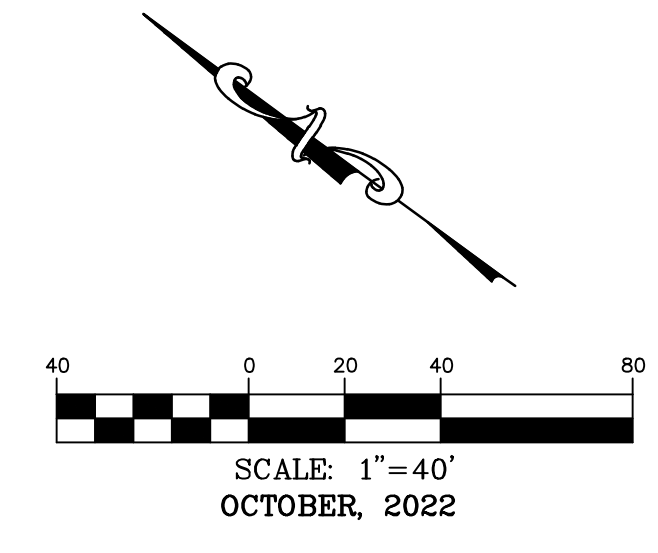

Drainage Area	Inlet Number	AREA (AC.)	% IMPERVIOUS	15 YEAR - 20 MIN		100 YEAR - 20 MIN	
				P.I. VALUE (CFS/AC.)	RUNOFF (CFS)	P.I. VALUE (CFS/AC.)	RUNOFF (CFS)
1	CI #3	0.14	55%	3.54	0.49	4.77	0.66
2	CI #7	0.14	64%	3.54	0.51	4.77	0.69
3	CI #8	0.12	45%	2.30	0.28	3.10	0.38
4	CI #9	0.64	79%	3.13	2.01	4.22	2.70
5	CI #11	0.60	94%	3.54	2.12	4.77	2.86
6	Truck Well	0.05	82%	3.17	0.16	4.27	0.21
7	GI #12	0.27	90%	3.36	0.89	4.53	1.20
8	DCI #13	0.08	100%	3.54	0.29	4.77	0.39
9	AI #14	1.32	91%	3.38	4.48	4.55	6.03
10	AI #14 FUTURE	2.27	92%	3.40	7.73	4.58	10.42
11	CI #15 N	0.63	89%	3.34	2.11	4.50	2.85
12	CI #15 S	0.39	71%	2.99	1.16	4.02	1.56
13	GCI #16	0.29	95%	3.45	1.01	4.65	1.36
14	GCI #17	0.30	93%	3.41	1.02	4.60	1.37
15	GCI #18	0.70	92%	3.40	2.37	4.58	3.20
16	CI #20	0.21	77%	3.11	0.67	4.20	0.90
17	CI #21	0.15	84%	3.20	0.49	4.32	0.67
18	GCI #22	0.08	90%	3.36	0.26	4.53	0.36
19	GCI #23	0.20	90%	3.47	0.69	4.67	0.93
20	CI #24	0.55	92%	3.20	1.75	4.32	2.37

Q=Runoff  
A=Area (AC.)  
P.I.= (CFS/AC.)

ALL FUTURE IMPROVEMENTS WERE COUNTED AS IMPERVIOUS AREAS.

636-584-0540 (tel.)  
636-584-0512 (fax)  
mailto:ochran@ochran.com

**COCHRAN**  
Civil Engineering  
Land Surveying  
Architecture  
Site Development  
General Consulting  
Master Planning

530A E. Independence Dr.  
Union, Missouri 63084

Missouri State Certificate of Authority Numbers:  
Survey: 000380  
Engineering: 001655  
Architecture: 2002014240

Three working days prior to the start of any excavation call 1-800-UGC-RTIC for utility location information.

All OSHA rules & regulations and state & local construction requirements for these plans shall be strictly followed (ie. trenching, blasting, etc.)

**SITE IMPROVEMENTS**  
**SSM HEALTH**  
**O'FALLON, MISSOURI**

**STORM SEWER DRAINAGE MAP**

DATE: 10-21-23  
DATE: 10-21-23  
SCALE: 1"=40'  
PROJ. NO: 22-9120  
DWG. NO: C8

DATE	BY	APP'D. BY
TML		
TML		

DWG NAME: F: 22-9120 - Professional Design Services for the SSM Medical Building in O'Fallon, MO AutoCAD Drawings 9/120 - Plan Sheets 13 - STORM DRAINAGE MAP.dwg LAYOUT TAB: STORM DRAINAGE MAP.dwg PLOTTED ON: Feb 10, 2023 - 8:56am PLOTTED BY: rgates