

MATCHLINE - SEE L1.1

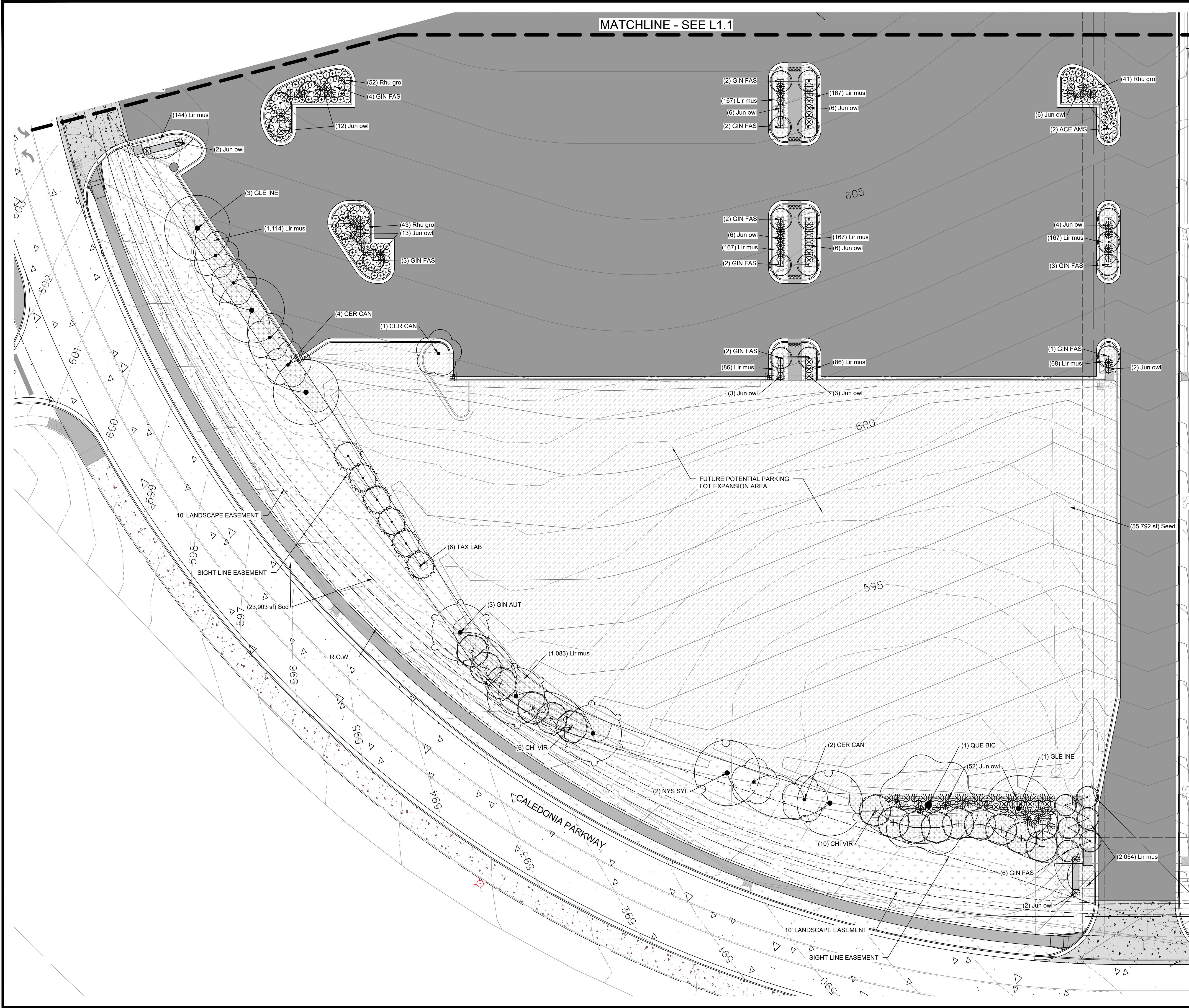

**LANDSCAPE NOTES**

1. REFER TO DEMOLITION PLAN FOR REMOVAL OF EXISTING VEGETATION.
2. UNLESS OTHERWISE NOTED, ALL NATURAL VEGETATION SHALL BE MAINTAINED WHERE IT DOES NOT INTERFERE WITH CONSTRUCTION. PROTECT EXISTING UTILITIES, STRUCTURES OR VEGETATION FROM DAMAGE. CONTRACTOR SHALL MAINTAIN AND SECURE THE PROJECT SITE TO PROTECT THE PUBLIC FROM INJURY DUE TO WORK AND RELATED MATERIAL.
3. UNDERGROUND FACILITIES, STRUCTURES AND UTILITIES MUST BE CONSIDERED APPROXIMATE ONLY. THERE MAY BE OTHERS NOT PRESENTLY KNOWN OR SHOWN. LANDSCAPE CONTRACTOR SHALL BE RESPONSIBLE TO DETERMINE AND VERIFY THE EXISTENCE OF AND EXACT LOCATION OF ALL UTILITIES.
4. LANDSCAPE CONTRACTOR IS ADVISED TO STUDY THE PLANS AND VISIT THE SITE TO BECOME FAMILIAR WITH THE EXISTING CONDITIONS. REPORT ANY DISCREPANCIES IMMEDIATELY TO THE OWNER'S REPRESENTATIVE.
5. LANDSCAPE CONTRACTOR SHALL STAKE THE LOCATIONS OF ALL PROPOSED PLANT MATERIAL AND PLANTING BED EDGES FOR APPROVAL BY THE OWNER'S REPRESENTATIVE PRIOR TO INSTALLATION.
6. ALL PLANT MATERIAL SHALL BE WARRANTED FOR A PERIOD OF 12 MONTHS AFTER ACCEPTANCE BY OWNER.
7. CONTRACTOR SHALL STAKE AND BRACE TREES IMMEDIATELY FOLLOWING INSTALLATION ACCORDING TO PLANS, DETAILS, AND SPECIFICATIONS.
8. ALL PLANTING BED EDGES SHALL BE SPADE CUT UNLESS OTHERWISE INDICATED.
9. CONTRACTOR TO SEED ALL AREAS DISTURBED DUE TO CONSTRUCTION ACTIVITIES.
10. ALL PLANT MATERIAL SHALL BE TAGGED OR OTHERWISE APPROVED BY THE OWNER'S REPRESENTATIVE. APPROVAL IN THE NURSERY DOES NOT INDICATE FINAL ACCEPTANCE.
11. ITEMS SHOWN ON THESE DRAWINGS TAKE PRECEDENCE OVER THE MATERIAL LIST. LANDSCAPE CONTRACTOR SHALL VERIFY ALL QUANTITIES AND CONDITIONS PRIOR TO BIDDING AND IMPLEMENTATION OF THE PLAN. NO SUBSTITUTIONS OF TYPES OR SIZE OF PLANT MATERIAL WILL BE ACCEPTED WITHOUT WRITTEN APPROVAL BY OWNER'S REPRESENTATIVE.
12. ALL PLANT MATERIAL SHALL CONFORM TO UPPER RANGE LIMITS FOR CALIPER, HEIGHT AND ROOT BALL DIMENSIONS LISTED IN ANSI Z60.1-2014.
13. TOPSOIL SHALL BE SPREAD TO A DEPTH OF 4" TO ALL AREAS INDICATED TO RECEIVE SEEDING AND ANY AREA DISTURBED BY CONSTRUCTION THAT WILL RECEIVE RESTORATION SEEDING.
14. CONTRACTOR TO VERIFY AND CONFIRM THE LOCATION OF ALL PROPERTY LINES AND UTILITY EASEMENTS PRIOR TO COMPLETING ANY WORK NEAR ADJACENT PROPERTIES OR IN ANY EASEMENT AREA.

**LANDSCAPE LEGEND**

(REFER TO SHEET L-103 FOR FULL SCHEDULE)

COLUMNAR TREES	COMMON NAME
ACE AMS	Armstrong Freeman Maple
GIN FAS	Fastigate Maidenhair Tree
TAX LAB	Prairie Sentinel Pond Cypress
FLOWERING TREES	COMMON NAME
AME SER	Serviceberry
CER CAN	Eastern Redbud
CHI VIR	White Fringetree
OVERSTORY TREES	COMMON NAME
GIN AUT	Autumn Gold Maidenhair Tree
GLE INE	Skylight® Honey Locust
NYS SYL	Blackgum
QUE BIC	Swamp White Oak
SHRUBS	COMMON NAME
Bud pmc	Pink Micro Chip Butterfly Bush
Bux ese	Wedding Ring® Boxwood
lle jim	Jim Dandy Winterberry
lle red	Red Sprite Winterberry
Jun owl	Grey Owl Eastern Redcedar
Rhu gro	Gro-Low Fragrant Sumac
GRASSES	COMMON NAME
Bou gra	Blue Grama Grass
Pen krs	Karley Rose Fountain Grass

GROUND COVERS	CODE	COMMON NAME
	Lir mus	Lilyturf
SOD/SEED	CODE	COMMON NAME
	Seed	Drought Tolerant Fescue Blend
	Sod	Turf-type Tall Fescue

2816 Sutton Boulevard, Suite 1  
 Saint Louis, Missouri 63143  
 Phone 314.241.3600  
 www.planningdesignstudio.com

**KEY MAP**

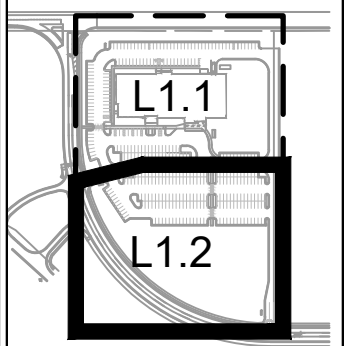

Three working days prior to the start of any excavation call 1-800-HIG-BRITE for utility location information.  
 All OSHA rules & regulations and state regulations required by these plans and be strictly followed (i.e. trenching, blasting, etc.).



Name: Scott Emmekamp  
 Date: 12/21/2022  
 License No.: LA-120  
 Company License No.: LAC-2006001845

**MEDICAL OFFICE BUILDING**  
**CALEDONIA PARKWAY**  
**OF FALLON, MISSOURI**

**LANDSCAPE PLAN**

DATE:	DATE:	DATE:	DATE:
DRAWN BY:	DESIGNED BY:	CHECKED BY:	APPROVED BY:
JDC	JDC	SVE	SVE
DATE:	DATE:	DATE:	DATE:
DEC 21, 2022	DEC 21, 2022	DEC 21, 2022	DEC 21, 2022
SCALE:	SCALE:	SCALE:	SCALE:
1" = 20'	1" = 20'	1" = 20'	1" = 20'
PROJECT NO.:	PROJECT NO.:	PROJECT NO.:	PROJECT NO.:
J2224	J2224	J2224	J2224
DWG. NO.:	DWG. NO.:	DWG. NO.:	DWG. NO.:
L1.2	L1.2	L1.2	L1.2