

NEWHALL HEATH COURT WARPING DETAIL  
SCALE: 1"=20'

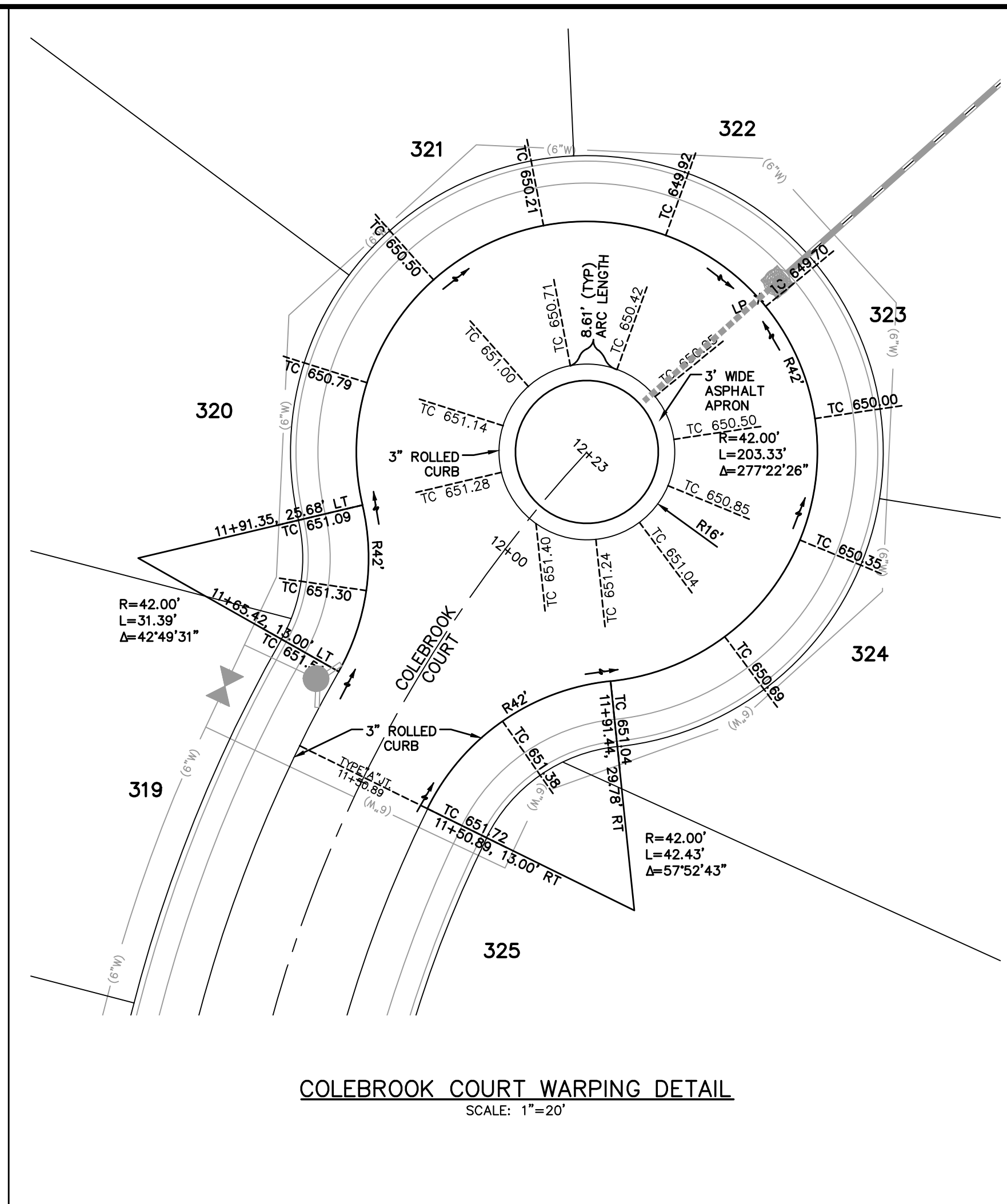

COLEBROOK COURT WARPING DETAIL  
SCALE: 1"=20'

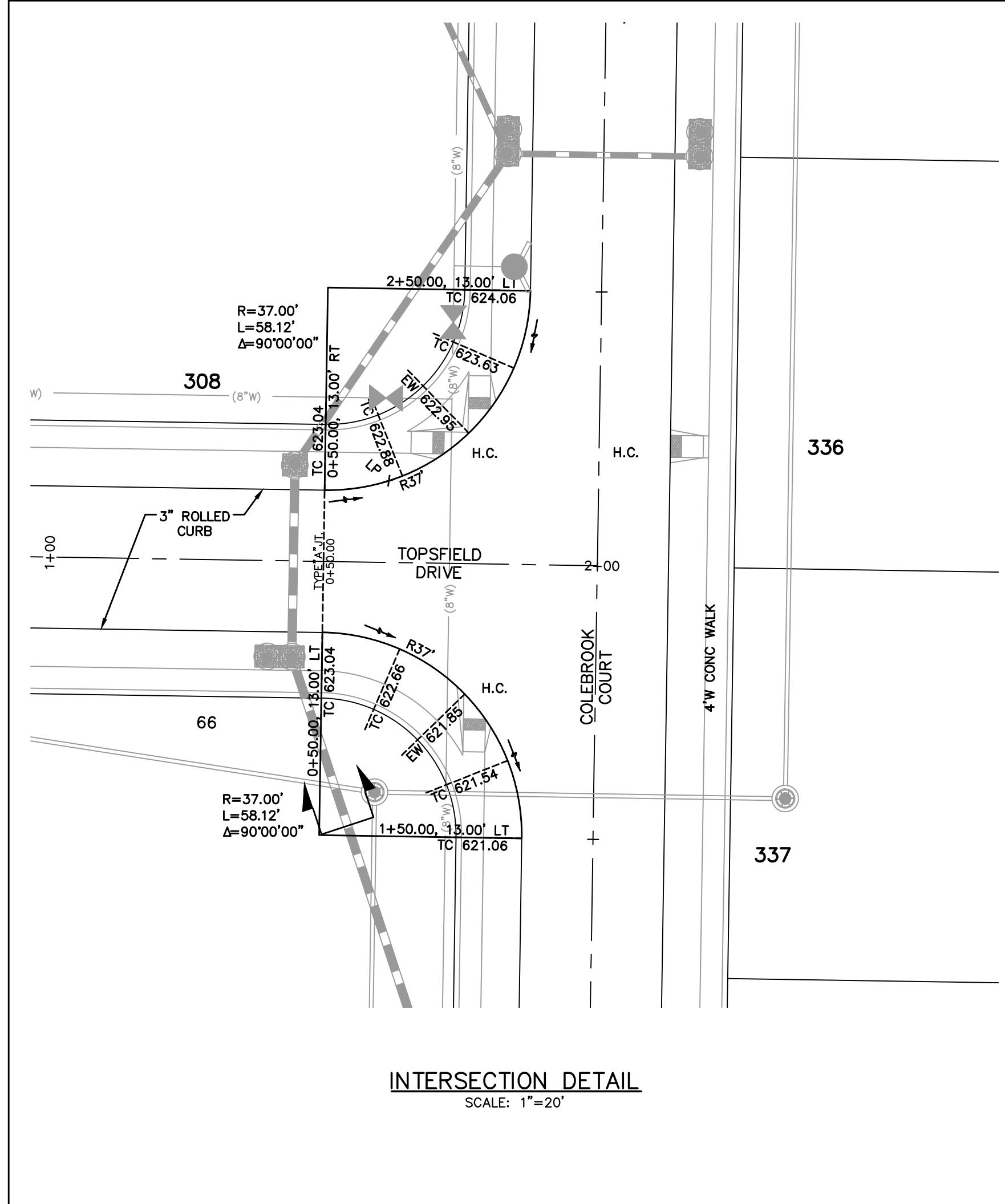

INTERSECTION DETAIL  
SCALE: 1"=20'

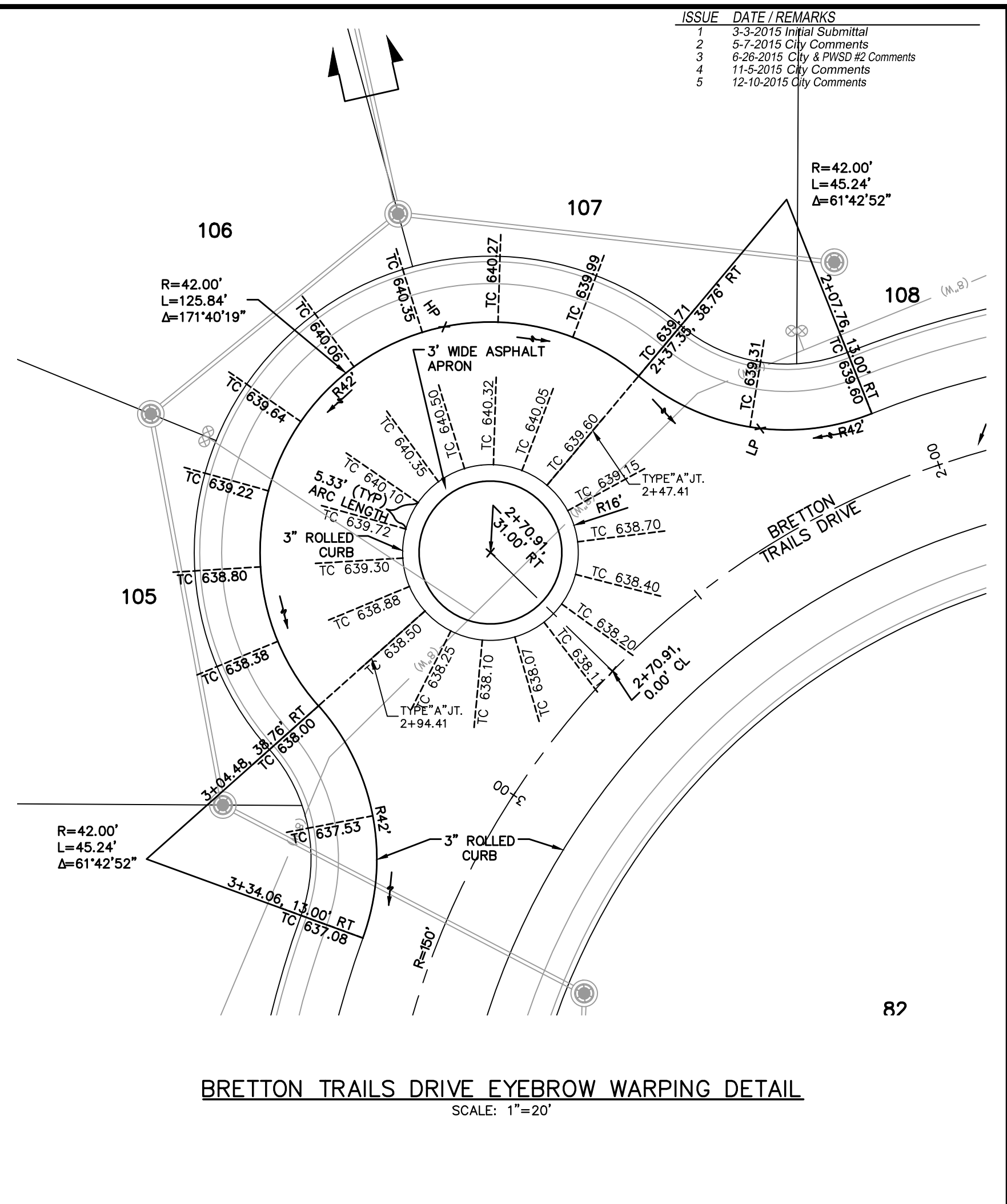

BRETTON TRAILS DRIVE EYEBROW WARPING DETAIL  
SCALE: 1"=20'

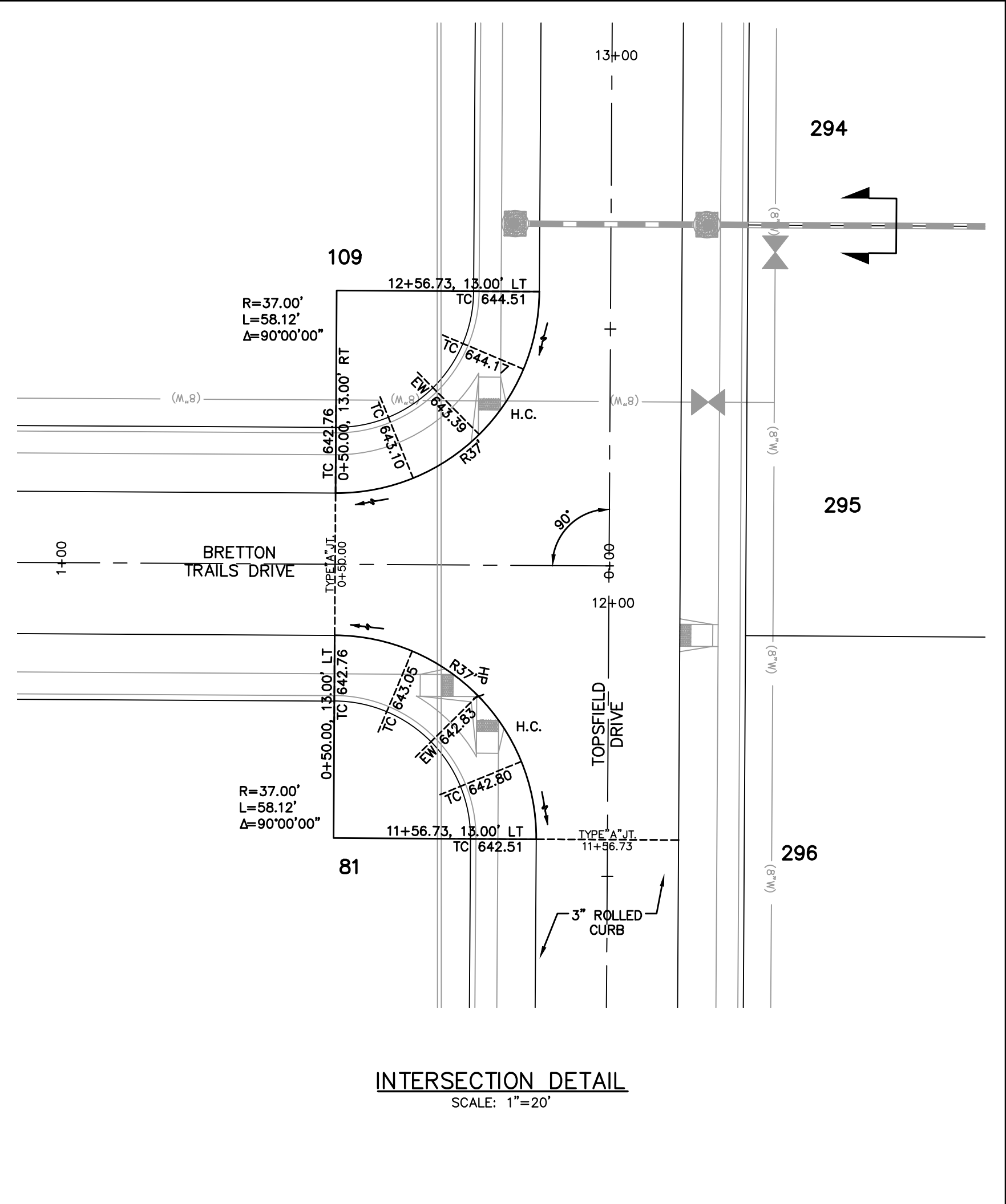

INTERSECTION DETAIL  
SCALE: 1"=20'

ISSUE	DATE / REMARKS
1	3-3-2015 Initial Submittal
2	5-7-2015 City Comments
3	6-26-2015 City & PWSD #2 Comments
4	11-9-2015 City Comments
5	12-10-2015 City Comments

PROJECT TITLE

*The Villages at*  
**Shady Creek**  
OFFALON, MISSOURI

**THE STERLING CO.**  
ENGINEERS & SURVEYORS  
5055 New Baumgartner Road  
St. Louis, Missouri 63129  
Ph 314-487-0440 Fax 314-487-8944  
www.sterling-eng-sur.com  
Corporate Certificate of Authority #001348



Date: 12/10/2015  
RODNEY ARNOLD  
LICENSE # PE-2002016612  
Civil Engineer

*Lombardo Homes of St. Louis, LLC*  
2299 Technology Drive, Suite 150  
Offalton, Missouri 63366  
Ph. (636) 265-2710  
Fax (636) 695-3195  
www.lombardohomesstlouis.com

ENTRANCE / WARPING DETAILS

P+Z No. P&Z NO  
City No. 15-162-SP  
Date: 12/10/2015  
Job No. 14-03-087

Page No.

**12.4**

IMP

Drawing name: V:\140387\G06\F77\Drawings\Improvements\307\WP.dwg Plotter on: Dec 15, 2015 - 10:56am Plotted by: amolitor