

ISSUE	DATE / REMARKS
1	3-3-2015 Initial Submittal
2	5-7-2015 City Comments
3	6-26-2015 City & PWSO #2 Comments
4	11-9-2015 City Comments
5	12-10-2015 City Comments

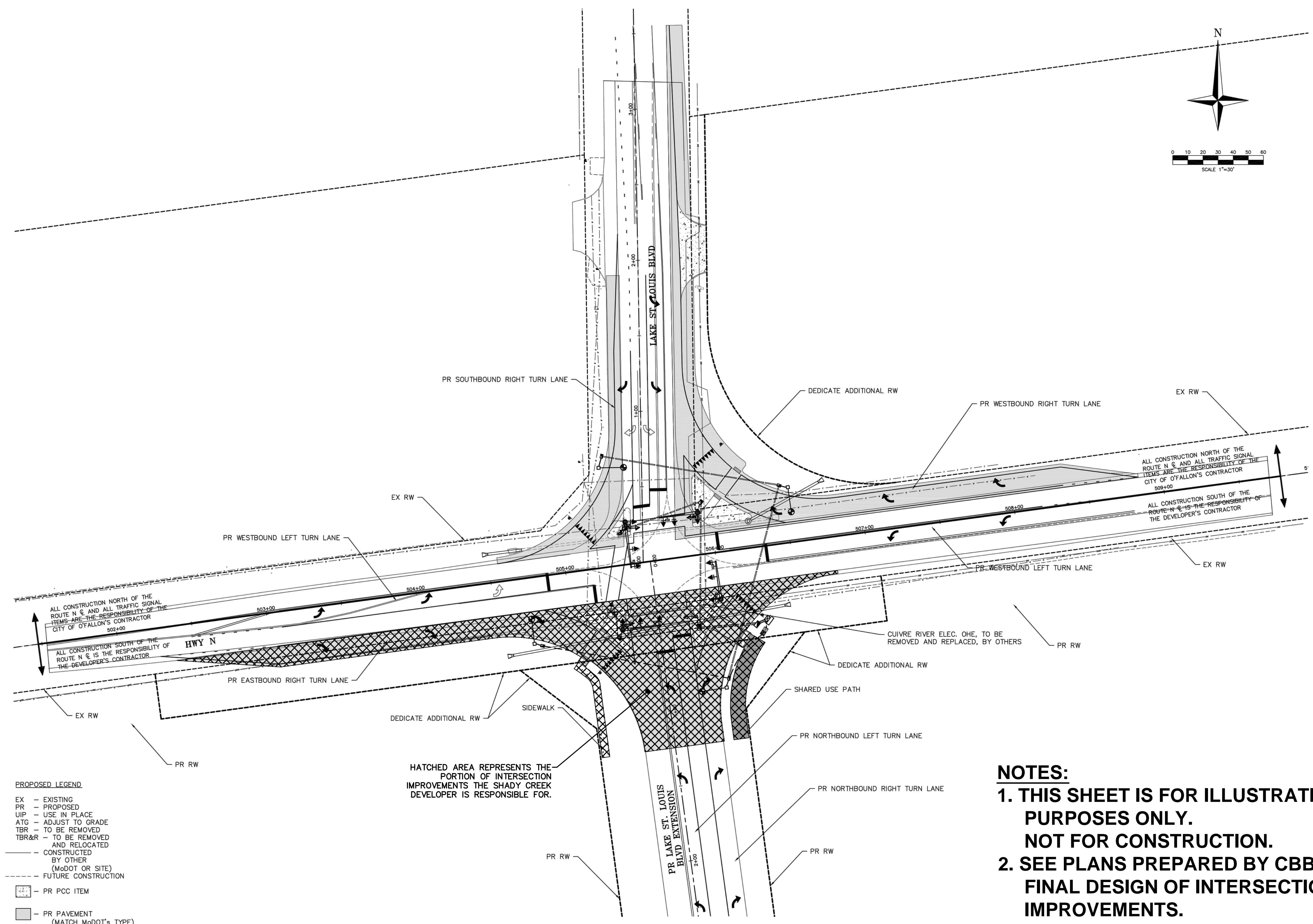
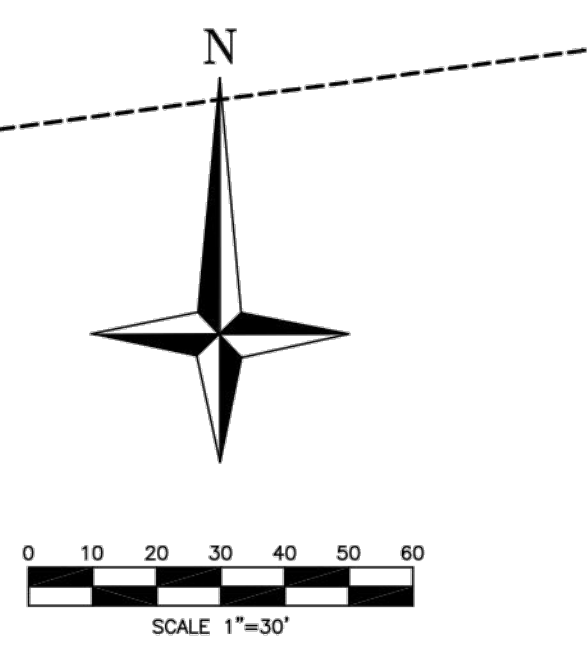

- PROPOSED LEGEND**
- EX - EXISTING
 - PR - PROPOSED
 - IIP - USE IN PLACE
 - ATG - ADJUST TO GRADE
 - TBR - TO BE REMOVED
 - TBR&R - TO BE REMOVED AND RELOCATED
 - CONSTRUCTED BY OTHER (MoDOT OR SITE)
 - - - - FUTURE CONSTRUCTION
 - [Hatched Box] - PR PCC ITEM
 - [Solid Box] - PR PAVEMENT (MATCH MoDOT's TYPE)

NOTES:

- 1. THIS SHEET IS FOR ILLUSTRATIVE PURPOSES ONLY. NOT FOR CONSTRUCTION.**
- 2. SEE PLANS PREPARED BY CBB FOR FINAL DESIGN OF INTERSECTION IMPROVEMENTS.**

PROJECT TITLE

The Villages at Shady Creek

OFFALLON, MISSOURI

THE STERLING CO.
ENGINEERS & SURVEYORS

5055 New Baumgartner Road
St. Louis, Missouri 63129
Ph 314-487-0440 Fax 314-487-8944
www.sterling-eng-sur.com
Corporate Certificate of Authority #001348

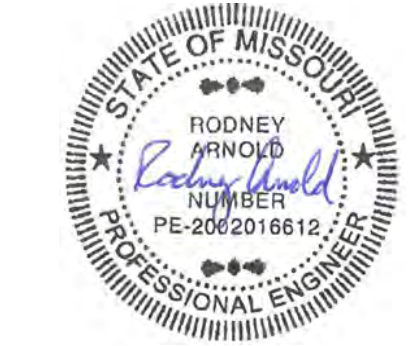

Date: 12/10/2015
RODNEY ARNOLD
LICENSE # PE-2002016612
Civil Engineer

Lombardo Homes of St. Louis, LLC

2299 Technology Drive, Suite 150
O'Fallon, Missouri 63368
Ph. (636) 265-2710
Fax (636) 695-3195
www.lombardohomesstlouis.com

OFFSITE ROAD IMPROVEMENTS

P+Z No. P&Z NO
City No. 15-162-SP
Date: 12/10/2015
Job No. 14-03-087

Page No.
12.7

IMP

Drawing name: V:\42687_GRRF\710\Drawings\Improvements\3071\MP.dwg Plotter on: Dec 15, 2015 10:42:11am Plotted by: jmorris