

ISSUE	DATE / REMARKS
1	3-3-2015 Initial Submittal
2	5-7-2015 City Comments
3	6-26-2015 City & PWSD #2 Comments
4	11-9-2015 City Comments
5	12-10-2015 City Comments

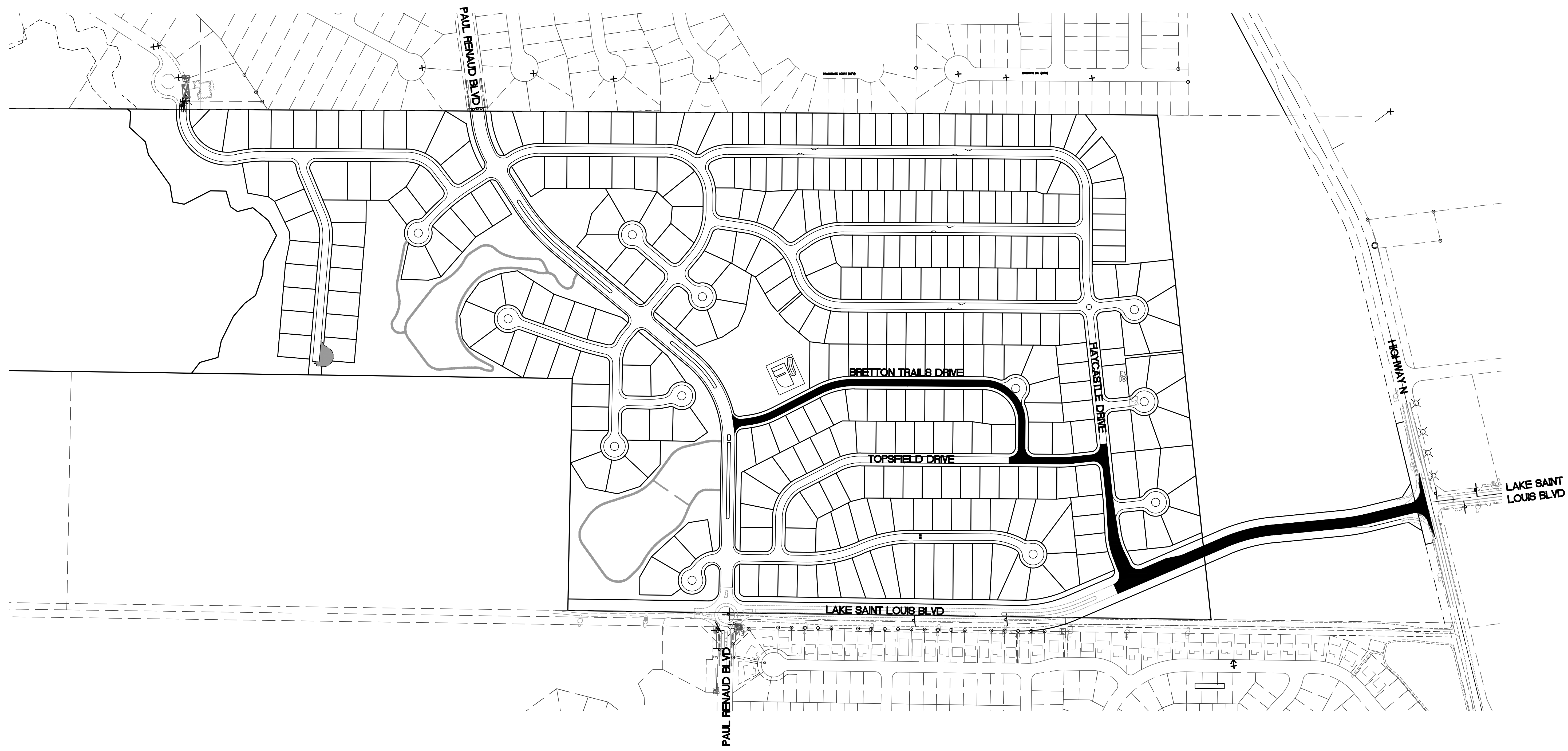

Access Plan

THE ABOVE ACCESS ROUTE (SHADED) TO PAUL RENAUD BLVD SHALL BE ESTABLISHED IF CONSTRUCTION OF LAKE SAINT LOUIS BLVD HAS NOT BEEN COMPLETED.
 AN ALTERNATE ACCESS ROUTE MAY BE PROPOSED TO THE CITY IN THE FUTURE IF NECESSARY.

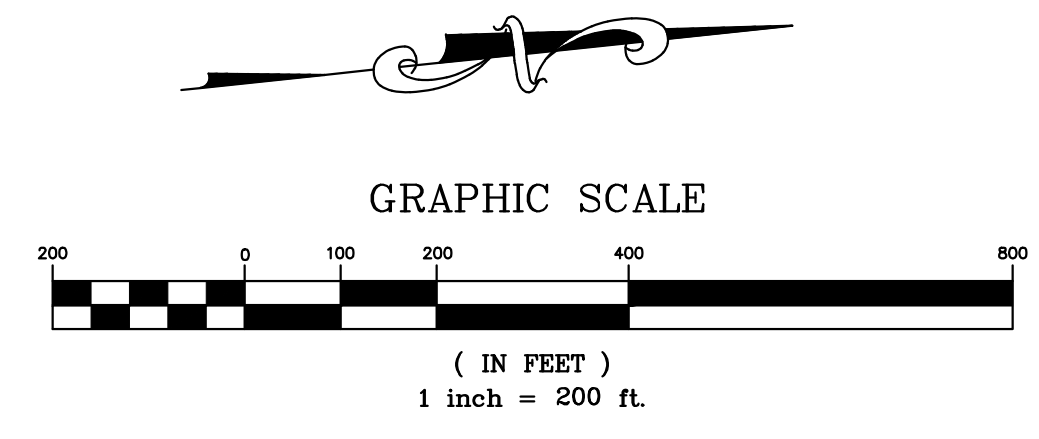

PROJECT TITLE

*The Villages at
Shady Creek*
OFALLON, MISSOURI

THE **STERLING** CO.
ENGINEERS & SURVEYORS
5055 New Baumgartner Road
St. Louis, Missouri 63129
Ph 314-487-0440 Fax 314-487-8944
www.sterling-eng-sur.com
Corporate Certificate of Authority #001348



Date: 12/10/2015
 RODNEY ARNOLD
 LICENSE # PE-2002016612
 Civil Engineer

Lombardo Homes of St. Louis, LLC
 2299 Technology Drive, Suite 150
 Ofallon, Missouri 63368
 Ph. (636) 265-2710
 Fax (636) 695-3195
 www.lombardohomesstlouis.com

ACCESS PLAN DETAIL

P+Z No. P&Z NO
 City No. 15-162-SP
 Date: 12/10/2015
 Job No. 14-03-087

Page No.

DTL-13
 IMP

Drawing name: V:\42687-GRF\77\Drawings\Improvements\327\MP.dwg Plotted on: Dec 15, 2015 - 11:56am Plotted by: jmorris