

# SITE DEVELOPMENT PLANS TO SERVE SIGNATURE BANK OF O'FALLON, MO

100 CHRISTINA MARIE DRIVE  
CITY OF O'FALLON,  
ST. CHARLES COUNTY, MISSOURI

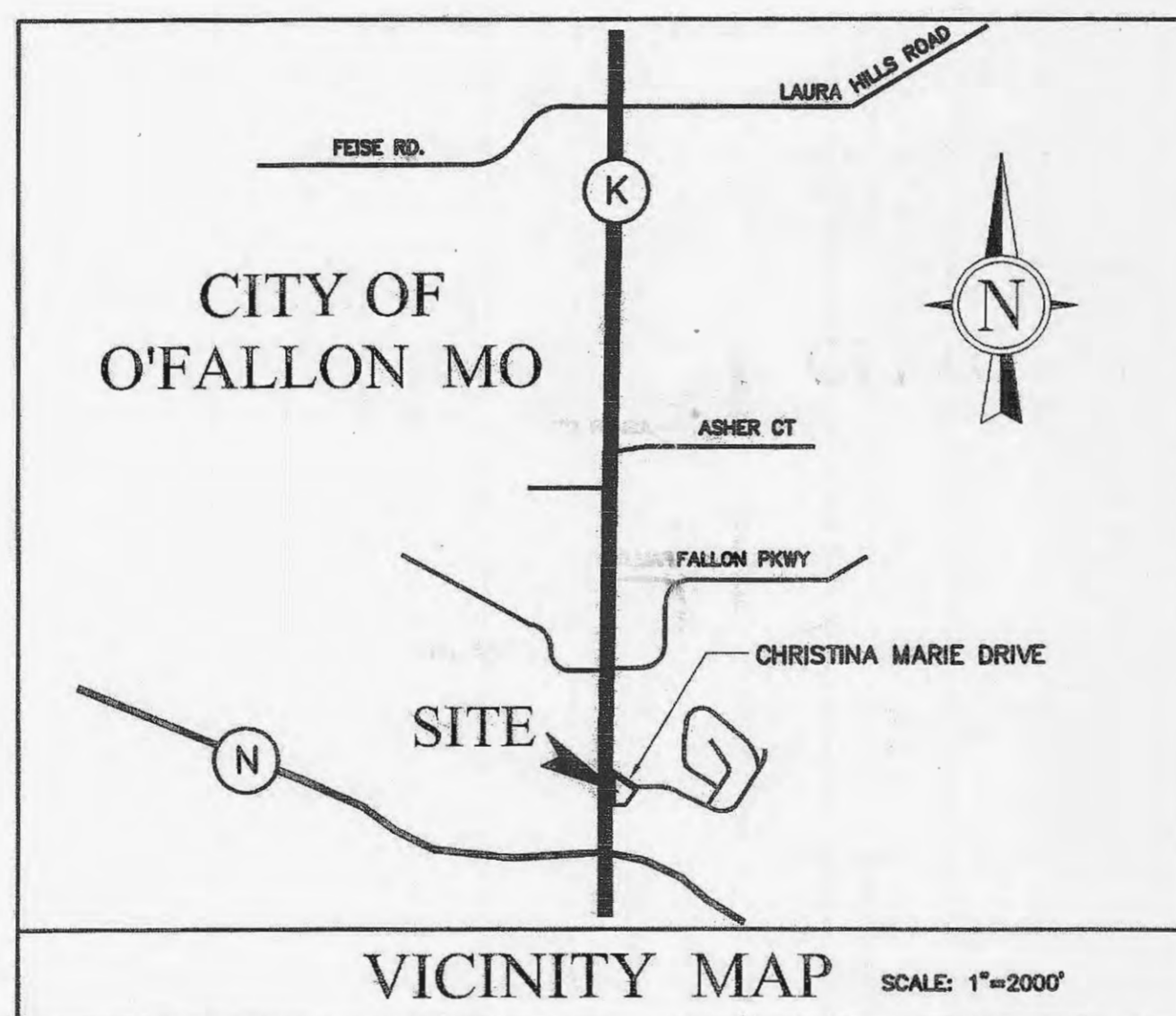

**NOTES:**

1. DEVELOPER MUST SUPPLY CITY CONSTRUCTION INSPECTORS WITH SOIL REPORTS PRIOR TO OR DURING SITE SOIL TESTING.
2. THE SOIL REPORT WILL BE REQUIRED TO CONTAIN THE FOLLOWING INFORMATION ON SOIL TEST CURVES (PROCTOR REPORTS) FOR PROJECTS WITH THE CITY.
  - \* MAXIMUM DRY DENSITY
  - \* OPTIMUM MOISTURE CONTENT
  - \* MAXIMUM AND MINIMUM ALLOWABLE MOISTURE CONTENT
  - \* CURVE MUST BE PLOTTED TO SHOW DENSITY FROM A MINIMUM OF 90% COMPACTION AND ABOVE AS DETERMINED BY THE "MODIFIED AASHTO T-100 COMPACTION TEST" (A.S.T.M.-D-1157) OR FROM A MINIMUM 95% AS DETERMINED BY THE "STANDARD PROCTOR TEST AASHTO T-99, METHOD C" (A.S.T.M.-D-698). PROCTOR MUST BE DESIGNED ON DOCUMENT.
  - \* CURVE MUST HAVE AT LEAST 5 DENSITY POINTS WITH MOISTURE CONTENT AND SAMPLE LOCATIONS LISTED ON DOCUMENT.
  - \* SPECIFIC GRAVITY.
  - \* NATURAL MOISTURE CONTENT
  - \* LIQUID LIMIT
  - \* PLASTIC LIMIT

BE ADVISED THAT IF THIS INFORMATION IS NOT PROVIDED TO THE CITY'S CONSTRUCTION INSPECTOR THE CITY WILL NOT ALLOW GRADING OR CONSTRUCTION ACTIVITIES TO PROCEED ON ANY PROJECT SITE.

**LEGEND**

PP	POWER POLE W/ GUY WIRE	⊙	SANITARY MANHOLE
⊙	LIGHT STANDARD	○	STORM MANHOLE
⊗	AREA VALVE	---	EXISTING FLOOD PLAIN BOUNDARY
⊕	GAS VALVE	---	NEW FLOOD PLAIN BOUNDARY
⊗	TRAFFIC SIGNAL	---	EXISTING FLOOD WAY BOUNDARY
⊕	SIGN	---	SILTATION CONTROL FENCE
⊕	WATER VALVE	---	EXIST. CONTOUR
⊕	FIRE HYDRANT	---	PROPOSED CONTOUR
⊕	MAILBOX	---	SANITARY
⊕	BELL PEDESTAL	---	NEW VINYL FENCE
⊕	FLARED END SECTION	---	WATER LINE
⊕	EXISTING TREE	---	NEW STORM
		---	OVERHEAD ELECTRIC

THE UTILITIES SHOWN HEREIN WERE PLOTTED FROM AVAILABLE INFORMATION AND DO NOT NECESSARILY REFLECT THE ACTUAL EXISTENCE, NON-EXISTENCE, SIZE, TYPE, OR LOCATION OF THESE OR OTHER UTILITIES. THE CONTRACTOR SHALL BE RESPONSIBLE FOR THE VERIFYING THE ACTUAL LOCATION OF ALL UTILITIES, SHOWN OR NOT SHOWN, AND SAID UTILITIES SHALL BE LOCATED IN THE FIELD PRIOR TO ANY CONSTRUCTION OF IMPROVEMENTS. THESE PROVISIONS SHALL IN NO WAY ABSOLVE ANY PARTY FROM COMPLYING WITH THE UNDERGROUND FACILITY SAFETY AND DAMAGE PREVENTION ACT, CHAPTER 319 RSMo.

REISSUED

**INDEX OF SHEETS**

SHEET 1	OF 16	COVER SHEET
SHEET 2	OF 16	TRAFFIC CONTROL PHASE 1
SHEET 3	OF 16	TRAFFIC CONTROL PHASE 2
SHEET 4	OF 16	STRIPING PLAN
SHEET 5	OF 16	SITE PLAN
SHEET 6	OF 16	GRADING PLAN
SHEET 7	OF 16	DRAINAGE AREA
SHEET 8	OF 16	STORM SEWER PROFILES
SHEET 9	OF 16	SILTATION CONTROL PLAN
SHEET 10	OF 16	CONSTRUCTION NOTES
SHEET 11	OF 16	ENTRANCE PLAN
SHEET 12	OF 16	GENERAL DETAILS
SHEET 13	OF 16	GENERAL DETAILS
SHEET 14	OF 16	GENERAL DETAILS
SHEET 15	OF 16	GENERAL DETAILS
SHEET 16	OF 16	GENERAL DETAILS

CITY PLANNING & ENGINEERING FILE# 0506  
DEVELOPMENT PLAN APPROVED APRIL 20, 2006

PLANS PREPARED FOR  
H DESIGN GROUP LLC  
5051 SOUTH NATIONAL  
SUITE 7A  
SPRINGFIELD, MO 65810



Missouri One Call System, Inc.  
Call Before You Dig!  
FIBER OPTICS ARE PRESENT  
MoDOT 1-314-340-4100  
1-800-DIG-RITE  
(1-800-344-7483)

RECEIVED  
NOV 16 2006  
ENGINEERING DEPARTMENT

REVISION No. 1	AUG. 3, 2006	ADDENDUM	(PER CITY COMMENTS)
REVISION No. 2	AUG. 3, 2006	ADDENDUM	(PER CITY AND MoDOT COMMENTS)
REVISION No. 3	AUG. 3, 2006	ADDENDUM	(PER CITY AND MoDOT COMMENTS)
REVISION No. 4	OCT. 11, 2006	PER WATER DISTRICT	(COMMENTS)
REVISION No. 5	OCT. 25, 2006	PER MoDOT	(COMMENTS)

REVISIONS	

**BUESCHER DITCH & ASSOCIATES, INC.**  
2 East Fifth Street, P.O. Box 621, Washington, Missouri 63090  
Telephone: 1-636-239-6255 Fax: 1-636-239-7681  
E-mail: www.buescherditch.com

COVER SHEET  
SIGNATURE BANK OF O'FALLON  
ST. CHARLES COUNTY, MISSOURI

CITY OF O'FALLON  
COMMUNITY DEVELOPMENT DEPARTMENT  
ACCEPTED FOR CONSTRUCTION  
BY: [Signature]  
DATE: 11-22-06  
PROFESSIONAL ENGINEER'S SEAL  
INDICATES RESPONSIBILITY FOR DESIGN



RECEIVED  
NOV 15 2006  
BUILDING DEPARTMENT

10/30/06  
6-15-06  
DATE  
06033  
PROJECT NUMBER  
PERMIT PLAN  
NOV 02 2006  
MoDOT DIST 6

This document shall remain the property of Buescher Ditch and Associates, Inc. (BDA) and may not be used by any other party without the written consent of said BDA.

1 of 16
SHEET OF
GMM
DRAWN CHECKED

Const. Inspector