

SECTION ONE RETAINING WALL PROFILES

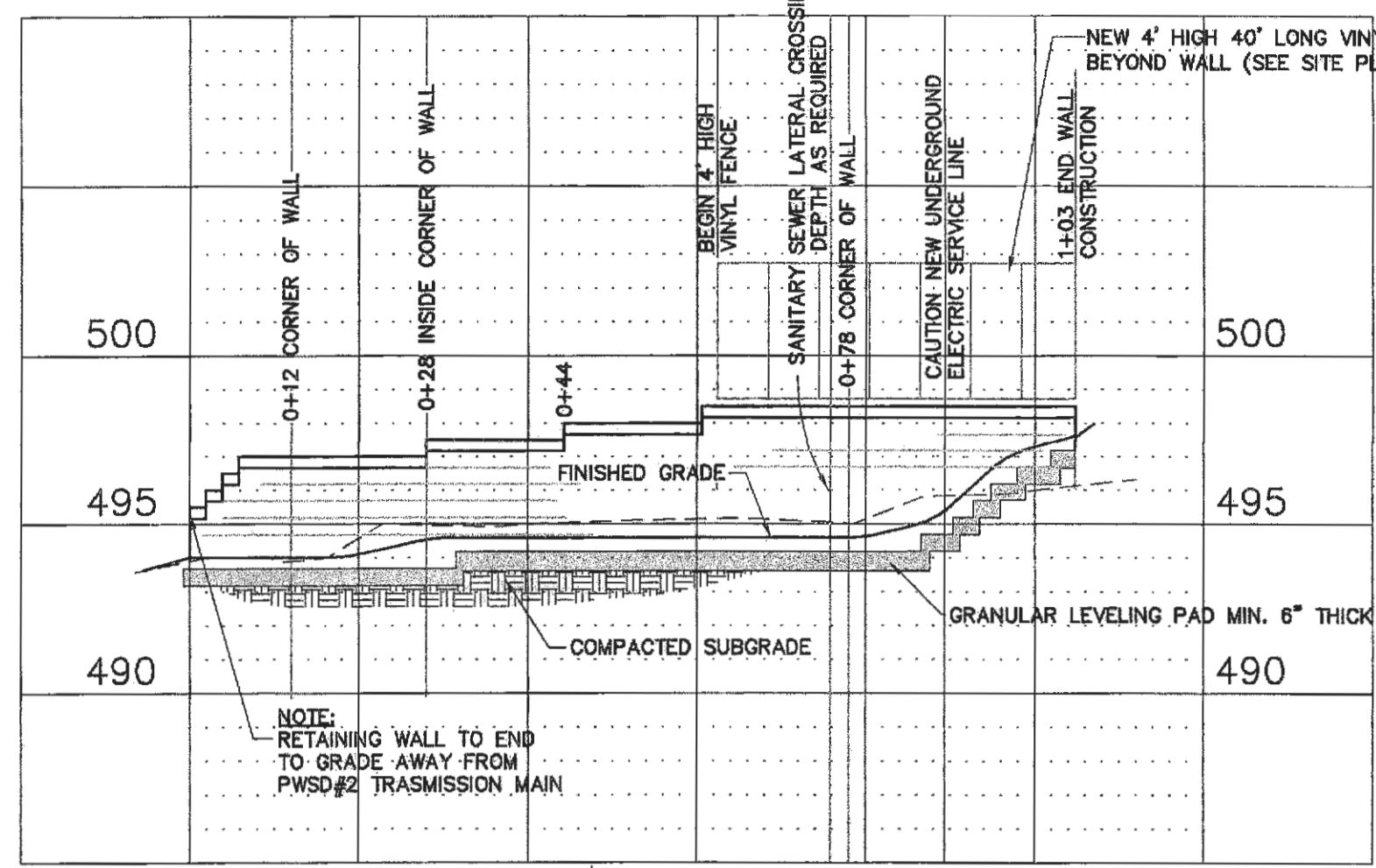

SECTION TWO RETAINING WALL PROFILES

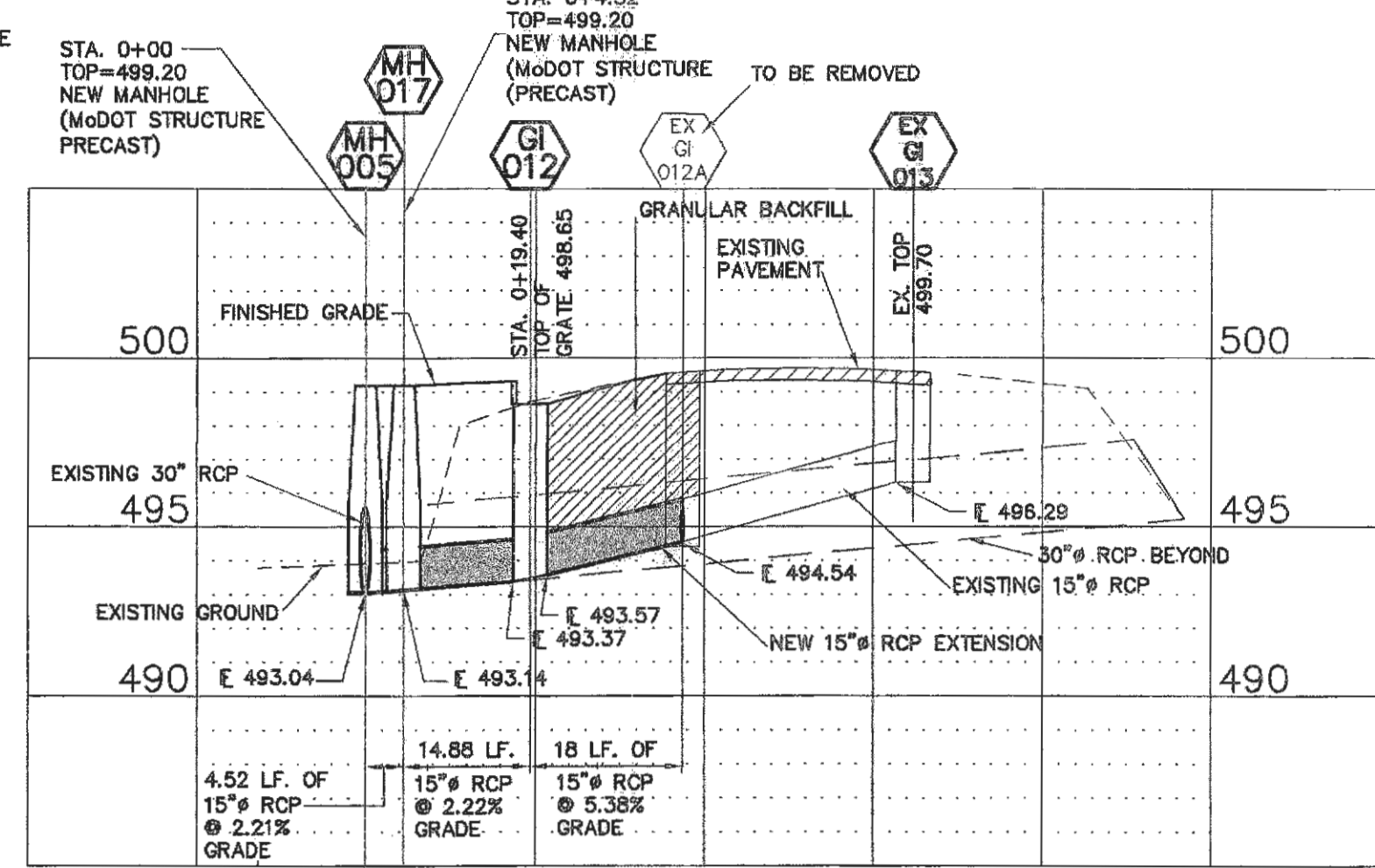

MoDOT 15" RCP SEWER

SCALE:
HORIZ. 1"=20'
VERT. 1"= 5'

SEE WALL DETAILS
SHEET 10 OF 16
SCALE:
HORIZ. 1"=20'
VERT. 1"= 5'

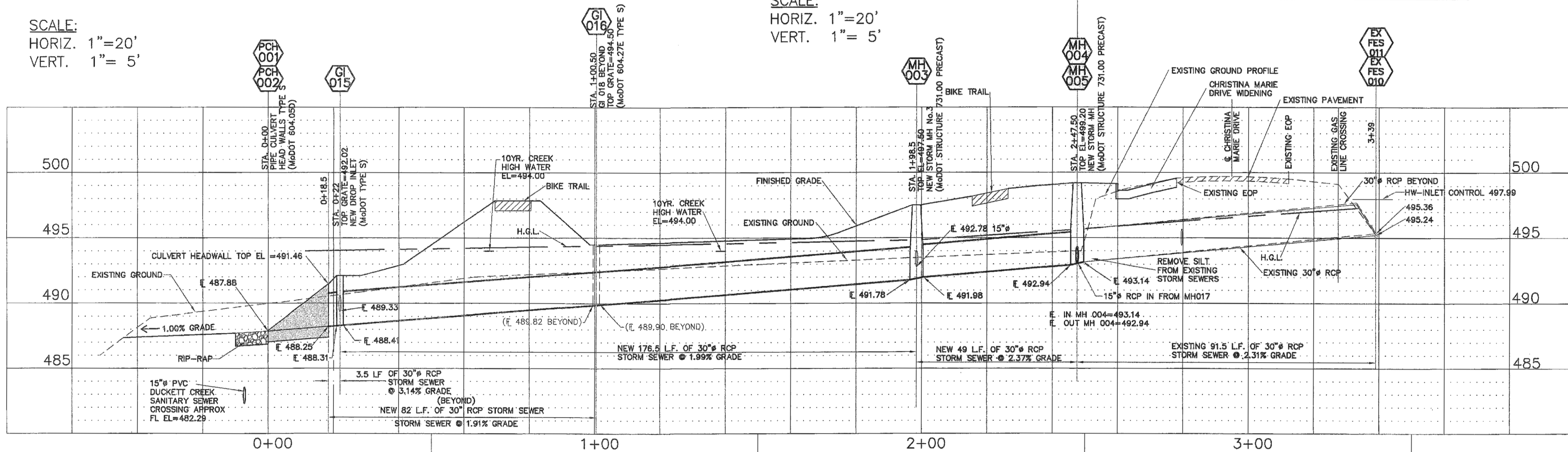

MoDOT 30" RCP SEWERS

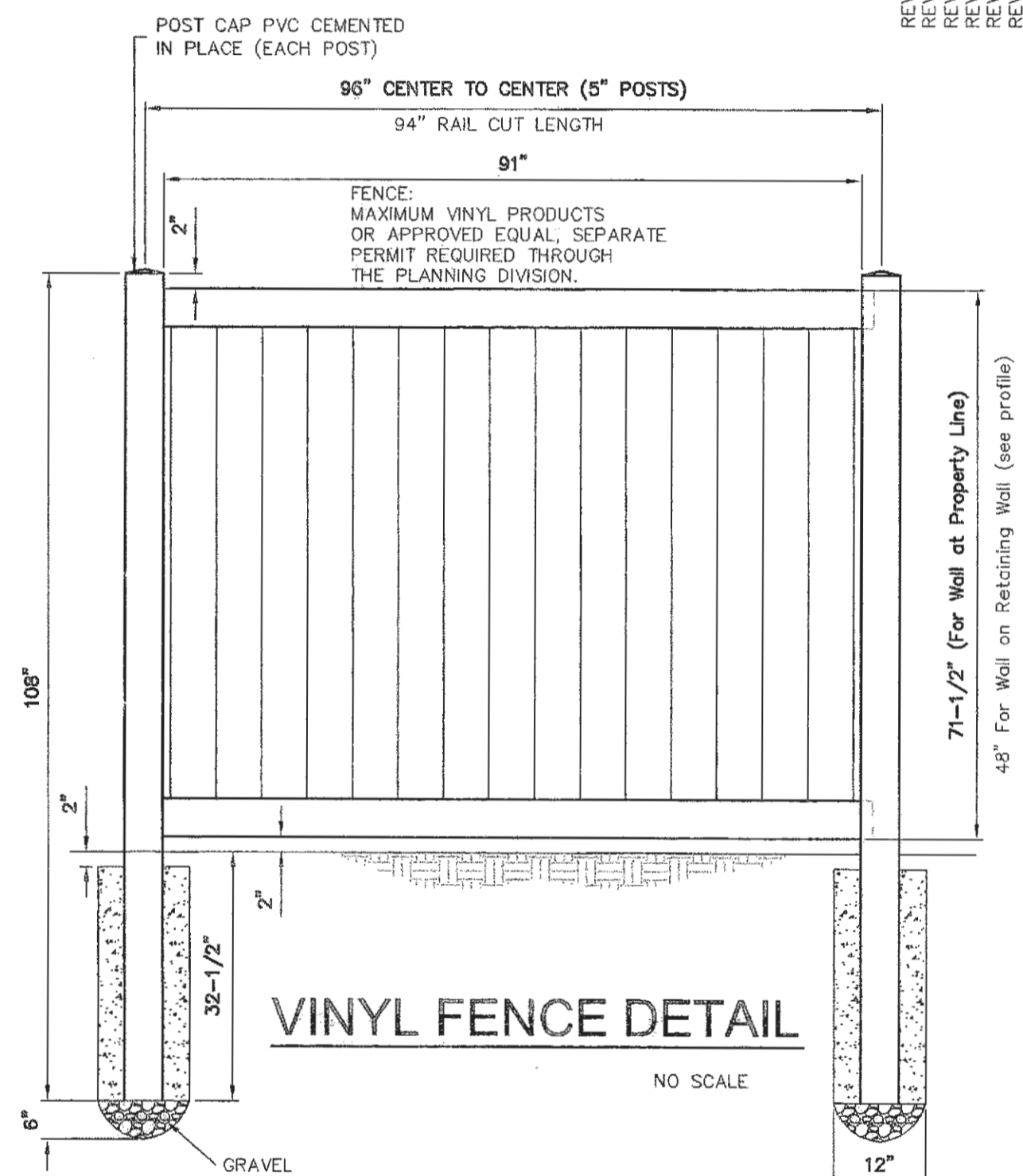

VINYL FENCE DETAIL

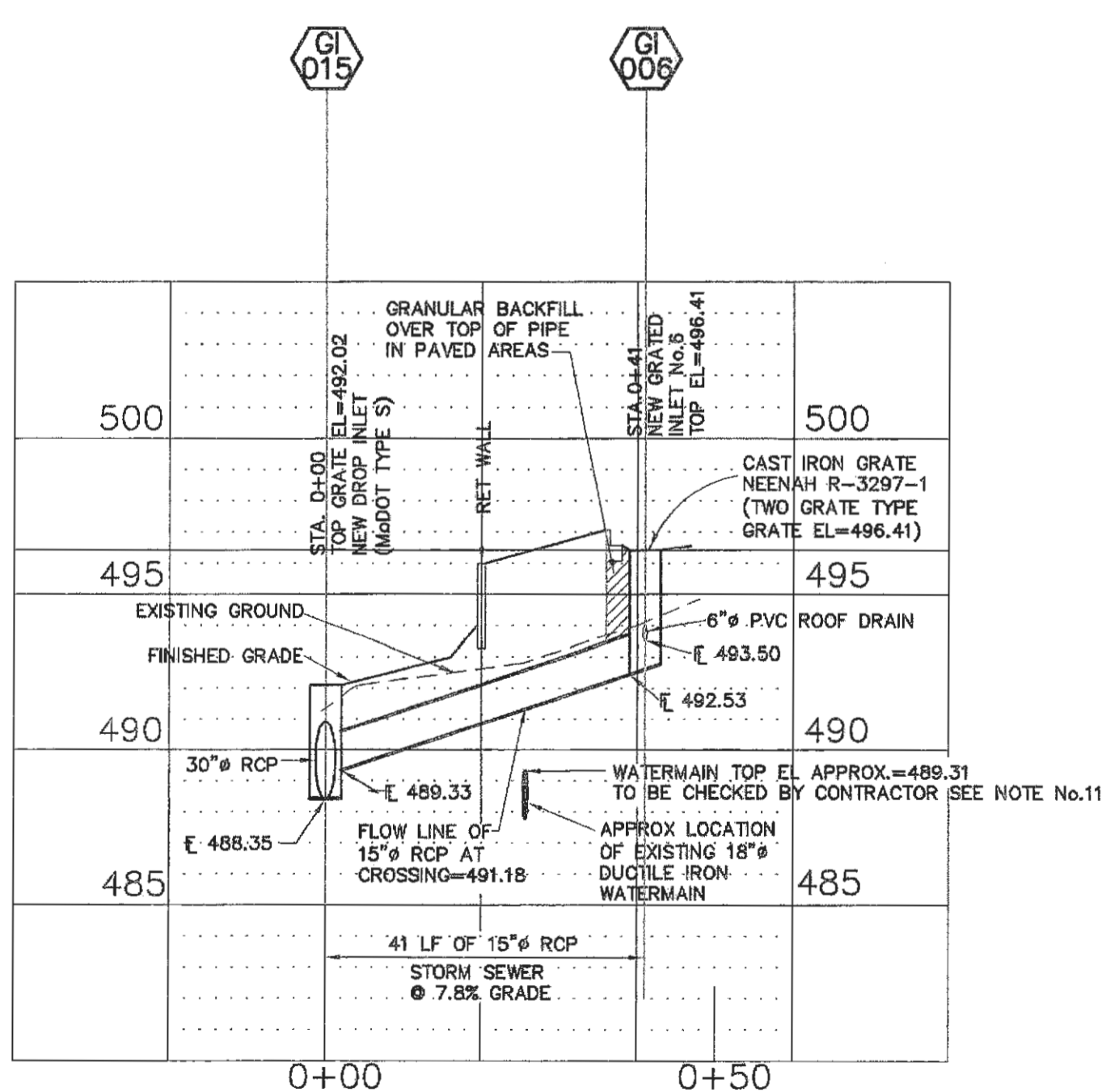

PRIVATE 15" RCP SEWER

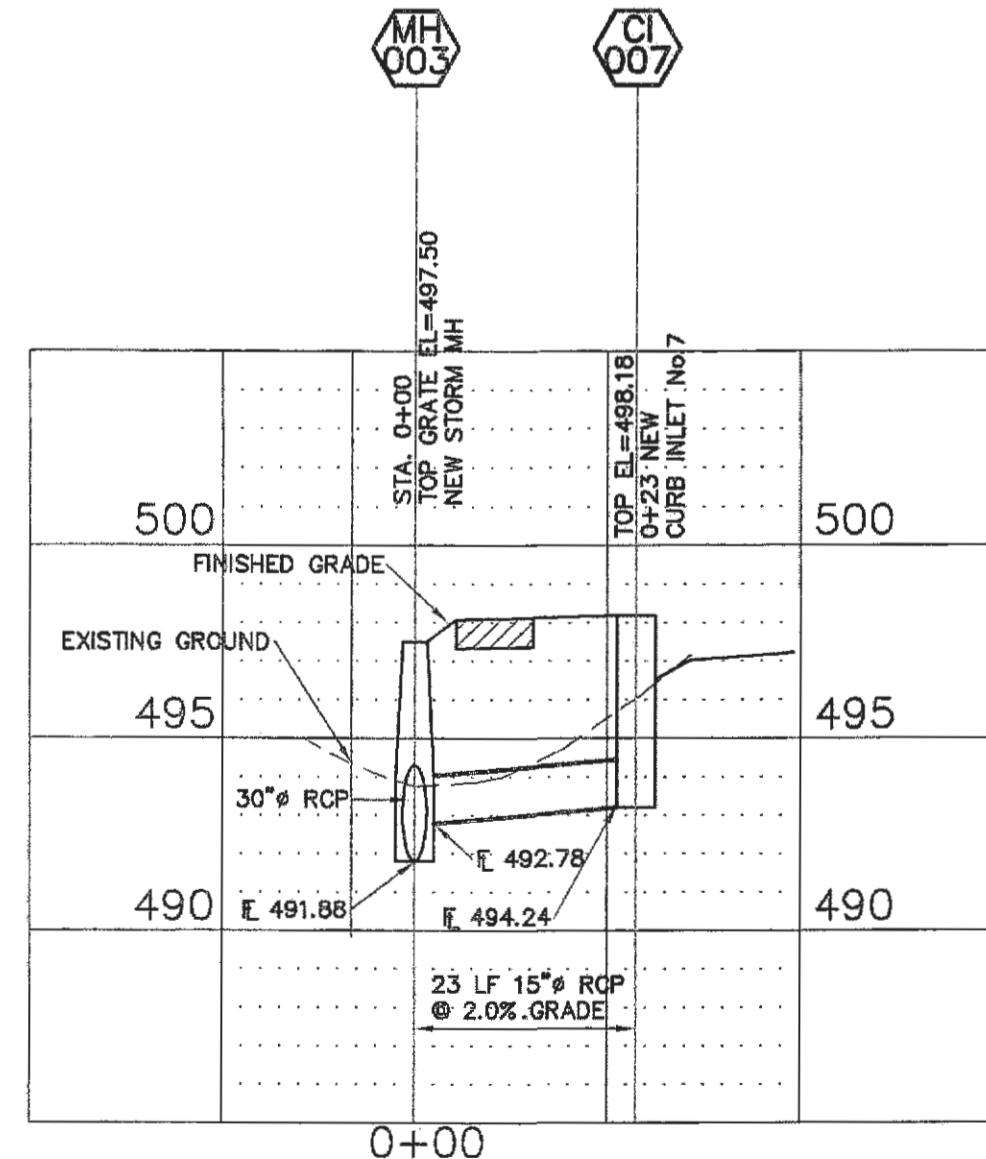

PRIVATE 15" RCP SEWER

NOTES:

- 1.) THE UTILITIES SHOWN HEREIN WERE PLOTTED FROM AVAILABLE INFORMATION AND DO NOT NECESSARILY REFLECT THE ACTUAL EXISTENCE, NONEXISTENCE, SIZE, TYPE, OR LOCATION OF THESE OR OTHER UTILITIES. THE CONTRACTOR SHALL BE RESPONSIBLE FOR THE VERIFYING THE ACTUAL LOCATION OF ALL UTILITIES, SHOWN OR NOT SHOWN, AND SAID UTILITIES SHALL BE LOCATED IN THE FIELD PRIOR TO ANY CONSTRUCTION OF IMPROVEMENTS. THESE PROVISIONS SHALL IN NO WAY ABSOLVE ANY PARTY FROM COMPLYING WITH THE UNDERGROUND FACILITY SAFETY AND DAMAGE PREVENTION ACT, CHAPTER 319 RSMO.
- 2.) ALL GRADED AREAS SHALL BE PROTECTED FROM EROSION BY EROSION CONTROL DEVICES AND/OR SEEDING AND MULCHING.
- 3.) GRADING CONTRACTOR SHALL INSTALL SILTATION CONTROL PRIOR TO STARTING THE GRADING.
- 4.) ALL FILLS AND BACKFILLS SHALL BE MADE OF SELECTED EARTH MATERIALS, FREE FROM BROKEN MASONRY, ROCK, FROZEN EARTH, RUBBISH, ORGANIC MATERIAL AND DEBRIS.
- 5.) GRADING CONTRACTOR SHALL KEEP EXISTING ROADWAYS CLEAN OF MUD AND DEBRIS AT ALL TIMES.
- 6.) NO GRADE SHALL EXCEED 3:1 SLOPE, OR AS DIRECTED BY SOIL CONSULTANT.
- 7.) A GRADING PERMIT FROM THE DIRECTOR OF PUBLIC WORKS IS REQUIRED PRIOR TO ANY GRADING ON THE SITE AND A LAND DISTURBANCE PERMIT FROM THE DEPARTMENT OF NATURAL RESOURCES WHERE APPLICABLE NO CHANGE IN WATERSHEDS SHALL BE PERMITTED.
- 8.) ALL JOINTS SHALL BE GASKETED "O-RING" TYPE.
- 9.) PROVIDE 5/8" DIA. TRASH BARS FOR ALL INLETS.
- 10.) ALL PROPOSED FENCING REQUIRES A SEPARATE PERMIT THROUGH THE PLANNING DIVISION.
- 11.) THE STORM SEWER CONTRACTOR SHALL UNCOVER THE PWS#2 18" DIP TRANSMISSION MAIN IN THE AREA OF 15" RCP CROSSING FROM GI #006 TO GI #015. EXTREME CARE SHALL BE EXERCISED AS NOT TO DAMAGE THE TRANSMISSION MAIN DURING THE DIG. THE TOP OF THE 18" DIP SHALL BE SURVEYED USING THE SITE BENCH MARK. IF THE WATER MAIN ELEVATION IS ABOVE 489.31 THE CONTRACTOR SHALL CONTACT PWS#2 AND SOLICIT A PERMIT FOR CLEARANCE VARIANCE.



Missouri One Call System, Inc.
Call Before You Dig!
FIBER OPTICS ARE PRESENT
MoDOT 1-314-340-4100
1-800-DIG-RITE
(1-800-344-7483)

CITY PLANNING & ENGINEERING FILE # 0506
DEVELOPMENT PLAN APPROVED APRIL 20, 2006

This document shall remain the property of Buescher Ditch and Associates, Inc. (BDA) and may not be used by any other party without the written consent of said BDA.

REVISIONS	

BUESCHER DITCH & ASSOCIATES, INC.
2 East Fifth Street, P.O. Box 621, Washington, Missouri 63090
Telephone: 1-636-239-7681
E-mail: www.buescherditch.com

STORM SEWER PLAN AND PROFILES
SIGNATURE BANK OF O'FALLON
ST. CHARLES COUNTY, MISSOURI



11/15/06
DATE
06033
PROJECT NUMBER
0000CON.DWG
FILE NAME
8 of 16
SHEET OF
CMM
DRAWN CHECKED