

**SITE NOTES:**

- UNDERGROUND UTILITIES HAVE BEEN PLOTTED FROM AVAILABLE INFORMATION AND THEREFORE LOCATION SHALL BE CONSIDERED APPROXIMATE ONLY. THE VERIFICATION OF THE LOCATION OF ALL UNDERGROUND UTILITIES, EITHER SHOWN OR NOT SHOWN ON THESE PLANS, SHALL BE THE RESPONSIBILITY OF THE CONTRACTOR AND SHALL BE LOCATED PRIOR TO ANY GRADING OR CONSTRUCTION OF IMPROVEMENTS.
- GAS, WATER AND OTHER UNDERGROUND UTILITIES SHALL NOT CONFLICT WITH THE DEPTH OR HORIZONTAL LOCATION OF EXISTING OR PROPOSED SANITARY AND STORM SEWERS, INCLUDING HOUSE LATERALS.
- ALL EXISTING SITE IMPROVEMENTS DISTURBED, DAMAGED OR DESTROYED SHALL BE REPAIRED OR REPLACED TO CLOSELY MATCH PRE CONSTRUCTION CONDITIONS.
- ALL FILL INCLUDING PLACES UNDER PROPOSED STORM AND SANITARY SEWER LINES AND PAVED AREAS INCLUDING TRENCH BACKFILLS WITHIN AND OFF THE ROAD RIGHT-OF-WAY SHALL BE COMPACTED TO 90 PERCENT OF MAXIMUM DENSITY AS DETERMINED BY THE MODIFIED AASHTO T-180 COMPACTION TEST (ASTM D1557). ALL TESTS SHALL BE VERIFIED BY A SOILS ENGINEER CONCURRENT WITH GRADING AND BACKFILLING OPERATIONS. THE COMPACTED FILL SHALL BE FREE OF RUTTING AND SHALL BE NON-YIELDING AND NON-PUMPING DURING PROOFROLLING AND COMPACTION.
- THE CONTRACTOR SHALL PREVENT ALL STORM, SURFACE WATER, MUD AND CONSTRUCTION DEBRIS FROM ENTERING THE EXISTING SANITARY SEWER SYSTEM.
- ALL SANITARY SEWER FLOWLINES AND TOPS BUILT WITHOUT ELEVATIONS FURNISHED BY THE ENGINEER WILL BE THE RESPONSIBILITY OF THE SEWER CONTRACTOR.
- EASEMENTS SHALL BE PROVIDED FOR ALL SANITARY SEWERS, STORM SEWERS AND ALL UTILITIES ON THE RECORD PLAN.
- ALL SANITARY SEWER CONSTRUCTION AND MATERIALS SHALL CONFORM TO THE CURRENT CONSTRUCTION STANDARDS OF DUCKETT CREEK SANITARY DISTRICT.
- THE DUCKETT CREEK SANITARY DISTRICT SHALL BE NOTIFIED AT LEAST 48 HOURS PRIOR TO CONSTRUCTION FOR COORDINATION OF INSPECTION.
- ALL SANITARY SEWER BUILDING CONNECTIONS SHALL BE DESIGNED SO THAT THE MINIMUM VERTICAL DISTANCE FROM THE LOW POINT OF THE BASEMENT TO THE FLOWLINE OF A SANITARY SEWER AT THE CORRESPONDING BUILDING CONNECTION SHALL BE LESS THAN THE DIAMETER OF THE PIPE PLUS THE VERTICAL DISTANCE OF 2-1/2 FEET.
- ALL SANITARY SEWER MANHOLES SHALL BE WATERPROOFED ON THE EXTERIOR IN ACCORDANCE WITH MISSOURI DEPT. OF NATURAL RESOURCES SPECIFICATION 10 CSR-8, 120(7)(E).
- ALL PVC SANITARY SEWER PIPE SHALL CONFORM TO THE REQUIREMENTS OF ASTM D-3034 STANDARD SPECIFICATION FOR PSM POLYVINYL CHLORIDE SEWER PIPE, SDR-35 OR EQUAL, WITH "CLEAN" 1/2 INCH TO 1 INCH GRANULAR STONE BEDDING UNIFORMLY GRADED. THIS BEDDING SHALL EXTEND FROM 4 INCHES BELOW THE PIPE TO SPRINGLINE OF PIPE. IMMEDIATE BACKFILL OVER PIPE SHALL CONSIST OF SAME SIZE "CLEAN" OR "MINUS" STONE FROM SPRINGLINE OF PIPE TO 6 INCHES ABOVE THE TOP OF PIPE.
- ALL SANITARY AND STORM SEWER TRENCH BACKFILLS SHALL BE WATER JETTED. GRANULAR BACKFILL WILL BE USED UNDER PAVEMENT AREAS.
- ALL PIPES SHALL HAVE POSITIVE DRAINAGE THROUGH MANHOLES. FLAT INVERT STRUCTURES NOT ALLOWED.
- ALL CREEK CROSSING SHALL BE LINED WITH RIP-RAP AS DIRECTED BY DISTRICT INSPECTORS.
- BRICK SHALL NOT BE USED ON SANITARY SEWER MANHOLES.
- EXISTING SANITARY SEWER SERVICE SHALL NOT BE INTERRUPTED.
- MAINTAIN ACCESS TO EXISTING RESIDENTIAL DRIVEWAYS AND STREETS.
- PRE MANUFACTURED ADAPTERS SHALL BE USED AT ALL PVC TO DIP CONNECTIONS. RUBBER BOOT / MISSION-TYPE COUPLINGS WILL NOT BE ALLOWED.
- ANY PERMITS, LICENSES, EASEMENTS, OR APPROVALS REQUIRED TO WORK ON PUBLIC OR PRIVATE PROPERTIES OR ROADWAYS ARE THE RESPONSIBILITY OF THE DEVELOPER.
- "TYPE N" LOCK-TYPE COVER AND LOCKING DEVICE (LOCK-LUG) SHALL BE USED WHERE LOCK-TYPE COVERS ARE REQUIRED.
- WHERE EXCAVATION RESULTS IN SUBGRADE OR SLOPES OF UNSUITABLE MATERIAL, SUCH MATERIAL TO BE REMOVED AND REPLACED WITH APPROVED MATERIAL.
- ALL FILL PLACED UNDER PROPOSED STORM AND SANITARY SEWER, PROPOSED ROADS, AND/OR PAVED AREAS SHALL BE COMPACTED TO 90% OF MINIMUM DENSITY AS DETERMINED BY THE MODIFIED AASHTO T-180 COMPACTION TEST OR 95% OF MAXIMUM DENSITY AS DETERMINED BY THE STANDARD PROCTOR TEST AASHTO T-99. ALL FILL PLACED IN PROPOSED ROADS SHALL BE COMPACTED FROM THE BOTTOM OF THE FILL UP. ALL TESTS SHALL BE VERIFIED BY A SOILS ENGINEER CONCURRENT WITH GRADING AND BACKFILLING OPERATIONS. NOTE THAT THE MOISTURE CONTENT OF THE SOIL IN FILL AREAS IS TO CORRESPOND TO THE COMPACTIVE EFFORT AS DEFINED BY THE STANDARD OR MODIFIED PROCTOR TEST. OPTIMUM MOISTURE CONTENT SHALL BE DETERMINED USING THE SAME TEST THAT WAS USED FOR COMPACTION. SOIL COMPACTION CURVES SHALL BE SUBMITTED TO THE CITY OF O'FALLON PRIOR TO THE PLACEMENT OF FILL. PROOF ROLLING MAY BE REQUIRED TO VERIFY SOIL STABILITY AT THE DISCRETION OF THE CITY OF O'FALLON.
- EACH LAYER SHALL BE WETTED OR DRIED, IF NECESSARY, AND COMPACTED TO REQUIRED DENSITY. COMPACTIVE EFFORT ON EACH LAYER TO CONSIST OF DISTRIBUTING ALL EQUIPMENT MOVEMENTS OVER ENTIRE FILL AREA AND MAKING AT LEAST THREE COMPLETE COVERS WITH A TAMPERING-TYPE ROLLER. TAMPERING-TYPE ROLLER TO HAVE TAMPERS OR FEET PROJECTING NOT LESS THAN 6 INCHES FROM THE SURFACE OF THE DRUM AND SHALL HAVE A MINIMUM LOAD ON EACH TAMPER OF 250 POUNDS PER SQUARE INCH OF TAMPERING AREA.
- ALL EXCAVATED MATERIAL TO BE STOCKPILED IN A MANNER THAT WILL NOT ENDANGER THE WORK OR IMPEDE DISCHARGE OF SURFACE WATER.
- ALL EXCESS OR UNSUITABLE EXCAVATED MATERIAL TO BE STORED IN DESIGNATED STORAGE AREAS OR AS DIRECTED BY THE ENGINEER, AND LATER USED AS FILL IN UNCRITICAL AREAS OR REMOVED FROM THE SITE.
- NEWLY FINISHED SURFACES TO BE PROTECTED FROM ANY ACTION OF THE ELEMENTS, OR ANY SETTLEMENT OR WASHING THAT MAY OCCUR.
- SILTATION CONTROL DEVICES TO BE IN PLACE DURING ALL OPERATIONS TO CONTROL EROSION. ADDITIONAL SILTATION AND EROSION CONTROL DEVICES MAY BE REQUIRED AS DIRECTED BY WARREN COUNTY.
- ROCK IS DEFINED AS MATERIAL THAT CANNOT BE EXCAVATED BY A STANDARD EXCAVATING MACHINE (BULLDOZER, BACKHOE, ETC.) WITHOUT DRILLING AND BLASTING OR WEDGING. ROCK SHALL BE REMOVED DOWN TO FINISH GRADES SHOWN ON THE PLANS. WHERE ROCK IS ENCOUNTERED, CONTRACTOR SHALL PROVIDE SUITABLE EQUIPMENT AND PERSONNEL FOR CARRYING OUT DRILLING, BLASTING, AND ROCK REMOVAL OPERATIONS IN A SAFE AND SENSIBLE MANNER.
- WHEN SOLID ROCK IS ENCOUNTERED, STRIP ALL OVERLYING EARTH FROM ROCK AREA, THEN NOTIFY ENGINEER FOR INSPECTION AND MEASUREMENT. ENGINEER MAY THEN TAKE ELEVATIONS ON THE SURFACE OF THE ROCK AND ADJACENT GROUND LEVEL OR MAY, AT HIS DISCRETION, DEFER MEASUREMENT UNTIL EXCAVATION IS COMPLETED. IN ANY EVENT, CONTRACTOR SHALL NOT EXCAVATE FURTHER INTO THE ROCK UNTIL TOLD TO DO SO BY THE ENGINEER. ROCK VOLUME WILL BE DETERMINED USING LENGTHS AND DEPTHS AS MEASURED IN THE FIELD. CONTRACTOR WILL NOT BE ALLOWED PAYMENT FOR ANY ROCK CLAIMED UNLESS SAME HAS BEEN MEASURED AS HEREIN DEFINED.
- COMPACTION TESTS TO BE RESPONSIBILITY OF CONTRACTOR AS A FORM OF QUALITY CONTROL. TESTS TO BE TAKEN BY AN APPROVED TESTING FIRM AT LOCATIONS APPROVED BY THE ENGINEER. FREQUENCY OF THE TESTING FOR EACH LIFT TO BE ONE DENSITY TEST EVERY 10,000 SQUARE FEET OF FILL AREA OR AS DIRECTED BY THE ENGINEER. ALL TESTS REPORTS TO BE SENT TO THE ENGINEER FOR REVIEW AND APPROVAL. THE COUNTY MAY, AT THE DISCRETION OF THE COMMISSIONER OF PUBLIC WORKS, EMPLOY A TESTING FIRM AS A FORM OF QUALITY ASSURANCE.
- THE FIELD DENSITY AFTER COMPACTION WILL BE DETERMINED IN ACCORDANCE WITH ASTM D2922 (NUCLEAR METHOD), ASTM D1556 (SAND CONE METHOD), ASTM D2167 (RUBBER BALLOON METHOD), OR ASTM D2937 (DRIVE CYLINDER METHOD).

- ALL DISTURBED AREAS OF THE SITE TO BE PREPARED, LIMED, FERTILIZED AND SEEDED SURFACES TO BE FREE OF LARGE CLODS AND STONES AND FIRST SMOOTHED BY DISKING AND DRAGGING TO FORM A GOOD SEEDBED. SEEDBEDS SHALL THEN BE FIRMED BY ROLLING OR CULTIPACKING.
- SEEDS TO BE SOWN BY A METHOD THAT WILL INSURE UNIFORM DISTRIBUTION OVER ENTIRE AREA.
- STARTER LIME AND FERTILIZER TO BE UNIFORMLY APPLIED OVER THE PREPARED SURFACE AT THE FOLLOWING RATES:
  - LIME: 75 LB. PER 1,000 SQ. FT.
  - FERTILIZER: 5-10-5 FERTILIZER AT 25 LB. PER 1,000 SQ. FT.
- SEEDBEDS TO BE SEED AT 3.5 LB. PER 1,000 SQ. FT. WITH THE FOLLOWING MIXTURE:
  - PERENNIAL REGRESS 25%
  - KENTUCKY BLUEGRASS 60%
  - WHITE DUTCH CLOVER 15%
 IF CUT AND FILL OPERATIONS OCCUR DURING A SEASON NOT FAVORABLE FOR IMMEDIATE ESTABLISHMENT OF GROUND COVER, A FAST GERMINATING ANNUAL SEED SUCH AS RYE GRASS (COOL WEATHER) OR SUDAN GRASS (HOT WEATHER) SHALL BE UTILIZED TO RETARD EROSION.
- ALL LEGUME SEEDS TO BE INOCULATED AT SEEDING TIME. SOW AS SOON AS POSSIBLE AFTER INOCULATION. KEEP INOCULATED SEED IN A SHADY PLACE BETWEEN TIME OF INOCULATION AND PLANTING. SEED HELD MORE THAN 24 HOURS SHOULD BE RE-INOCULATED.
- THE SEEDING AREA TO BE ROLLED OR CULTIPACKED AFTER SEEDING AND MULCHED WITH STRAW OR BURLAP. RATE OF APPLICATION OF STRAW TO BE APPROXIMATELY 1 BALE PER 1,000 SQ. FT. AREA TO BE KEPT CONTINUALLY DAMP UNTIL SEEDLINGS ARE WELL ESTABLISHED.
- THE CONTRACTOR SHALL PROTECT AND AVOID DAMAGE TO ALL PUBLIC AND PRIVATE PROPERTY ALONG THE LINE OF WORK. ANY DAMAGE DONE TO BE REPAIRED OR RESTORED AT HIS EXPENSE. PARTICULAR ATTENTION SHALL BE PAID TO AVOID DAMAGE TO TREES, SHRUBS, BUSHES, AND PRIVATE PROPERTY LOCATED IN AND ADJACENT TO EASEMENTS ON PRIVATE PROPERTY.
- NO TREES MAY BE REMOVED OUTSIDE CONSTRUCTION LIMITS WITHOUT THE PERMISSION OF THE PROPERTY OWNER.
- FINISHED LAWN AREA UPON WHICH EARTH HAS BEEN DEPOSITED SHALL BE CLEARED TO THE LEVEL OF THE EXISTING SOD, RAKED AND WATERED. AREAS WHERE SOD HAS BEEN DAMAGED, DESTROYED, OR RUTS HAVE BEEN FILLED IN, SHALL BE RE-SODED. AREAS WHERE SOD IS ONLY SLIGHTLY DAMAGED MAY BE LIGHTLY RE-SEED, IF SO PERMITTED. ANY FENCES DISTURBED OUTSIDE THE CONSTRUCTION LINES WILL BE REPLACED TO THE SATISFACTION OF THE ENGINEER.

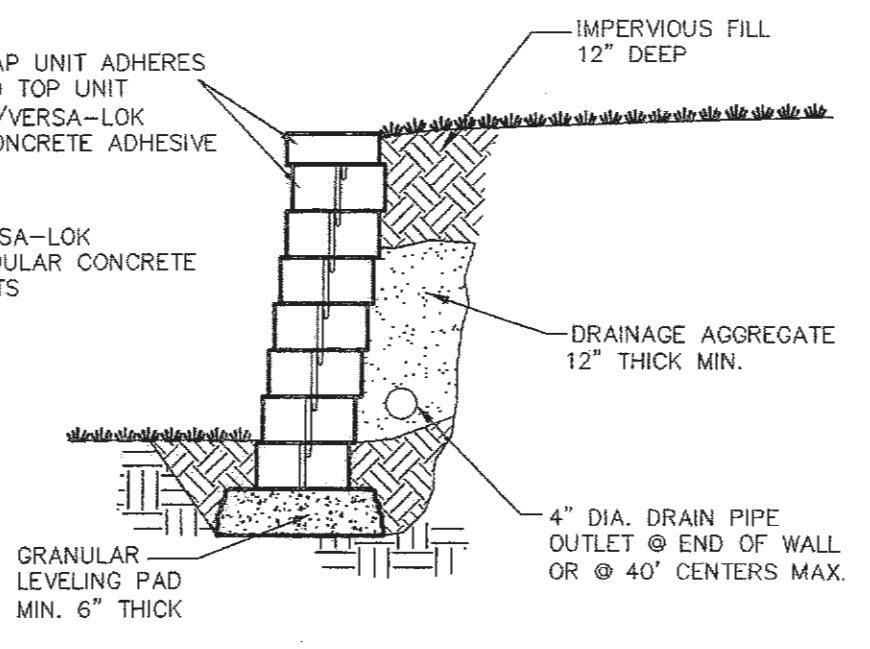

**TYPICAL SECTION-UNREINFORCED RETAINING WALL**  
NO SCALE

- (SECTION 400.425 OF ARTICLE X)
- FOR COMMERCIAL ZONING DISTRICTS WHICH ABUT ANY RESIDENTIALLY ZONED PROPERTY OR PROPERTY FOR FUTURE RESIDENTIAL DEVELOPMENT BY THE CITY'S COMPREHENSIVE PLAN, THE FOLLOWING TWENTY (20) FOOT BUFFER YARD SHALL BE PROVIDED:
- FOR EVERY ONE HUNDRED (100) FEET OF FRONTAGE WHERE THE BUFFER YARD IS REQUIRED: A TOTAL OF TWO (2) PLANT UNITS AND A SIGHT PROOF, SIX (6) FOOT HIGH FENCE AS APPROVED BY THE PLANNING AND ZONING COMMISSION SHALL BE PROVIDED.
- A PLANT UNIT SHALL CONSIST OF A COMBINATION OF LANDSCAPE MATERIALS WHICH SHALL EQUAL THIRTY (30) POINTS WHERE DECIDUOUS CANOPY TREES MEASURING TWO (2) TO TWO AND ONE-HALF (2.5) INCH CALIPER EQUALS TEN (10) POINTS EACH, EVERGREEN TREES MEASURING SIX (6) TO EIGHT (8) FEET TALL EQUAL TEN (10) POINTS EACH, ORNAMENTAL DECIDUOUS TREES MEASURING ONE AND ONE-HALF (1.5) TO TWO (2) INCH CALIPER EQUAL FIVE (5) POINTS EACH, AND SHRUBS MEASURING EIGHTEEN (18) TO TWENTY-FOUR (24) INCHES TALL OR THREE (3) TO FOUR (4) FEET WIDE EQUAL ONE (1) POINT EACH. ALL SIZES SPECIFIED ARE AT THE TIME OF PLANTING.

**GENERAL NOTES:**

- COMMERCIAL DISTRICT C-2 REQUIRES ONE (1) TREE FOR EVERY FORTY (40) FEET, OR PORTION THEREOF, OF STREET FRONTAGE, PUBLIC OR PRIVATE, SHALL BE REQUIRED WITHIN THE LANDSCAPE SETBACK ABUTTING SAID FRONTAGE. SAID TREES MAY BE CLUSTERED OR ARRANGED WITHIN THE SETBACK AND NEED NOT BE PLACED EVENLY AT FORTY (40) FOOT INTERVALS. IN ADDITION TO THE REQUIRED TREES, BASED UPON STREET FRONTAGE, ONE (1) TREE SHALL ALSO BE REQUIRED FOR EVERY (3,000) S.F. OF LANDSCAPED OPEN SPACE. THESE MAY INCLUDE TREES REQUIRED IN PARKING LOTS, AS SET OUT IN SUBSECTION (C) OF PLANTING REQUIREMENTS WITHIN PARKING AND VEHICULAR USE AREAS AS DEFINED BY ARTICLE X - LANDSCAPING AND SCREENING REGULATIONS.
- ALL LANDSCAPING SHOWN ON SITE PLAN INDICATES MINIMUM REQUIREMENTS PER CITY OF O'FALLON ZONING ORDINANCE. THE OWNER MAY ADD VEGETATION TO ENHANCE THE APPEARANCE OF THE SITE AT THEIR OWN DISCRETION.
- THIS PROPERTY IS CURRENTLY ZONED C-2 COMMERCIAL BY THE CITY OF O'FALLON, MISSOURI. THE RESTRICTIONS FOR C-2 COMMERCIAL ZONING ARE AS FOLLOWS:  
25' FRONT SETBACK  
5' SIDE SETBACK  
0' REAR SETBACK
- THIS PROPERTY IS SERVICED BY THE FOLLOWING UTILITY COMPANIES:  
AMEREN UE COMPANY  
GTE TELEPHONE COMPANY  
LAKELAND GAS COMPANY  
ST. CHARLES COUNTY WATER DISTRICT NO.2  
DUCKETT CREEK SANITARY SEWER DISTRICT
- ALL SIGN POST AND BACKS AND BRACKET ARMS SHALL BE PAINTED BLACK USING CARBOLINE RUSTBOND PENETRATING SEALER SG AND CARBOLINE 133 HB PAINT (OR EQUIVALENT AS APPROVED BY CITY AND MODOT) SIGNS DESIGNATING STREET NAME SHALL BE ON THE OPPOSITE SIDE OF THE STREET FROM TRAFFIC CONTROL SIGNS.
- NO SLOPES SHALL BE STEEPER THAN 3 (HORIZONTAL) TO 1 (VERTICAL)
- GRADED AREAS THAT ARE TO REMAIN BARE FOR OVER 2 WEEKS SHALL BE SEEDED AND MULCHED PER DNR REQUIREMENTS.
- ALL EROSION CONTROL SYSTEMS SHALL BE INSPECTED AND NECESSARY CORRECTIONS MADE WITHIN 24 HOURS OF ANY RAINSTORM RESULTING IN ONE-HALF INCH OF RAIN OR MORE.
- TRAFFIC CONTROL IS TO BE PER MODOT (MISSOURI STANDARD PLANS FOR HIGHWAY CONSTRUCTION).
- TREES, ORGANIC DEBRIS, RUBBLE, FOUNDATIONS AND OTHER DELETERIOUS MATERIAL SHALL BE REMOVED FROM THE SITE AND DISPOSED IN COMPLIANCE WITH ALL APPLICABLE LAWS AND REGULATIONS. LANDFILL TICKETS FOR SUCH DISPOSAL SHALL BE MAINTAINED ON FILE BY THE DEVELOPER. BURNING ON SITE SHALL BE ALLOWED ONLY BY PERMIT FROM THE LOCAL FIRE DISTRICT. IF A BURN PIT IS PROPOSED THE LOCATION AND MITIGATION SHALL BE SHOWN ON THE GRADING PLAN AND DOCUMENTED BY THE SOILS ENGINEER.
- ALL UTILITIES INCLUDING SANITARY SEWER LATERAL TRENCHES SHALL BE BACKFILLED WITH GRANULAR MATERIAL UNDER ALL PAVED AREAS.
- SIGNAL IMPROVEMENTS OR MODIFICATIONS ARE NOT REQUIRED FOR THIS PROJECT.
- PROVIDE A MARKING ON STORM SEWER INLETS.  
MANUFACTURER: ACP INTERNATIONAL  
SIZE: 3-4 dia.  
ADHESIVE: EPOXY  
STYLE: CRYSTAL CAP  
MESSAGE: "NO DUMPING DRAINS TO WATERWAYS" (SD-W-CC)  
WEBSITE: www.acpinternational.com or www.dasmaufacturing.com
- FLOOD AND FLOOD WAY BOUNDARY DETERMINED FROM FLOOD INSURANCE RATE MAP PANEL 239 DATED AUGUST 2, 1996 AND REVISED SEPTEMBER, 2002 (ZONE "AE" BASE FLOOD ELEVATIONS DETERMINED).
- RIP-RAP SHOWN AT FLARED ENDS WILL BE EVALUATED IN THE FIELD AFTER INSTALLATION FOR EFFECTIVENESS AND FIELD MODIFIED IF NECESSARY TO REDUCE EROSION ON AND OFF SITE.
- DEVELOPER MUST SUPPLY CITY CONSTRUCTION INSPECTORS WITH SOIL REPORTS PRIOR TO OR DURING SITE SOIL TESTING.
- RETAINING WALL:  
SUPPLIER OF RETAINING MATERIAL SHALL SUBMIT TO THE CITY OF O'FALLON (ATTN: JEANNE GREENLEE) STRUCTURAL CALCULATIONS OF THE WALL WITH A 1.5 OVERTURN FACTOR OF SAFETY IN ACCORDANCE WITH INC CODE. SAID CALCULATIONS SHALL BE SIGNED AND SEALED BY A PROFESSIONAL ENGINEER.

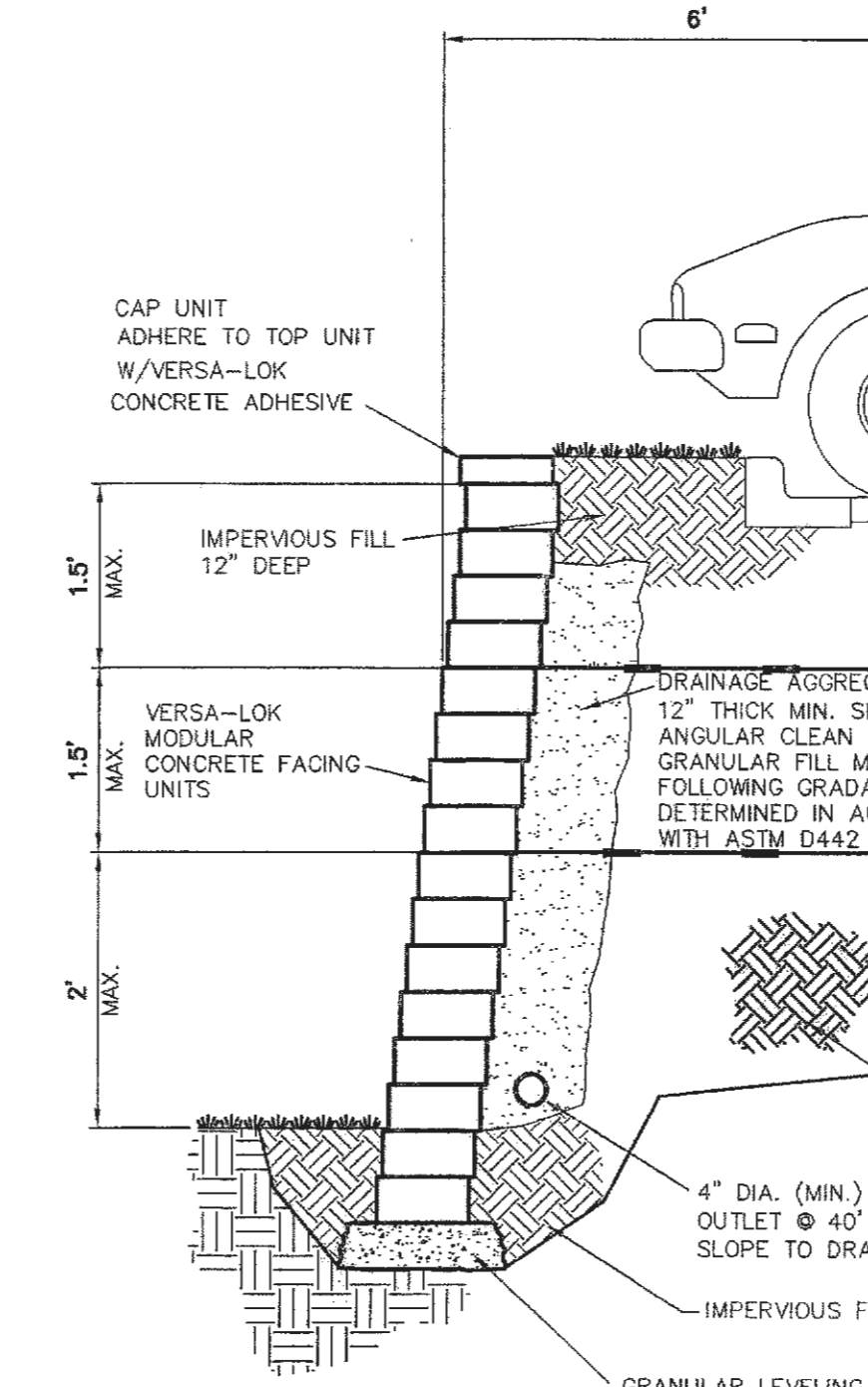

**TYPICAL SECTION REINFORCED RETAINING WALL 4 TO 5 FT. IN HEIGHT**  
MODULAR CONCRETE UNIT  
SCALE: NONE

**SOILS NOTES:**

- DEVELOPER MUST SUPPLY CITY CONSTRUCTION INSPECTORS WITH SOIL REPORTS PRIOR TO OR DURING SITE SOIL TESTING.
- THE SOIL REPORT WILL BE REQUIRED TO CONTAIN THE FOLLOWING INFORMATION ON SOIL TEST CURVES (PROCTOR REPORTS) FOR PROJECTS WITH THE CITY.
  - MAXIMUM DRY DENSITY
  - OPTIMUM MOISTURE CONTENT
  - MAXIMUM AND MINIMUM ALLOWABLE MOISTURE CONTENT.
  - CURVE MUST BE PLOTTED TO SHOW DENSITY FROM A MINIMUM OF 90% COMPACTION AND ABOVE AS DETERMINED BY THE "MODIFIED AASHTO T-180 COMPACTION TEST" (A.S.T.M.-D-1157) OR FROM A MINIMUM 95% AS DETERMINED BY THE "STANDARD PROCTOR TEST AASHTO T-99, METHOD C" (A.S.T.M.-D-698).
  - PROCTOR MUST BE DESIGNED ON DOCUMENT.
  - CURVE MUST HAVE AT LEAST 5 DENSITY POINTS WITH MOISTURE CONTENT AND SAMPLE LOCATIONS LISTED ON DOCUMENT.
  - SPECIFIC GRAVITY.
  - NATURAL MOISTURE CONTENT
  - LIQUID LIMIT
  - PLASTIC LIMIT

BE ADVISED THAT IF THIS INFORMATION IS NOT PROVIDED TO THE CITY'S CONSTRUCTION INSPECTOR THE CITY WILL NOT ALLOW GRADING OR CONSTRUCTION ACTIVITIES TO PROCEED ON ANY PROJECT SITE.

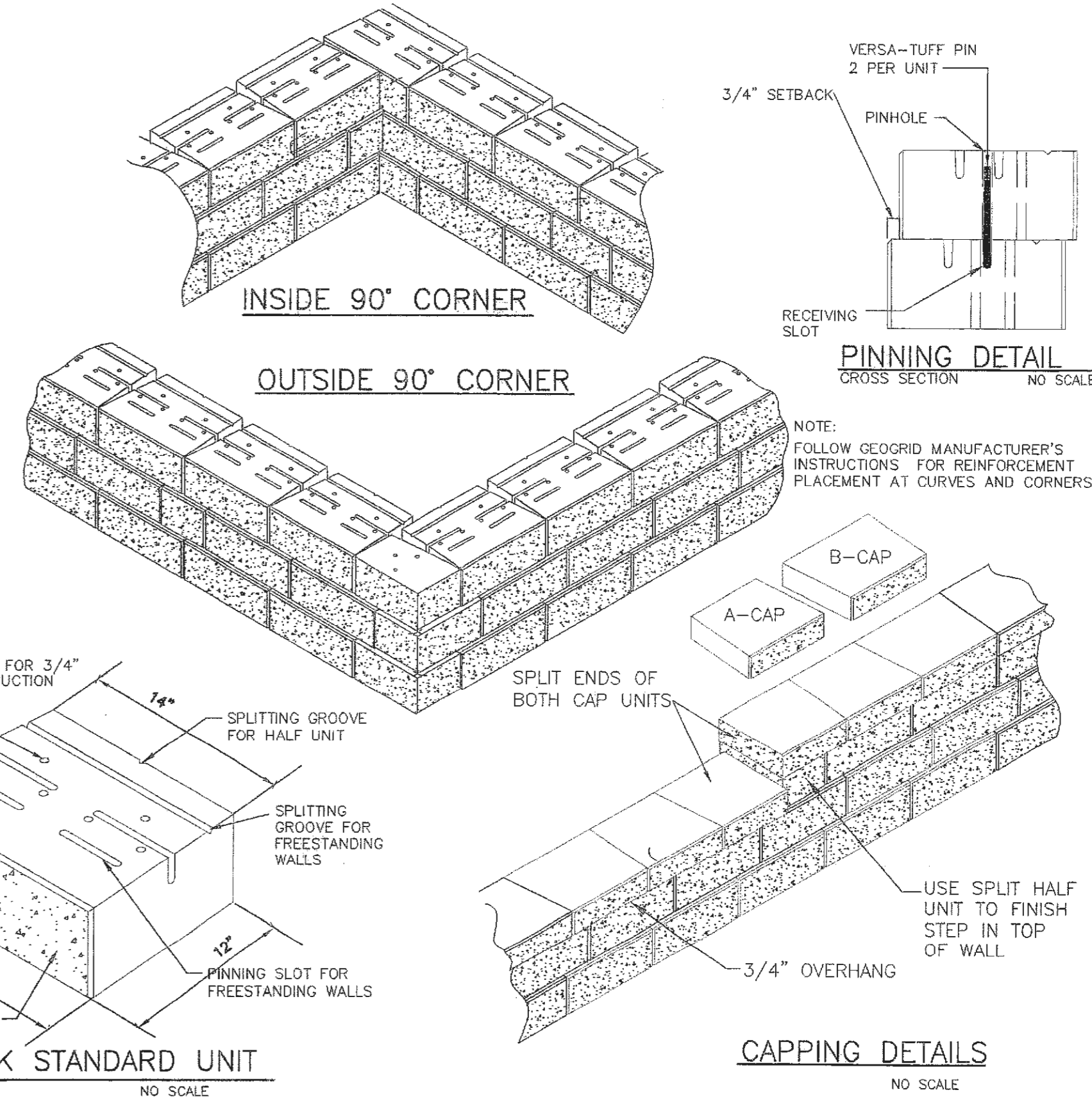
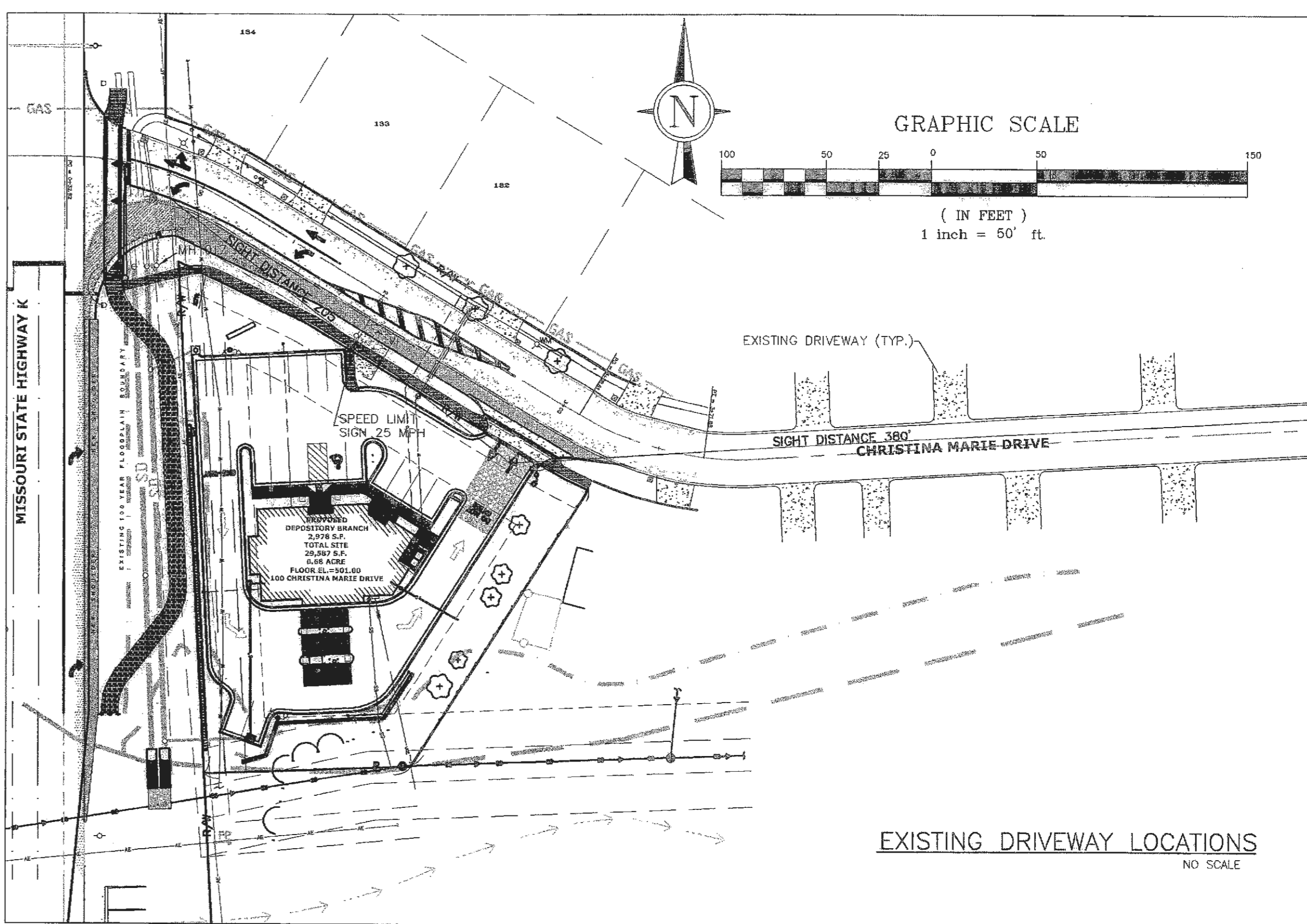

**VERSALO-K STANDARD UNIT**  
NO SCALE

**CAPPING DETAILS**  
NO SCALE



Missouri One Call System, Inc.  
Call Before You Dig!  
FIBER OPTICS ARE PRESENT  
MoDOT 1-314-340-4100  
1-800-DIG-RITE  
(1-800-344-7483)

CITY PLANNING & ENGINEERING FILE# 0506  
DEVELOPMENT PLAN APPROVED APRIL 20, 2008

This document shall remain the property of Buescher Ditch and Associates, Inc. (BDA) and may not be used by any other party without the written consent of said BDA.

**REVISIONS**

NO.	DATE	DESCRIPTION

**BUESCHER DITCH & ASSOCIATES, INC.**  
2 East Fifth Street, P.O. Box 621, Washington, Missouri 63090  
Telephone: 1-636-239-7681  
E-mail: www.buescherditch.com

**GENERAL NOTES**  
SIGNATURE BANK OF O'FALLON  
ST. CHARLES COUNTY, MISSOURI

11/15/06

6-19-06  
DATE  
06033  
PROJECT NUMBER  
SITE DEV. PLANS.DWG  
FILE NAME  
10 of 16  
SHEET OF  
GMM  
DRAWN CHECKED