

DETENTION BASIN CROSS SECTIONS

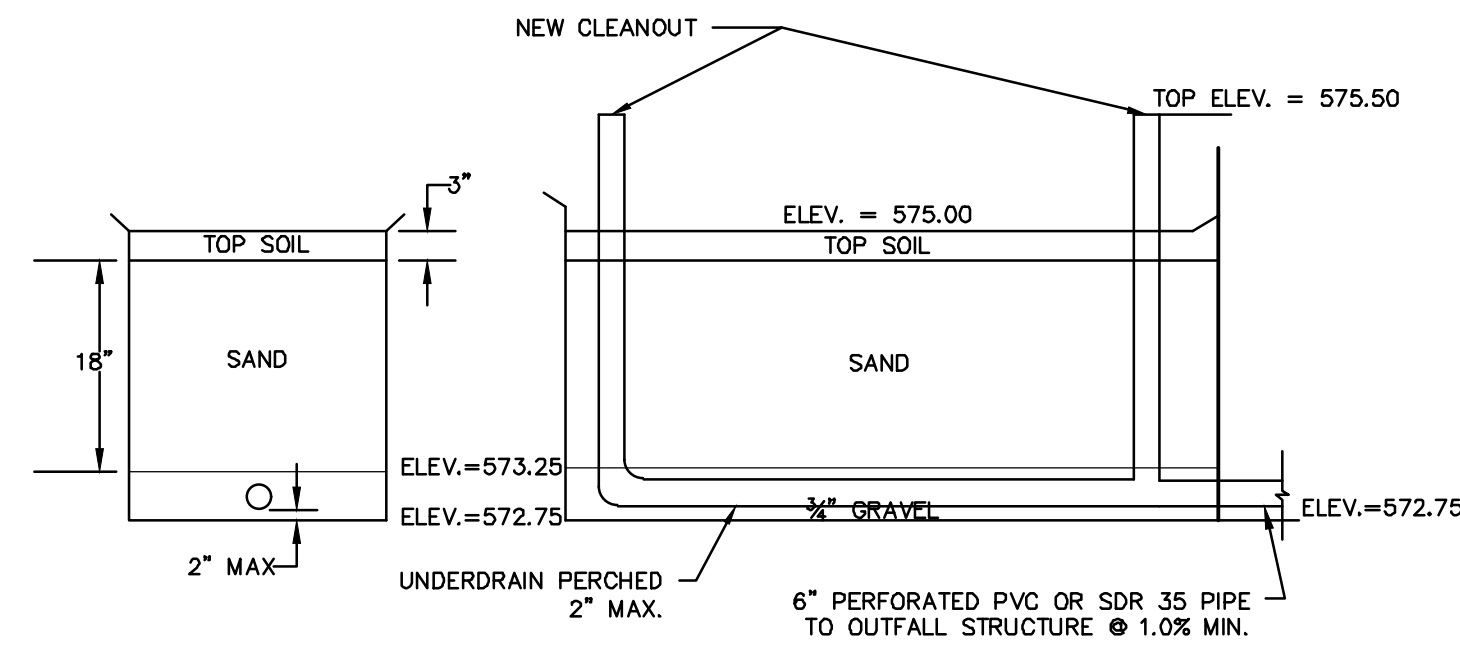

SURFACE SAND FILTER TRAP DETAIL
NO SCALE

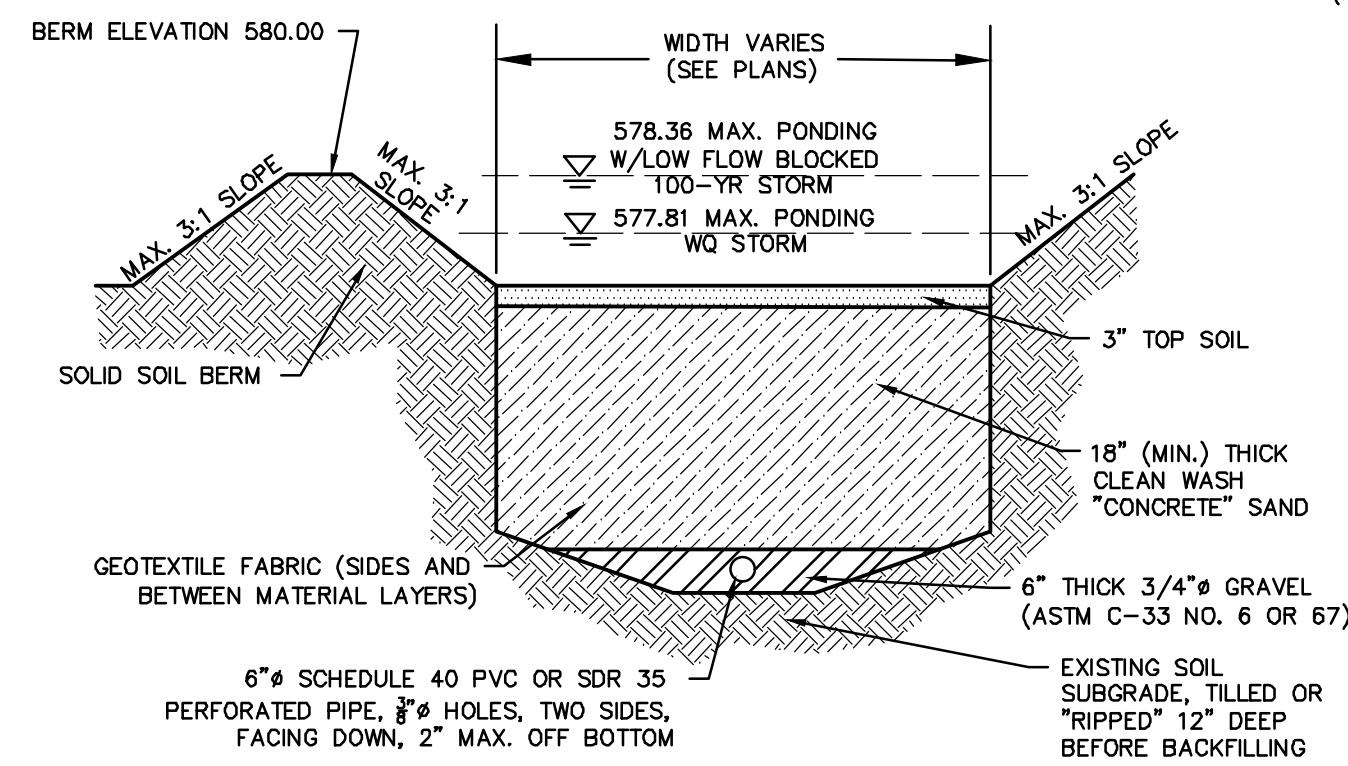

SURFACE SAND FILTER DETAIL
NO SCALE

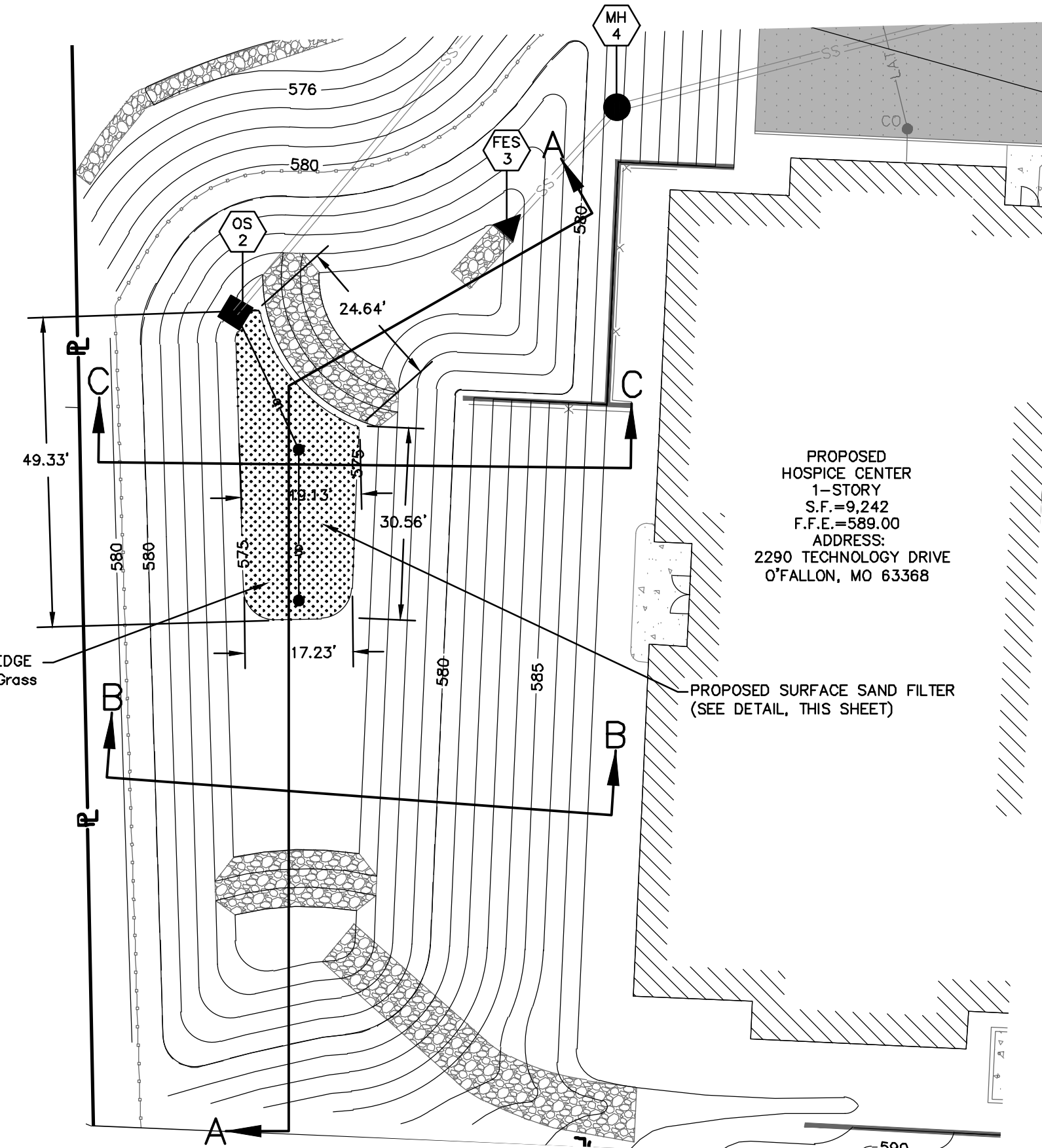

PLAN VIEW

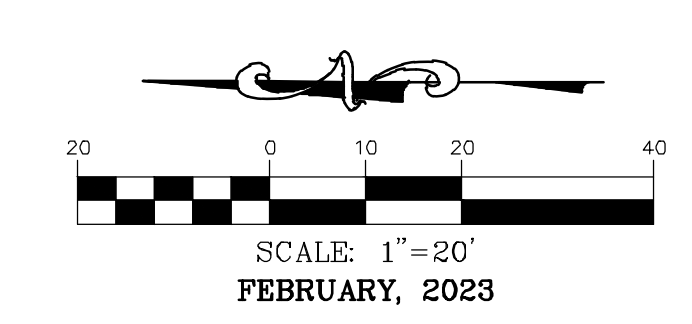

PLANT SCHEDULE

QTY.	I.D.	COMMON NAME	BOTANICAL NAME	SPACING
SAND FILTER PLANTINGS				
38		Switchgrass	<i>Panicum virgatum</i>	2.5'
37		Shining bluestar	<i>Amsonia illustris</i>	2.5'
37		Slender bush clover	<i>Lespedeza virginica</i>	2.5'

Note: Contractor responsible for quantity of plants and materials based upon the plan. Quantities in plant schedule are estimates only.

SPACING 'FT'	ROW 'IN'	NUMBER OF PLANTINGS 'FT'
30'	25"	180
24'	20.8"	28
18'	15.6"	40
12'	10.4"	60
12'	10.4"	100
12'	6.88"	144
8'	6.88"	225

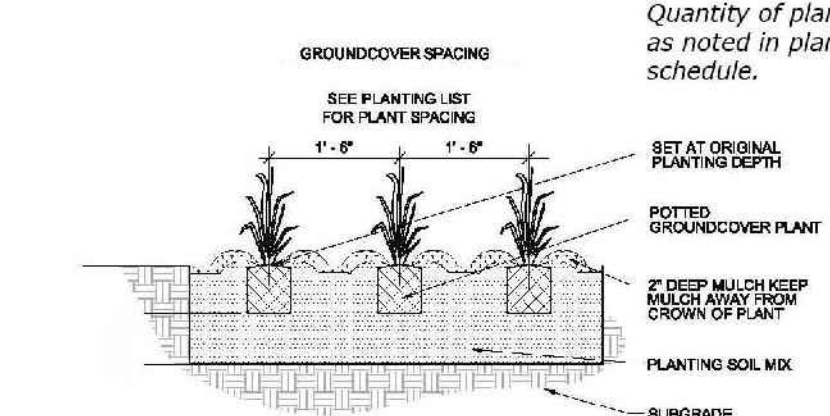
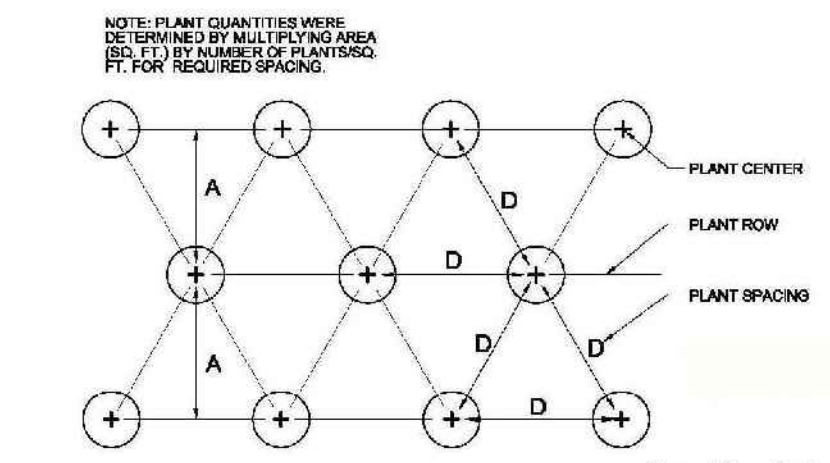

Plant Spacing Plan
Figure 9
Planting Detail Courtesy of Ted Spald
SWT Design, St. Louis, MO

NOTE:
100YR STORM ELEVATION IS CALCULATED USING LOW FLOW BLOCKED CONDITION.

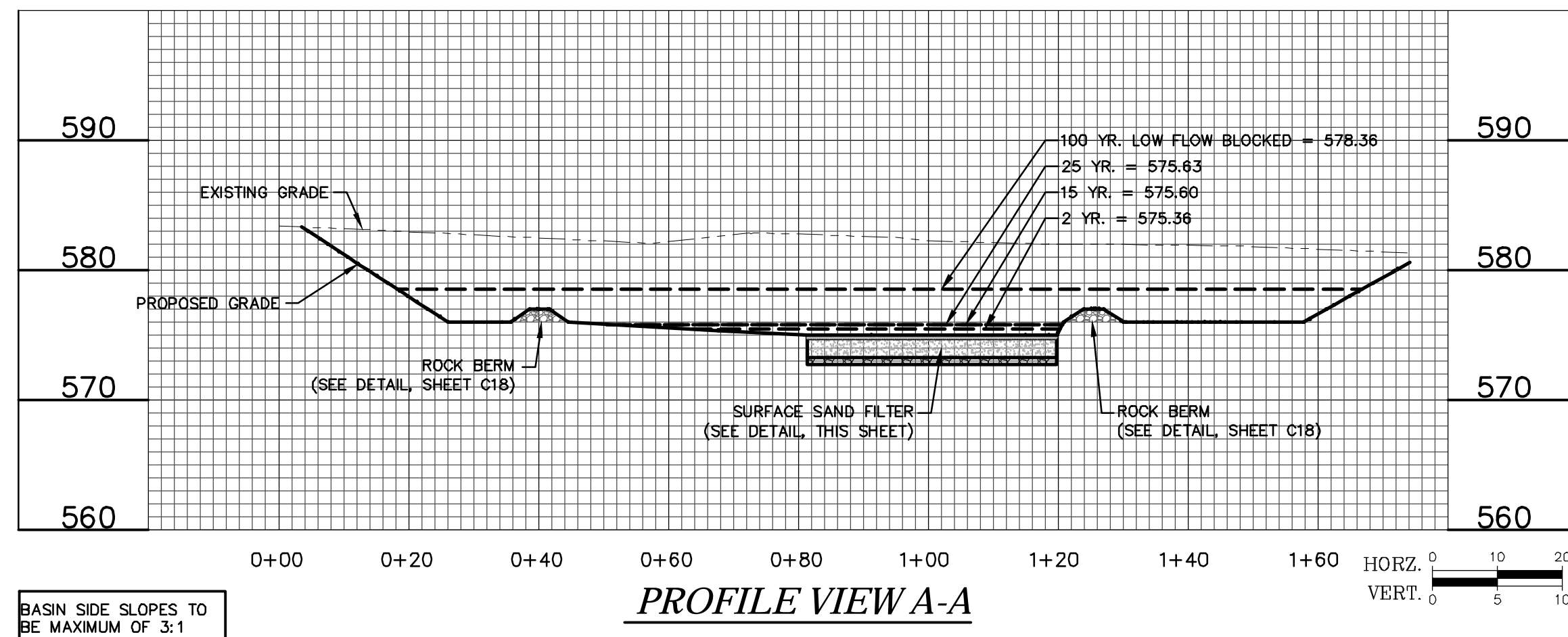

PROFILE VIEW A-A

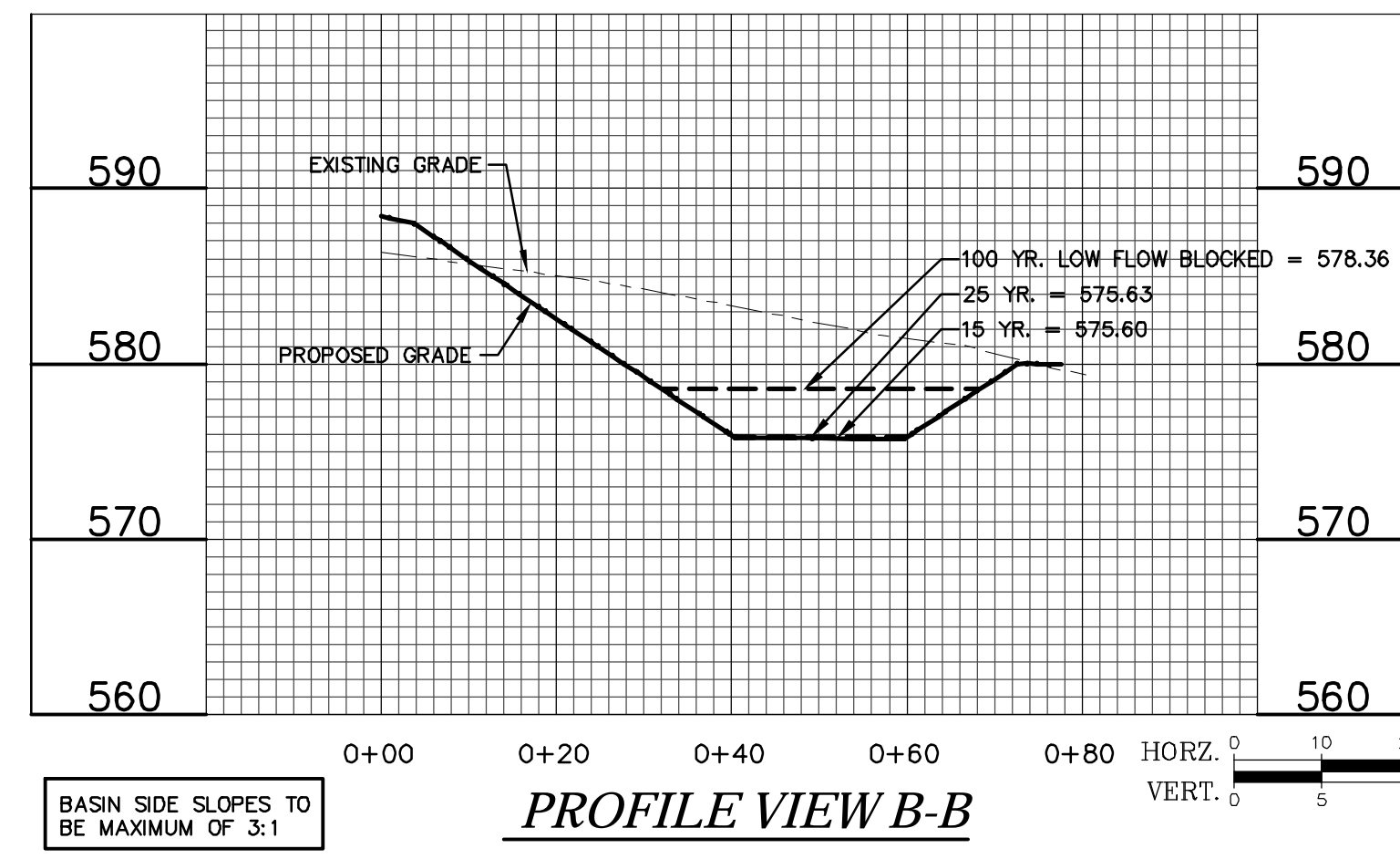

PROFILE VIEW B-B

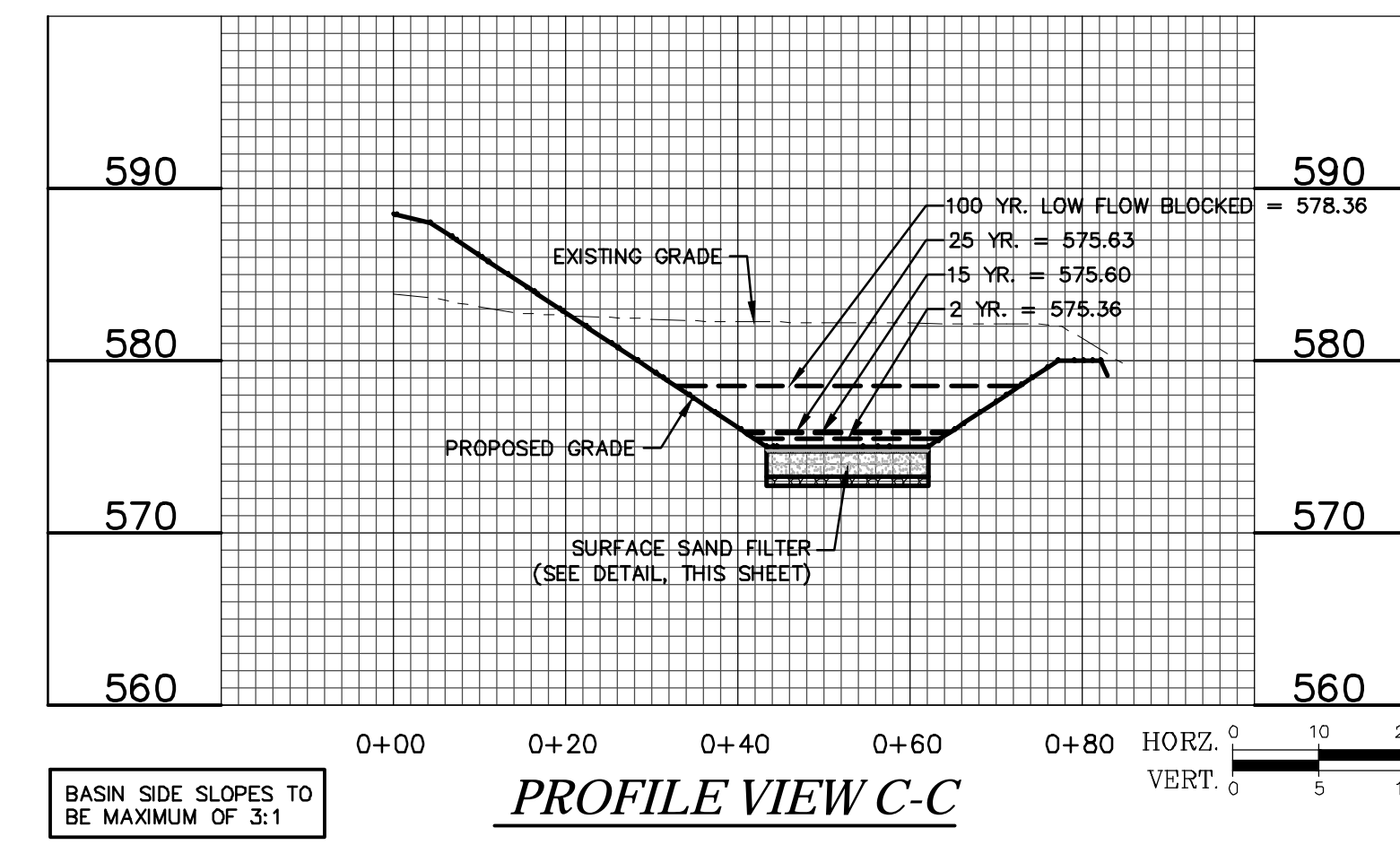

PROFILE VIEW C-C

BASIN SIDE SLOPES TO BE MAXIMUM OF 3:1

BASIN SIDE SLOPES TO BE MAXIMUM OF 3:1

BASIN SIDE SLOPES TO BE MAXIMUM OF 3:1

SOLACE HOSPICE CARE



636-332-4574 (tel.)
636-327-0760 (fax)
www.missouricochran.com
63395
North Office
8 East Main Street
Wentzville, Missouri

COCHRAN

- Civil Engineering
- Land Surveying
- Architecture
- Site Development
- General Consulting
- Master Planning

Missouri State Certificate of Authority Number: 2010000046
Cochran Project No. M22-8498

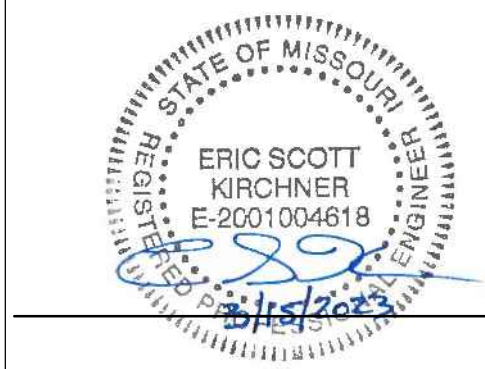

DATE
Eric S. Kirchner No. E-2001004618
Registered Professional Engineer
State of Missouri
for Cochran Engineering & Surveying

Developer Information
HV PROPERTY MANAGEMENT, LLC
14010 MANCHESTER RD, MANCHESTER, MO 63011

Owner Information
HV PROPERTY MANAGEMENT, LLC
14010 MANCHESTER RD, MANCHESTER, MO 63011

DETENTION BASIN CROSS SECTIONS

P+Z No. 22-008964
Approval Date: NOV. 3, 2022
Permit No.

Page No.
C10A

OWNER/DEVELOPER:
HV PROPERTY MANAGEMENT, LLC
14010 MANCHESTER RD.
MANCHESTER, MO 63011

CALL OR CLICK 3 DAYS BEFORE YOU DIG!
MISSOURI
1-800-DIG-RITE OR 811
www.motcall.com

City of O'Fallon Standard Notes and Details - June 2010