

STORM SEWER PLAN AND PROFILE

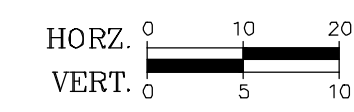

SOLACE HOSPICE CARE

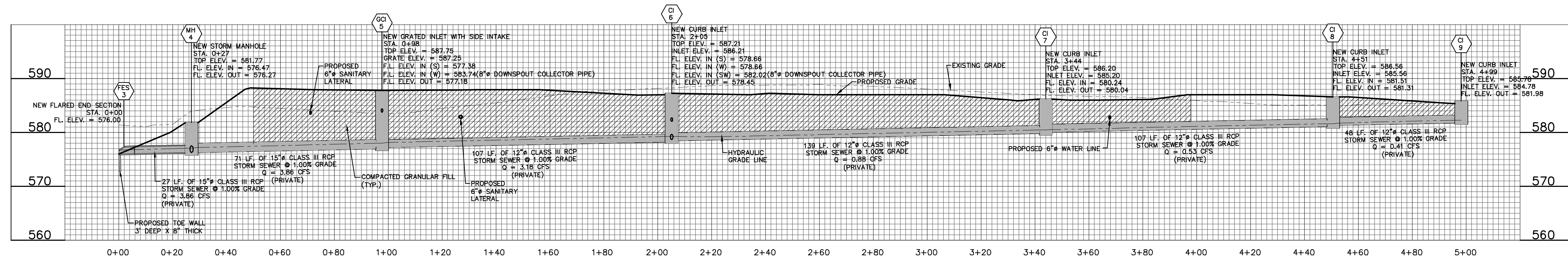
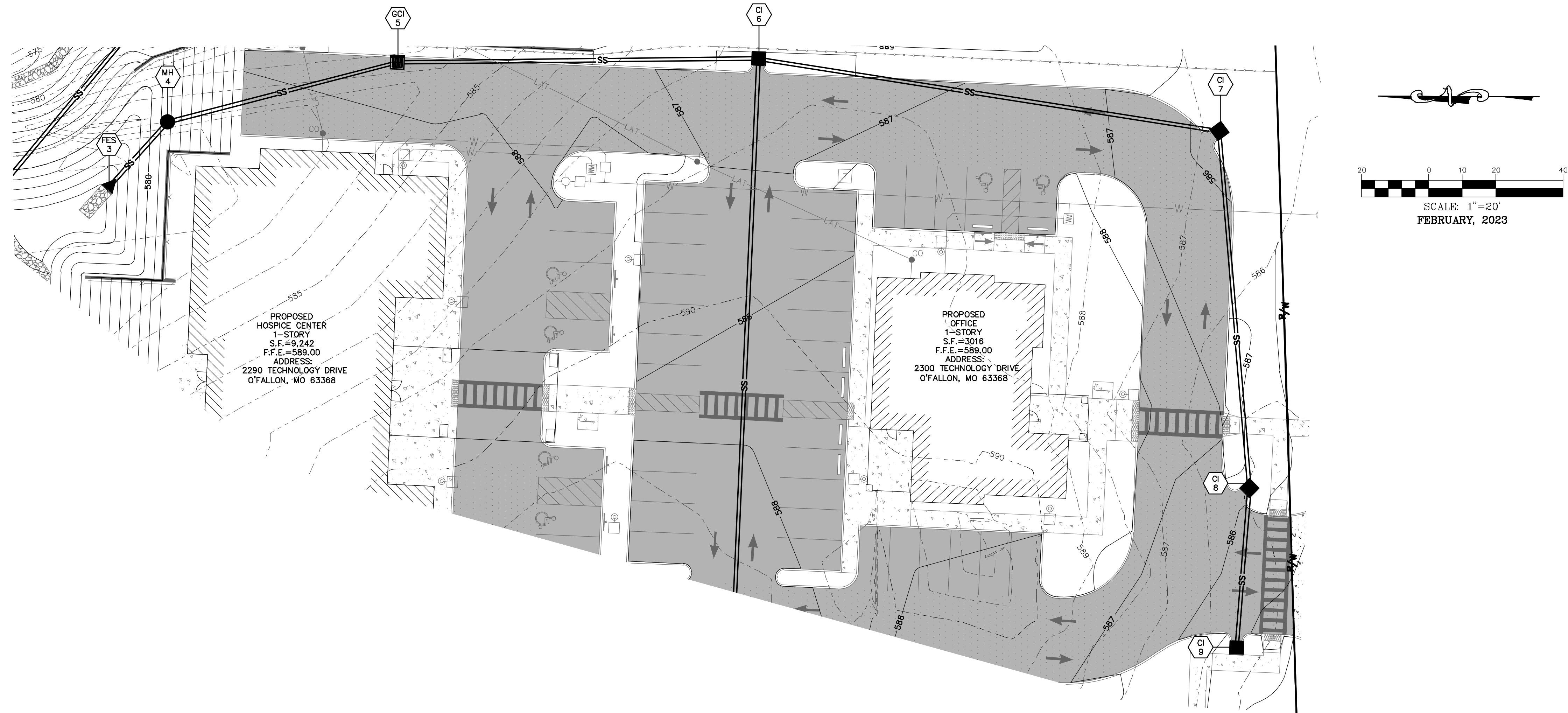

636-332-4574 (tel.)
636-327-0760 (fax)
636-327-0760 (cell)
www.solacehospice.com

- Civil Engineering
- Land Surveying
- Architecture
- Site Development
- General Consulting
- Master Planning



Missouri State Certificate
of Authority Number: 2010000046
Cochran Project No. M22-8498



DATE
Eric S. Kirchner No. E-2001004618
Registered Professional Engineer
State of Missouri
for Cochran Engineering & Surveying

Developer Information
HV PROPERTY MANAGEMENT, LLC
14010 MANCHESTER RD, MANCHESTER, MO 63011

Owner Information
HV PROPERTY MANAGEMENT, LLC
14010 MANCHESTER RD, MANCHESTER, MO 63011

STORM SEWER PLAN AND PROFILE

P+Z No. 22-008964
Approval Date: NOV. 3, 2022
Permit No.

Page No.

C10

CALL OR CLICK 3 DAYS BEFORE YOU DIG!
MISSOURI
1-800-DIG-RITE OR 811
www.motcall.com

City of O'Fallon Standard Notes and Details - June 2010

OWNER/DEVELOPER:
HV PROPERTY MANAGEMENT, LLC
14010 MANCHESTER RD.
MANCHESTER, MO 63011