

Scale in Feet  
Scale: 1"=60'

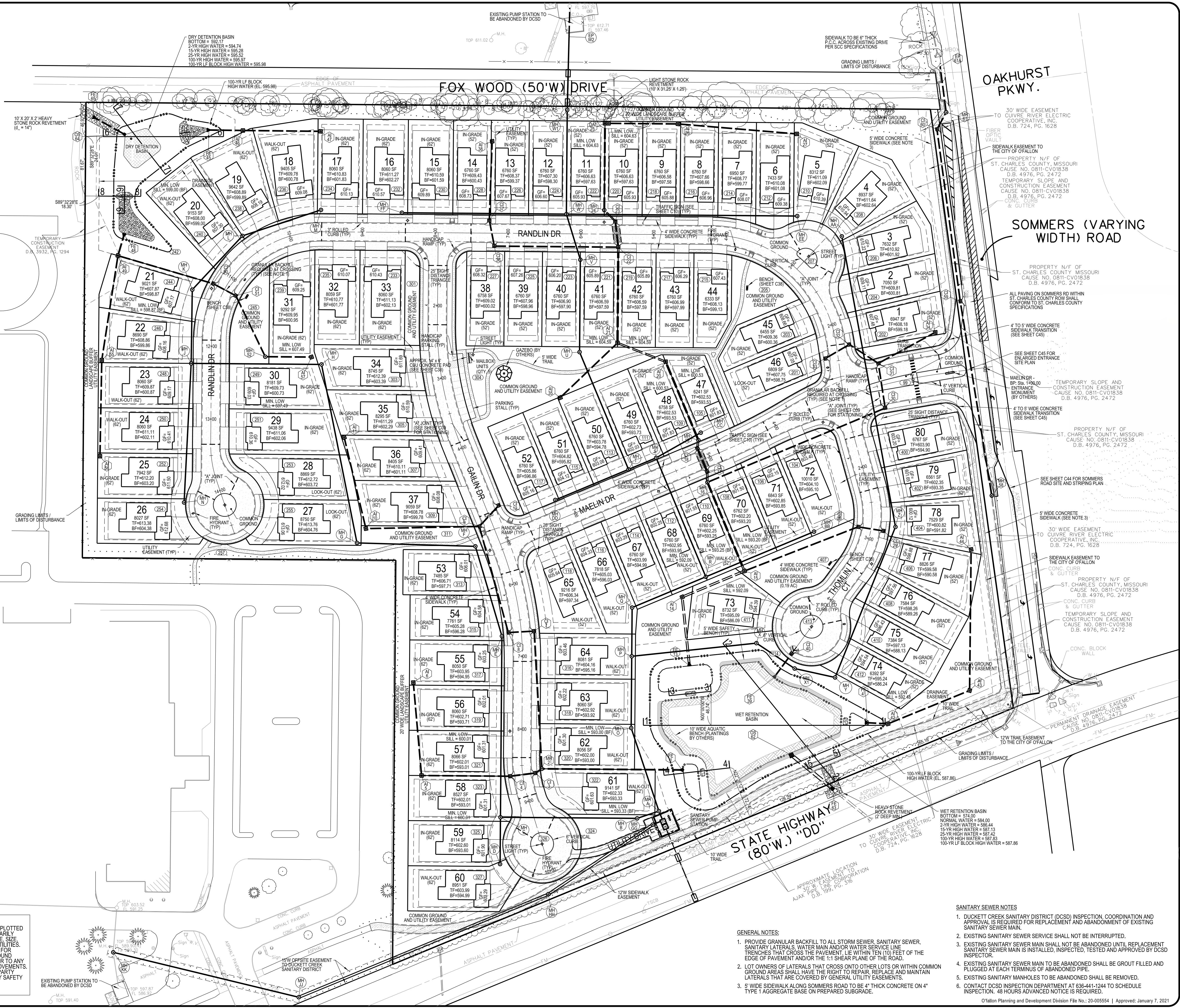

OAKHURST PKWY.  
30' WIDE EASEMENT TO CUIVRE RIVER ELECTRIC COOPERATIVE, INC. D.B. 724, PG. 1628

SOMMERS (VARYING WIDTH) ROAD

PROPERTY N/F OF ST. CHARLES COUNTY, MISSOURI CAUSE NO. 0811-CV01838 D.B. 4976, PG. 2472

PROPERTY N/F OF ST. CHARLES COUNTY, MISSOURI CAUSE NO. 0811-CV01838 D.B. 4976, PG. 2472

PROPERTY N/F OF ST. CHARLES COUNTY, MISSOURI CAUSE NO. 0811-CV01838 D.B. 4976, PG. 2472

PROPERTY N/F OF ST. CHARLES COUNTY, MISSOURI CAUSE NO. 0811-CV01838 D.B. 4976, PG. 2472

PROPERTY N/F OF ST. CHARLES COUNTY, MISSOURI CAUSE NO. 0811-CV01838 D.B. 4976, PG. 2472

PROPERTY N/F OF ST. CHARLES COUNTY, MISSOURI CAUSE NO. 0811-CV01838 D.B. 4976, PG. 2472

PROPERTY N/F OF ST. CHARLES COUNTY, MISSOURI CAUSE NO. 0811-CV01838 D.B. 4976, PG. 2472

PROPERTY N/F OF ST. CHARLES COUNTY, MISSOURI CAUSE NO. 0811-CV01838 D.B. 4976, PG. 2472

PROPERTY N/F OF ST. CHARLES COUNTY, MISSOURI CAUSE NO. 0811-CV01838 D.B. 4976, PG. 2472

PROPERTY N/F OF ST. CHARLES COUNTY, MISSOURI CAUSE NO. 0811-CV01838 D.B. 4976, PG. 2472

PROPERTY N/F OF ST. CHARLES COUNTY, MISSOURI CAUSE NO. 0811-CV01838 D.B. 4976, PG. 2472

PROPERTY N/F OF ST. CHARLES COUNTY, MISSOURI CAUSE NO. 0811-CV01838 D.B. 4976, PG. 2472

PROPERTY N/F OF ST. CHARLES COUNTY, MISSOURI CAUSE NO. 0811-CV01838 D.B. 4976, PG. 2472

PROPERTY N/F OF ST. CHARLES COUNTY, MISSOURI CAUSE NO. 0811-CV01838 D.B. 4976, PG. 2472

PROPERTY N/F OF ST. CHARLES COUNTY, MISSOURI CAUSE NO. 0811-CV01838 D.B. 4976, PG. 2472

CALL MISSOURI ONE CALL SYSTEMS INC. TWO FULL WORKING DAYS IN ADVANCE OF STARTING

THE UNDERGROUND UTILITIES SHOWN HEREIN WERE PLOTTED FROM AVAILABLE INFORMATION AND DO NOT NECESSARILY REFLECT THE ACTUAL EXISTENCE, OR NON EXISTENCE, SIZE, TYPE, NUMBER, OR LOCATION OF THESE OR OTHER UTILITIES. THE GENERAL CONTRACTOR SHALL BE RESPONSIBLE FOR VERIFYING THE ACTUAL LOCATION OF ALL UNDERGROUND UTILITIES IN THE FIELD, SHOWN OR NOT SHOWN, PRIOR TO ANY GRADING, EXCAVATION, OR CONSTRUCTION OR IMPROVEMENTS. THESE PROVISIONS SHALL IN NO WAY ABSOLVE ANY PARTY FROM COMPLYING WITH THE UNDERGROUND FACILITY SAFETY AND DAMAGE PREVENTION ACT, CHAPTER 319, RSMO.

WORK MISSOURI ONE-CALL 1-800-344-7483

GENERAL NOTES:

- PROVIDE GRANULAR BACKFILL TO ALL STORM SEWER, SANITARY SEWER, SANITARY LATERALS, WATER MAIN AND/OR WATER SERVICE LINE TRENCHES THAT CROSS THE PAVEMENT. LIE WITHIN TEN (10) FEET OF THE EDGE OF PAVEMENT AND/OR THE 1:1 SHEAR PLANE OF THE ROAD.
- LOT OWNERS OF LATERALS THAT CROSS ONTO OTHER LOTS OR WITHIN COMMON GROUND AREAS SHALL HAVE THE RIGHT TO REPAIR, REPLACE AND MAINTAIN LATERALS THAT ARE COVERED BY GENERAL UTILITY EASEMENTS.
- 3' WIDE SIDEWALK ALONG SOMMERS ROAD TO BE 4" THICK CONCRETE ON 4" TYPE 1 AGGREGATE BASE ON PREPARED SUBGRADE.

SANITARY SEWER NOTES

- DUCKETT CREEK SANITARY DISTRICT (DCSD) INSPECTION, COORDINATION AND APPROVAL IS REQUIRED FOR REPLACEMENT AND ABANDONMENT OF EXISTING SANITARY SEWER MAIN.
- EXISTING SANITARY SEWER SERVICE SHALL NOT BE INTERRUPTED.
- EXISTING SANITARY SEWER MAIN SHALL NOT BE ABANDONED UNTIL REPLACEMENT SANITARY SEWER MAIN IS INSTALLED, INSPECTED, TESTED AND APPROVED BY DCSD INSPECTOR.
- EXISTING SANITARY SEWER MAIN TO BE ABANDONED SHALL BE GROUT FILLED AND PLUGGED AT EACH TERMINUS OF ABANDONED PIPE.
- EXISTING SANITARY MANHOLES TO BE ABANDONED SHALL BE SCHEDULED.
- CONTACT DCSD INSPECTION DEPARTMENT AT 636-441-1244 TO SCHEDULE INSPECTION. 48 HOURS ADVANCED NOTICE IS REQUIRED.

**MCKELVEY HOMES**  
Building A Tradition of Excellence Since 1888  
218 Chesterfield Towne Center  
Chesterfield, MO 63005  
Phone: (636) 530-6800

**VOLZ**  
INCORPORATED  
10849 Indian Head Ind. Blvd.  
St. Louis, Missouri 63132  
314.990.1250 FAX  
www.volzinc.com  
Arlinity #203

**RYAN L. HOLMES**  
Professional Engineer  
PE-2017018988

**RYAN L. HOLMES**  
Professional Engineer  
PE-2017018988

**RYAN L. HOLMES**  
Professional Engineer  
PE-2017018988

**RYAN L. HOLMES**  
Professional Engineer  
PE-2017018988

**RYAN L. HOLMES**  
Professional Engineer  
PE-2017018988

**RYAN L. HOLMES**  
Professional Engineer  
PE-2017018988

**RYAN L. HOLMES**  
Professional Engineer  
PE-2017018988

06-28-21  
C05

SITE PLAN

Design By: R/LH  
Drawn By: R/LH  
Checked By: R/LH

Vote Project # 22074

Fallon Planning and Development Division File No.: 20-00554 | Approved: January 7, 2021