

TYPICAL EMERGENCY RELIEF PATH SECTION
N.T.S.

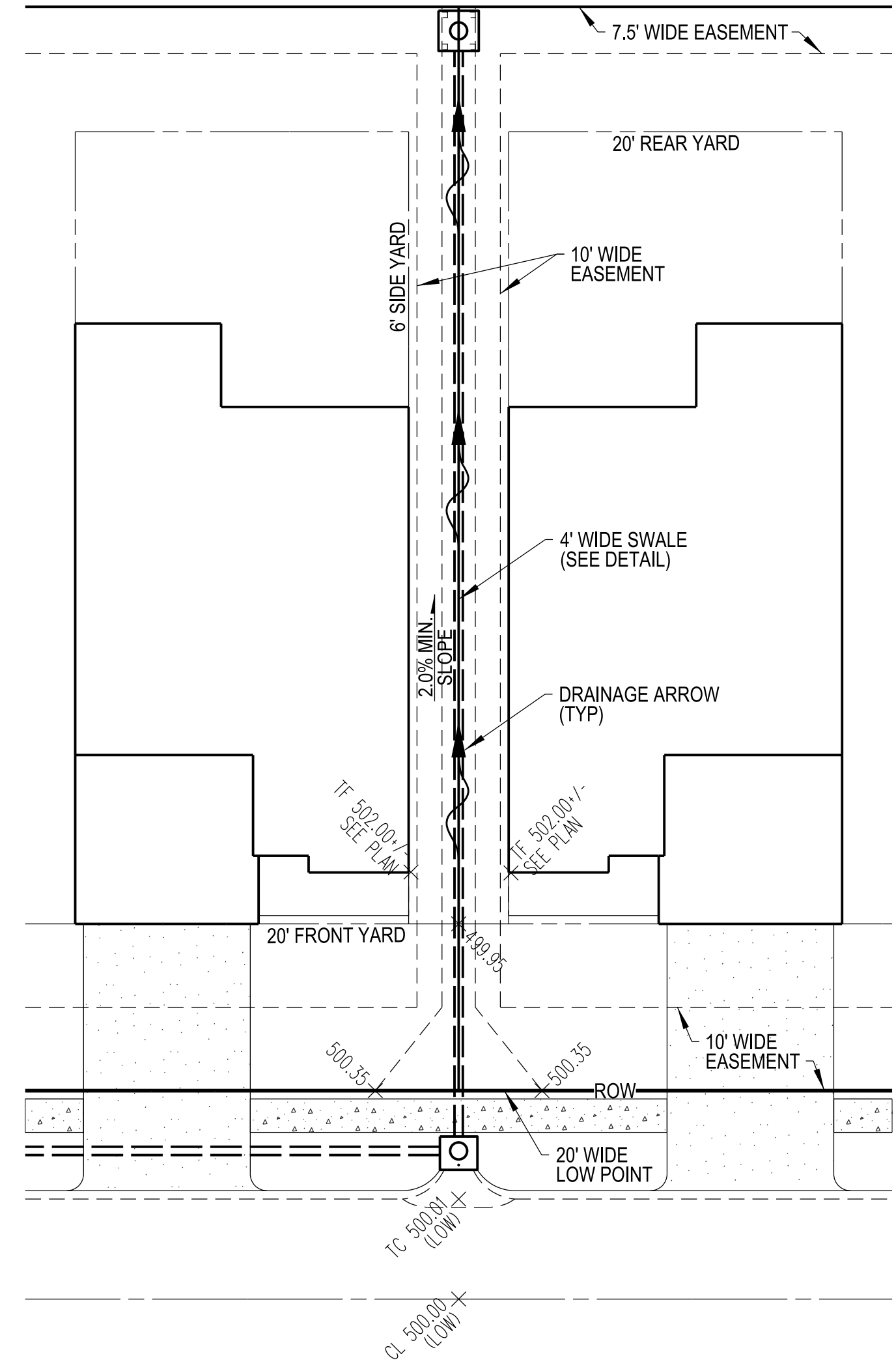

TYPICAL EMERGENCY RELIEF SWALE DETAIL
PLAN VIEW
N.T.S.

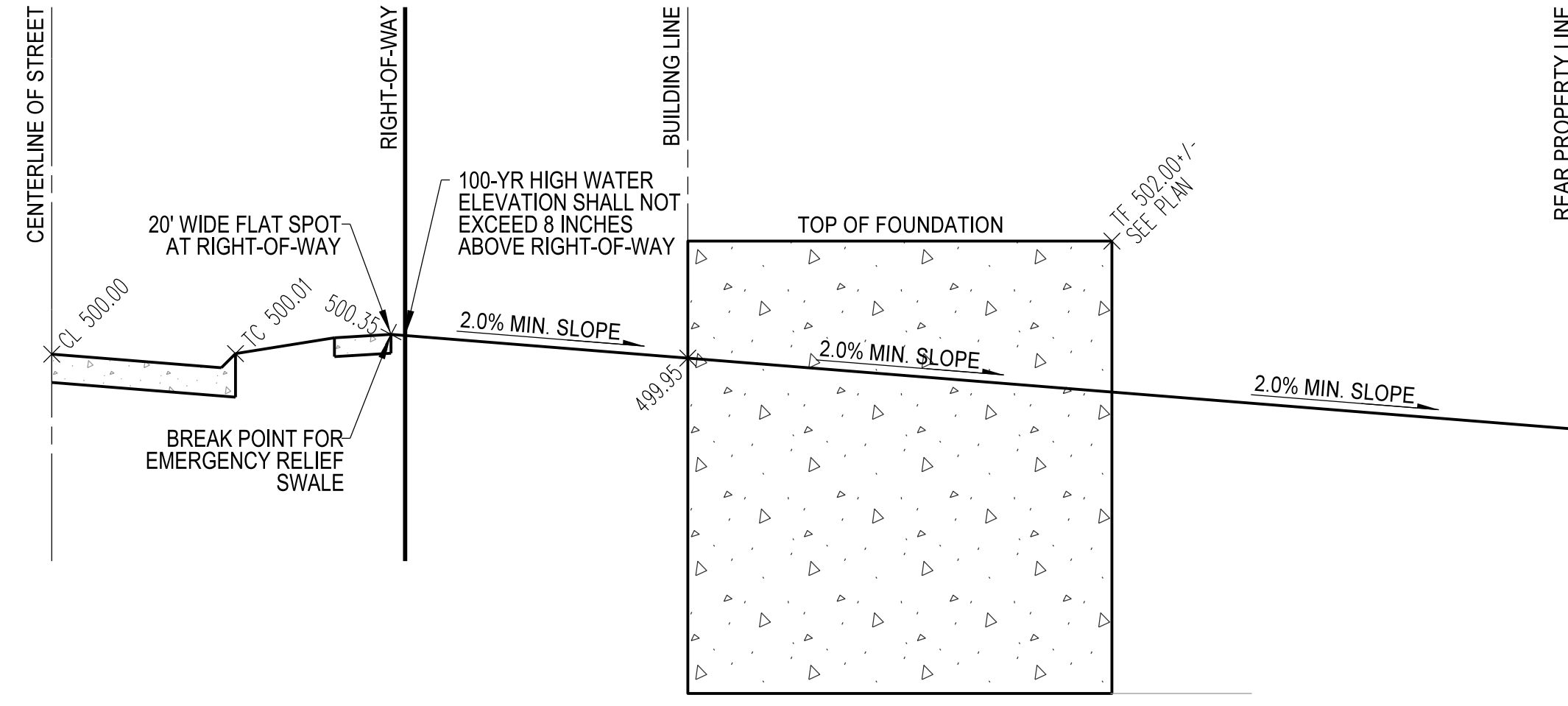

TYPICAL EMERGENCY RELIEF PATH PROFILE
IN-GRADE LOT
N.T.S.

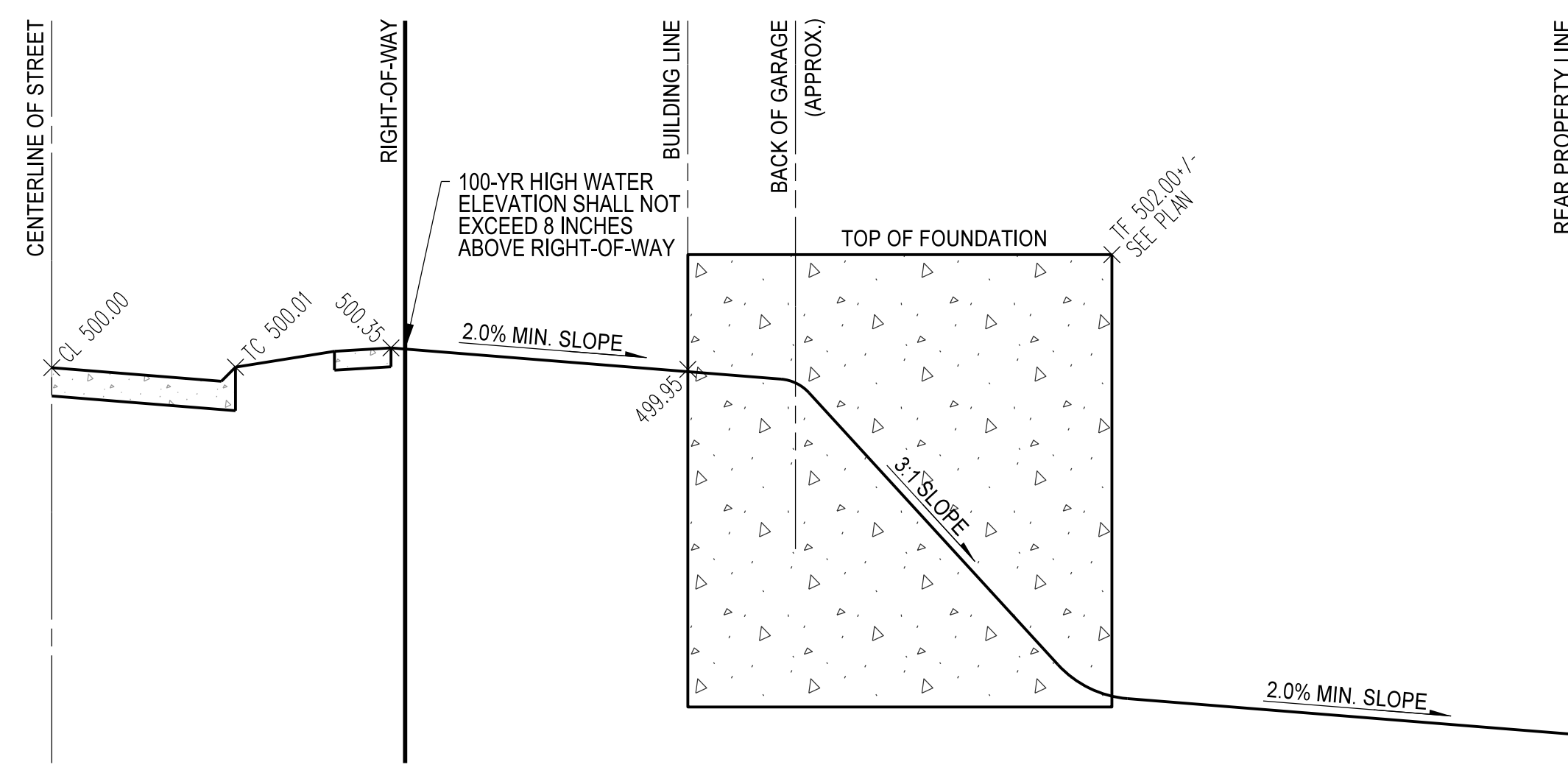

TYPICAL EMERGENCY RELIEF PATH PROFILE
WALK-OUT LOT
N.T.S.

- GENERAL NOTES:
1. THE 100 YEAR STORM WATER FLOW SHALL NOT EXCEED THE LOW SILL ELEVATION OF THE HOUSE OR WINDOW WELLS WILL BE REQUIRED.
 2. TYPICAL SIDE YARD SWALES BETWEEN HOUSES SHALL BE 6" DEEP AND GENERALLY LOCATED ALONG THE PROPERTY LINE BETWEEN THE HOUSES.

CALL MISSOURI ONE CALL SYSTEMS INC. TWO FULL WORKING DAYS IN ADVANCE OF STARTING

THE UNDERGROUND UTILITIES SHOWN HEREIN WERE PLOTTED FROM AVAILABLE INFORMATION AND DO NOT NECESSARILY REFLECT THE ACTUAL EXISTENCE, OR NON EXISTENCE, SIZE, TYPE, NUMBER, OR LOCATION OF THESE OR OTHER UTILITIES. THE GENERAL CONTRACTOR SHALL BE RESPONSIBLE FOR VERIFYING THE ACTUAL LOCATION OF ALL UNDERGROUND UTILITIES IN THE FIELD, SHOWN OR NOT SHOWN, PRIOR TO ANY GRADING, EXCAVATION, OR CONSTRUCTION OF IMPROVEMENTS. THESE PROVISIONS SHALL IN NO WAY ABSOLVE ANY PARTY FROM COMPLYING WITH THE UNDERGROUND FACILITY SAFETY AND DAMAGE PREVENTION ACT, CHAPTER 319, RSMO.



H:\CAD\22000-22999\22074\ImpPlans\22074 - C29.0 Emergency Relief Path Details.dgn - Detail - 6/29/2021 4:36:55 PM - Plotted by: rholmes - Plot Scale: 10.0000 sf / in - Plot Driver: volz15.pdf.plt;cig Pen Table: volz15.pdf.tbl