

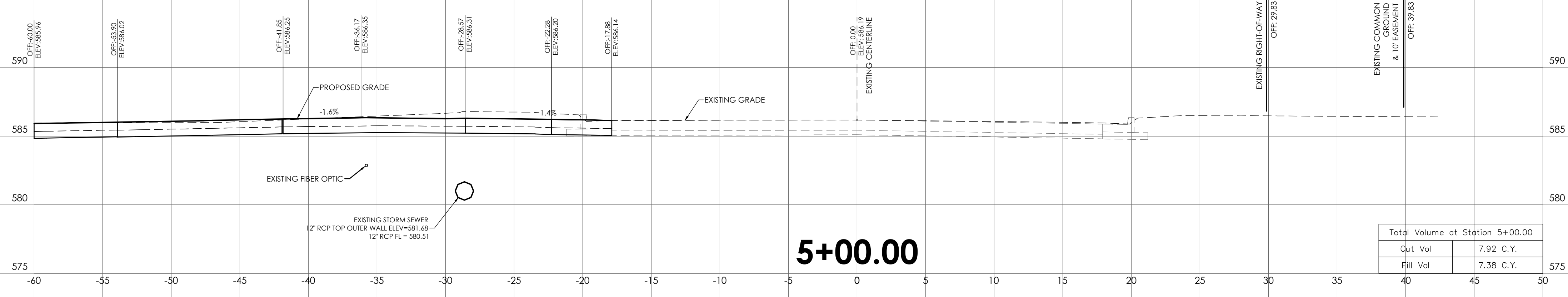
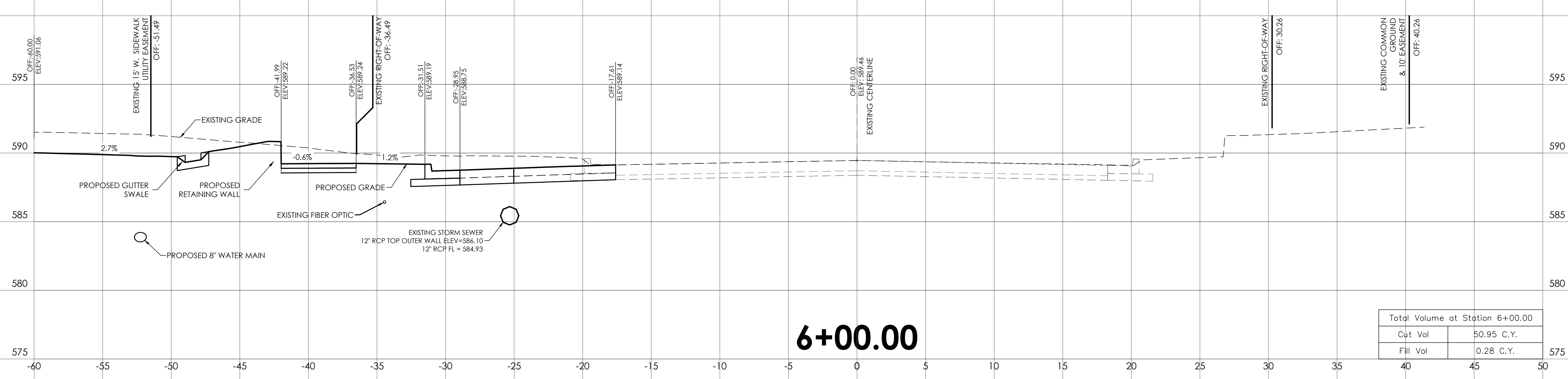

ENGINEERS AUTHENTICATION
The responsibility for the professional engineering activities on this project is hereby limited to the set of plans authorized by the seal, signature, and date hereunder attached. Responsibility is disclaimed for all other engineering plans involved in this project and specifically excludes revisions after the date herein manifested.
STEVEN D. MARION, P.E.
PROFESSIONAL ENGINEER
PE 2006007195

1-800-DIG-RITE
CALL BEFORE YOU DIG

UNDERGROUND UTILITIES AND OSHA SAFETY NOTE:
Underground utilities and structures have been plotted from available information and therefore, their location must be considered approximate only. It is the responsibility of the individual contractors to notify the utility companies before actual construction. All O.S.H.A. rules and regulations established for the type of construction required by these plans shall be strictly followed (i.e. trenching, blasting, etc.)

SOUTH RIDGE SHOPPES, L.L.C.
OLD HIGHWAY N ROAD IMPROVEMENTS
8288 HWY N
OFALLON, MO
NEIL KERSTEN
16761 CONCORD HILL
MARTHASVILLE, MO 63357

Project: **OLD HIGHWAY N ROAD IMPROVEMENTS**
Date: **2-08-2020**

Revision Date	Description of Changes
3. 04-24-20	REVISIONS PER CITY COMMENTS
4. 05-12-20	REVISIONS PER CITY COMMENTS

Sheet Number: **C-313**

Project No. **168305**
Drawn By **A. JONES**
Checked By **J. WINTERS**
NOT RELEASED FOR CONSTRUCTION

1"=5' HORIZONTAL
1"=5' VERTICAL