

ENGINEERS AUTHENTICATION
The responsibility for any professional engineering actions on this project is hereby limited to the set of plans authorized by the seal, signature, and date hereunder attached. Responsibility is disclaimed for all other engineering plans involved in this project and specifically excludes revisions after the date stated hereunder.
STEVEN D. MARION, P.E.
PROFESSIONAL ENGINEER
PE 2006007195

Project
SOUTH RIDGE SHOPPES, L.L.C.
OLD HIGHWAY N ROAD IMPROVEMENTS
8288 HWY N
OFALLON, MO
NEIL KERSTEN
16761 CONCORD HILL
MARTHASVILLE, MO 63357

Date 2-08-2020

Revision Date	Description of Changes
1. 03-20-20	REVISIONS PER CITY'S COMMENTS
2. 04-08-20	REVISIONS PER CITY'S COMMENTS
3. 04-24-20	REVISIONS PER CITY'S COMMENTS
4. 05-12-20	REVISIONS PER CITY'S COMMENTS

Sheet No. C-401
Project No. 168305
Drawn By A. JONES
Checked By J. WINTERS

NOT RELEASED FOR CONSTRUCTION

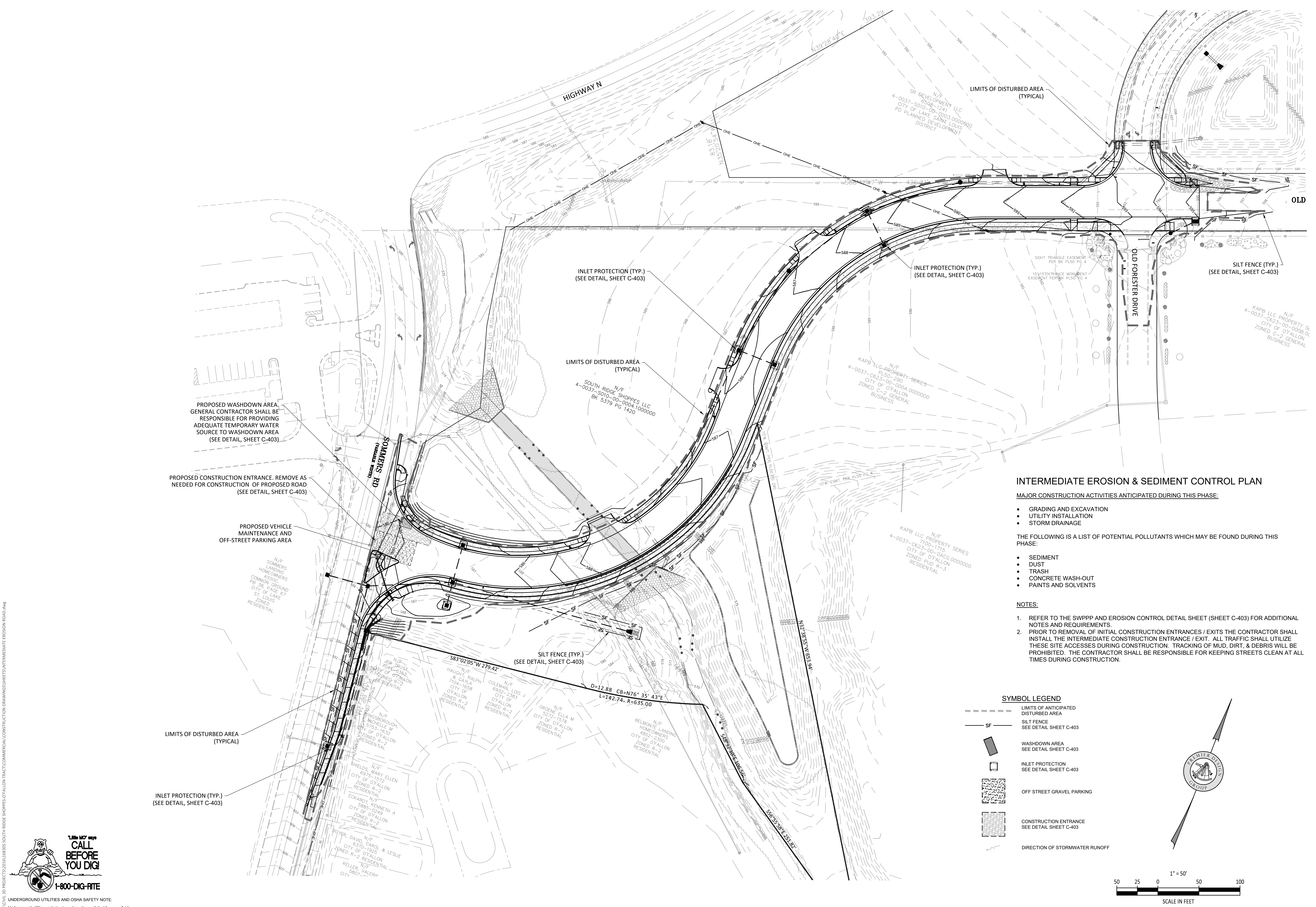

INTERMEDIATE EROSION & SEDIMENT CONTROL PLAN

MAJOR CONSTRUCTION ACTIVITIES ANTICIPATED DURING THIS PHASE:

- GRADING AND EXCAVATION
- UTILITY INSTALLATION
- STORM DRAINAGE

THE FOLLOWING IS A LIST OF POTENTIAL POLLUTANTS WHICH MAY BE FOUND DURING THIS PHASE:

- SEDIMENT
- DUST
- TRASH
- CONCRETE WASH-OUT
- PAINTS AND SOLVENTS

NOTES:

1. REFER TO THE SWPPP AND EROSION CONTROL DETAIL SHEET (SHEET C-403) FOR ADDITIONAL NOTES AND REQUIREMENTS.
2. PRIOR TO REMOVAL OF INITIAL CONSTRUCTION ENTRANCES / EXITS THE CONTRACTOR SHALL INSTALL THE INTERMEDIATE CONSTRUCTION ENTRANCE / EXIT. ALL TRAFFIC SHALL UTILIZE THESE SITE ACCESSES DURING CONSTRUCTION. TRACKING OF MUD, DIRT, & DEBRIS WILL BE PROHIBITED. THE CONTRACTOR SHALL BE RESPONSIBLE FOR KEEPING STREETS CLEAN AT ALL TIMES DURING CONSTRUCTION.

SYMBOL LEGEND

- LIMITS OF ANTICIPATED DISTURBED AREA
- SF SILT FENCE SEE DETAIL SHEET C-403
- WASHDOWN AREA SEE DETAIL SHEET C-403
- INLET PROTECTION SEE DETAIL SHEET C-403
- OFF STREET GRAVEL PARKING
- CONSTRUCTION ENTRANCE SEE DETAIL SHEET C-403
- DIRECTION OF STORMWATER RUNOFF

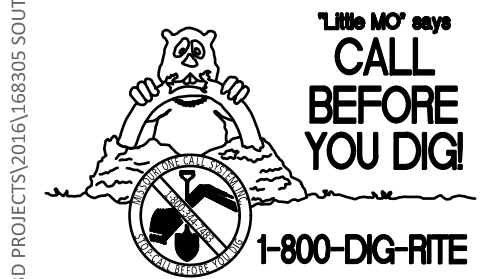
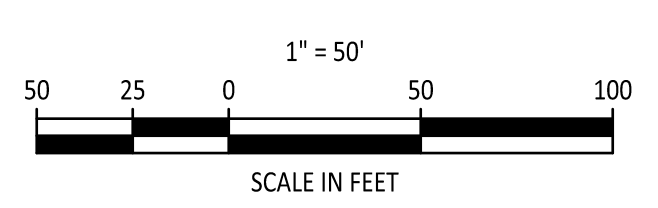

UNDERGROUND UTILITIES AND OSHA SAFETY NOTE:
Underground utilities and structures have been plotted from available information and therefore, their location must be considered approximate only. It is the responsibility of the individual contractors to notify the utility companies before actual construction. All O.S.H.A. rules and regulations established for the type of construction required by these plans shall be strictly followed (ie. trenching, shoring, etc.)