

1 WARPING DETAIL
SCALE: 1"=10'

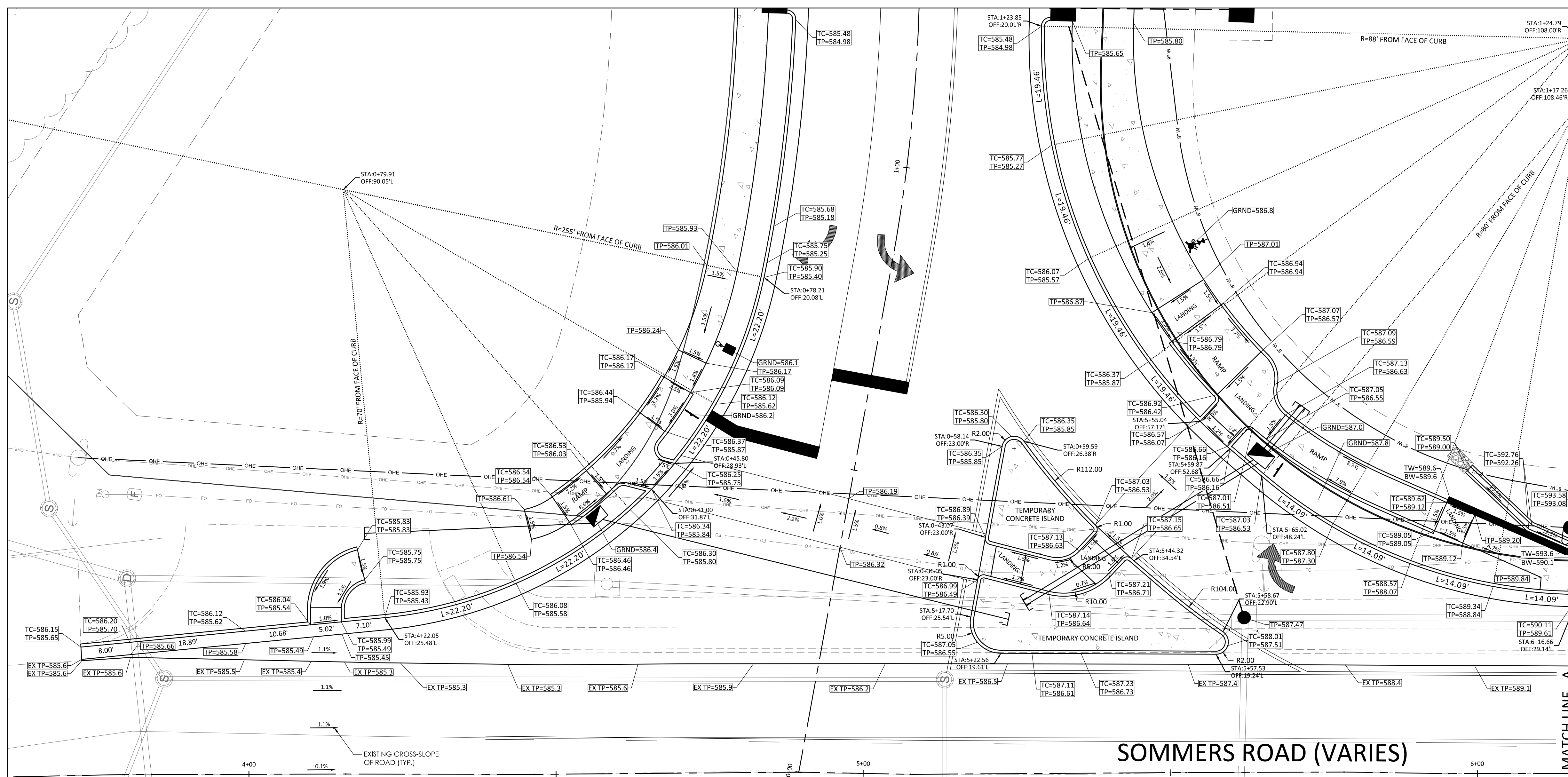

1A HANDICAP RAMP AND WARPING DETAIL
SCALE: 1"=10'



ENGINEERS AUTHENTICATION
 The responsibility for the preparation of engineering solutions on this project is hereby limited to the set of plans authorized by the seal, signature, and date hereunder attached. Responsibility is disclaimed for all other engineering plans involved in this project and specifically excludes revisions after the date sales are negotiated.
STEVEN D. MARON, P.E.
 PROFESSIONAL ENGINEER
 PE 2006007195

SOUTH RIDGE SHOPPES, L.L.C.
 OLD HIGHWAY N ROAD IMPROVEMENTS
 8288 HWY N
 OF FALLON, MO
 NEIL KERSTEN
 16761 CONCORD HILL
 MARTHASVILLE, MO 63357

Project: SOUTH RIDGE SHOPPES, L.L.C. OLD HIGHWAY N ROAD IMPROVEMENTS
 Date: 2-08-2020

Revision Date	Description of Changes
1. 03-20-20	REVISIONS PER CITY COMMENTS
2. 04-24-20	REVISIONS PER CITY COMMENTS
3. 05-14-20	REVISIONS PER CITY COMMENTS
4. 05-14-20	REVISIONS PER CITY COMMENTS
5. 05-14-20	REVISIONS PER CITY COMMENTS

Sheet Title: WARPING DETAILS
 Sheet No.: C-800

Project No. 168305
 Drawn By A. JONES
 Checked By J. WINTERS

NOT RELEASED FOR CONSTRUCTION

\\wint\p\w\c\civil\3d\PROJECTS\2016\168305 SOUTH RIDGE SHOPPES\CONSTRUCTION DRAWINGS\DETAILS\ENTRANCE DETAILS-ROAD.dwg



UNDERGROUND UTILITIES AND OSHA SAFETY NOTE:
 Underground utilities and structures have been plotted from available information and therefore, their location must be considered approximate only. It is the responsibility of the individual contractors to notify the utility companies before actual construction. All O.S.H.A. rules and regulations established for the type of construction required by these plans shall be strictly followed (ie, trenching, blasting, etc.)