

# SOUTHSIDE PLAZA

A TRACT OF LAND BEING PART OF U. S. SURVEY 55  
T. 47 N. - R. 3 E.  
ST CHARLES COUNTY, MISSOURI

## EXISTING DRAINAGE AREAS (NO CHANGES) PAVEMENT RECONSTRUCTION ONLY!

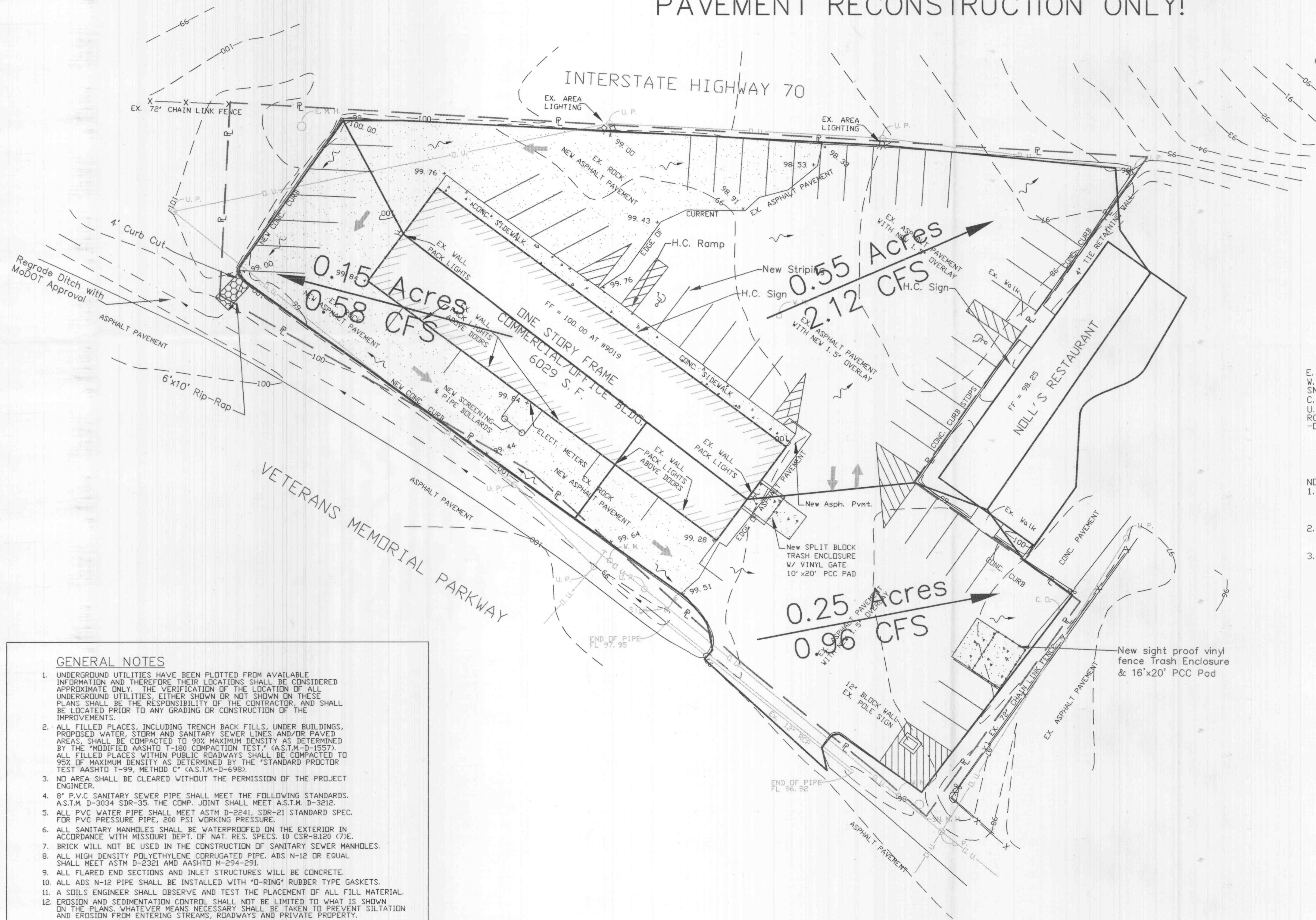

**LEGEND**

E. M. H.	Electric Manhole
W. M.	Water Meter
S. M. H.	Sanitary Manhole
C. D.	Cleanout
U. P.	Utility Pole
RCP	Reinforced Concrete Pipe
-DU-	Overhead Utilities

- NOTES:**
- 1.) ASSUMED DATUM BENCHMARK  
ELEVATION = 100.00  
AT FINISHED FLOOR OF #9019
  - 2.) THE EXISTENCE OF UNDERGROUND  
UTILITIES WERE NOT INVESTIGATED
  - 3.) THE PARCEL LINES SHOWN HEREON  
ARE TAKEN FROM A PROPERTY BOUNDARY  
SURVEY PREPARED BY METTS & ASSOCIATES,  
INC. DATED SEPTEMBER, 2002

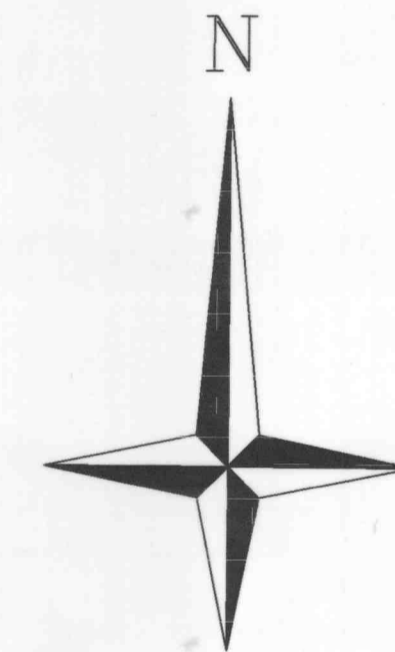
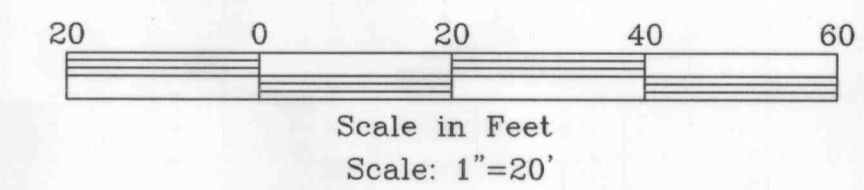

**GENERAL NOTES**

1. UNDERGROUND UTILITIES HAVE BEEN PLOTTED FROM AVAILABLE INFORMATION AND THEREFORE THEIR LOCATIONS SHALL BE CONSIDERED APPROXIMATE ONLY. THE VERIFICATION OF THE LOCATION OF ALL UNDERGROUND UTILITIES, EITHER SHOWN OR NOT SHOWN ON THESE PLANS SHALL BE THE RESPONSIBILITY OF THE CONTRACTOR, AND SHALL BE LOCATED PRIOR TO ANY GRADING OR CONSTRUCTION OF THE IMPROVEMENTS.
2. ALL FILLED PLACES, INCLUDING TRENCH BACK FILLS, UNDER BUILDINGS, PROPOSED WATER, STORM AND SANITARY SEWER LINES AND/OR PAVED AREAS, SHALL BE COMPACTED TO 90% MAXIMUM DENSITY AS DETERMINED BY THE "MODIFIED AASHTO T-99 COMPACTON TEST," (A.S.T.M.-D-1557). ALL FILLED PLACES WITHIN PUBLIC ROADWAYS SHALL BE COMPACTED TO 95% OF MAXIMUM DENSITY AS DETERMINED BY THE "STANDARD PROCTOR TEST AASHTO T-99, METHOD C" (A.S.T.M.-D-698).
3. NO AREA SHALL BE CLEARED WITHOUT THE PERMISSION OF THE PROJECT ENGINEER.
4. 8" P.V.C. SANITARY SEWER PIPE SHALL MEET THE FOLLOWING STANDARDS. A.S.T.M. D-3034 SDR-35. THE COMP. JOINT SHALL MEET A.S.T.M. D-3212.
5. ALL PVC WATER PIPE SHALL MEET ASTM D-2241, SDR-21 STANDARD SPEC. FOR PVC PRESSURE PIPE, 200 PSI WORKING PRESSURE.
6. ALL SANITARY MANHOLES SHALL BE WATERPROOFED ON THE EXTERIOR IN ACCORDANCE WITH MISSOURI DEPT. OF NAT. RES. SPECS. 10 CSR-8.120 (7)E.
7. BRICK WILL NOT BE USED IN THE CONSTRUCTION OF SANITARY SEWER MANHOLES.
8. ALL HIGH DENSITY POLYETHYLENE CORRUGATED PIPE, ADS N-12 OR EQUAL SHALL MEET ASTM D-2321 AND AASHTO M-274-291.
9. ALL FLARED END SECTIONS AND INLET STRUCTURES WILL BE CONCRETE.
10. ALL ADS N-12 PIPE SHALL BE INSTALLED WITH "O-RING" RUBBER TYPE GASKETS.
11. A SOILS ENGINEER SHALL OBSERVE AND TEST THE PLACEMENT OF ALL FILL MATERIAL.
12. EROSION AND SEDIMENTATION CONTROL SHALL NOT BE LIMITED TO WHAT IS SHOWN ON THE PLANS. WHATEVER MEANS NECESSARY SHALL BE TAKEN TO PREVENT SILTATION AND EROSION FROM ENTERING STREAMS, ROADWAYS AND PRIVATE PROPERTY.
13. ALL CONSTRUCTION SHALL MEET THE REQUIREMENTS OF THE CITY OF FALLON, MISSOURI.

COMMERCIAL BROKERAGE GROUP  
412 JUNGERMANN ROAD, SUITE 104  
ST. PETERS, MO 63376  
(636)-498-7000

PARKING LOT RECONSTRUCTION PLAN

CRISWELL ENGINEERING  
1663 NORTH MAIN STREET  
O FALLON, MO 63366  
(636) 240-4031

REVISIONS  
#1 6/2/03 City Comments

**CRISWELL  
ENGINEERING**

DISCLAIMER OF RESPONSIBILITY  
I HEREBY SPECIFY THAT THE DOCUMENTS INTENDED TO BE AUTHORIZED BY MY SEAL ARE LIMITED TO THE PROJECT AND I DISCLAIM ANY RESPONSIBILITY FOR ALL OTHER ENGINEERING DOCUMENTS OR INSTRUMENTS RELATING TO OR INTENDED TO BE USED FOR ANY PART OR PARTS OF THE ARCHITECTURAL OR ENGINEERING PROJECT OR SURVEY.

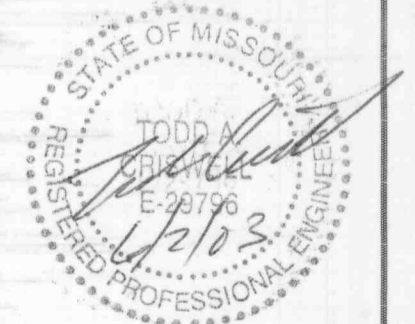

SEAL

DESIGNED: TAC  
CHECKED: DKC  
DATE: 5/26/03  
PROJECT NO.:

SHEET  
2 OF 2