

St. Peters
 22 Richmond Center Court
 St. Peters, MO 63376
 Phone (636) 397-1211
 Fax (636) 397-1104
 www.prs3.com

Pickett Ray & Silver
 Civil Engineering
 & Land Surveying
 Beyond Standard

ENGINEER'S AUTHENTICATION
 The responsibility for professional engineering liability on this project is hereby limited to the set of plans authorized by the seal, signature, and date hereunder attached. Responsibility is disclaimed for all other engineering plans involved in this project and specifically excludes revisions after this date unless reauthorized.



WILLIAM SCHEDT, P.E.
 PE-2018007869

Details

Owner Information:
 Archdiocese of St. Louis
 20 Archbishop May Dr
 St. Louis, MO 63119

City of O'Fallon Grading Plans

P+Z No. SP19-000002
 Approval Date: 3-8-19
 City No. 19-004263
 Page No.
DETAILS
 6 of 7

TYPE	SIGN SUPPORT	SIGN SUBSTRATE	MINIMUM MOUNTING HEIGHT (MIN.)	WEAR LIMITATIONS	COMMENTS
POST	PERFORATED SQUARE STEEL TUBE U-CHANNEL BOND	WOOD	NONE	NONE	POSTS SHALL BE FREE OF ANY BRACING AND FASTENERS EXCEPT ABOVE THE SIGN. ALL POSTS SHALL BE CHANGED AT THE END OF THE PROJECT. INSTALLATION SHALL BE IN ACCORDANCE WITH THE MOUNTING HEIGHTS LISTED IN TABLE A.
TYPE I PORTABLE	SLIP-UP STAND	WOOD	5' UNLESS INDICATED OTHERWISE	PERMITTED ONLY WHERE POST MOUNTING IS NOT PRACTICAL.	SYSTEM SHALL COMPLY WITH CRASH TEST REQUIREMENTS AND SHALL BE TESTED TO WITHSTAND THE IMPACT OF A 10,000 LB. TRUCK. ALL PORTABLE SIGN STANDS SHALL BE TESTED TO WITHSTAND THE IMPACT OF A 10,000 LB. TRUCK. ALL PORTABLE SIGN STANDS SHALL BE TESTED TO WITHSTAND THE IMPACT OF A 10,000 LB. TRUCK. ALL PORTABLE SIGN STANDS SHALL BE TESTED TO WITHSTAND THE IMPACT OF A 10,000 LB. TRUCK.
TYPE 2 PORTABLE	SLIP-UP STAND SELF-DRAINING HOOD TYPE III MOVABLE BARRICADE	FLEXIBLE	5' UNLESS INDICATED OTHERWISE	PERMITTED ONLY FOR INSTALLATION ON SIDEWAYS.	SYSTEM SHALL COMPLY WITH CRASH TEST REQUIREMENTS AND SHALL BE TESTED TO WITHSTAND THE IMPACT OF A 10,000 LB. TRUCK. ALL PORTABLE SIGN STANDS SHALL BE TESTED TO WITHSTAND THE IMPACT OF A 10,000 LB. TRUCK. ALL PORTABLE SIGN STANDS SHALL BE TESTED TO WITHSTAND THE IMPACT OF A 10,000 LB. TRUCK.
BARRIER	CONCRETE TRAFFIC BARRIER	FLEXIBLE	5' UNLESS INDICATED OTHERWISE	PERMITTED ONLY WHERE POST MOUNTING IS NOT PRACTICAL.	SYSTEM SHALL COMPLY WITH CRASH TEST REQUIREMENTS AND SHALL BE TESTED TO WITHSTAND THE IMPACT OF A 10,000 LB. TRUCK. ALL PORTABLE SIGN STANDS SHALL BE TESTED TO WITHSTAND THE IMPACT OF A 10,000 LB. TRUCK. ALL PORTABLE SIGN STANDS SHALL BE TESTED TO WITHSTAND THE IMPACT OF A 10,000 LB. TRUCK.

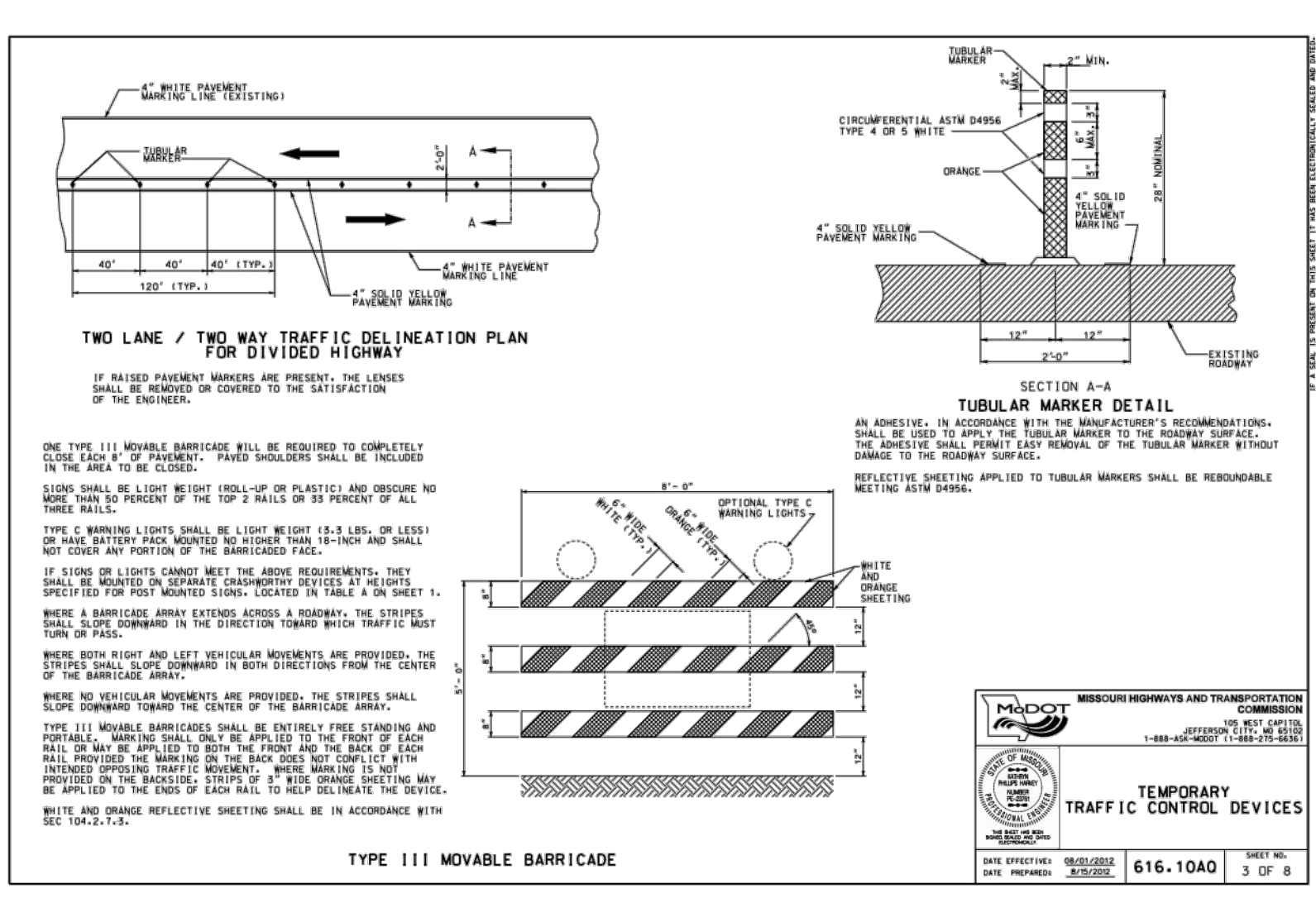
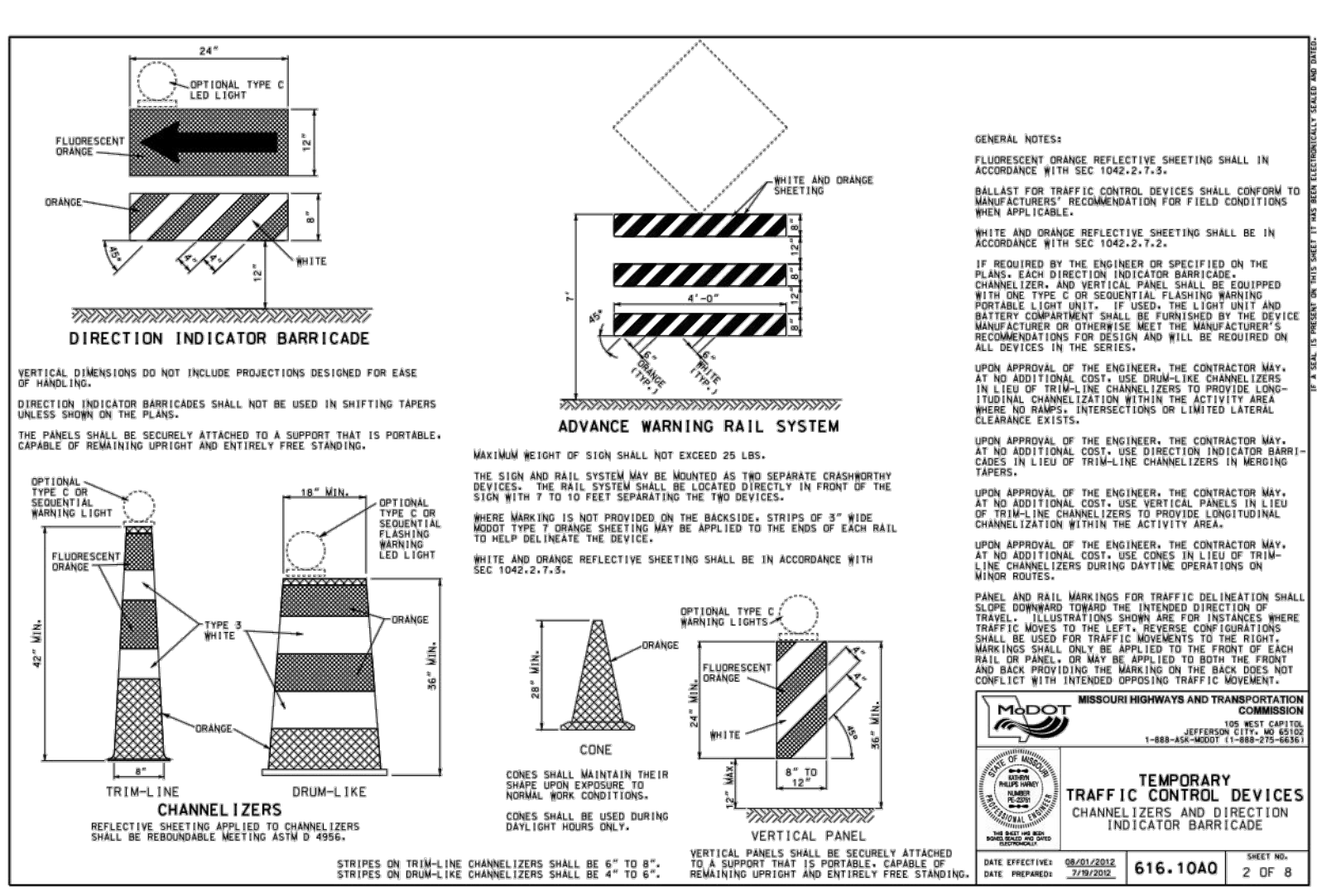

TYPE	POST TYPE	POST TYPE	POST TYPE
TYPE I PORTABLE	1 - 4" x 4" x 8"	1 - 4" x 4" x 8"	1 - 4" x 4" x 8"
TYPE 2 PORTABLE	2 - 4" x 4" x 8"	2 - 4" x 4" x 8"	2 - 4" x 4" x 8"
BARRIER	2 - 4" x 4" x 8"	2 - 4" x 4" x 8"	2 - 4" x 4" x 8"

TYPE	POST TYPE	POST TYPE	POST TYPE
TYPE I PORTABLE	1 - 4" x 4" x 8"	1 - 4" x 4" x 8"	1 - 4" x 4" x 8"
TYPE 2 PORTABLE	2 - 4" x 4" x 8"	2 - 4" x 4" x 8"	2 - 4" x 4" x 8"
BARRIER	2 - 4" x 4" x 8"	2 - 4" x 4" x 8"	2 - 4" x 4" x 8"

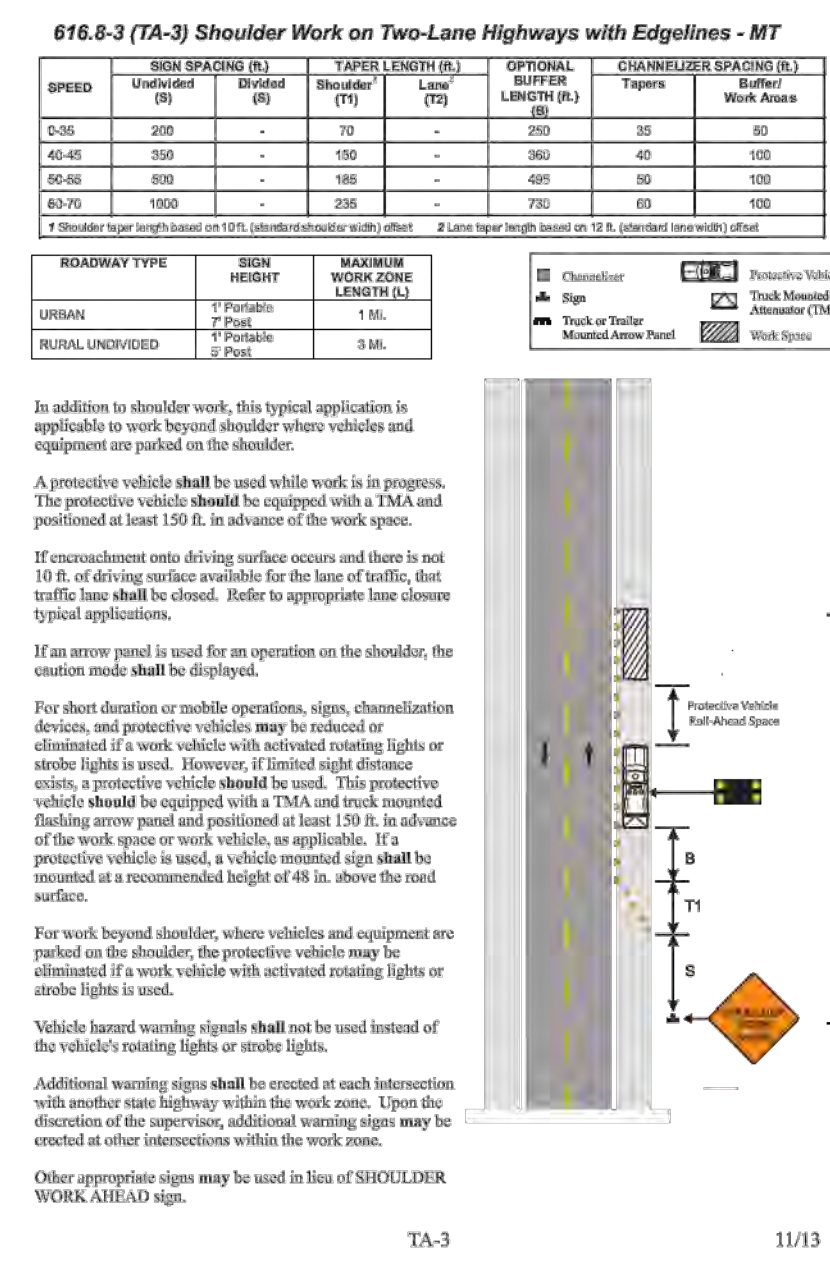
Table 60-7 Temporary Fall Seeding

Plant Species	Rate ¹ (lb/acre)	Seeding Times
Side-Outs	65	8/16 - 9/30
Winter Rye	50	8/01 - 10/15
Winter Wheat	60	8/01 - 10/15
Orchard Grass	120	8/01 - 10/15
Perennial Ryegrass	80	8/01 - 10/15
Tall fescue, Smooth Brome	80	8/01 - 10/15
K-31 Fescue	120	9/01 - 11/15
Ladino Clover	2 ²	8/15 - 9/15
Crimson Clover	6 ²	8/15 - 9/15
Orchard Grass and Oats or Rye	15 ²	8/15 - 9/15

¹If using aerial seeding or other broadcast method to apply seed without rolling or cultipacking, increase seeding rates by 50 percent.

²Pure live seed (PLS)

Table 60-8 Temporary Spring Seeding

Plant Species	Rate ¹ (lb/acre)	Seeding Dates
Winter Rye	50	3/15 - 5/31
Spring Oats	65	3/15 - 5/31
Annual Ryegrass	4 ²	3/15 - 6/15
Sudangrass	30 ²	3/15 - 5/31
Red Clover	2 ²	3/15 - 5/31
Oats	30 ²	3/15 - 5/31

¹If using aerial seeding or other broadcast method to apply seed without rolling or cultipacking, increase seeding rates by 50 percent.

²Pure live seed (PLS)

Table 60-5 Soil Stabilization Schedule

Soil Disturbance Activity or Condition	Required Stabilization Time
Soil disturbance has ceased in areas greater than 2,000 square feet.	14 days
After construction of dikes, swales, diversions, and other concentrated flow areas	5 days
When slopes are steeper than 3 horizontal to 1 vertical	7 days
When slopes are greater than 3% and longer than 150 feet.	14 days
Perimeter controls around soil stockpiles.	End of workday
Stabilization or covering of inactive stockpiles.	30 days
When land disturbance is completed, permanent soil stabilization must be installed.	30 days