

FLAT ROOF RECTANGULAR RACKS/WEIRS (STANDARD SIZES) DIMENSIONS IN INCHES TO THE NEAREST 1/4"

HOST STRUCTURE INSIDE DIMENSIONS
 LENGTH WALL THICKNESS (REQUIRED)
 WIDTH

AS DISTRIBUTED BY CONTECH CONSTRUCTION PRODUCTS NATIONALLY

WIDTH (A)	11 3/8	16 3/4	22 1/8	27 1/2	32 7/8	38 1/4	43 5/8	49	54 3/8	59 3/4	65 1/8	70 1/2	75 7/8	81 7/8	87 1/4
CODE	02	03	04	05	06	07	08	09	10	11	12	13	14	15	16
LENGTH (B)	11 3/8	16 3/4	22 1/8	27 1/2	32 7/8	38 1/4	43 5/8	49	54 3/8	59 3/4	65 1/8	70 1/2	75 7/8	81 7/8	87 1/4
CODE	02	03	04	05	06	07	08	09	10	11	12	13	14	15	16
HEIGHT (C)	7 1/2	12 7/8													
CODE	01	02													
	1 GRID HIGH	2 GRID HIGH													

FLAT ROOF (FR) WIDTH (A) LENGTH (B) HEIGHT (C)

CONTECH CONSTRUCTION PRODUCTS INC.
 9000 CENTRE POINT DRIVE, SUITE 400
 MISSOURI CITY, MO 63051
 PH: 816.251.2200 FAX: 816.251.7399
 © COPYRIGHT

CUSTOMER: _____ DATE: _____
 PROJECT: _____ DRAWN BY: _____
 APP'D BY: _____
 DETAIL: _____

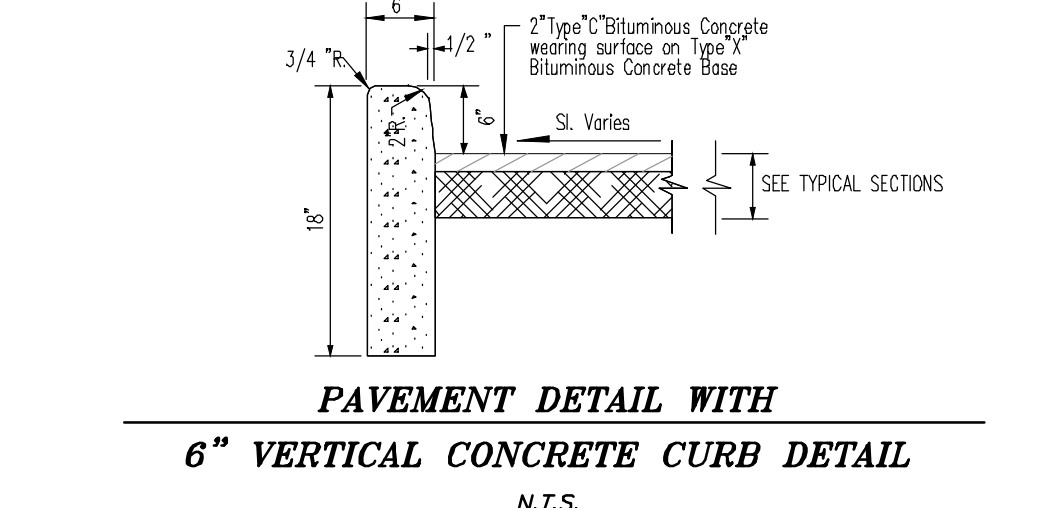
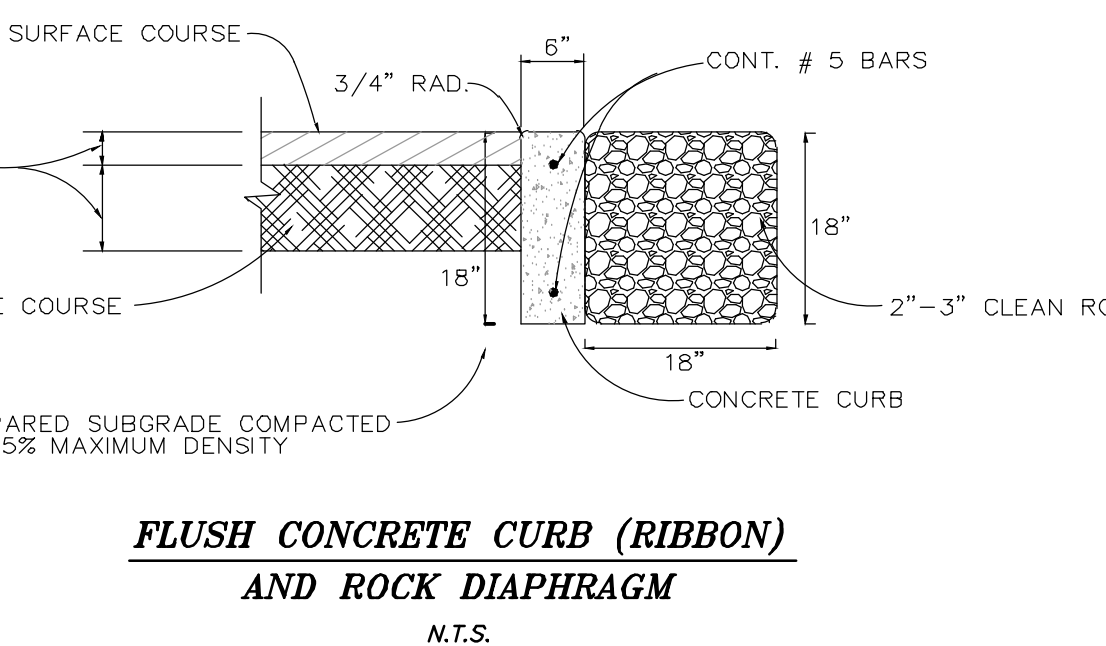

BITUMINOUS CONCRETE OVER CONCRETE PAVEMENT CUT
CONCRETE PAVEMENT CUT
BITUMINOUS CONCRETE PAVEMENT CUT

CUT PLAN
 NOTE: Right Angles to be 90°±

CUT SECTION
 NOTE: Right Angles to be 90°±

GENERAL NOTES

- If a joint is located in the existing concrete pavement, all full depth repairs shall be made in accordance with the specifications for full depth repairs.
- Concrete pavement shall be repaired in accordance with the specifications for concrete pavement repair.
- Concrete pavement shall be repaired in accordance with the specifications for concrete pavement repair.
- Concrete pavement shall be repaired in accordance with the specifications for concrete pavement repair.

DETAILS OF TEMPORARY OPENINGS IN ROADWAY PAVEMENT

CITY OF O'FALLON ENGINEERING DEPARTMENT O'FALLON, MISSOURI

WILLIAM SCHEIDT
 NUMBER PE-2018007869
 PROFESSIONAL ENGINEER

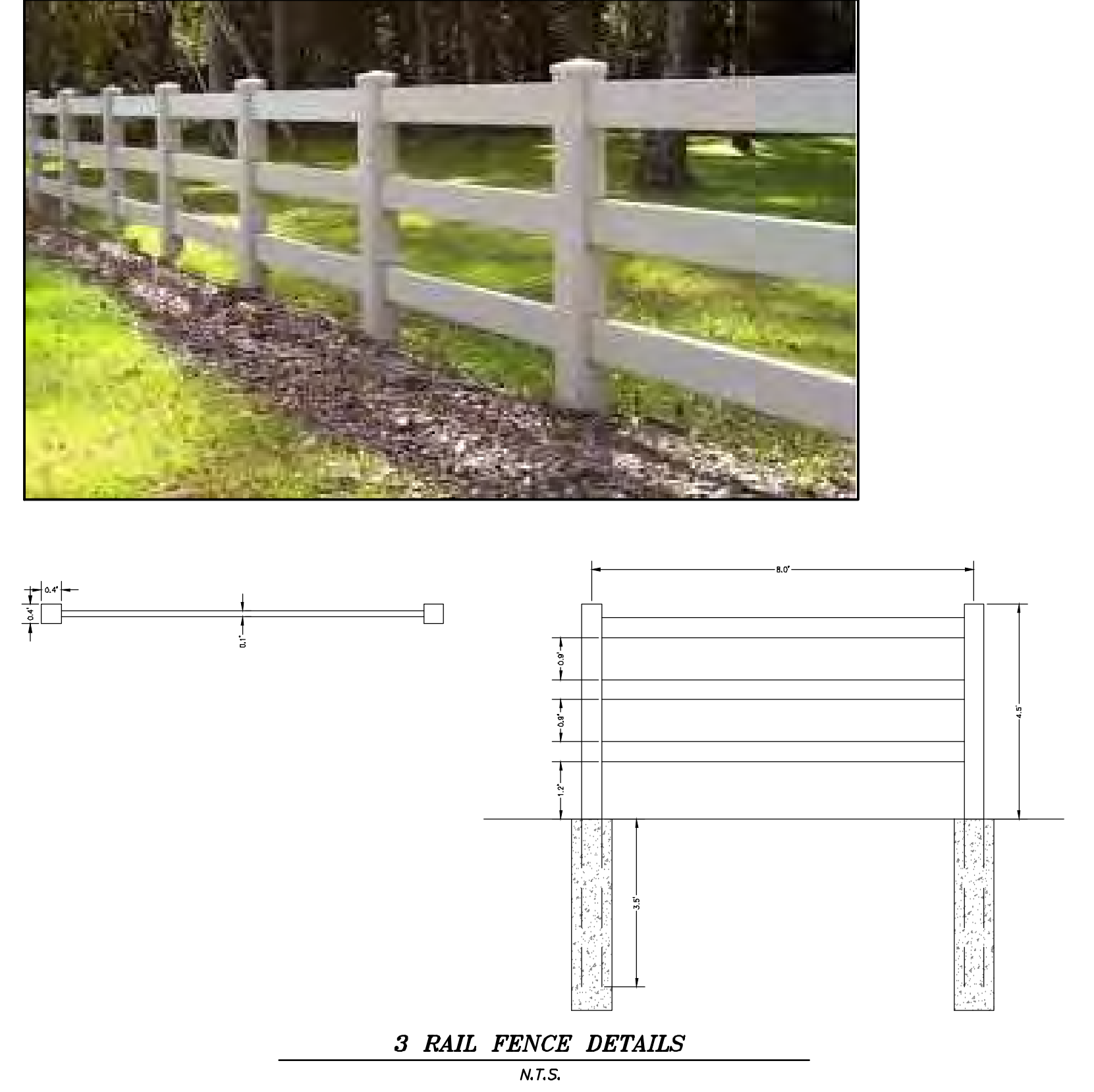

LIGHT POLE BASE DETAIL
N.T.S.

ANCHOR BOLTS (FURNISHED BY ELECTRICAL CONTRACTOR, INSTALLED BY GENERAL CONTRACTOR)

BASE CAP

#8 AWG GROUNDWIRE

GRADE

CAD WELD CONNECTION

P.V.C. CONDUIT (BY ELECTRICAL CONTRACTOR) SIZE AS REQUIRED - MIN. 2"

1/2" 8-0" COPPER CLAD GROUND ROD

24" CONCRETE PIER

COMPACTED FILL TO UNDISTURBED SOIL

NOTE: DIMENSIONS MAY VARY, SEE ELECTRICAL ENGINEERS SPECIFICATIONS

BIO-RETENTION MEDIA SECTION DETAILS
N.T.S.

RETAINING WALL

2.0'

2.0'

2" SHREDDED HARDWOOD MULCH

PLANTING SOIL SHOULD BE A SANDY LOAM OR LOAMY SAND:
 70-75% SAND
 15-20% SILT
 5-10% CLAY
 2-5% ORGANICS

THE CLAY CONTENT FOR THESE SOILS SHOULD BE LESS THAN 10 PERCENT BY VOLUME. A SATURATED HYDRAULIC CONDUCTIVITY OF AT LEAST 2.0 FEET PER DAY (1.0 INCHES PER HOUR) IS REQUIRED.

6" CONCRETE SAND, ASTM C-33, NATURAL

6" CLEAN PEA GRAVEL 3/8", AASHTO M-43 NO. 8

3/4" CLEAN GRAVEL INFILTRATION BED

AASHTO M-43 NO. 6 OR 67

MIRAFI FW-SERIES OR APPROVED EQUAL FILTER FABRIC INSTALLED ON SIDE SLOPES ONLY.

BIORETENTION PLANTING PALLET

BOTANICAL NAME	COMMON NAME	SIZE
COREOPSIS LANCEOLATA	LANCELEAF COREOPSIS	1 QT.
ECHINACEA PURPUREA	PURPLE CONFLOWER	100 mm ELLEPOT
MONARDA FISTULOSA	WILD BERGAMONT	120 mm ELLEPOT
PHLOX PANICULATA	MEADOW PHLOX	1 GALLON
PANICUM VIRGATUM	SWITCH GRASS	1 GALLON

BIORETENTION PLANT SPACING

ST DOMINIC HIGH SCHOOL
 SEVERAL TRACTS OF LAND BEING U.S. SURVEY 55,
 TOWNSHIP 47 NORTH RANGE 3 EAST,
 CITY OF O'FALLON,
 ST. CHARLES COUNTY, MISSOURI
IMPROVEMENT PLANS

PROJECT NO: 19002.S019.008

St. Peters
 22 Richmond Center Court
 St. Peters, MO 63376
 Phone (636) 397-1121
 Fax (636) 397-1104
 www.prs3.com

Pickett Ray & Silver
 Civil Engineering
& Land Surveying
 Beyond Standard

ENGINEERS AUTHORIZATION
 The responsibility for professional engineering liability on this project is hereby limited to the set of plans authorized by the seal, signature, and date hereunder attached. Responsibility is disclaimed for all other engineering plans involved in this project and specifically excludes revisions after this date unless reauthorized.

PICKETT, RAY & SILVER, INC.



WILLIAM SCHEIDT, P.E.
 PE-2018007869

Details

Owner Information:
 Archdiocese of St. Louis
 20 Archbishop May Dr
 St. Louis, MO 63119

City of O'Fallon Improvement Plans

P+Z No: SP19-000018
 Approval Date: 6/6/2019
 City No: 19-005347

Page No.
DETAILS
 10 of 11